

Assessment Report

NI 43-101-Compliant Report on the Year-2006 Diamond Drilling Program, Including Summaries of 2006 Resource Estimates and Metallurgical Studies On the Louise Lake Property North American Gem Inc.

Volume 3: Figures 9 – 15, Maps 1, 1a

CAVE, LOUISE 2, 3, 8, 10, 11, 14, 19, 21, 23, 25, 28, 35-38 claims,
Unnamed Tenures 508123, 508125 – 508137 inclusive, 514931, 514932

Owner: Messrs. Bernard Kreft and Charles Schulze
Operator: North American Gem Inc.

Smithers area, north-central British Columbia
Omineca Mining Division

54° 51' 15" N Latitude, 127° 42' 45" W Longitude
BCGS Sheet NO93L082

Dec 10, 2006

For: North American Gem Inc.
Suite 1788 – 650 West Georgia St.
Vancouver, B.C. V6B 4N8
Tel: 604-683-5445
Fax: 604-687-9631
Toll Free: 1-866-683-5445
charles@solitaireminerals.com

By:
Carl Schulze, BSc, PGeo, Consulting Geologist for project
All-Terrane Mineral Exploration Services
35 Dawson Rd
Whitehorse, Yukon Y1A 5T6
Tel: 867-633-4807
Fax: 867-633-4883
Email: allterrane@northwestel.net

Jan 22, 2007

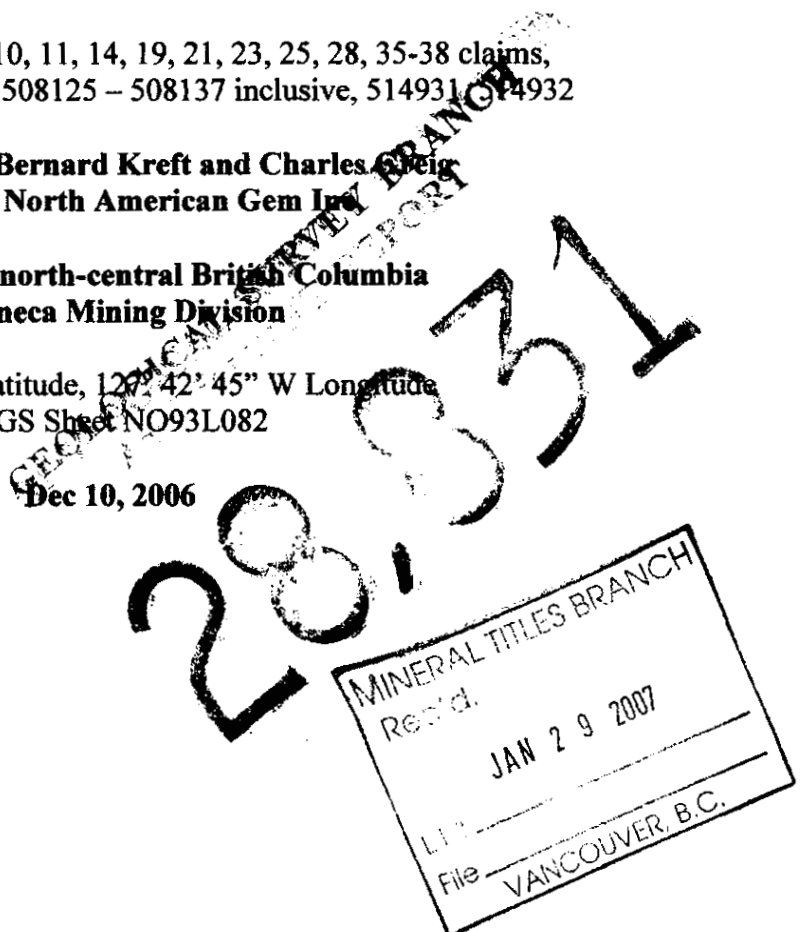

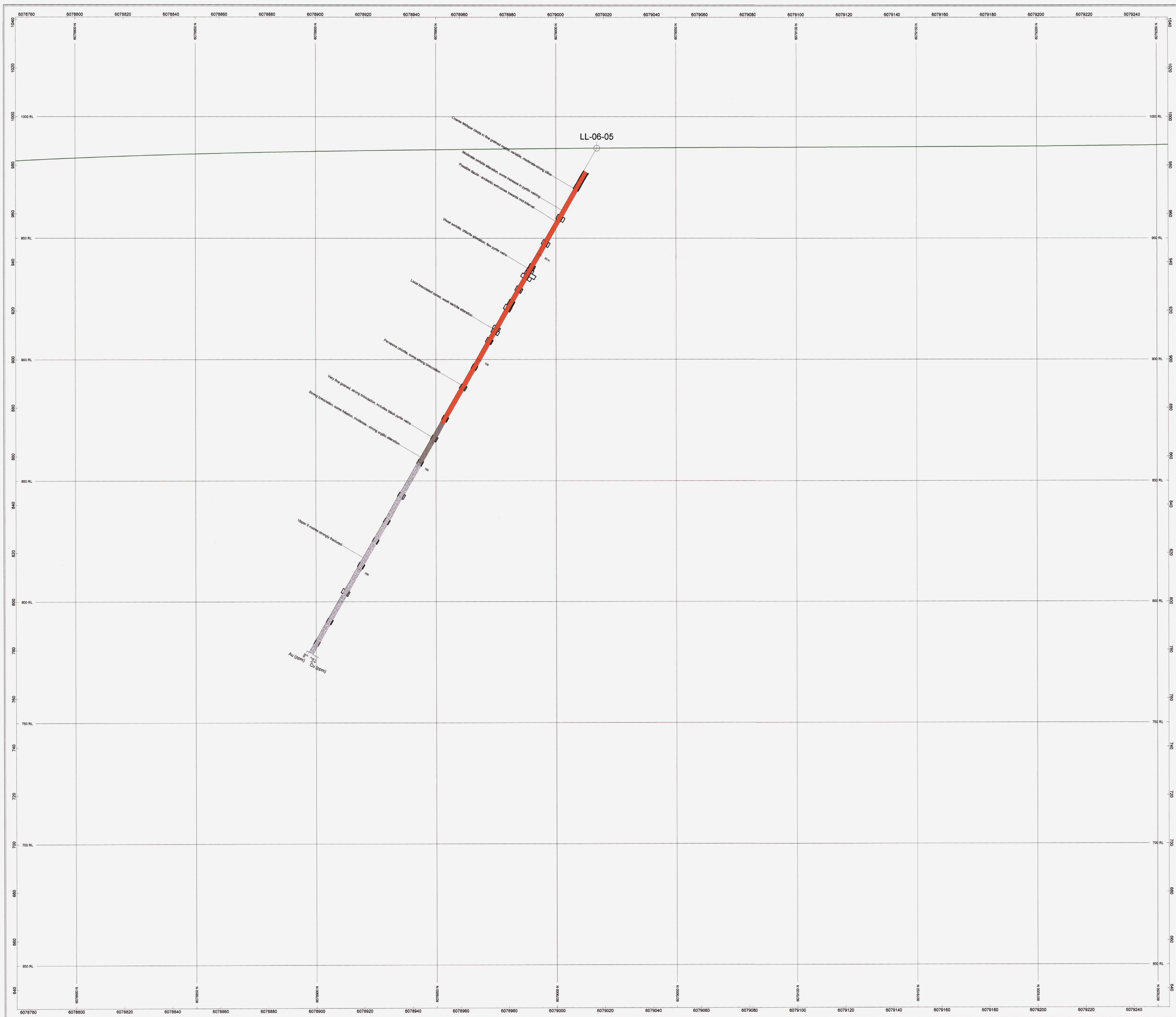

LL-06-05

Au (ppm)
Cu (ppm)

LEGEND:

LABEL	DESCRIPTION
CNGL-SDST	Conglomerate Sandstone
PRMET	Pyritic Monzonite
OVB	Overburden
SLST	Siltstone

HISTOGRAM LEGEND:

Cu (ppm) Au (ppm)

SECTION SPECS:
 REF. PT. E. N. 5000000.00
 EXTENSION 100.00 m
 SECTION 100.00 m
 TOTAL DISTANCE 100.00 m

28.831

Scale 1:500

NORTH AMERICAN GEMS INC.
 LOUISE LAKE PROJECT
 FIGURE 9A-LL-06-05 DRILL SECTION (Cu-Au)

Trim: N093082 Mining District: Omineca
 Datum: NAD83 Projection: Zone 9
 Date: January 19th 2007 Job: NAG-7502-BC
 Drafted By: L. Blackburn

AURORA GEOSCIENCES LTD.

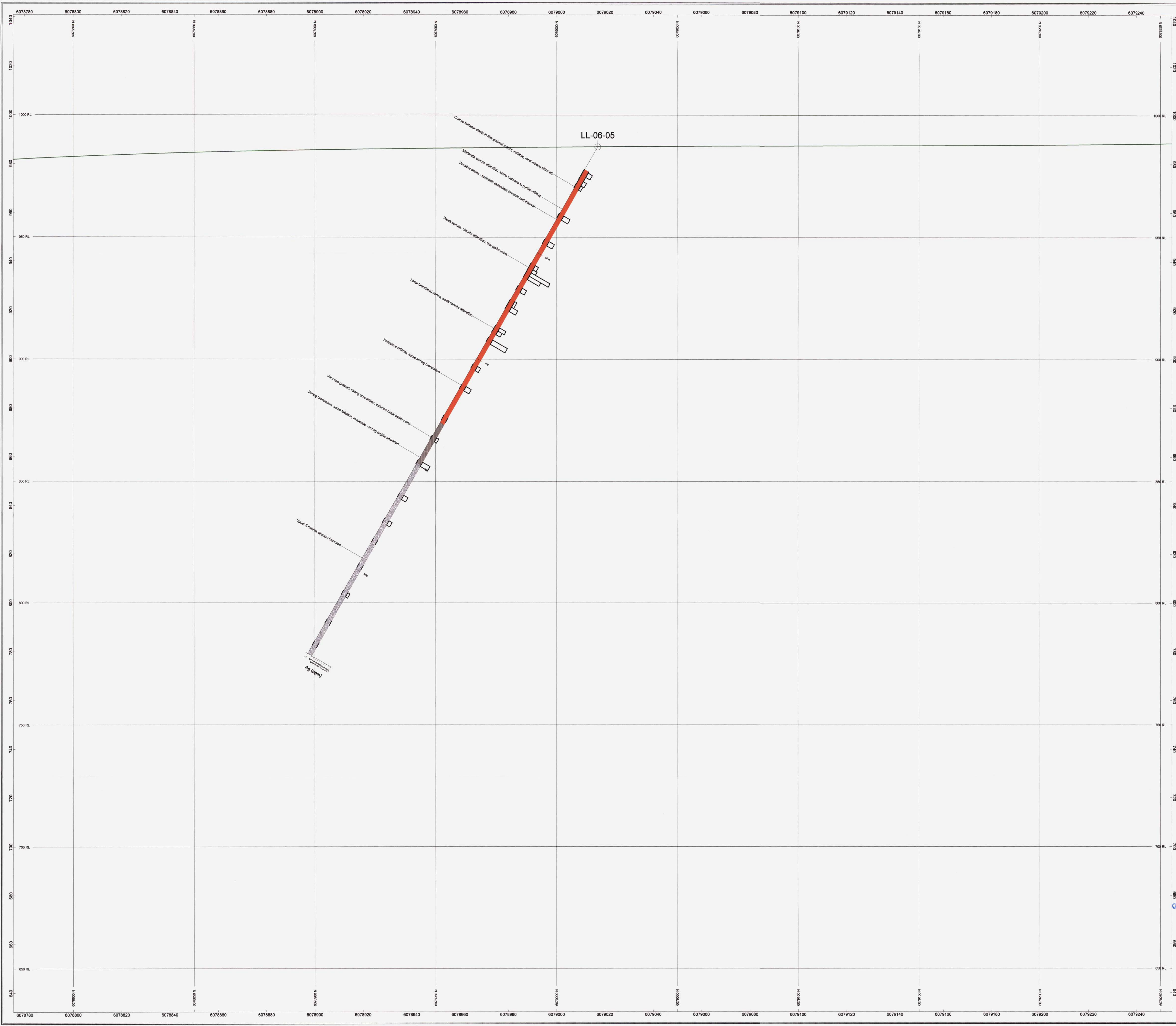

LEGEND:

LABEL	DESCRIPTION
OVBL-SLST	Conglomerate-Sandstone
FRMGT	Feldspar-Phenocryst-Microcrite
OVB	Overburden
SLST	Siltstone

COMPOSITE VALUES: Cu (ppm)

> 3000 ppm (Cu)
1500 - 3000 ppm (Cu)
< 1500 ppm (Cu)

COMPOSITE VALUES LEGEND:

2385	0.134	1.2	63
Cu (ppm)	Ag (ppm)	Ag (ppm)	Mo (ppm)

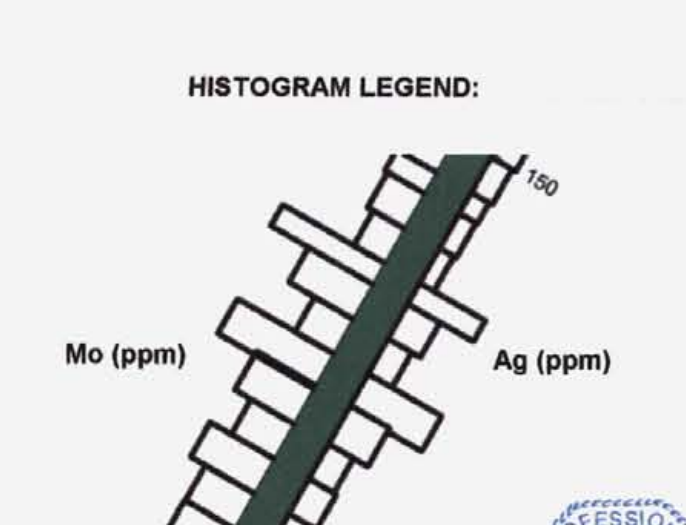

GEOLOGICAL SURVEY BRANCH
ASSESSMENT REPORT

SECTION SPECS:
REF ID: 11-08345 m 6079016 m
EXTENTS: 79.4 m 438.7 m
SECTION: 1041 m 622.2 m
TOURNAI: 90 m

Scale 1:500

28,031

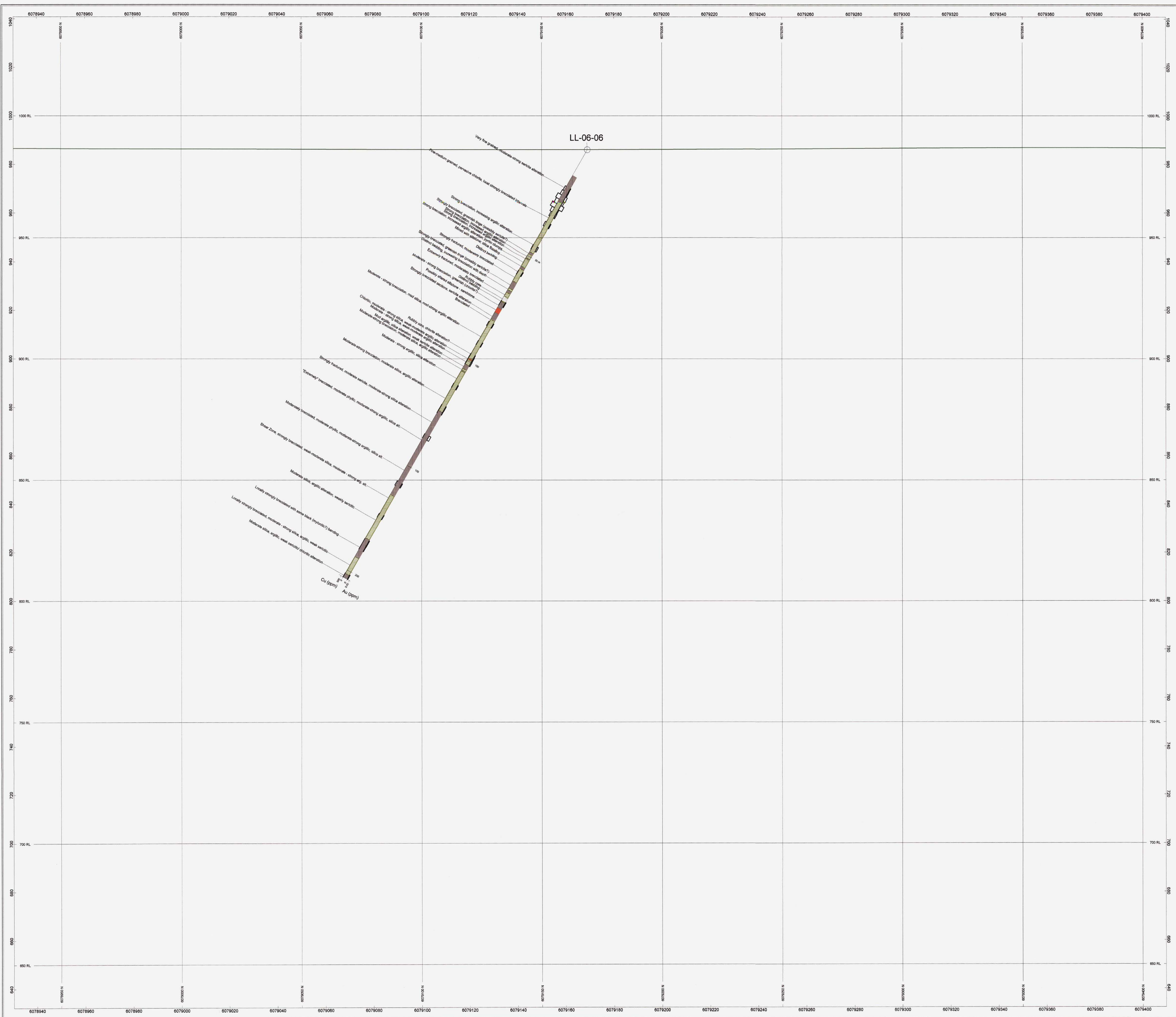

LL-06-06

LEGEND:

LABEL	DESCRIPTION
FRAC1	Felsic-Porphyric-Monzonite
OVB	Ore-bearing
SCST	Sandstone
SILT	Siltstone
SILT-SDST	Siltstone-Sandstone

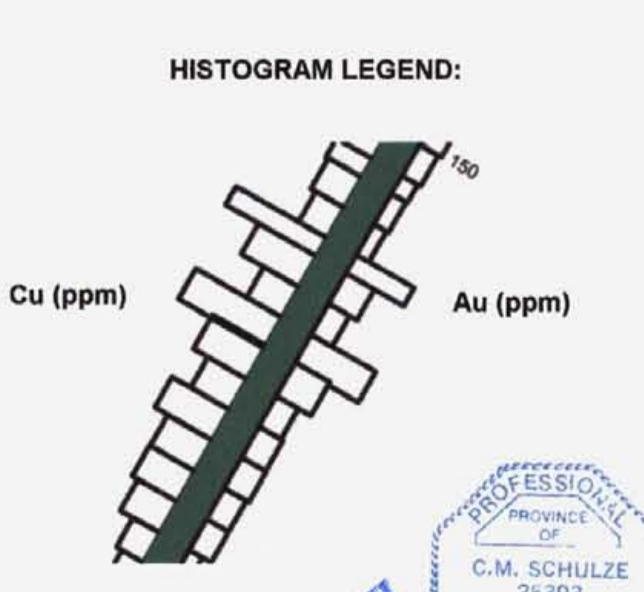

SECTION SPECS:
 REF. PT. E. N. 6079170 m
 EXTENT E. 408.7 m
 EXTENT N. 1041 m
 TOLERANCE +/- 50 m

Scale 1:500

28,000

GEOLOGICAL BRANCH
ASSIGNMENT REPORT

PROFESSOR
 C.M. SCHULTE
 23.393
 COLUMBIA
 UNIVERSITY
 GEOSCIENCE

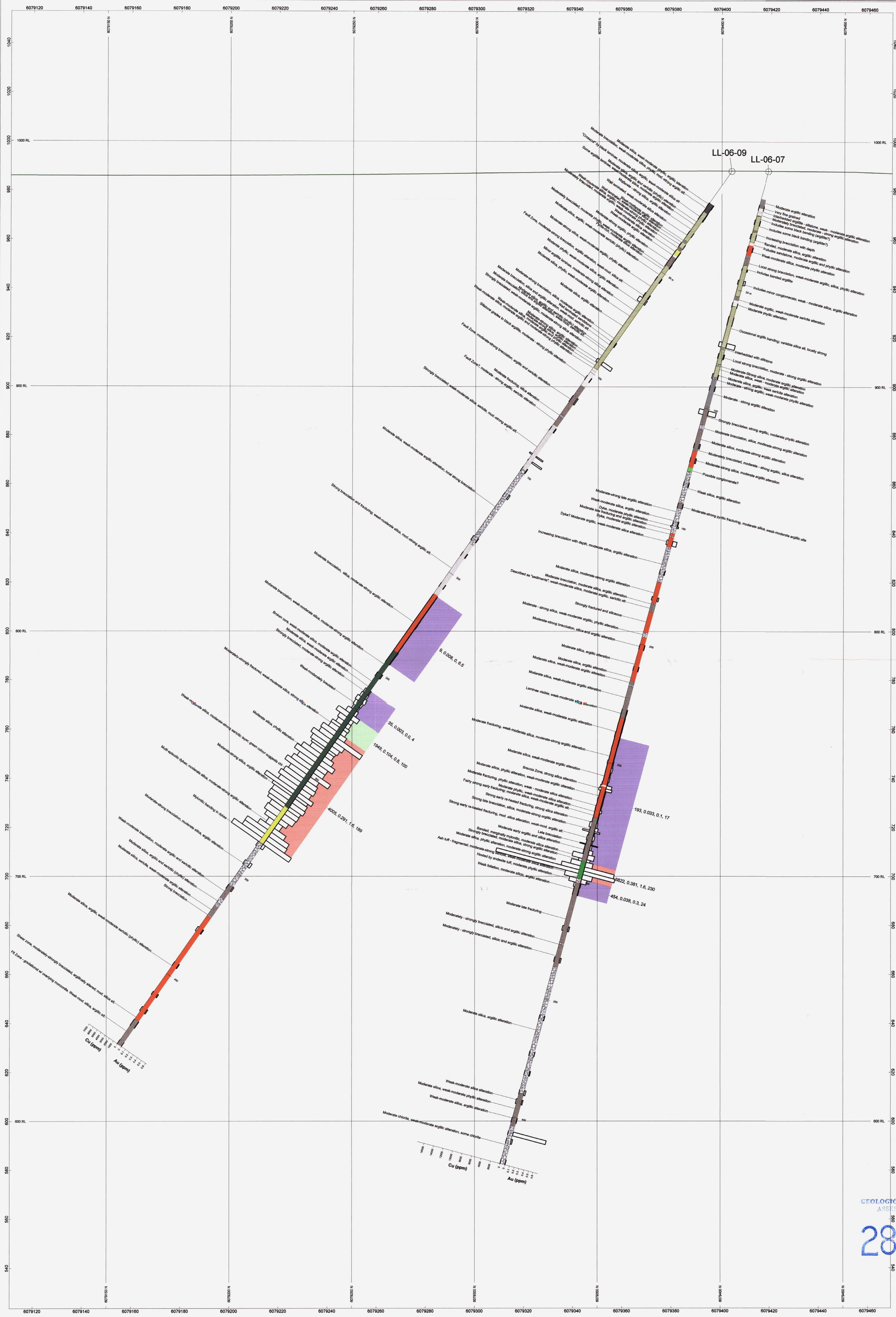

LEGEND:

LABEL	DESCRIPTION
AGLT	Argillite
AGLT-SDST	Argillite-Sandstone
AGLT-SLST	Argillite-Siltstone
AND-DAC-VOLR	Andesite-Dacite-Volcanics
CHU-SLST	Conglomerate-Siltstone
DAC-AND-TUF	Dacite-Andesite-Tuff
FLC-DYK	Felsic-Dyke
FR-MZT	Felsic-Phosphatic-Monzonite
HIT-CANGL	Heimiteic-Conglomerate
MVL-FLT-ZN	Mylonite-Fault-Zone
OVN	Overburden
RFV-FOMTL	Rhyolite-Fragmental
SDST	Sandstone
SLST	Siltstone
SLST-SDST	Siltstone-Sandstone

COMPOSITE VALUES: Cu (ppm)

< 3000 ppm (Cu)
1500 - 3000 ppm (Cu)
> 1500 ppm (Cu)

COMPOSITE VALUES LEGEND:

2389, 0.134, 1.3, 83

HISTOGRAM LEGEND:

Cu (ppm) Au (ppm)

SECTION SPECS:

REF. PT. E.N. 56040 m 6079360 m
 EXTENTS 368.7 m 528.4 m
 SECTION TOP, BOT 1063 m 523.5 m
 TOLERANCE +/- 90 m

28,831

Scale 1:500

NORTH AMERICAN GEMS INC.
LOUISE LAKE PROJECT
FIGURE 11A- LL-06-07 & LL-06-09 DRILL SECTIONS (Cu-Au)
 Trim: N693082 Mining District: Omineca
 Datum: NAD83 Projection: Zone 9
 Date: January 24th 2007 Drafted By: L. Blackburn Job: NAG-7502-BC
AURORA GEOSCIENCES LTD.

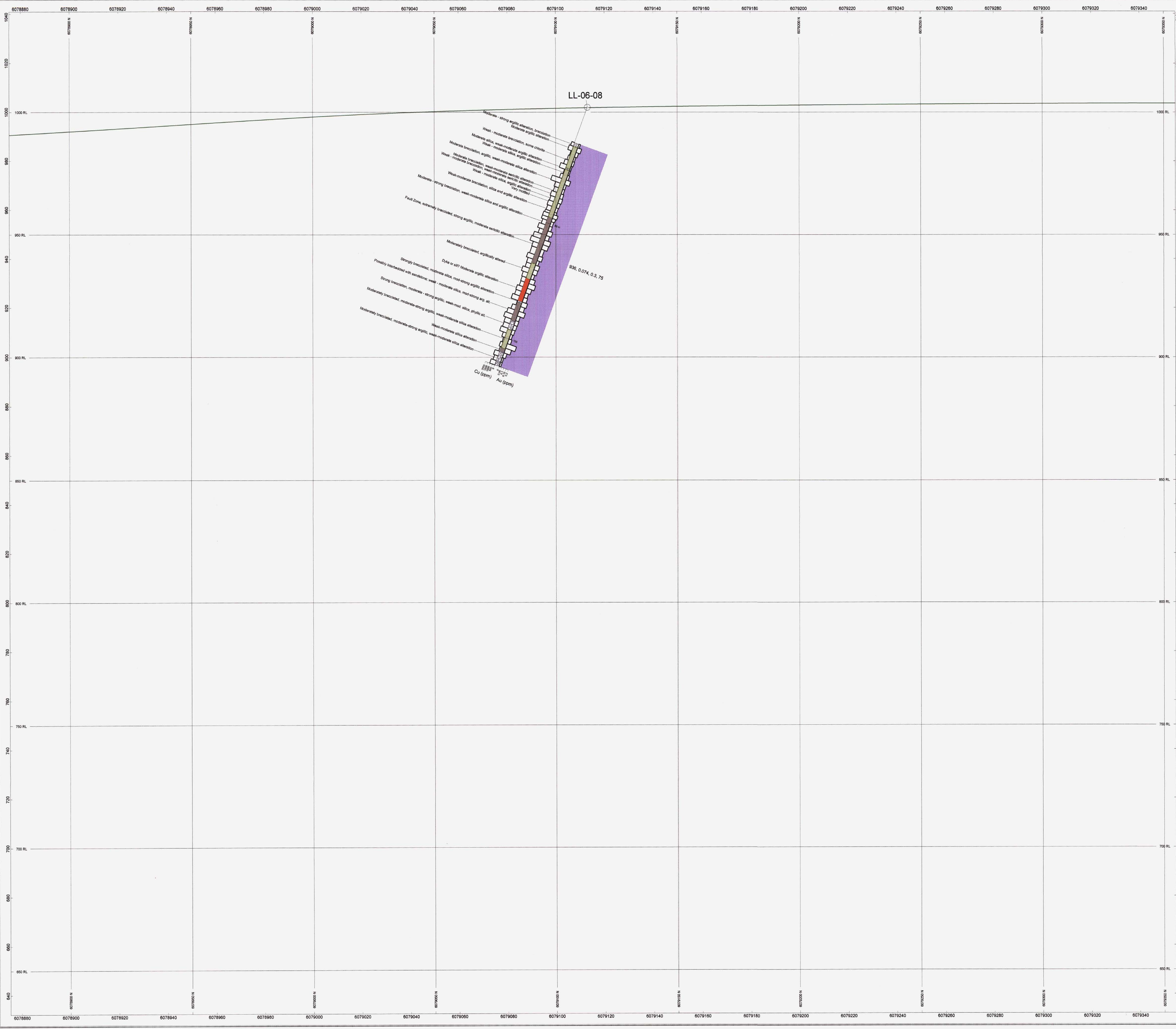

LEGEND:

LABEL	DESCRIPTION
FR-42T	Feldspar-Porphyrific-Monzonite
HET-CWCL	Hyaloclastic Conglomerate
OVB	Overburden
SDBT	Sandstone
SLEST	Siltstone

COMPOSITE VALUES: Cu (ppm)

Red	> 3000 ppm (Cu)
Orange	1000 - 3000 ppm (Cu)
Yellow	< 1000 ppm (Cu)

COMPOSITE VALUES LEGEND:

2360	0.134	1.2	63
Cu (ppm)	Au (ppm)	Ag (ppm)	Mo (ppm)

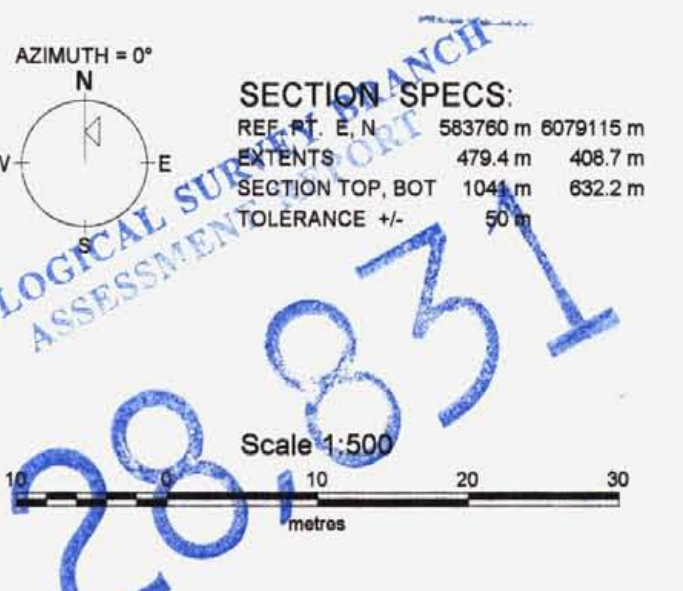

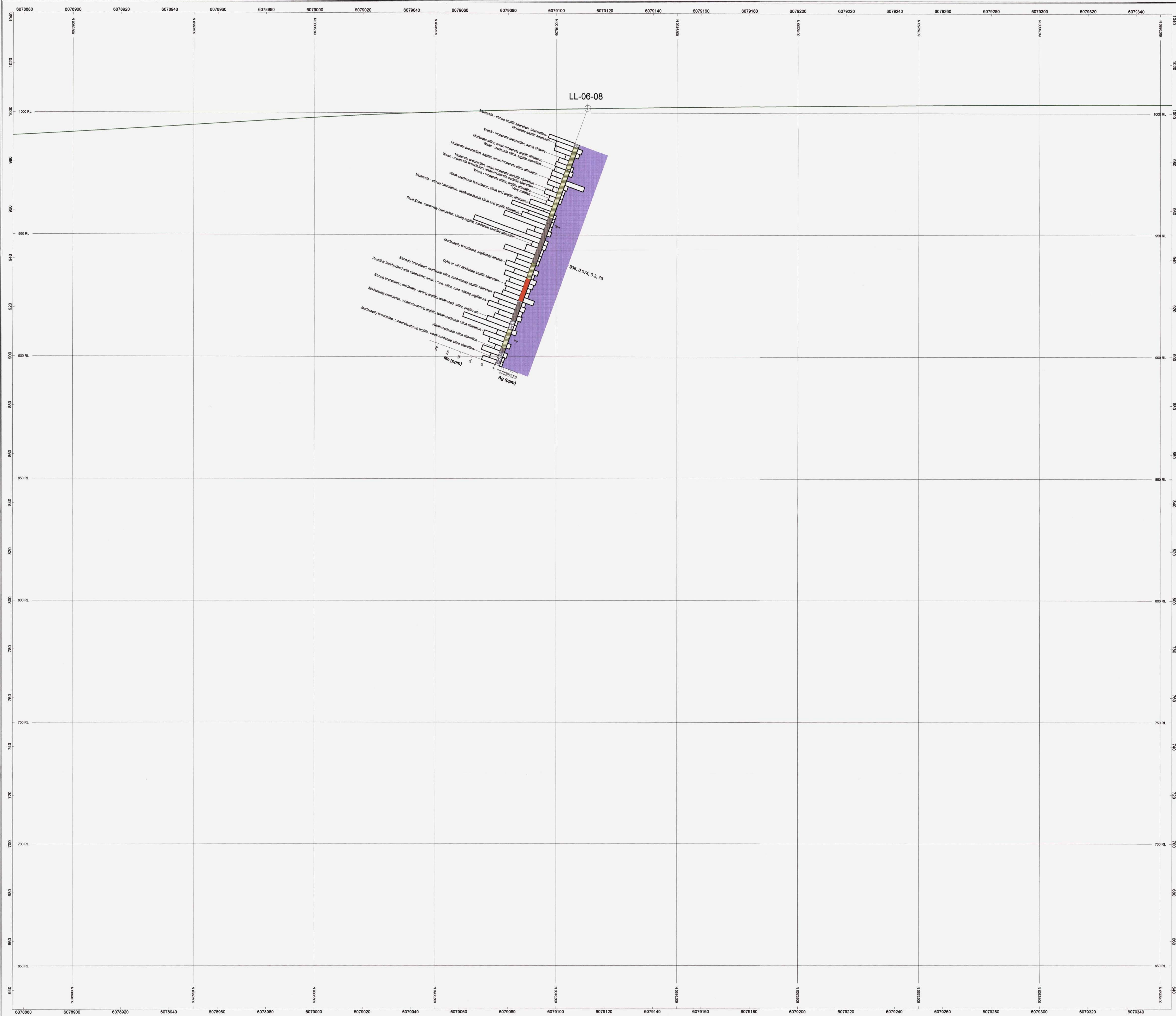

LEGEND:

LABEL	DESCRIPTION
FP-AZT	Feldspar-Porphyrific-Monzonite
HET-CAGL	Heterolithic-Conglomerate
CVB	Overburden
SDST	Sandstone
SLST	Siltstone

COMPOSITE VALUES: Cu (ppm)

Red	> 3000 ppm (Cu)
Green	1800 - 3000 ppm (Cu)
Blue	< 1800 ppm (Cu)

COMPOSITE VALUES: Cu (ppm)

2389, 0.134, 1.2, 63
Cu (ppm), Au (ppm), Ag (ppm), Mo (ppm)

HISTOGRAM LEGEND:

SECTION SPECS

REF. PT. E N 6079115 m
 EXTENTS 479.4 m 408.7 m
 SECTION TOP BOT 1041 m 932.2 m
 TOLERANCE ± 50 m

Scale 1:500

NORTH AMERICAN GEMS INC.
LOUISE LAKE PROJECT
FIGURE 12B-LL-06-08 DRILL SECTION (Mo-Ag)
 Title: N093082 Mining District: Orinaca
 Datum: NAD83 Projection: Zone 9
 Date: January 23rd 2007 Job: NAG-7502-BC
 Drafted By: L. Blackburn
AURORA GEOSCIENCES LTD.

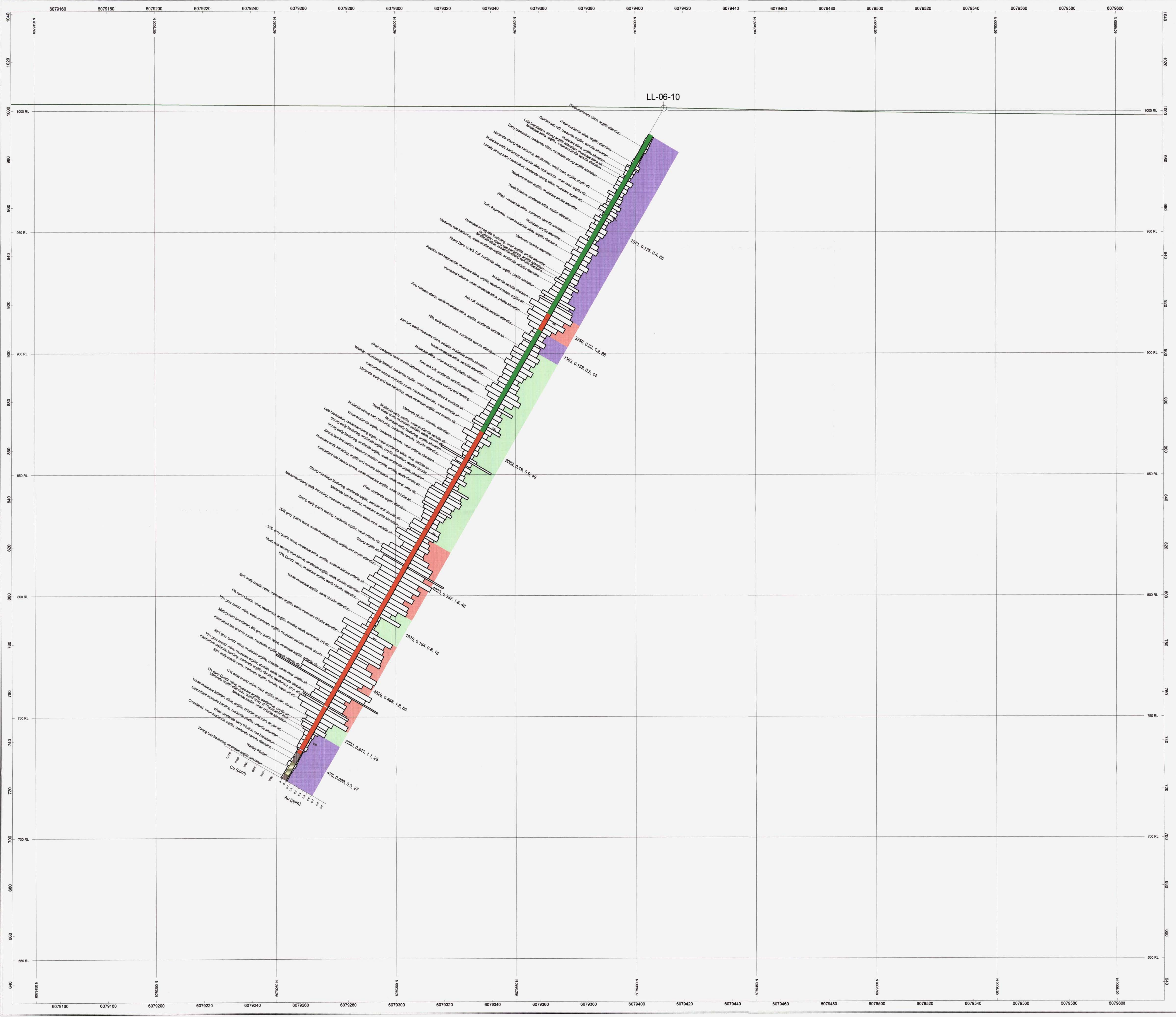

LEGEND:

LABEL	DESCRIPTION
DAC-AND-TUF	Dacite-and-tuff
FMZT	Felsic tuff
MYL-FLT-ZH	Mylonite-Fault-Zone
CVB	Chert
SDST	Sandstone
SLST	Siltstone

COMPOSITE VALUES: Cu (ppm)

Red	> 3000 ppm (Cu)
Light Green	1500 - 3000 ppm (Cu)
Dark Green	< 1500 ppm (Cu)

COMPOSITE VALUES LEGEND:

2389, 0.134, 1.2, 63
 Cu (ppm), Au (ppm), Ag (ppm), Mo (ppm)

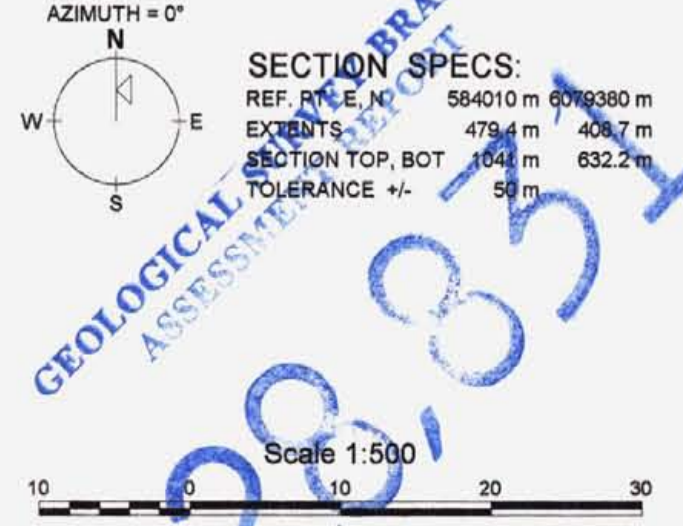
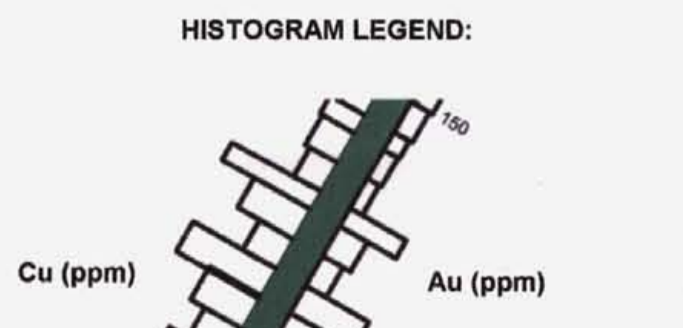

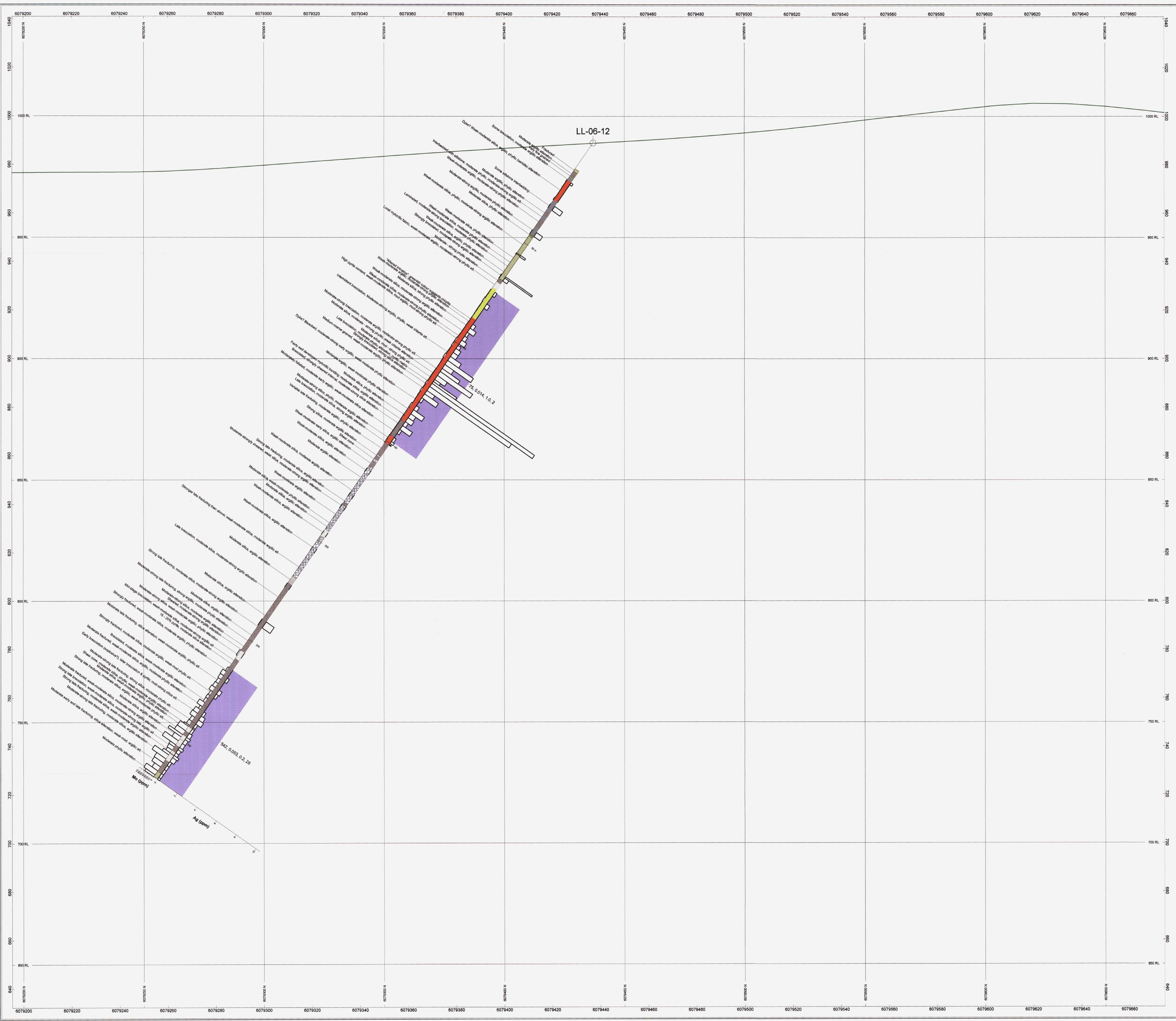

LEGEND:

LABEL	DESCRIPTION
AGLT	Argillite
AGLT-SDST	Argillite-Sandstone
AGLT-SILT	Argillite-Siltstone
FLC-DK	Felsic-Diabase
FP-MET	Felsic-Porphyr-Monzonite
HET-CHGL	Hematite-Conglomerate
OVIS	Oxide
SDST	Sandstone
SILT	Siltstone
SILT-SDST	Siltstone-Sandstone

COMPOSITE VALUES: Cu (ppm)

> 3000 ppm (Cu)	Red
1000 - 3000 ppm (Cu)	Orange
< 1000 ppm (Cu)	Green

COMPOSITE VALUES LEGEND:

288	0.134	1.2	83
Cu (ppm)	Au (ppm)	Ag (ppm)	Mo (ppm)

HISTOGRAM LEGEND:

Mo (ppm) Ag (ppm)

SECTION SPECS:
 REF. FT. E. N. 83335 m 6079435 m
 EXTENTS 17.4 m 49.7 m
 SECTION THICKNESS 104 m 652.2 m
 TOLERANCE 50 m

Scale 1:500

Geological Survey of Canada Assessment Report

2883

NORTH AMERICAN GEMS INC.
 LOUISE LAKE PROJECT
 FIGURE 16B-LL-06-12 DRILL SECTION (Mo-Ag)
 Trim: N283082 Mining District: Omineca
 Datum: NAD83 Projection: Zone 8
 Date: January 23rd 2007 Drafted By: L. Blackburn
 AURORA GEOSCIENCES LTD.