



Ministry of Energy and Mines
Energy and Minerals Division
Mineral Titles Branch

MINERAL TITLES BRANCH
Rec'd.
APR 23 2007
L.I.# _____
File _____
VANCOUVER, B.C. TITLES
VICTORIA, B.C.
APR 18 2007
FILE NO. _____
LOG IN NO. _____

OFFICE USE ONLY
EVENT NO. _____
Gold Commissioner Approval of
Physical Work: _____

STATEMENT OF WORK, CASH PAYMENT, RENTAL

Mineral Tenure Act
Sections 29, 30, 31, 33 and 50

Type of Title: Mineral Placer

Mining Division: ALBERNI

1. PAUL SAULNIER
(Name)
6144 MARGOT RD
(Address)
PORT ALBERNI BC
1194 856 724-1309
(Postal Code) (Telephone)
Client Number 123745

Agent for _____
(Names of all recorded holders)

(Address)

(Postal Code) (Telephone)
Client Number _____

**If recording work, complete the following and continue onto Page 3.
If paying cash in lieu of work or lease rental, turn to (and complete) Page 4.**

List the titles (claim name, lease, tenure number, crown grant lot) on which the work specified below was actually done:

Date work started _____ completed _____ WORK PERMIT No. _____

TYPE OF WORK AND TOTAL VALUE FOR EACH TYPE BEING CLAIMED ON THIS STATEMENT

Physical Refer to Page 2 for claimable physical work types and requirements \$ 640. A
Technical Prospecting \$ 100. B
Geological, Geochemical, Geophysical, and/or Diamond Drilling \$ 415.00 C
Portable Assessment Credit (PAC) Withdrawal (Box D)
either 30% of value in Box B & C only
or Total PAC \$ _____ D

from the account(s) of: _____

TOTAL VALUE OF WORK (Complete Page 3) A + B + C + D = E \$ 1155 E

PHYSICAL WORK

When claiming exploration and development costs for trenches, open cuts, adits, pits, shafts, panning and sluicing (placer only), reclamation, and road and trail construction, the following details must be provided on separate pages and attached to this Statement:

- (a) an accurate map showing the location of the claimed physical work relative to the boundaries and legal corner post of a 4 post mineral claim or the boundaries and legal posts of a 2 post mineral claim or placer claim, or the boundaries of a lease or crown granted mineral claim;
- (b) metric dimensions of all workings, trenches, open cuts, adits, pits and shafts;
- (c) the amount of material removed from the ground of the title and tested or processed;
- (d) the length and width of a road, in metric measure, together with details of how the road or trail was constructed or improved, and the manpower, equipment and machinery used;
- (e) metric dimensions of an airstrip or heliport must be stated, together with full details of how it was constructed; and
- (f) a fully-itemized cost statement where costs for labour (wages), food and accommodation, transportation, rental or operation of machinery, equipment and/or instruments is being claimed. Receipts are not required but must be provided if requested by the Gold Commissioner.

Ground control surveys, line-cutting or grid establishment, and topographic and/or photogrammetric mapping, when done in preparation for a geological, geophysical or geochemical survey or diamond drilling work, may be submitted separately as physical work. The following details must be attached to this Statement at the time of submission for recording if this work is recorded separately as physical work:

- (a) for a control survey, an accurate traverse map must be submitted, the survey method must be stated and described, and the procedure shown or described by which the survey was tied to an accurately located reference point related to claim boundaries;
- (b) for linecutting, the specifications must be stated, and the lines shown on a map in relation to the claims and to identifiable geographic features which will relate it to an index map. New grid must be clearly distinguished from any pre-existing grid. A geological, geophysical or geochemical map showing the grid, claims and geographic features will serve as a grid map; and
- (c) for topographic or photogrammetric mapping, the map must be submitted including the names of the firm or individuals who prepared it and claim boundaries and survey grids must be superimposed on the topographic map.

Global Positioning System surveys of a mineral or placer claim may be submitted for physical work credits. A report in compliance with the standards and guidelines for undertaking a Global Positioning System survey established by the Mineral Titles Branch must be submitted either with this Statement of Work or subsequently, but no later than 30 days after the anniversary date of the claim.

Surveys carried out by a British Columbia Land Surveyor may be submitted for physical work credits provided a copy of the survey plan is attached to this Statement.

Archaeological Impact Assessment Study may be submitted for physical work credits according to the provisions in the Regulation. A copy of the approved Study Report must be submitted with the prescribed form under section 29 of the Act.

TECHNICAL WORK

Requires a technical assessment report prepared by a qualified person and in accordance with the applicable requirements in the sections of Part C of the Mineral Act Regulation (BC Reg 587/77) referenced below. The report must be received within 90 days of the first anniversary date on this Statement that occurs on or immediately following the recording date of this Statement.

The section numbers listed below refer to sections set out in Part C of the Mineral Act Regulation.

GEOLOGICAL: Sections 1 - 4 and 5

GEOPHYSICAL: Sections 1 - 4 and 6

GEOCHEMICAL: Sections 1 - 4 and 7

DIAMOND DRILLING: Sections 1 - 4 and 8

PROSPECTING: Sections 1 - 4 and 9

WORK CREDITS APPLIED TO CLAIMS

EVENT NUMBER: _____

I wish to apply \$ 1234 of the total value in Box E (from Page 1) as follows:

Claim Name (one claim per line)	Tenure Number	No. of Units*	Expiry Date	Work to be applied		Recording Fee	New Expiry Date
				Value	Years		
HV#1	505357	8	2007		1		2008 Post
TOTALS							

* 2 Post, Fraction, Rev. Crown Grant and Placer Claims are one unit each.

NOTICE TO GROUP / CAD EVENT NUMBER: _____ RECORDED _____

Value of work to be credited to portable assessment credit (PAC) account(s).		
(May only be credited from the approved value of Box C not applied to claims.)		
	Name	Amount
Name of owner/operator	1. _____	\$ _____
	2. _____	\$ _____

I, the undersigned Applicant, hereby confirm that the information is supplied and the credits are claimed in accordance with the requirements in the Mineral Tenure Act, the Mineral Tenure Act Regulation, and the Mineral Act Regulation. I hereby acknowledge and understand that it is an offence to knowingly provide false information under the *Mineral Tenure Act*. I acknowledge and understand that if the statements made, or information given, in this Statement of Work are found to be false and the exploration and development has not been performed, then the work reported on this Statement will be cancelled and the subject mineral or placer claims(s) may, as a result, forfeit and vest back to the Province under section 35 of the *Mineral Tenure Act*.

Date

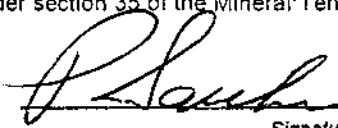
Signature of Applicant

CASH IN LIEU OF WORK OR LEASE RENTAL

EVENT NUMBER: _____

Claim Name (one claim per line)	Tenure Number	No. of Units*	Expiry Date	Cash in Lieu	Recording Fee	Lease Rental	New Expiry Date
* 2 Post, Fraction, Rev. Crown Grant and Placer Claims are one unit each.				TOTALS			

Date

Signature of Applicant

Internet Mapping Framework

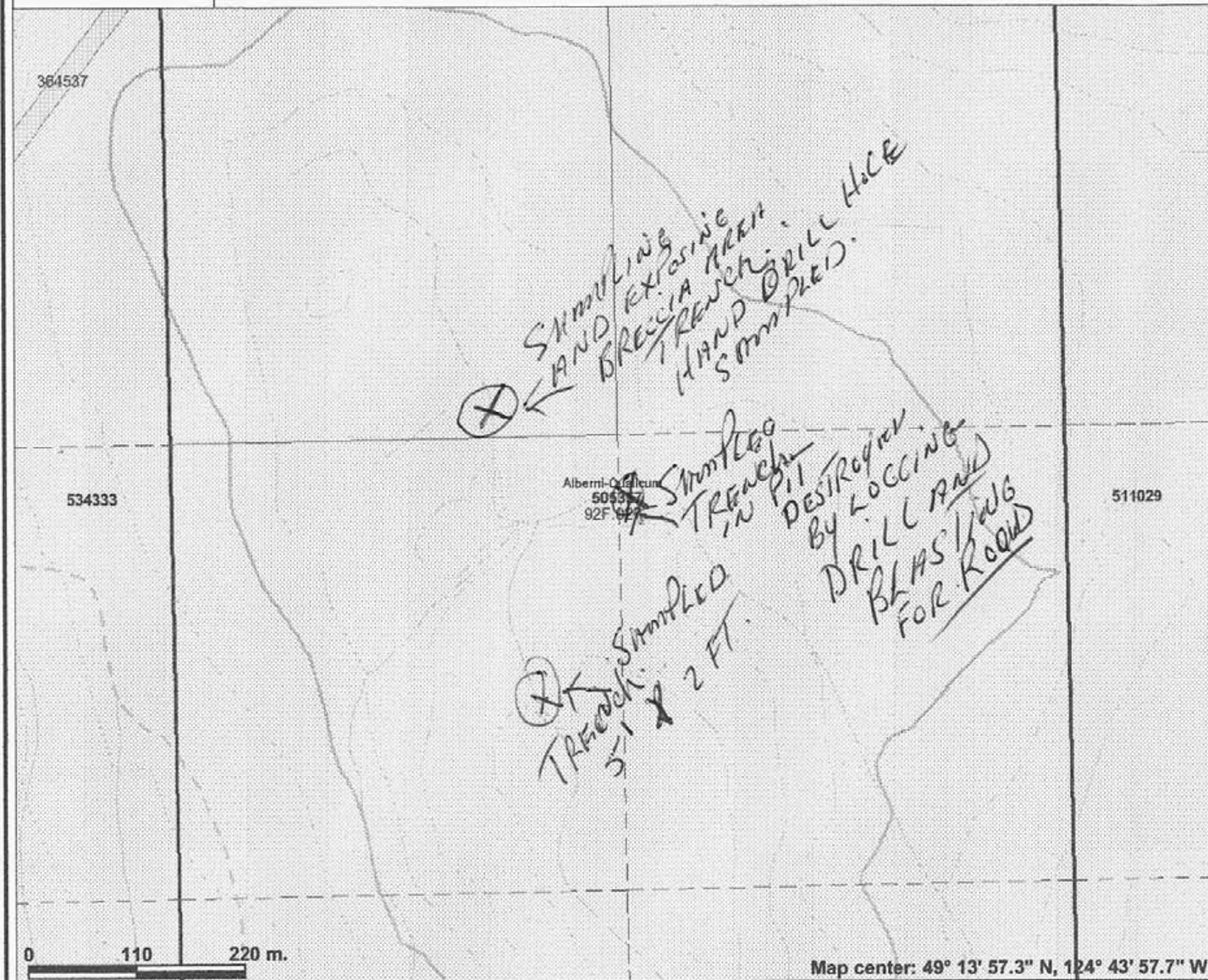

Legend

- Indian Reserves
- National Parks
- Parks
- Mineral Titles Grid (MTO)
- Mineral Tenures (Mineral - MTO)
- Mineral Claim
- Mineral Lease
- Reserves (Mineral - MTO Sites)**
- Placer Claim Designation
- Placer Lease Designation
- No Staking Reserve
- Conditional Reserve
- Release Required Reserve
- Surface Restriction
- Recreation Area
- Others
- Mining Division (MTO)
- Integrated Cadastral Fabric
- BCGS Grid
- Contours (TRIM)
- Contour - Index
- Contour - Index.Indefinite
- Contour - Index.Depression
- Contour - Index.Depression Indefinite
- Contour - Intermediate
- Contour - Intermediate.Indefinite
- Contour - Intermediate.Depression
- Contour - Intermediate.Depression Indefinite
- Area of Exclusion
- Area of Indefinite Contours
- Annotation (1:20K)
- Transportation - Points (TRIM)

Scale: 1:6,109

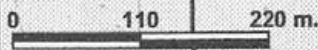

Map center: 49° 13' 57.3" N, 124° 43' 57.7" W

This map is a user generated static output from an Internet mapping site and is for general reference only. Data layers that appear on this map may or may not be accurate, current, or otherwise reliable. THIS MAP IS NOT TO BE USED FOR NAVIGATION.

GEOCHEMICAL Soil SAMPLING 2 LINES 8 SAMPLES TO TEST

Internet Mapping Framework

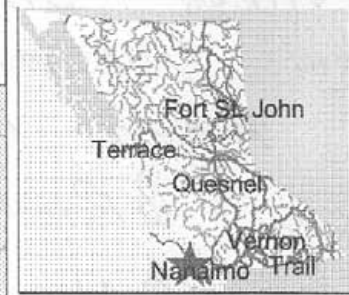

GOLD
ANKERITE
EXPOSURE
RESULTS
BAD IN
GOLD.

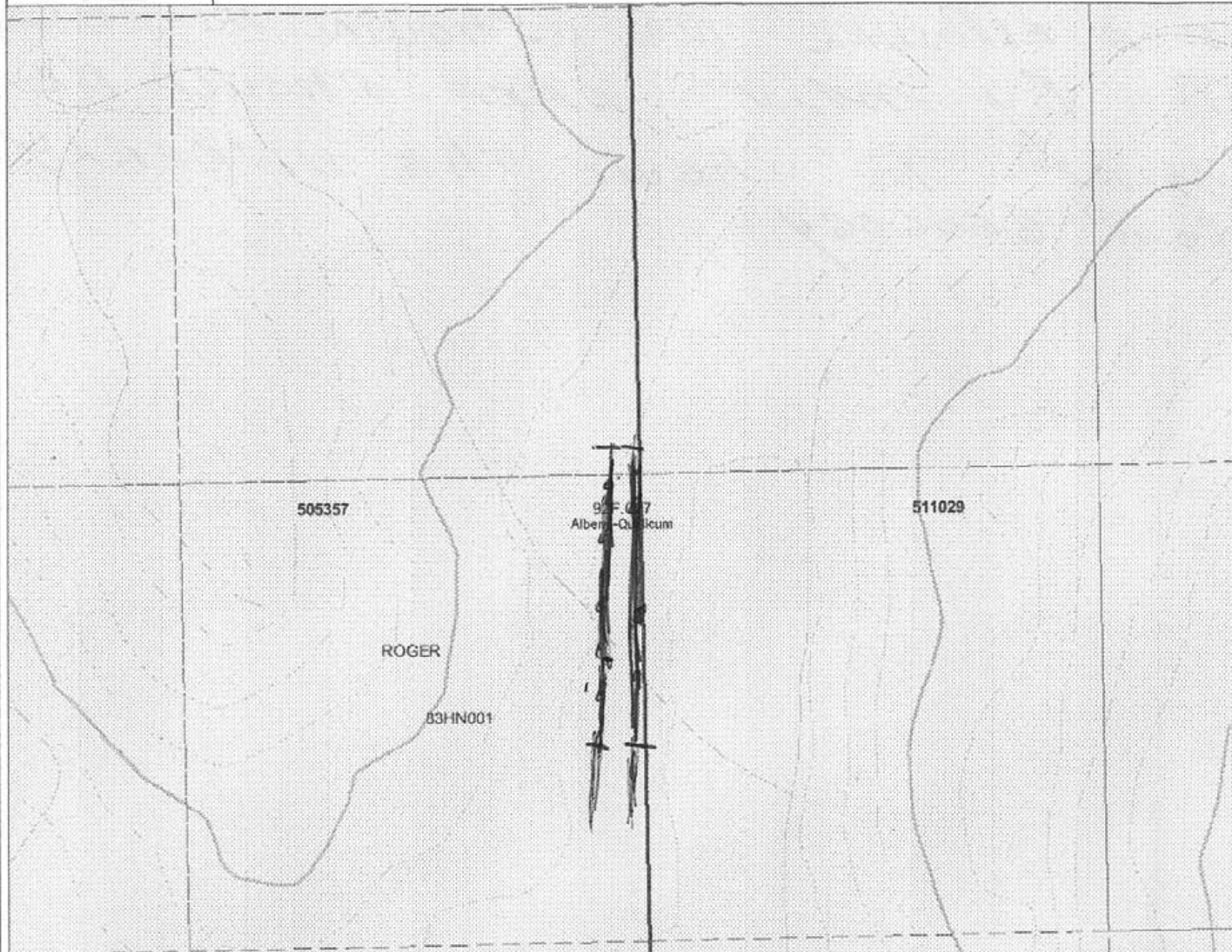

Legend

- Indian Reserves
- National Parks
- Parks
- Mineral Titles Grid (MTO)
- Mineral Tenures (Mineral - MTO)
- Mineral Claim
- Mineral Lease
- Reserves (Mineral - MTO Sites)
- Placer Claim Designation
- Placer Lease Designation
- No Staking Reserve
- Conditional Reserve
- Release Required Reserve
- Surface Restriction
- Recreation Area
- Others
- Mining Division (MTO)
- Integrated Cadastral Fabric
- BCGS Grid
- Contours (TRIM)
- Contour - Index
- Contour - Index.Indefinite
- Contour - Index.Depression
- Contour - Index.Depression Indefinite
- Contour - Intermediate
- Contour - Intermediate.Indefinite
- Contour - Intermediate.Depression
- Contour - Intermediate.Depression Indefinite
- Area of Exclusion
- Area of Indefinite Contours
- Annotation (1:20K)
- Transportation - Points (TRIM)

0 110 220 m.

Map center: 49° 13' 43.3" N, 124° 43' 35.8" W



Scale: 1:6,109

This map is a user generated static output from an Internet mapping site and is for general reference only. Data layers that appear on this map may or may not be accurate, current, or otherwise reliable. THIS MAP IS NOT TO BE USED FOR NAVIGATION.

1000 mts. IN TOTAL SAMPLING DONE BY MAMI
SPOT CHECK SAMPLING DONE ON LINE ACROSS
SICKER VOLCANICS AND ANKERITE EXPOSURE
THIS AREA IS A EXPOSURE NOT SHOWN AS THE
SICKER GROUP BY MIN AREA SHOULD BE
REVISED ON MAP TO SHOW THE UNDERLY
OF SICKER GROUP GEOLOGY.

Receipt

ALS CHEMEX
 ALS Canada Ltd.
 212 Brooksbank Avenue
 North Vancouver BC
 V7J 2C1

604-984-0221
www.alschemex.com

Transaction Type: Purchase

Order ID:	mvt5825974620	Card Number:	**** * 8017
Card Type:	VISA	Approval Code:	443484
Date/Time:	Sep 14 2006 11:49AM	Response / ISO Code:	27/1
Sequence Number:	660659640013670070 M	Message:	APPROVED * =
Amount :	143.52		

Customer ID:

Order Information			
Qty	Item	Description	Amount
	1430086	VA06076546 - RTS	143.52
			Total: 143.52 \$CAD

Purchaser Information

Bill To:

Paul Saulnier

 tel:
 fax:

Ship To:

tel:
 fax:

Special Instructions

E-Mail Address:

Refund Policy



Certificate of Analysis

Work Order: 091453

Date: Dec 28, 2006

To: Attn: Paul A. Saulnier
Prospector
6144 Margot Rd.
PORT ALBERNI
BC V9Y 8S6

P.O. No. : PAUL SAULNIER
Project No. : DEFAULT
No. Of Samples : 25
Date Submitted : Nov 27, 2006
Report Comprises : Pages 1 to 6
(Inclusive of Cover Sheet)

Distribution of unused material:

2

Handwritten notes:
SGS 2721
ALS change 14352
415.52
34
x 8
272.

Certified By : 
Stuart Lam
Operations Manager

14352

ISO 9002 REGISTERED
ISO 17025 Accredited for Specific Tests. SCC No. 456

Report Footer: L.N.R. = Listed not received I.S. = Insufficient Sample
n.a. = Not applicable -- = No result
*INF = Composition of this sample makes detection impossible by this method
M after a result denotes ppb to ppm conversion. % denotes ppm to % conversion
Methods marked with an asterisk (e.g. *NAA08V) were subcontracted

Subject to SGS General Terms and Conditions

The data reported on this certificate of analysis represents the sample submitted to SGS Minerals Services. Reproduction of this analytical report, in full or in part, is prohibited without prior written approval.

Element Method	W	Y	Yb	Zn	Zr
Det.Lim.	MMI-M5	MMI-M5	MMI-M5	MMI-M5	MMI-M5
Units	1	5	1	20	5
	PPB	PPB	PPB	PPB	PPB
AREA-A-1	3	79	5	60	79
AREA-A-2	1	296	20	630	9
AREA-A-3	<1	<5	2	170	24
AREA-A-4	<1	46	4	610	53
AREA-A-5	<1	184	10	990	18
AREA-A-6	<1	44	3	230	19
AREA-A-7	<1	247	17	70	39
AREA-A-8	<1	106	7	380	39
AREA-B-LINE 1 ZONE-0+25	<1	<5	<1	230	<5
AREA-B-LINE 1 ZONE-0+275	<1	18	1	390	<5
AREA-B-LINE 1 ZONE-0+450	<1	9	<1	200	20
AREA-B-LINE 1 ZONE-0+775	<1	21	1	130	17
AREA-B-LINE 2 ZONE-0+00W	<1	7	<1	500	8
AREA-B-LINE 2 ZONE-0+200W	<1	15	1	350	12
AREA-B-LINE 2 ZONE-0+375W	<1	8	<1	240	10
AREA-B-LINE 2 ZONE-0+400W	<1	171	10	270	9
AREA-B-LINE 2 ZONE-0+475W	<1	12	<1	210	25
AREA-B-LINE 2 ZONE-0+500W	<1	7	<1	150	10
AREA-B-LINE 2 ZONE-0+600W	<1	45	3	750	23
AREA-B-LINE 2 ZONE-0+800W	<1	37	2	880	11
AREA-B-LINE 3 ZONE-0+25N	<1	<5	<1	290	7
AREA-B-LINE 3 ZONE-0+175N	<1	8	<1	140	51
AREA-B-LINE 3 ZONE-0+400N	<1	11	<1	600	9
AREA-B-LINE 3 ZONE-0+475N	<1	16	1	80	42
AREA-B-LINE 3 ZONE-0+775N	<1	118	8	130	6
*Dup AREA-A-1	<1	105	7	80	81
*Dup AREA-B-LINE 2 ZONE-0+00W	<1	9	<1	550	6
*Dup AREA-B-LINE 3 ZONE-0+775N	<1	107	8	120	10

FOR GOLD
 8 X 34.00
 PER SAMPLE
 TOTAL COST
 \$272.00
 \$272.00
 \$272.00

The data reported on this certificate of analysis represents the sample submitted to SGS Minerals Services. Reproduction of this analytical report, in full or in part, is prohibited without prior written approval.

COST SHEET FOR HV #1 CLAIM #505357
PHYSICAL WORK \$640.00 32 manhours. 20.00 PER HOUR.
GEOCHEMICAL SAMPLING, GRID, TRENCHING, AND
DRILLING FOR SAMPLING, PROSPECTING \$400.00

COST FOR SAMPLING = 415.52

TRACKING GAS - 60.00

MISCELLANEOUS

20.00 -

FLAGGING MATERIAL
HIP CHAIN. STRING ETC.

640

415

60

20

TOTAL 1235