

29297 Vol. 2

PLUS UP TO
100
PAGES

7030



APPENDIX 3

DRILL SAMPLE RESULTS

**GEOLOGICAL SURVEY BRANCH
ASSESSMENT REPORT**

29,297

MINERAL TITLES BRANCH
Rec'd.
SEP 7 - 2007
L.I.# _____
File VANCOUVER, B.C.

ACME ANALYTICAL LABORATORIES LTD. (ISO 9001 Accredited Co.)		832 E. HASTINGS ST. VANCOUVER BC V6A 1R6		PHONE (604) 253-3158 FAX (604) 253-1916	
ASSAY CERTIFICATE					
BIM Resources Inc. FILE # A5C2802R2 Page 1		809 W. Beach St., Vancouver BC V6B 2V6 Submitted by: Bob K. Gorse			
SAMPLE#	Mo %	Ca %	Ag** gm/mt	As** gm/mt	
G-1	4.001	0.001	42	<.01	
405533	4.001	0.024	42	<.01	
405533	4.001	0.021	42	<.01	
405533	4.001	0.014	42	<.01	
405533	4.001	0.058	42	<.01	
405533	0.061	0.017	42	<.01	
405533	0.062	0.131	42	<.01	
405533	4.001	0.117	42	<.01	
405533	4.001	0.024	42	<.01	
405533	4.001	0.054	42	<.01	
405533	4.001	0.019	42	<.01	
405533	4.001	0.021	42	<.01	
405533	4.001	0.029	42	<.01	
405533	0.062	0.026	42	<.01	
405533	4.001	0.027	42	<.01	
405533	4.001	0.030	42	<.01	
405533	4.001	0.013	42	<.01	
405533	4.001	0.014	42	<.01	
405533	4.001	0.013	42	<.01	
405533	4.001	0.010	42	<.01	
405533	4.001	0.018	42	<.01	
405533	4.001	0.011	42	<.01	
RS 405563	4.001	0.010	42	<.01	
405533	4.001	0.010	42	<.01	
405533	4.001	0.004	42	<.01	
405533	4.001	0.008	42	<.01	
405533	4.001	0.020	42	<.03	
405533	4.001	0.015	42	<.01	
405533	4.001	0.010	42	<.01	
405533	4.001	0.009	42	<.01	
405533	4.001	0.009	42	<.01	
405533	4.001	0.006	42	<.01	
405533	4.001	0.001	42	<.01	
405533	4.001	0.001	42	<.01	
STANDARD R-2a/OxL14	0.050	0.570	160	5.83	

PREP 710 - 0.500 GR SAMPLE, 4 ACID (HF-HClO4-HNO3-HCl) DIGESTION TO 100 ML, ANALYSIS BY ICP-ES.
 AG** & AS** BY FIRE ASSAY FROM A.T. SAMPLE.
 - SAMPLE TYPE: Core Rej. P103 Samples beginning 'RE' are Recons and 'RSE' are Recons Samples.

Data FA DATE RECEIVED: JUL 17 2006 DATE REPORT MAILED: 2006-07-27 11:25



All results are considered the confidential property of the client. Acme assumes the liabilities for actual cost of the analysis only.

AA 100% PURE		TM Resources Inc. FILE # A602802RE		Page 2		AA 100% PURE	
SAMPLE#	Mo %	Cu %	Ag** gm/mt	Au** gm/mt			
4055378	.001	.0066	AN	.01			
4055380	.001	.0066	AN	.01			
4055382	.001	.0062	AN	.01			
4055383	.002	.0095	AN	.01			
4055384	.001	.025	AN	.01			
4055385	.001	.010	AN	.01			
4055386	.001	.003	AN	.01			
4055387	.001	.001	AN	.01			
RE 4055607	.001	.001	AN	.01			
4055688	.001	.007	AN	.01			
4055689	.001	.010	AN	.01			
4055690	.001	.013	AN	.01			
4055691	.001	.016	AN	.01			
4055692	.001	.012	AN	.01			
STANDARD R-2a/OxL34	.049	.576	161	5.76			

Sample type: Core Rej. P150. Samples beginning 'RE' are Returns and 'RRE' are Reject Returns.

All results are considered the confidential property of the client. Acme assures the liabilities for actual cost of the analysis only. Date: 8/82

ACME ANALYTICAL LABORATORIES LTD. 852 F. BASTINGS ST. VANCOUVER BC V6A 1R6 PHONE (604) 253-3158 FAX (604) 253-1716 (ISO 9001 Accredited Co.)	
ASSAY CERTIFICATE	
LTD. ASSOCIATES LTD. 4000028 PRC 200 W. 10th St. Vancouver BC V6A 1A5 Analyzed by: JH	
SAMP.#	VO K
405531	<.001
405532	<.001
405533	<.001
405534	<.001
405535	<.001
RE 405535	<.001
405536	.002
405537	<.001
405538	<.001
405539	<.001
405540	<.001
405541	<.001
405542	<.001
405543	<.001
405544	<.001
405545	<.001
405546	<.001
405547	<.001
405548	<.001
405549	<.001
405550	<.001
405551	<.001
405552	<.001
405553	<.001
405554	<.001
405555	<.001
405556	<.001
405557	<.001
405558	<.001
405559	<.001
405560	<.001
405561	<.001
405562	<.001
405563	<.001
405564	<.001
405565	<.001
405566	<.001
405567	<.001
405568	<.001
405569	<.001
405570	<.001
405571	<.001
405572	<.001
405573	<.001
405574	<.001
405575	<.001
405576	<.001
405577	<.001
405578	<.001
405579	<.001
405580	<.001
405581	<.001
405582	<.001
405583	<.001
405584	<.001
405585	<.001
405586	<.001
405587	<.001
405588	<.001
405589	<.001
405590	<.001
405591	<.001
405592	<.001
405593	<.001
405594	<.001
405595	<.001
405596	<.001
405597	<.001
405598	<.001
405599	<.001
405600	<.001
STANDARD R-2R	.046

DRUM TOP - 0.500 gm SAMPLE BY PHOSPHORIC ACID LEACH, ANALYSIS BY ICP-MS.
 * SAMPLE TYPE: Core Pulp
 SAMPLE CONTAINING 'RE' ARE AS-MADE AND 'RM' ARE REWORK SAMPLES.

Date 6/27/06 DATE RECEIVED: JUN 27 2006 DATE REPORT MAILED: 07-04-2006 10:36

All results are considered the confidential property of the client. Acme assumes the liability for actual cost at the analysis only.



AA LL ONE MILLION	TFM Resources Inc. FILE # A602802R	Page 2	AA LL ONE MILLION
SAMPLE#		Mo	t
405676		4	.001
405677		4	.001
405678		4	.001
405679		4	.001
405680		4	.001
405681		4	.001
405682		4	.001
405683		4	.001
RE 405683		4	.001
405684		4	.001
405685		4	.001
405686		4	.001
405687		4	.001
405688		4	.001
405689		4	.001
405690		4	.001
405691		4	.001
405692		4	.001
STANDARD R 2a			.049

Sample type: Core Pulp. Samples beginning 'RE' are Reruns and 'REE' are Reject Reruns.

All results are considered the confidential property of the client. TFM assumes the responsibility for actual cost of the analysis only.

DATA *h* PA

ACME ANALYTICAL LABORATORIES LTD. 4520 G. BASTINGS ST. VANCOUVER BC V6A 1R6 PHONE (604) 298-3158 FAX (604) 298-1776	
ABSAY CERTIFICATE	
TFM Resources Inc. File # 4553018 Page 1	
SAMPLE#	Mo % W Sample % Kg
G-1	<.001 <.01
405688	<.001 <.01
405699	<.001 <.01
405700	<.001 <.01
405701	<.001 <.01
405702	<.001 <.01
405703	<.001 <.01
405704	<.001 <.01
405705	<.001 <.01
405706	<.001 <.01
405707	<.001 <.01
405708	<.001 <.01
405709	<.001 <.01
405710	<.001 <.01
405711	<.001 <.01
405712	<.001 <.01
405713	<.001 <.01
RE 405713	<.001 <.01
RMB 405713	<.001 <.01
405714	<.001 <.01
405715	<.001 <.01
405716	<.001 <.01
405717	<.001 <.01
405718	<.001 <.01
405719	<.001 <.01
405720	<.001 <.01
405721	<.001 <.01
405722	<.001 <.01
405723	<.001 <.01
405724	<.001 <.01
405725	<.001 <.01
405726	<.001 <.01
405727	<.001 <.01
405728	<.001 <.01
405729	<.001 <.01
STANDARD R-2a	.052 .08

GROUP 700 - 0.500 GR SAMPLE BY PHOSPHORIC ACID LEADS, ANALYSIS BY ICP-MS.
 - SAMPLE TYPE: Drill Core X30
 Samples beginning 'RE' are Retest and 'RMB' are Reject Returns.

Date: 6 FA DATE RECEIVED: JUN 23 2006 DATE REPORT MAILED: 07-05-2006 P04:40

All results are considered the confidential property of the client. Acme assumes the liabilities for actual cost of the analysis only.



ACME ANALYTICAL LABORATORIES LTD. (LTD 3001 Accredited Co.)		852 B. HASTINGS ST. VANCOUVER BC V6A 1R6		PHONE (604) 253-3358 FAX (604) 253-1716	
ASSAY CERTIFICATE					
T.M. Resources Inc. 216 W. 40th St. Regina, Sask. S4S 0A1					
SAMPLE#	Mo	W	Sample		
	g	g	Kg		
3-1	.001	<.01			
405698	.001	<.01	3.06		
405699	.001	<.01	1.97		
405700	.001	<.01	2.35		
405701	.001	<.01	2.41		
405702	.001	<.01	3.16		
405703	.001	<.01	3.58		
405704	.001	<.01	4.10		
405705	.001	<.01	4.22		
405706	.001	<.01	4.51		
405707	.001	<.01	3.12		
405708	.001	<.01	4.25		
405709	.001	<.01	4.11		
405710	.001	<.01	3.95		
405711	.001	<.01	3.95		
405712	.001	<.01	2.71		
405713	.001	<.01	3.85		
RE 405713	.001	<.01			
RMB 405713	.001	<.01			
405714	.001	<.01	5.17		
405715	.001	<.01	5.22		
405716	.001	<.01	4.95		
405717	.001	<.01	4.33		
405718	.001	<.01	3.85		
405719	.001	<.01	3.85		
405720	.001	<.01	4.87		
405721	.001	<.01	4.11		
405722	.001	<.01	4.25		
405723	.001	<.01	3.91		
405724	.001	<.01	4.6		
405725	.001	<.01	3.37		
405726	.001	<.01	4.25		
405727	.001	<.01	4.13		
405728	.001	<.01	4.85		
405729	.001	<.01	4.87		
STANDARD R-2a	.052	.08	-		

GROUP 725 - 0.500 GR SAMPLE BY PHOSPHORIC ACID LEAD, ANALYSIS BY ICP-MS.
 - SAMPLE TYPE: Drill Core #20
 Samples analyzed by ICP-MS. Results and 1387 are select results.

07-05-2006 09:40

Date: 6 VA DATE RECEIVED: JUN 23 2006 DATE REPORT MAILED:



All results are considered the confidential property of the client. Acme assumes the liabilities for actual cost of the analysis only.

AA ANALYTICAL		TTH Resources Inc. FILE # A600018	Page 3	AA ANALYTICAL	
SAMPLE#	Mo t	N	Sample t		
G-1	<.001	<.01	-		
405762	<.001	<.01	5.83		
405763	<.001	<.01	4.83		
405764	<.001	<.01	7.96		
405765	<.001	<.01	6.53		
RE 405765	<.001	<.01	-		
RE 405765	<.001	<.01	-		
405766	<.001	<.01	5.92		
405767	<.001	<.01	6.43		
405768	<.001	<.01	5.71		
405769	<.001	<.01	5.65		
405770	<.001	<.01	5.71		
405771	<.002	<.01	6.83		
405772	<.001	<.01	7.23		
405773	<.001	<.01	7.13		
405774	<.001	<.01	6.86		
405775	<.001	<.01	6.73		
405776	<.001	<.01	6.94		
405777	<.001	<.01	7.02		
405778	<.001	<.01	5.23		
STANDARD R-2a	.050	.08	-		

Sample type: Drill Core R150. Samples beginning 'RE' are Retuns and 'REE' are Reject Retuns.

All results are considered the confidential property of the client. Acme assumes the liability for actual cost of the analysis only. Data *KA*

ACME ANALYTICAL LABORATORIES LTD. (ISO 9001 Accredited Co.)		452 F. HASTINGS ST. VANCOUVER BC V6A 1R6		PHONE (604) 253-1158 FAX (604) 253-716	
ASSAY CERTIFICATE					
THE RESOURCES INC.					
SAMPLE#	Mo %	Cu %	kg** gm/mt	Au** gm/mt	Sample kg
G-1	.001	.001	.001	.001	-
405779	.001	.016	.001	.001	4.79
405780	.001	.014	.001	.001	4.79
405781	.001	.130	.001	.001	4.79
405782	.001	.023	.001	.001	4.79
405783	.001	.036	.001	.001	4.79
405784	.001	.016	.001	.001	4.79
405785	.001	.019	.001	.001	4.79
405786	.001	.024	.001	.001	4.79
405787	.001	.012	.001	.001	4.79
405788	.001	.053	.001	.001	4.79
405789	.001	.010	.001	.001	4.79
405790	.001	.022	.001	.001	4.79
405791	.001	.011	.001	.001	4.79
405792	.001	.016	.001	.001	4.79
405793	.001	.023	.001	.001	4.79
405794	.001	.044	.001	.001	4.79
405795	.001	.033	.001	.001	4.79
405796	.001	.008	.001	.001	4.79
405797	.001	.013	.001	.001	4.79
405798	.001	.056	.001	.001	4.79
405799	.001	.046	.001	.001	4.79
405800	.001	.039	.001	.001	4.79
405801	.001	.019	.001	.001	4.79
405802	.001	.015	.001	.001	4.79
405803	.001	.023	.001	.001	4.79
405804	.001	.011	.001	.001	4.79
405805	.001	.009	.001	.001	4.79
405806	.001	.012	.001	.001	4.79
405807	.001	.012	.001	.001	4.79
405808	.001	.008	.001	.001	4.79
405809	.001	.026	.001	.001	4.79
RE 405809	.001	.027	.001	.001	4.79
PR 405809	.001	.027	.001	.001	4.79
405810	.001	.019	.001	.001	4.79
STANDARD R-2a/OxL34	.047	.553	152	5.79	-

GROUP TRA - 1.000 GR SAMPLE, ANGA - REGIA (HCL-HNO3-H2O) DIGESTION TO 100 ML, ANALYSED BY ICP-ES.
 AC** & AU** BY FIRE ASSAY FROM 1 A.T. SAMPLE.
 SAMPLE TYPE: DRILL CORE R150

Samples containing 'RE' are Reagent and 'PR' are Reagent Standard.

07-22-2006 PC2:18

Data 6 FA

DATE RECEIVED: JUL 10 2006 DATE REPORT MADE:



All results are considered the confidential property of the client. Acme assumes the liabilities for actual cost of the analysis only.

AA KIMBERLY		TKM Resources Inc. FILE # A603497				Page 2		AA KIMBERLY	
SAMPLE#	Mo %	Cu %	Ag** gm/mt	Au** gm/mt	Sample	kg			
G-1	.001	.381	.022	.01		-			
405811	.001	.323	.022	.01	MIN	4.43			
405812	.001	.018	.022	.01		5.52			
405813	.001	.022	.022	.01		7.43			
405814	.001	.019	.022	.01		4.43			
405815	.001	.338	.022	.01		6.46			
405816	.001	.022	.022	.01		4.16			
405817	.001	.010	.022	.01		4.43			
405818	.001	.012	.022	.01		4.68			
405819	.001	.308	.022	.01		4.36			
405820	.001	.339	.022	.01		2.85			
405821	.001	.020	.022	.01		1.62			
405822	.001	.013	.022	.01		5.62			
405823	.001	.009	.022	.01		6.02			
405824	.001	.037	.022	.01		8.1			
405825	.001	.018	.022	.01		7.65			
405826	.001	.023	.022	.01		7.31			
405827	.001	.007	.022	.01		6.46			
405828	.001	.011	.022	.01		7.17			
405829	.001	.014	.022	.01		6.58			
405830	.001	.006	.022	.01		4.79			
405831	.001	.003	.022	.01		3.39			
405832	.001	.019	.022	.01		7.7			
405833	.001	.011	.022	.01		7.7			
405834	.001	.005	.022	.01		7.7			
RE 405834	.001	.305	.022	.01		-			
RRE 405834	.001	.305	.022	.01		-			
405835	.001	.007	.022	.01		5.02			
405836	.001	.010	.022	.01		7.69			
405837	.001	.009	.022	.01		6.66			
405838	.001	.004	.022	.01		7.02			
405839	.001	.018	.022	.01		6.02			
405840	.001	.007	.022	.01		6.02			
405841	.001	.048	.022	.01		6.02			
405842	.001	.021	.022	.01		6.02			
STANDARD R-2a/OxL34	.047	.568	153	5.76		-			

Sample type: DRILL CORE RISC. Samples beginning 'RE' are Returns and 'RRE' are Reject Returns.

All results are considered the confidential property of the client. ACRB assumes the liabilities for actual cost of the analysis only. Date 1/11

AA FOR ANALYSIS		TM Resources Inc. TILB # A693427				Page 3	AA FOR ANALYSIS
SAMPLE#	Mp %	Cu %	Ag** gm/mt	Au** gm/mt	Sample kg		
G-1	.001	.301	.42	.01	-		
405843	.001	.321	.42	.01	6.73		
405844	.001	.303	.42	.01	7.03		
405845	.001	.320	.42	.01	5.12		
405846	.001	.313	.42	.01	5.86		
405847	.001	.301	.42	.01	4.40		
405848	.001	.303	.42	.01	3.93		
405849	.001	.302	.42	.01	5.82		
405850	.001	.304	.42	.01	6.73		
405851	.001	.301	.42	.01	6.82		
405852	.001	.303	.42	.01	6.73		
405853	.001	.311	.42	.02	6.09		
405854	.001	.313	.42	.01	13.07		
405855	.001	.307	.42	.01	11.50		
405856	.001	.302	.42	.01	6.78		
405857	.001	.314	.42	.01	9.13		
405858	.001	.307	.42	.01	6.49		
405859	.001	.304	.42	.01	7.82		
405860	.001	.303	.42	.01	9.49		
405861	.001	.301	.42	.01	9.49		
405862	.001	.301	.42	.01	6.19		
405863	.001	.306	.42	.01	6.00		
405864	.001	.303	.42	.01	5.04		
405865	.001	.301	.42	.01	6.49		
405866	.001	.302	.42	.01	4.46		
405867	.001	.308	.42	.01	8.58		
405868	.001	.306	.42	.01	6.34		
405869	.001	.306	.42	.01	6.31		
RE 405869	.001	.306	.42	.01	-		
RRR 405869	.001	.307	.42	.01	-		
405870	.001	.317	.42	.01	6.69		
405871	.001	.309	.42	.01	6.69		
405872	.001	.304	.42	.01	6.14		
405873	.015	.312	.42	.01	6.46		
405874	.031	.308	.42	.01	6.46		
STANDARD R-2a/OxL34	.047	.549	145	5.76	-		

sample type: DRILL CORE H150. Samples beginning 'RE' are Returns and 'RRR' are Reject Returns.

All results are considered the confidential property of the client. Acme assumes the liability for actual cost of the analysis only.

AA ANALYTICAL		TET Resources Inc. FILE # A602497				Page 4	AA ANALYTICAL
SAMPLE#	Mo %	Cu %	Ag ⁴⁴ gm/mt	Au ⁴⁴ gm/mt	Sample kg		
G-1	<.001	<.001	<2	<.01	-		
405875	4.001	.013	<2	<.01	7.37		
405876	4.001	.011	<2	<.01	7.03		
405877	4.001	.010	<2	<.01	6.97		
405878	4.001	.007	<2	<.01	1.13		
RE 405878	4.001	.007	<2	<.01	-		
RRE 405878	4.001	.006	<2	<.01	-		
405879	4.001	.006	<2	<.01	6.75		
405880	4.001	.010	<2	<.01	7.45		
405881	4.001	.008	<2	<.01	6.72		
405882	4.001	.008	<2	<.01	6.51		
405883	4.001	.003	<2	<.01	6.53		
405884	4.001	.009	<2	<.01	6.44		
405885	4.001	.007	<2	<.01	7.16		
405886	4.001	.010	<2	<.01	5.84		
405887	4.001	.027	<2	<.01	7.73		
405888	4.001	.008	<2	<.01	6.46		
405889	4.001	.006	<2	<.01	6.52		
405890	4.001	.012	<2	<.01	6.66		
405891	4.001	.010	<2	<.01	6.81		
405892	4.001	.017	<2	.01	7.20		
405893	4.001	.017	<2	<.01	6.98		
405894	4.001	.005	<2	<.01	6.99		
405895	4.001	.003	<2	<.01	6.96		
405896	4.001	.004	<2	<.01	6.86		
405897	4.001	.009	<2	.01	6.36		
405898	4.001	.011	<2	.01	4.65		
405899	4.001	.008	<2	<.01	7.44		
405900	4.001	.008	<2	.01	8.02		
STANDARD R-2a/OxL34	.348	.556	156	5.81	-		

Sample type: DRILL CORE R150. Samples beginning 'RE' are Reruns and 'RRE' are Reject Reruns.

All results are considered the confidential property of the client. ACS issues the liabilities for actual cost of the analysis only. Date: 1/28

ACME ANALYTICAL LABORATORIES LTD. 852 W. HASTINGS ST. VANCOUVER BC V6A 1R6 PHONE (604) 253 2158 FAX (604) 253 1716		
(ISO 9001 Accredited Co.)		
ASSAY CERTIFICATE		
TTM Resources Inc. File # A604127 Page 1		
420 - 801 A. Parker St., Vancouver BC V6C 2V6		
SAMPLE#	Mo %	Cu Sample %
G-1	.001	.001
405901	.001	.013
405902	.001	.013
405903	.001	.026
405904	.002	.017
405905	.001	.021
405906	.001	.009
405907	.002	.008
405908	.002	.012
405909	.001	.017
405910	.001	.022
405911	.001	.017
405912	.005	.009
405913	.011	.007
405914	.001	.010
405915	.001	.014
405916	.001	.012
405917	.001	.018
405918	.001	.008
405919	.001	.011
405920	.001	.010
405921	.001	.012
405922	.001	.010
RR 405922	.001	.010
RRR 405922	.001	.010
405923	.001	.009
405924	.001	.040
405925	.001	.016
405926	.001	.007
405927	.001	.018
405928	.001	.008
405929	.001	.013
405930	.001	.013
405931	.001	.035
405932	.001	.017
STANDARD R-2a	.049	.572

GROUP 770 - 0.500 gm SAMPLE, 4 ACID (HF-HClO4-HNO3-HCl) DIGESTION TO 100 mL, ANALYSIS BY ICP-ES.
 * SAMPLE TYPE: DRILL CORE R150 Samples beginning "RR" are Return and "RRR" are Reject Returns.

Date 6/28 DATE RECEIVED: JUN 21 2006 DATE REPORT MADE: 2006-08-10 10:23:30



All results are considered the confidential property of the client. Acme assumes no liabilities for actual cost of the analysis only.

AA ANALYTICAL		TTM Resources Inc. FILE # A604127		Page 2		AA ANALYTICAL	
SAMPLE#	MO	Cu	Sample	kg			
Q 1	.001	.001					
405933	.001	.048		4.71			
405934	.001	.018		4.78			
405935	.001	.016		7.28			
RE 405935	.001	.016					
RRR 405935	.031	.021					
405936	.031	.053		6.55			
405937	.031	.082		3.83			
405938	.031	.084		4.78			
405939	.031	.011		3.78			
405940	.001	.011		3.62			
405941	.001	.018		4.66			
405942	.001	.012		4.84			
405943	.001	.011		4.96			
405944	.001	.023		4.77			
405945	.001	.036		2.98			
405946	.001	.019		4.39			
405947	.001	.019		4.78			
405948	.001	.074		4.96			
405949	.001	.058		4.83			
405950	.001	.021		4.95			
405951	.001	.010		4.27			
405952	.001	.014		4.21			
405953	.001	.038		4.24			
405954	.001	.038		4.08			
405955	.001	.018		3.37			
405956	.001	.059		4.83			
405957	.001	.018		4.10			
405958	.001	.058		4.83			
405959	.001	.037		4.26			
405960	.001	.011		4.80			
405961	.001	.023		4.28			
405962	.001	.008		4.28			
405963	.001	.006		4.68			
405964	.001	.035		4.44			
STANDARD R 2B	.048	.556					

Sample type: DRILL CORE 2150. Sample beginning 'RE' are Return and 'RRR' are Reflect Return.

All results are considered the confidential property of the client. Acme assumes the liabilities for actual cost of the analysis only. Date 6/22/04

AA AC ANALYTICAL		TYM Resources Inc. FILE # AC04127		Page 3		AA AC ANALYTICAL	
SAMPLE#	MO	Ch	Sample				
	g	g	kg				
G-1	4.001	0.001	-				
405965	4.001	0.009	3.01				
405966	4.001	0.015	3.45				
405967	4.001	0.002	4.16				
405968	4.001	0.005	4.98				
405969	4.001	0.005	4.89				
405970	4.001	0.005	4.91				
405971	4.001	0.011	4.73				
405972	4.001	0.010	3.74				
405973	4.001	0.001	4.73				
405974	4.001	0.010	4.89				
405975	4.001	0.004	4.85				
405976	4.001	0.006	4.25				
405977	4.001	0.006	4.72				
RE 405977	4.001	0.006	-				
RRR 405977	4.001	0.006	-				
405978	4.001	0.010	4.47				
405979	4.001	0.005	5.96				
405980	4.001	0.011	7.10				
405981	4.001	0.014	7.51				
405982	4.001	0.004	7.16				
405983	4.001	0.007	5.90				
405984	4.001	0.009	7.38				
405985	4.001	0.010	3.89				
STANDARD R-2a	0.049	0.005	-				

Sample type: DRILL CORE EL50. Samples beginning 'RR' are Returns and 'RRR' are Reject Returns.

All results are considered the confidential property of the client. Acee assumes the liabilities for actual cost of the analysis only. Date: 6/78

ACME ANALYTICAL LABORATORIES LTD. (ISO 9001 Accredited Co.)		852 W. HASTINGS ST. VANCOUVER BC V6A 1R6		PHONE (604) 253-3150 FAX (604) 253-1716	
ASSAY CERTIFICATE					
AA		TIM Resources Inc. File # A603633 Page 1		AA	
320 - 800 W. Parson St., Vancouver, B.C. V6C 2K6					
SAMPLE#	Mo %	Ch %	Sample	kg	
G 1	0.001	0.001			
337501	0.006	0.047		2.26	
337502	0.001	0.099		2.88	
337503	0.001	0.011		3.33	
337504	0.001	0.023		3.27	
337505	0.001	0.036		3.54	
337506	0.001	0.037		3.56	
RR 337506	0.001	0.037		3.56	
337507	0.001	0.006		3.07	
337508	0.001	0.010		3.58	
337509	0.001	0.036		3.25	
337510	0.001	0.007		3.38	
337511	0.001	0.017		3.17	
337512	0.001	0.016		3.31	
337513	0.001	0.010		3.79	
337514	0.001	0.006		3.86	
337515	0.001	0.024		3.13	
337516	0.001	0.014		3.60	
337517	0.001	0.053		3.81	
337518	0.001	0.042		3.68	
337519	0.001	0.007		3.96	
337520	0.001	0.025		3.53	
337521	0.001	0.023		4.00	
337522	0.001	0.030		3.63	
337523	0.001	0.029		3.18	
337524	0.001	0.034		3.33	
337525	0.001	0.025		4.10	
337526	0.001	0.010		4.36	
337527	0.001	0.015		3.63	
337528	0.001	0.015		3.63	
337529	0.001	0.023		4.44	
337530	0.001	0.010		4.05	
337531	0.001	0.010		1.65	
RR 337531	0.001	0.010		1.65	
337532	0.001	0.010		1.56	
337533	0.001	0.010		1.76	
STANDARD R-2a	0.047	0.567			

GROUP 716 - COPPER SAMPLE, 4 ACID (HF-HNO3-H2O2-HCL) DISSOLUTION TO 100 ML. ANALYSIS BY ICP-AES.
 * SAMPLE TYPE: DRILL CORE R190 Samples beginning "RR" are Refuse and "RR" are Reject Refuse.

Data # PA _____ DATE RECEIVED: JUL 14 2006 DATE REPORT MAILED: 07-31-2006 P04:27



All results are considered the confidential property of the client. Acme assumes the liabilities for actual cost of the analysis only.

AA ANALYTICAL		TMC Resources Inc. FILE # A603623		Page 2		AA ANALYTICAL	
SAMPLE#	Mo %	(g) Sample					
		kg					
G-1	<.001	.001	-				
337534	.001	.017	2.43				
337535	.001	.004	6.98				
337536	.001	.008	3.47				
337537	.001	.012	1.28				
337538	.001	.004	4.73				
337539	.001	.003	4.69				
337540	.001	.004	4.53				
337541	.001	.006	3.36				
405985	.001	.021	3.19				
RRE 405986	.001	.022	-				
405987	.001	.055	3.68				
405988	.001	.018	3.66				
R 405988	.001	.018	-				
405989	.001	.016	1.38				
405990	.001	.011	3.51				
405991	.001	.011	3.43				
405992	.004	.021	3.61				
405993	.004	.009	3.15				
405994	.001	.008	3.87				
405995	.001	.025	3.65				
405996	.001	.006	4.45				
405997	.001	.009	4.61				
405998	.001	.015	4.86				
405999	.001	.009	4.95				
406000	.001	.022	3.25				
STANDARD R-2a	.047	.552	-				

Sample type: DRILL CORE R15G. Samples beginning 'RR' are Returns and 'RRE' are Reject Returns.

All results are considered the confidential property of the client. Amp assumes the liabilities for actual cost of the analysis only.

Date: 1/84

ACME ANALYTICAL LABORATORIES LTD. 452 E. HASTINGS ST. VANCOUVER BC V6A 1K6 PHONE (604) 253-3158 FAX (604) 253-1716 (ISO 9001 Accredited Co.)		ASSAY CERTIFICATE	
TIN Resources Inc. File # A803611 Page 1 521 - 8th St. Port Moody, Vancouver BC V6C 2H6			
SAMPLE#		Ag** gm/mt	Au** gm/mt
G-1		42	.01
337501			.03
337502			.01
337503			.01
337504			.01
337505			.01
337506			.01
RF 337506			.01
337507			.01
337508			.01
337509			.01
337510			.01
337511			.01
337512			.01
337513			.01
337514			.01
337515			.01
337516			.01
337517			.01
337518			.01
337519			.01
337520			.01
337521			.01
337522			.01
337523			.01
337525			.10
337526			.01
337527			.01
337528			.01
337529			.01
337530			.01
337531			.01
RRR 337531			.01
337532			.01
337533			.01
STANDARD R-25/OxL34		156	5.77

GROUP 6 - PREVIOUS METALS BY FIRE ASSAY FROM 1 A.L. SAMPLE, ANALYSIS BY ICP-ES.
 - SAMPLE TYPE: ZILL CORE R150
 Samples beginning 'RF' are Reforms and 'RRR' are Reject Reforms.

Date 1 FA _____ DATE RECEIVED: JUL 14 2006 DATE REPORT MAILED: 2006-07-27 ACB:28

All results are considered the confidential property of the client. Acme assumes the liabilities for actual cost of the analyses only.



AA ANALYTICAL		TTM Resources Inc. FILE # A603633	Page 2	AA ANALYTICAL	
SAMPLE#	Ag** gm/mt	Au** gm/mt			
C-1	^	^	^	^	^
337534	^	^	^	^	^
337535	^	^	^	^	^
337536	^	^	^	^	^
337537	^	^	^	^	^
337538	^	^	^	^	^
337539	^	^	^	^	^
337540	^	^	^	^	^
337541	^	^	^	^	^
405986	^	^	^	^	^
RRR 405986	^	^	^	^	^
405987	^	^	^	^	^
405988	^	^	^	^	^
RE 405988	^	^	^	^	^
405989	^	^	^	^	^
405990	^	^	^	^	^
405991	^	^	^	^	^
405992	^	^	^	^	^
405993	^	^	^	^	^
405994	^	^	^	^	^
405995	^	^	^	^	^
405996	^	^	^	^	^
405997	^	^	^	^	^
405998	^	^	^	^	^
405999	^	^	^	^	^
406000	^	^	^	^	^
STANDARD R-2a/Ox134	158	5A	01	76	

Sample type: DRILL CORE R150. Samples beginning 'RE' are Returns and 'RRR' are Reject Returns.

All results are considered the confidential property of the client. Acme assumes the liabilities for actual cost of the analysis only. Data LPA

ACME ANALYTICAL LABORATORIES LTD. 852 E. HASTINGS ST. VANCOUVER BC V6A 1R6 PHONE (604) 253-3158 FAX (604) 253-1726	
(ISO 9001 Accredited Co.)	
ASSAY CERTIFICATE	
TIM Resources Inc. File # AC0755 Page 1	
820 - 830 W. Pender St., Vancouver BC V6C 1V6	
SAMPLE#	Mo % C1 Sample kg
G-	.001 .001
337542	.007 .017
337543	.004 .018
337544	.001 .020
337545	.001 .054
337546	.001 .027
337547	.001 .014
337548	.004 .014
337549	.001 .035
337550	.001 .018
337551	.001 .026
337552	.003 .027
RR 337552	.003 .027
RRE 337552	.003 .030
337553	.001 .022
337554	.001 .025
337555	.005 .013
337556	.015 .015
337557	.013 .019
337558	.005 .014
337559	.013 .008
337560	.001 .008
337561	.001 .004
337562	.001 .021
337563	.001 .009
337564	.001 .037
337565	.001 .028
337566	.001 .019
337567	.001 .009
337568	.001 .014
337569	.001 .023
337570	.001 .015
337571	.001 .021
337572	.001 .014
337573	.007 .006
STANDARD R-2a	.047 .573

GROUP 710 - 1.000 GR SAMPLE, 4% ACID (HF-HNO3-H2O2-CL) DIGESTION TO 100 ML, ANALYSIS BY ICP-ES.
 SAMPLE TYPE: DRILL CORE R150 SAMPLES DESIGNATED 'M' ARE RETURN AND 'RRE' ARE REJECT SAMPLES.

DATE RECEIVED: JUL 14 2006 DATE REPORT MAILED: 2006-08-02 11:27



All results are considered the confidential property of the client. Some analyses the Laboratories for actual cost of the analysis only.

AA NOT ANALYZED		TTM Resources Inc. FILE # AG03755		Page 2		AA NOT ANALYZED	
SAMPLE#	No	Cu	Sample				
	%	%	kg				
G-1	.001	.001	-				
337574	.003	.008	2.39				
337575	.001	.026	1.41				
337576	.001	.036	1.63				
337577	.001	.029	2.03				
337578	.001	.017	3.79				
337579	.001	.027	5.74				
337580	.001	.024	1.70				
337581	.001	.028	1.76				
337582	.001	.010	1.66				
337583	.001	.012	1.61				
337584	.001	.028	3.08				
337585	.001	.010	1.72				
337586	.001	.013	2.93				
337587	.001	.004	2.27				
337588	.001	.004	5.11				
337589	.001	.009	4.41				
337590	.001	.009	4.41				
337591	.001	.007	4.18				
337592	.001	.004	4.19				
337593	.001	.006	4.93				
337594	.001	.009	4.31				
337595	.001	.004	2.66				
337596	.001	.005	3.00				
337597	.001	.005	3.04				
337598	.001	.005	2.04				
337599	.001	.005	2.43				
337600	.001	.010	2.89				
337601	.001	.034	1.34				
337602	.001	.035	1.32				
337603	.001	.004	2.65				
337604	.001	.027	1.41				
337605	.001	.009	3.20				
RR 337605	.001	.009	-				
RRR 337605	.001	.002	-				
STANDARD R-2a	.043	.563	-				

Sample type: DRILL CORE 2150. Samples beginning 'RR' are Reruns and 'RRR' are Reject Reruns.

All results are considered the confidential property of the client. Acme assumes no liabilities for actual cost of the analysis only. Date: 6/24

AA ANALYTICAL		PTM Resources Inc. FILE # A605755		Page 3		AA ANALYTICAL	
SAMPLE#	Kg	Ct	Sample				
	g	g	Kg				
G-1	<.001	<.001	-				
337606	<.001	.004	1.63				
337607	<.001	.009	3.51				
337608	<.001	.006	3.97				
337609	<.001	.015	4.41				
337610	<.001	.005	1.9-				
337611	<.001	.006	4.33				
337612	<.001	.010	4.02				
337613	<.001	.005	4.00				
RE 337613	<.001	.005	-				
RR3 337613	<.001	.007	-				
337614	.002	.007	1.98				
337615	<.001	.005	4.87				
337616	<.001	.005	5.50				
STANDARD R-2a	.050	.570	-				

Sample type: DRILL CORE R150. Samples beginning 'RE' are Returns and 'RR3' are Reject Returns.

All results are considered the confidential property of the client. ACRS assumes the liabilities for actual cost of the analysis only. Date *hca*

ACME ANALYTICAL LABORATORIES LTD. (ISO 9001 Accredited Co.)		851 E. HASTINGS ST. VANCOUVER BC V6A 1R6		PHONE (604) 253-3108 FAX (604) 253-1716	
ASSAY CERTIFICATE					
T.M. Resources Inc. File # A603751 Page 1					
40 - 500 g. Samples (Maximum of 500 mg)					
SAMPLES		Ag**	Al**		
		gm/mt	gm/mt		
G-1		ASONS	4.01		
337542		ASONS	4.01		
337543		ASONS	4.03		
337544		ASONS	4.01		
337545		ASONS	4.01		
337546		ASONS	4.01		
337547		ASONS	4.01		
337548		ASONS	4.01		
337549		ASONS	4.01		
337550		ASONS	4.01		
327551		ASONS	4.01		
337552		ASONS	4.01		
337553		ASONS	4.01		
RRE 327552		ASONS	4.01		
RRE 327553		ASONS	4.01		
337554		ASONS	4.01		
337555		ASONS	4.01		
337556		ASONS	4.01		
337557		ASONS	4.01		
337558		ASONS	4.01		
337559		ASONS	4.01		
337560		ASONS	4.01		
337561		ASONS	4.01		
337562		ASONS	4.01		
337563		ASONS	4.01		
337564		ASONS	4.01		
337565		ASONS	4.01		
337566		ASONS	4.01		
337567		ASONS	4.01		
337568		ASONS	4.01		
337569		ASONS	4.01		
337570		ASONS	4.01		
337571		ASONS	4.01		
337572		ASONS	4.01		
337573		ASONS	4.01		
STANDARD R-2a/CXL34		157	5.80		

GROUP 6 - PRECISION METALS BY FIRE ASSAY FROM 1 A.T. SAMPLE, ANALYSIS BY ICP-ES.
 * SAMPLE TYPE: SKILL CORE RND
 Sample Identifiers: 'RE' are Returns and 'RRE' are Reject Returns.

2006-07-26 P03 35

Data: PA _____ DATE RECEIVED: N. 14 2005 DATE REPORT MAILED: _____

All results are considered the confidential property of the client. Acme assumes no liabilities for actual cost of the analyses only.



AA ANALYTICAL		TTM Resources Inc. FILE # A603755	Page 2	AA ANALYTICAL	
SAMPLE#	Ag** gm/mt	Au** gm/mt			
G-1	42	4.01			
337574	42	4.01			
337575	42	4.01			
337576	42	4.02			
337577	42	4.04			
337578	42	4.01			
337579	42	4.01			
337580	42	4.01			
337581	42	4.01			
337582	42	4.01			
337583	42	4.01			
337584	42	4.01			
337585	42	4.01			
337586	42	4.01			
337587	42	4.01			
337588	42	4.01			
337589	42	4.01			
337590	42	4.01			
337591	42	4.01			
337592	42	4.01			
337593	42	4.01			
337594	42	4.01			
337595	42	4.01			
337596	42	4.01			
337597	42	4.01			
337598	42	4.01			
337599	42	4.01			
337600	42	4.01			
337601	42	4.01			
337602	42	4.01			
337603	42	4.01			
337604	42	4.01			
337605	42	4.01			
RR 337605	42	4.01			
RR 337605	42	4.01			
STANDARD R-2a/OxL34	157	5.80			

Sample type: DRILL CORE R15C. Samples beginning 'RR' are Returns and 'RRR' are Reject Returns.

All results are considered the confidential property of the client. Agre assumes the liabilities for actual cost of the analysis only. Date: FA

AA AAE ANALYTICAL		TJM Resources Inc. FILE # A603/25	Page 3	AA AAE ANALYTICAL	
SAMPLE#	Ag** gm/mt	Au** gm/mt			
G-1	<.01	<.01			
337606	<.01	<.01			
337607	<.01	.03			
337608	<.01	<.01			
337609	<.01	.01			
337610	<.01	.01			
337611	<.01	.01			
337612	<.01	.01			
337613	<.01	.01			
RR 337613	<.01	<.01			
RRE 337613	<.01	<.01			
337614	<.01	.01			
337615	<.01	.01			
337616	<.01	.01			
STANDARD R-2a/OxL34	159	5.78			

Sample type: DRILL CORE R130. Samples beginning 'RE' are Returns and 'RRE' are Reject Returns.

All results are considered the confidential property of the client. AAE assumes the liabilities for actual cost of the analysis only. Data FA

RS-06-07

Pg. 1

ACME ANALYTICAL LABORATORIES LTD. (ISO 9001 Accredited Co.)		892 E. HASTINGS ST. VANCOUVER BC V6A 1W6		PHONE(604)253-3138 FAX(504)253-1716	
AA		ASSAY CERTIFICATE		AA	
TEM Resources Ltd.		File # A613789		Page 1	
100 - 800 W. Gordon St., Vancouver, BC V6C 2W8					
SAMPLE#	Mo	CU			
	%	%			
G-1	.001	.001			
337617	.002	.023			
337618	.004	.045			
337619	.001	.014			
337620	.001	.013			
337621	.002	.024			
337622	.001	.047			
337623	.003	.031			
337624	.006	.021			
337625	.001	.021			
337626	.007	.023			
337627	.002	.022			
337628	.001	.016			
337629	.007	.025			
337630	.001	.010			
337631	.001	.011			
337632	.005	.007			
337633	.005	.017			
337634	.008	.019			
337635	.019	.015			
337636	.002	.308			
337637	.001	.016			
337638	.001	.005			
337639	.001	.027			
337640	.001	.014			
337641	.001	.016			
337642	.001	.014			
337643	.001	.308			
337644	.001	.305			
337645	.001	.319			
337646	.001	.013			
337647	.001	.009			
RR 337647	.001	.010			
RRR 337647	.001	.010			
337648	.001	.010			
STANDARD R-2a	.051	.577			

GROUP TD - 0.500 GR SAMPLE, 4 ACID (HF-HNO3-H2O2-HEX) DIGESTION TO 100 ML, ANALYSIS BY ICP-MS.
 - SAMPLE TYPE: Drill Core 150 Samples containing 'RE' are Return and 'RSE' are 50:50 Return.

Date 6 / 28 DATE RECEIVED: JUL 17 2006 DATE REPORT MAILED: 2006-08-01 Pg: 41



All results are considered the confidential property of the client. Acme assumes no liabilities for actual cost of the analysis or y.

RS-06-07

Pg. 2

AA ANALYTICAL		T.M. Resources Inc. FILE # A603798		Page 2		AA ANALYTICAL	
SAMPLE#		Mo %	Cu %				
G-1		+.001	.061				
337649		+.001	.012				
337650		+.001	.006				
337651		+.001	.005				
337652		+.001	.028				
337653		+.001	.013				
STANDARD R-2a		.048	.586				
Sample type: <u>Drill Core R150.</u>							
All results are considered the confidential property of the client. Please advise the Client/ies for actual cost of the analysis only.						Data <u>LSA</u>	

ACME ANALYTICAL LABORATORIES LTD. 450 3801 Accredited Co.		852 W. EASTINGS ST. VANCOUVER BC V6A 1K6		PHONE (604) 253-3158 FAX (604) 253-1716	
ASSAY CERTIFICATE					
TMC Resources Inc. File # A601798 Page 3					
522 800 W. Pender St., Vancouver BC V6C 2Y7					
SAMPLE#	Ag** g/g	Au** g/g	Sample kg		
G-1					
337617	A2	A.01	2.15		
337618	A2	A.01	1.47		
337619	A2	A.01	2.01		
337620	A2	A.01	2.17		
337621	A2	A.01	2.48		
337622	A2	A.02	2.24		
337623	A2	A.01	2.84		
337624	A2	A.01	2.05		
337625	A2	A.02	2.07		
337626	A2	.02	2.29		
337627	A2	.01	2.68		
337628	A2	.01	1.19		
337629	A2	.01	1.73		
337630	A2	A.01	1.03		
337631	A2	.01	2.45		
337632	A2	A.01	2.03		
337633	A2	A.01	2.09		
337634	A2	.01	2.94		
337635	A2	.01			
337636	A2	.01	1.34		
337637	A2	A.01	1.90		
337638	A2	.01	2.06		
337639	A2	.04	2.27		
337640	A2	.01	2.18		
337641	A2	.01	2.85		
337642	A2	A.01	2.80		
337643	A2	A.01	2.33		
337644	A2	.01	2.00		
337645	A2	.01	2.00		
337646	A2	A.01	2.03		
337647	A2	A.01	2.01		
RR 337647	A2	A.01			
RRB 337647	A2	A.01			
337648	A2	A.01	2.82		
STANDARD R-2a/QxL34	157	5.79			

GROUP 6 - PRECIOUS METALS BY FIRE ASSAY FROM 1 A.T. SAMPLE, ANALYSIS BY ICP-ES.
 - SAMPLE TYPE: Drill Core R150
 Sample bearings 'RR' are Reserve and 'RRB' are Rejected Reserve.



DATA PA _____ DATE RECEIVED: JUL 17 2006 DATE REPORT MAILED: 2006-08-01 10:14

All results are considered the confidential property of the client. Acme assumes the liabilities for actual cost of the analysis only.

AA ANALYTICAL		TTM Resources Inc. FILE # 2503793		Page 2		AA ANALYTICAL	
SAMPLE#	Ag** gm/mt	Au** gm/mt	Sample	Ag	Au	Sample	Ag
G-1	42	.01		3.04	-		
337644	42	.01		3.89	-		
337650	42	.01		3.91	-		
337651	42	.01		3.41	-		
337653	42	.01		6.32	-		
STANDARD P 2a/OxL34	157	5.75					
Sample Type: Drill Core R150.							
<p>All results are considered the confidential property of the client. Acme assumes no liability for actual cost of the analysis only.</p>							
							Date: <u>1/18</u>

ACME ANALYTICAL LABORATORIES LTD (ISO 9001 Accredited Co.)		452 W. HASTINGS ST. VANCOUVER BC V6A 1R6		PHONE(604)253-1158 FAX(604)253-1716	
AA		ASSAY CERTIFICATE		AA	
TTM Resources Inc. File # A503875 Page 1 420 - 602 A. Pender St., Vancouver BC V6C 2V6 Submitted by: Bob Krause					
SAMPLE#	Mo	Ct			
G-1	.001	.001			
337654	.001	.029			
337655	.001	.033			
337656	.003	.023			
337657	.001	.060			
337658	.001	.051			
337659	.001	.017			
337660	.001	.047			
337661	.001	.044			
337662	.001	.028			
337663	.001	.017			
337664	.001	.032			
337665	.001	.035			
337666	.001	.038			
337667	.001	.019			
337668	.001	.016			
337669	.001	.027			
337670	.001	.036			
337671	.001	.020			
337672	.001	.020			
337673	.002	.021			
337674	.001	.023			
337675	.001	.027			
337676	.002	.015			
337677	.002	.017			
337678	.003	.016			
337679	.008	.009			
337680	.016	.010			
337681	.009	.009			
337682	.005	.014			
RR 337687	.004	.014			
RRR 337682	.004	.014			
337683	.002	.040			
337684	.001	.021			
337685	.001	.036			
STANDARD R-2a	.047	.566			

GROUP 7TD - 0.500 GM SAMPLE, 4 ACID (HCl, HNO₃, HF, H₂O₂) DIGESTION TO 100 ML, ANALYSIS BY ICP-ES.
 - SAMPLE TYPE: DRILL CORE R150 Samples beginning 'RR' are Re-run and 'RRR' are Re-test lotting.

Data hpa DATE RECEIVED: Jul 20 2006 DATE REPORT MAILED: 2006-08-04 09:3:28



All results are considered the confidential property of the client. Acme assumes the liability for actual cost of the analysis only.

AA ACI ANALYTICAL		TIT Resources Inc. FILE # A603876	Page 2	AA ACI ANALYTICAL	
SAMPLE#	Mo	Cu			
G-1	4.001	.001			
337686	.004	.022			
337687	.004	.019			
337688	.006	.019			
337689	4.001	.018			
337690	.001	.028			
337691	.001	.014			
337692	.001	.011			
337693	.001	.009			
337694	.001	.014			
337695	4.001	.007			
337696	.005	.011			
337697	4.001	.008			
337698	4.001	.021			
337699	.001	.009			
337700	4.001	.006			
337701	4.001	.014			
337702	4.001	.012			
337703	4.001	.059			
337704	.001	.021			
337705	4.001	.040			
337706	4.001	.046			
337707	4.001	.026			
337708	4.001	.014			
337709	4.001	.009			
337710	4.001	.014			
337711	4.001	.011			
337712	4.001	.013			
337713	.004	.064			
RE 337713	.004	.067			
REE 337713	.005	.068			
337714	.012	.009			
337715	.008	.038			
337716	.001	.017			
337717	.001	.021			
STANDARD R-2D	.049	.569			

Sample type: DRILL CORE P155. Samples beginning 'RE' are Returns and 'REE' are Reject Returns.

All results are considered the confidential property of the client. ACI assumes no liability for actual cost of the analysis only. Date 6/24

ACME ANALYTICAL LABORATORIES LTD. 452 W. HASTINGS ST. VANCOUVER BC V6A 1R6 PHONE(604)251-7158 FAX(604)251-1716 (ISO 9001 Accredited Co.)	
ASSAY CERTIFICATE	
TTM Resources Inc. File # AG03875 Page 1 660 - 201 W. Pender St., Vancouver BC V6C 2L6 Submitted by: Bob Krause	
SAMPLE#	Au** Au** gm/mt gm/mt
G-1	.01
337654	.02
337655	.01
337656	.01
337657	.01
337658	.01
337659	.01
337660	.01
337661	.01
337662	.01
337663	.01
337664	.01
337665	.01
337666	.01
337667	.01
337668	.01
337669	.01
337670	.01
337671	.01
337672	.01
337673	.01
337674	.02
337675	.01
337676	.01
337677	.01
337678	.01
337679	.01
337680	.01
337681	.01
337682	.01
RE 337682	.01
RRE 337682	.02
337683	.01
337684	.01
337685	.04
STANDARD R-2a/Cx134	158 5.78

GROUP 6 - PRECIOUS METALS BY FIRE ASSAY FROM 1 A.T. SAMPLE, ANALYSIS BY 129-83.
 SAMPLE TYPE: DRILL CORE R150
 Service beginning 'RE' and 'RRE' and 'RRE' and 'RRE' and 'RRE' and 'RRE'.

DRAWN BY: SA DATE RECEIVED: JUL 26 2005 DATE REPORT MAILED: 08-05-2005 P02:59

All results are considered the confidential property of the client. Acme assumes the liabilities for actual cost of the analysis only.

AA ANALYTICAL		TTM Resources Inc. FILE # A603876	Page 2	AA ANALYTICAL	
SAMPLE#	Ag** g/t Au	Au** g/t Au			
337687	.01	.01			
337688	.02	.02			
337689	.01	.01			
337690	.01	.01			
337691	.01	.01			
337692	.01	.01			
337693	.01	.01			
337694	.01	.01			
337695	.01	.01			
337696	.01	.01			
337697	.01	.01			
337698	.01	.01			
337699	.01	.01			
337700	.01	.01			
337701	.01	.01			
337702	.01	.01			
337703	.01	.01			
337704	.01	.01			
337705	.01	.01			
337706	.01	.01			
337707	.01	.01			
337708	.01	.01			
337709	.01	.01			
337710	.01	.01			
337711	.01	.01			
337712	.03	.03			
337713	.04	.04			
RE 337713	.01	.01			
RRR 337713	.01	.01			
337714	.01	.01			
337715	.01	.01			
337716	.01	.01			
337717	.01	.01			
STANDARD R-2a/CXL34	160	5.71			

Sample type: DRILL CORE F150. Samples beginning 'RE' are Recharge and 'RRR' are Reject Returns.

All results are considered the confidential property of the client. AAR reserves the liability for actual cost of the analysis only. Date 6/28

AA ANALYTICAL		TDM Resources Inc. FILE # A601876	Page 3		AA ANALYTICAL	
SAMPLE#		Mo %	Cu %			
	G-1	4.002	4.001	.021		
	337718	4.002	4.001	.014		
	337719	4.002	4.001	.029		
	337720	4.002	4.001	.018		
	337721	4.002	4.001	.035		
	337722	.002	.001	.025		
	337723	.002	.001	.021		
	337724	.002	.001	.042		
	337725	.002	.001	.008		
	337726	.009	.006	.036		
	337727	.003	.002	.020		
	337728	.002	.002	.037		
	337729	.004	.004	.016		
	337730	.003	.003	.016		
	337731	.004	.004	.057		
	337732	.006	.006	.019		
	337733	.007	.007	.012		
	337734	.007	.007	.007		
	337735	.010	.010	.010		
	337735	.001	.001	.014		
	337737	.010	.010	.067		
	RR 337737	.010	.010	.065		
	RRE 337737	.009	.009	.073		
	337739	4.002	4.001	.010		
	337739	4.002	4.001	.006		
	337740	4.002	4.001	.024		
	337741	4.002	4.001	.028		
	337742	4.002	4.001	.014		
	337743	4.002	4.001	.021		
	337744	4.002	4.001	.020		
	337745	4.002	4.001	.009		
	337745	4.002	4.001	.004		
	337747	4.002	4.001	.003		
	337748	4.002	4.001	.005		
	337749	4.002	4.001	.005		
	STANDARD R-2a	.048	.048	.587		

Sample type: DRILL CORE P150. Samples beginning 'RR' are Returns and 'RRE' are Reject Returns.

All results are considered the confidential property of the client. PDM assumes the liabilities for actual cost of the analysis only. Date 6/24

AA ANALYTICAL		TIT Resources Inc. FILE # A603876	Page 4	AA ANALYTICAL	
SAMPLE#	Mc %	Cu %			
C-1	.001	.001			
337750	.001	.009			
337751	.001	.007			
337752	.001	.006			
RE 337752	.001	.006			
RSE 337752	.001	.006			
337753	.001	.006			
337754	.001	.006			
337755	.001	.008			
337756	.001	.007			
337757	.001	.013			
337758	.001	.011			
337759	.001	.011			
337760	.001	.005			
337761	.001	.003			
337762	.001	.018			
337763	.001	.007			
STANDARD R-2a	.048	.360			

Sample type: DRILL CORE 3150. Samples beginning 'RE' are Reruns and 'RSE' are Reject Results.



All results are considered the confidential property of the client. Aztec assumes the liabilities for actual cost of the analysis only.

Date *h* *PA*

AA ANALYTICAL		TTM Resources Inc. FILE # R603876	Page 3	AA ANALYTICAL	
SAMPLE#	Ag** gm/ul	Au** g/t.ass			
357718	A.A.S	A.A.	.01		
357719	A.A.S	A.A.	.01		
357720	A.A.S	A.A.	.01		
357721	A.A.S	A.A.	.01		
357722	A.A.S	A.A.	.01		
357723	A.A.S	A.A.	.01		
357724	A.A.S	A.A.	.01		
357725	A.A.S	A.A.	.01		
357726	A.A.S	A.A.	.01		
357727	A.A.S	A.A.	.01		
357728	A.A.S	A.A.	.01		
357729	A.A.S	A.A.	.01		
357730	A.A.S	A.A.	.01		
357731	A.A.S	A.A.	.01		
357732	A.A.S	A.A.	.01		
357733	A.A.S	A.A.	.01		
357734	A.A.S	A.A.	.01		
357735	A.A.S	A.A.	.01		
357736	A.A.S	A.A.	.01		
357737			.02		
RE 357737			.04		
RRE 357737			.02		
357738	A.A.S	A.A.	.01		
357739	A.A.S	A.A.	.01		
357740	A.A.S	A.A.	.02		
357741	A.A.S	A.A.	.03		
357742	A.A.S	A.A.	.01		
357743	A.A.S	A.A.	.02		
357744	A.A.S	A.A.	.01		
357745	A.A.S	A.A.	.01		
357746	A.A.S	A.A.	.01		
357747	A.A.S	A.A.	.01		
357748	A.A.S	A.A.	.01		
357749	A.A.S	A.A.	.01		
STANDARD R-2a/0x24	160	5.71			

Sample type: DRILL CORE R-50. Samples beginning 'RE' are Reruns and 'RRE' are Reject Reruns.

All res. ltr we consider the confidential property of the client. Also reserves the liabilities for actual cost of the analysis only. Date 6/24

		TCM Resources Inc. FILE # A603876		Page 4 	
SAMPLE#		Ag** gm/mt	Au** gm/mt		
G-1		AA	AA	0.01	
337750		AA	AA	0.01	
337751		AA	AA	0.01	
337752		AA	AA	0.01	
RE 337752		AA	AA	0.01	
PRE 337752		AA	AA	0.01	
337753		AA	AA	0.01	
337754		AA	AA	0.01	
337755		AA	AA	0.01	
337756		AA	AA	0.01	
337757		AA	AA	0.01	
337758		AA	AA	0.01	
337759		AA	AA	0.01	
337760		AA	AA	0.01	
337761		AA	AA	0.01	
337762		AA	AA	0.01	
337763		AA	AA	0.01	
STANDARD R-2a/OxL31		16200	5.78		

Sample type: DRILL CORE R15C. Samples beginning 'RE' are Returns and 'RPF' are Reject Returns.

All results are considered the confidential property of the client. TCM assumes the responsibility for actual cost of the analysis only. Data AA

ANALYTICAL LABORATORIES 442 E. BARRINGTON ST. WASHINGTON, DC, USA TEL: (202) 531-3154 FAX: (202) 531-3155 AA AA ANALYTICAL CHEMISTRY TMC Resources, Inc. P.O. Box 1188 418 E. Capitol St. Washington, DC 20001-0118					
SAMPLE#	Mo %	Cu %	Ag** gm/mt	As** gm/mt	Sample kg
Q-1	.001	.001	<2	<.01	-
337764	.010	.026	<2	<.01	2.10
337765	.004	.019	<2	<.01	2.10
337766	.003	.022	<2	<.01	2.10
337767	.005	.019	<2	<.01	2.10
337768	.001	.017	<2	<.01	2.40
337769	.001	.043	<2	<.01	2.00
337770	.002	.043	<2	<.01	1.00
337771	.011	.017	<2	<.01	1.80
337772	.023	.008	<2	<.01	.70
337773	.003	.013	<2	<.01	1.50
337774	.001	.009	<2	<.01	1.50
337775	.003	.010	<2	<.01	2.00
337776	.013	.023	<2	<.01	2.70
337777	.002	.023	<2	<.01	2.10
337778	.007	.022	<2	<.01	1.70
337779	.007	.009	<2	<.01	1.00
337780	.007	.006	<2	<.01	1.30
337781	.007	.020	<2	<.01	1.40
337782	.007	.010	<2	.02	1.50
337783	.001	.010	<2	.01	3.20
337784	.001	.014	<2	.04	3.10
337785	.001	.010	<2	.01	3.20
337786	.001	.011	<2	.01	3.00
337787	.001	.008	<2	.01	3.40
337788	.002	.009	<2	<.01	4.40
RE 337788	.002	.010	<2	<.01	-
RR 337788	.002	.009	<2	<.01	-
337789	.001	.003	<2	<.01	4.70
337790	.001	.020	<2	<.01	4.50
337791	.001	.004	<2	<.01	4.00
337792	.001	.008	<2	<.01	3.60
337793	.001	.008	<2	<.01	3.50
337794	.001	.007	<2	<.01	3.80
337795	.001	.006	<2	<.01	4.80
STANDARD R-2a/OxL34	.046	.566	155	5.83	-

GROUP 710 - 0.500 GR SAMPLE, 4 ACID (HNO₃-H₂O₂-HClO₄-H₂O) DIGESTION TO 100 ML, ANALYSIS BY ICP-ES.
 RE** & RR** BY FIRE ASSAY FROM 1 A.T. SAMPLE.
 - SAMPLE TYPE: GULF CONE R150 Sample Scenarios (RE) are Return and (RR) are Reject Results.

Data by FA DATE RECEIVED: Jul 27 2006 DATE REPORT MAILED: 08-15-2006 P02:39

All results are considered the confidential property of the client. KRC assumes the liability for actual cost of the analysis only.



AA ANALYTICAL		TKM Resources Inc. FILE # A504253				Page 2		AA LAB ANALYTICAL	
SAMPLE#	Mo %	Cu %	Ag** gm/mt	Au** gm/mt	Sample				
337795	.001	.001	.01	.01	4.3				
337796	.001	.008	.01	.01	4.0				
337797	.001	.009	.01	.01	4.5				
337798	.001	.006	.01	.01	4.0				
337799	.001	.012	.01	.01	4.0				
337800	.001	.007	.01	.01	4.0				
337801	.004	.003	.02	.02	4.4				
337802	.004	.003	.02	.02	4.0				
337803	.004	.003	.02	.02	4.0				
337804	.001	.009	.01	.01	4.1				
337805	.001	.004	.01	.01	4.2				
337806	.001	.004	.01	.02	4.0				
337807	.001	.001	.01	.01	4.4				
337808	.001	.003	.01	.01	3.4				
337809	.001	.005	.01	.20	1.15				
RE 337809	.001	.005	.01	.21	-				
REE 337809	.001	.005	.01	.12	-				
337810	.004	.003	.02	.01	3.4				
337811	.004	.003	.02	.01	3.0				
337812	.004	.003	.02	.01	3.0				
337813 (K.R.)	-	-	-	-	-				
337814	.005	.002	.01	.01	2.3				
337815	.001	.006	.01	.01	4.3				
337816	.001	.007	.01	.01	4.6				
337817	.001	.006	.01	.01	2.9				
337818	.002	.005	.01	.01	3.3				
337819	.001	.004	.01	.01	3.5				
337820	.001	.009	.01	.05	3.4				
337821	.003	.006	.01	.03	3.4				
337822	.008	.004	.02	.02	3.2				
337823	.003	.005	.01	.01	3.7				
337824	.001	.008	.01	.01	3.1				
337825	.012	.009	.01	.01	3.0				
337826	.001	.006	.01	.01	5.0				
337827	.002	.009	.01	.01	4.4				
STANDARD R-2a/OxL34	.048	.571	153	5.73					

Sample type: DRILL CORE R150. Samples beginning 'RE' are Retuns and 'REE' are Reject Reruns.

All results are considered the confidential property of the client. Low assays are liabilities for actual cost of the analysis only. Date: 6/11

AA ANALYSIS		TTM Resources Inc. FILE # A604253				Page 3	AA ANALYSIS
SAMPLE#	Mo %	Cu %	Ag** gms/oz	Au** grs/oz	Sample kg		
G-1	.001	.002	A2	A.01	-		
337826	.001	.004	A2	A.01	5.00		
337828	.001	.005	A2	A.01	5.00		
337830	.002	.004	A2	A.01	4.70		
337831	.001	.014	A2	.62	4.60		
337832	.001	.010	A2	A.01	4.60		
RE 337832	.001	.010	A2	A.01	-		
RRR 337832	.001	.010	A2	A.01	-		
337833	.001	.012	A2	A.01	4.60		
337834	.001	.022	A2	A.01	4.60		
337835	.001	.033	A2	A.01	4.30		
337836	.001	.019	A2	A.01	4.20		
337837	.001	.023	A2	.62	5.60		
337838	.001	.003	A2	.19	2.60		
337839	.001	.011	A2	A.01	4.30		
337840	.001	.011	A2	.02	3.40		
337841	.001	.020	A2	A.01	MINUM.40		
337842	.006	.043	A2	A.01	1.10		
337843	.001	.012	A2	A.01	1.80		
337844	.001	.008	A2	A.01	1.80		
337845	.001	.007	A2	A.01	1.60		
337846	.001	.015	A2	A.01	3.70		
337847	.001	.013	A2	A.01	3.00		
337848	.001	.021	A2	A.01	5.70		
337849	.001	.011	A2	A.01	5.20		
337850	.001	.007	A2	A.01	3.70		
337851	.001	.012	A2	A.01	4.90		
337852	.001	.009	A2	A.01	1.00		
337853	.002	.019	A2	.31	.40		
337854	.001	.007	A2	A.01	2.00		
337855	.001	.012	A2	A.01	1.70		
337856	.001	.009	A2	A.01	4.00		
337857	.001	.005	A2	A.01	4.50		
337858	.001	.024	A2	A.01	4.20		
337859	.001	.011	A2	A.01	4.10		
STANDARD R 23/OXL34	.049	.571	.55	5.73	-		

Sample type: DRILL CORE R:50. Samples beginning 'RE' are Returns and 'RRR' are Reject Returns.

All results are considered the confidential property of the client. Acon assures the liabilities for actual cost of the analysis only. Date 6/84

AA AGS ANALYTICAL		TKX Resources Inc. FILE # A604253				Page 4		AA AGS ANALYTICAL	
SAMPLE#	Mo %	Cu %	Ag** gm/mt	Au** gm/mt	Sample kg				
G-1	.0014	.001	42	4.01	-				
337860	.001	.011	42	4.01	4.50				
337861	.001	.009	42	4.01	4.20				
337862	.001	.014	42	4.01	4.50				
337863	.001	.022	42	4.01	6.90				
RE 337863	.001	.033	42	4.01	-				
RRE 337853	.001	.028	42	4.01	-				
337864	.001	.008	42	4.01	5.20				
337865	.001	.034	42	4.01	5.40				
337866	.001	.012	42	4.01	4.70				
337867	.001	.013	42	4.01	5.50				
337868	.001	.017	42	4.01	4.90				
337869	.001	.029	42	4.01	3.30				
337870	.001	.033	42	4.01	3.50				
337871	.001	.057	42	4.01	3.00				
337872	.001	.063	42	4.01	3.30				
337873	.001	.006	42	4.01	4.80				
337874	.001	.011	42	4.01	4.30				
337875	.001	.007	42	4.01	4.30				
337876	.001	.005	42	4.01	4.70				
STANDARD R-2a/OxL34	.046	.560	151	5.76	-				

Sample type: DRILL CORE R15C. Samples beginning 'RE' are Returns and 'RRE' are Reject Returns.

All results are considered the confidential property of the client. AGS assumes the liabilities for actual cost of the analysis only.

DATA *hda*

RS-06-12

Pg. 1



ASSAY CERTIFICATE



TTM Resources Inc. File # A604525 Page 1

620 - 800 W. Pender St., Vancouver BC V6C 2V6

SAMPLE#	Mo %	Cu %	Sample kg
G-1	.001	.001	-
337878	.012	.010	2.18
337879	.024	.004	2.32
337880	.017	.006	2.26
337881	.014	.005	2.36
337882	.002	.015	2.05
337883	.001	.030	2.27
337884	.001	.013	2.57
337885	.001	.012	2.16
337886	.001	.010	2.14
337887	.001	.024	2.13
337888	.001	.020	2.27
337889	.001	.025	2.20
337890	.001	.018	2.20
337891	.001	.019	2.10
337892	.001	.045	2.10
337893	.001	.032	1.79
337894	.001	.022	4.36
337895	.001	.015	3.96
337896	.001	.007	5.24
337897	.001	.009	2.45
337898	.001	.006	1.71
337899	.001	.009	3.95
337900	.001	.017	2.22
RE 337900	.001	.016	-
RRE 337900	.001	.018	-
337901	.001	.010	2.06
337902	.001	.013	5.04
337903	.001	.010	2.21
337904	.001	.013	1.56
337905	.001	.025	3.42
337906	.001	.057	3.40
337907	.001	.018	2.56
337908	.001	.033	5.96
337909	.001	.005	1.16
STANDARD R-2a	.048	.580	-

GROUP 7TD - 0.500 GM SAMPLE, 4 ACID (HF-HClO4-HNO3-HCL) DIGESTION TO 100 ML, ANALYSIS BY ICP-ES.
- SAMPLE TYPE: DRILL CORE R150 Samples beginning 'RE' are Reruns and 'RRE' are Reject Reruns.

Data FA

DATE RECEIVED: JUL 28 2006 DATE REPORT MAILED:.....

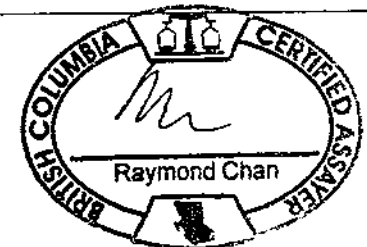

ALCO AN Analytical Laboratories Ltd. 552-5 HASTINGS ST. VANCOUVER BC V6C 2A6 TEL: (604) 251-1188 FAX: (604) 251-1716
 MASSAY CERTIFICATE
 57th Anniversary 1948-2005

SAMPLE#	Ag** gm/mt	Au** gm/mt
G-1		<.01
337878	AS5000	<.01
337879	AS5000	<.01
337880	AS5000	<.01
337881	AS5000	<.01
337882	AS5000	<.01
337883	AS5000	<.01
337884	AS5000	<.01
337885	AS5000	<.01
337886	AS5000	<.01
337887	AS5000	<.01
337888	AS5000	<.01
337889	AS5000	<.01
337890	AS5000	<.01
337891	AS5000	<.01
337892	AS5000	<.01
337893	AS5000	<.01
337894	AS5000	<.01
337895	AS5000	<.01
337896	AS5000	<.01
337897	AS5000	<.01
337898	AS5000	<.01
337899	AS5000	<.01
337900	AS5000	<.01
RE 337900		<.01
RRE 337900		<.01
337901	AS5000	<.01
337902	AS5000	<.01
337903	AS5000	<.01
337904	AS5000	<.01
337905	AS5000	<.01
337906	AS5000	<.01
337907	AS5000	<.01
337908	AS5000	<.01
337909	AS5000	<.01
STANDARD R-2a/OxL34	161	5.74

GROUP 6 - PRECIOUS METALS BY FIRE ASSAY FROM S.A.T. SAMPLE, ANALYSIS BY ICP-ES.
 - SAMPLE TYPES DRILL CORE R153
 Samples Requiring "RE" are Refused and "RRE" are Rejected Samples.



DATE RECEIVED: JUL 28 2006 DATE REPORT MAILED: 2006-08-31 20:07



All results are considered the confidential property of the client. Alcoa assumes no liabilities for actual cost of the analysis only.



AA LOW PPM TTX		TFM Resources Inc. FILE # A694525		Page 2		AA PER PARTIAL	
SAMPLE#	Mo %	Cu %	Sample #				
337910	.031	.006					
337911	.031	.017	5	25			
337912	.031	.009	5	33			
337913	.031	.022	5	09			
337914	.031	.071	1	67			
337915	.031	.040	2	11			
337916	.031	.057	2	46			
337917	.031	.010	2	62			
337918	.031	.014	3	97			
337919	.031	.010	3	94			
337920	.001	.015	5	24			
337921	.001	.014	4	08			
337922	.001	.014	4	08			
337923	.001	.019	3	25			
337924	.001	.022	1	53			
337925	.031	.017	4	91			
337926	.031	.042	2	18			
337927	.031	.036	2	73			
337928	.031	.039	3	60			
337929	.031	.006	3	40			
337930	.001	.006	4	26			
337931	.001	.009	4	26			
337932	.001	.015	2	97			
337933	.031	.006	3	77			
337934	.031	.021	3	74			
337935	.031	.006	4	24			
337936	.031	.043	4	74			
337937	.031	.004	3	09			
337938	.031	.006	3	88			
337939	.001	.005	4	37			
337940	.031	.006	3	02			
337941	.031	.006	5	54			
RE 337941	.031	.003	5	15			
RRE 337941	.031	.002					
STANDARD R 2a	.047	.573					

Sample type: DRILL CORE R-50. Samples beginning 'RE' are Returns and 'RRE' are Reject Returns.

		TTM Resources Inc. FILE # A501525		Page 3			
SAMPLE#	Mo %	Cu %	Sample	kg			
G-1	<.001	.003		-			
337942	<.001	.010		4.40			
337943	<.001	.007		2.45			
337944	<.001	.006		2.15			
337945	<.001	.010		2.14			
RR 337945	<.001	.019		-			
RRE 337945	<.001	.019		-			
337946	<.001	.005		1.59			
337947	<.001	.029		1.35			
337948	<.001	.012		2.17			
337949	<.001	.009		1.14			
337950	<.001	.017		2.08			
337951	<.001	.009		1.84			
337952	<.001	.006		2.33			
337953	<.001	.019		1.95			
337954	<.001	.020		1.93			
337955	<.001	.025		1.75			
337956	<.001	.011		2.54			
337957	<.001	.014		3.66			
337958	<.001	.014		4.61			
337959	<.001	.032		4.67			
337960	<.001	.012		2.98			
337961	<.001	.009		1.22			
STANDARD R-2a	.047	.575		-			

Sample Type: DRILL CORE R150. Samples beginning 'RR' are Reruns and 'RRE' are Reject Reruns.



All results are considered the confidential property of the client. Rose assumes the liabilities for actual cost of the analysis only. Date: 7/18/04

 TTM Resources Inc. FILE # A604525		Page 2 	
SAMPLE#	As** gm/mt	A1** gm/mL	
G-1			
337910	ASNSN	.01	
337911	ASNSN	.01	
337912	ASNSN	.01	
337913	ASNSN	.01	
337914		.01	
337915	ASNSN	.01	
337916	ASNSN	.01	
337917	ASNSN	.01	
337918	ASNSN	.01	
337919		.01	
337920	ASNSN	.01	
337921	ASNSN	.01	
337922	ASNSN	.01	
337923	ASNSN	.01	
337924	ASNSN	.01	
337925	ASNSN	.01	
337926	ASNSN	.01	
337927	ASNSN	.01	
337928	ASNSN	.01	
337929		.01	
337930	ASNSN	.01	
337931	ASNSN	.01	
337932	ASNSN	.01	
337933	ASNSN	.01	
337934	ASNSN	.01	
337935	ASNSN	.01	
337936	ASNSN	.01	
337937	ASNSN	.04	
337938		.01	
337939	ASNSN	.01	
337940	ASNSN	.01	
337941	ASNSN	.01	
RE 337941	ASNSN	.01	
RRE 337941	ASNSN	.01	
STANDARD R-2a/OxL34	162	5.79	

Sample type: DRILL CORE R15C. Samples beginning 'RE' are Return and 'RRE' are Reject Returns.

All results are considered the confidential property of the client. Agre assumes the liability for actual cost of the analysis only.

Data *LA*

		TTM Resources Inc. FILE # A604525			
		Page 3			
SAMPLE#	Ag** gm/mt	Au** gm/mt			
G-1	0.01				
337942	0.03				
337943	0.02				
337944	0.01				
337945	0.02				
RE 337945	0.03				
RRE 337945	0.02				
337946	0.01				
337947	0.01				
337948	0.01				
337949	0.01				
337950	0.10				
337951	0.01				
337952	0.01				
337953	0.01				
337954	0.01				
337955	0.01				
337956	0.01				
337957	0.01				
337958	0.01				
337959	0.02				
337960	0.01				
337961	0.01				
STANDARD R-2a/OxL34	15.00	5.73			

Sample type: DRILL CORE R150. Samples beginning 'RE' are Reconc and 'RRE' are Reject Reconc.

All results are considered the confidential property of the client. TTM assumes no liabilities for actual cost of the analysis only.

Date: 6/11

<small> ARIZONA ANALYTICAL LABORATORIES, LTD. 252 S. WASHINGTON ST. VANCOUVER, BC V6A 1H6. PHONE (604) 253-3558 FAX (604) 253-1776 1100 SUITE 200 VANCOUVER, BC ASSAY CERTIFICATE THE VANCOUVER INC. LTD. VANCOUVER, BC 4000 BURNBURY ST. VANCOUVER, BC V6H 1K6 </small>			
SAMPLE #	Mo %	Cu Sample %	Mo Sample %
G.	<.001	<.001	-
337962	.007	.007	2.19
337963	.017	.017	3.20
337964	.052	.052	3.98
337965	.047	.047	3.08
337966	.004	.004	2.58
337967	.018	.018	4.13
337968	.017	.017	3.94
337969	.010	.010	4.05
337970	.025	.025	4.23
337971	.020	.020	4.12
337972	.012	.012	4.12
337973	.029	.029	3.66
337974	.012	.012	3.96
337975	.037	.037	3.21
337976	.012	.012	3.44
337977	.011	.011	3.83
337978	.033	.033	3.04
337979	.010	.010	3.46
337980	.013	.013	3.34
337981	.017	.017	3.37
337982	.009	.009	3.27
337983	.021	.021	3.11
337984	.011	.011	3.51
337985	.005	.005	3.74
337986	.010	.010	3.76
337987	.013	.013	3.80
337988	.004	.004	3.81
R-2 337988	.004	.004	-
R-2 337988	.004	.004	-
337989	.024	.024	3.85
337990	.017	.017	3.99
337991	.014	.014	3.51
337992	.021	.021	3.24
337993	.082	.082	4.18
STANDARD R-2a	.047	.054	-

GROUP 710 - 0.500 g SAMPLE, 4 ACID (HF-HClO₄-HNO₃-HCl) DIGESTION TO 100 uL, ANALYSIS BY ICP-MS.
 - SAMPLE TYPE: UR - CUTP #153 Sample description: "R" ore Section: "R-2" AOR: R-2 cutp #153

Date: 1/18/06 DATE RECEIVED: JAN 31 2006 DATE REPORT MAILED: 2006-18-17 10:08:06



All results are considered the confidential property of the client. Aral reserves the liabilities for actual cost of the analysis only.

AA 407 WILSON		TTM Resources Inc. FILE # A504517		Page 2		AA 407 WILSON	
SAMPLE#	Mg %	Cu %	Sample				
			Kg				
Q-	0.002	300	-				
337993	0.002	330	4.81				
337995	0.002	305	4.45				
337996	0.002	308	4.45				
337997	0.002	013	4.50				
337998	0.001	019	2.02				
337999	0.001	001	1.02				
338000	0.001	009	4.29				
338001	0.001	005	3.42				
338002	0.001	016	4.67				
338003	0.001	018	4.38				
338004	0.001	017	4.50				
RE 338004	0.001	017	-				
RRE 338004	0.001	010	-				
338005	0.001	007	4.50				
338006	0.001	012	6.45				
338007	0.001	005	4.45				
338008	0.001	011	4.33				
338009	0.001	014	3.81				
338010	0.001	017	3.97				
338011	0.001	014	3.75				
338012	0.001	010	3.99				
338013	0.001	007	4.43				
338014	0.001	007	4.33				
338015	0.001	014	3.37				
338016	0.001	005	4.55				
338017	0.001	004	2.81				
338018	0.001	009	2.66				
338019	0.001	004	3.96				
STANDARD R-2a	0.047	550	-				

Sample type: DRILL CORE RISC. Samples beginning 'RE' are Returns and 'RRE' are Reject Returns.

All results are considered the confidential property of the client. Acme assumes the liabilities for actual cost of the analysis only. Date: 1-88

ACME ANALYTICAL LABORATORIES LTD. 557 E. BAYVIEW RD. VANCOUVER BC V7A 1K6 PHONE (604) 251-3179 FAX (604) 251-1724		ASSAY CERTIFICATE	
ACME RESOURCES INC. 5110 E. 146th ST. VANCOUVER BC V3R 0C1			
SAMPLE#	Ag	Au	
	gm/mt	gm/mt	
337961	.01	.01	
337962	.01	.01	
337963	.01	.01	
337964	.01	.01	
337965	.01	.01	
337966	.01	.01	
337967	.01	.01	
337968	.01	.01	
337969	.01	.01	
337970	.01	.01	
337971	.01	.01	
337972	.01	.01	
337973	.01	.01	
337974	.01	.01	
337975	.01	.01	
337976	.01	.01	
337977	.01	.01	
337978	.01	.01	
337979	.01	.01	
337980	.01	.01	
337981	.01	.01	
337982	.01	.01	
337983	.01	.01	
337984	.01	.01	
337985	.01	.01	
337986	.02	.01	
337987	.01	.01	
337988	.01	.01	
HR5 337988	.02	.01	
HR5 337988	.01	.01	
337989	.01	.01	
337990	.01	.01	
337991	.01	.01	
337992	.01	.01	
337993	.01	.01	
STANDARD R-2a/OxL34	161	5.83	

GROUP 6 - PRECIOUS METALS BY FIRE ASSAY FROM I.A.T. SAMPLE, ANALYSIS BY ICP-MS.
 - SAMPLE TYPE: PILL CORE #150
 - SAMPLES DESIGNATED 'AG' AND 'AU' ARE FOR AG AND AU ONLY.

DATE: 1 PA _____ DATE RECEIVED: JUN 31 2006 DATE REPORT MAILED: 2006-08-15 10:41:50

All results are considered the confidential property of the client. Acme assumes the liabilities for actual cost of the analysis only.



AA ANALYTICAL		TEN Resources Inc. FILE # A604517	Page 2	AA ANALYTICAL	
SAMPLE#	Ag** gm/mt	Au** gm/mt			
G-1		.01			
337994		.01			
337995		.01			
337996		.01			
337997		.01			
337998		.01			
337999		.01			
338000		.01			
338001		.01			
338002		.01			
338003		.01			
338004		.00			
RE 338004		.01			
RRE 338004		.01			
338005		.01			
338006		.01			
338007		.01			
338008		.01			
338009		.01			
338010		.01			
338011		.01			
338012		.01			
338013		.02			
338014		.01			
338015		.01			
338016		.01			
338017		.01			
338018		.01			
338019		.01			
STANDARD R-2a/OxL34	1	.01			

Sample type: DRILL CORE RL30. Samples beginning 'RE' are Reruns and 'RRE' are Reject Reruns.

All results are considered the confidential property of the client. Assay extra's the facilities for actual cost of the analysis only. Data 1 FA

AA		AA	
ACME ANALYTICAL LABORATORIES LTD. 552 W. EASTMOOR ST., VANCOUVER BC V6A 1K6 PHONE (604) 251-1150 FAX (604) 251-1154			
ISO 9001 Accredited			
ASSAY DESIGNATION			
SAMPLER NAME: IAG			
PROJECT: ANGLITA			
DATE: 2006-08-25			
LOCATION: Vancouver BC			
SAMPLE#	Mo %	Cu %	
G-1	.001	.001	
338021	.002	.013	
338022	.003	.026	
338023	.004	.026	
338024	.001	.020	
338025	.010	.024	
338026	.002	.015	
338027	.005	.028	
338028	.001	.068	
338029	.006	0.000	
338030	.006	.033	
338031	.009	.017	
338032	.001	.003	
338035	.005	.003	
338034	.013	.004	
338035	.009	.026	
338036	.002	.013	
338037	.003	.053	
338038	.010	.003	
338039	.016	.024	
338040	.004	.009	
338041	.021	.007	
338042	.010	.007	
338043	.012	.063	
338044	.017	.008	
338045	.006	.016	
338045	.006	.016	
338045	.007	.017	
338046	.004	.011	
338047	.006	.005	
338048	.022	.015	
338049	.002	.011	
338050	.007	.009	
338051	.011	.020	
338052	.033	.014	
STANDARD K-2a	.047	.566	

GROUP 7B - 0.500 gm SAMPLE, 4 ACID (H-F-HClO4-HNO3-CL) DIGESTION TO 100 ML, ANALYSIS BY ICP-MS.
 - SAMPLE TYPE: DRILL CORE R150 Samples beginning "85" are Refusa and "86" are Reject Refusa.

Data h FA _____ DATE RECEIVED: AUG 3 2006 DATE REPORT MAILED: 2006-08-25 10:31:19



All results are considered the confidential property of the client. Acme assumes no liabilities for actual cost of the analysis only.

AA K&S ANALYTICAL		TCM Resources Inc. FILE # A604674	Page 2	AA K&S ANALYTICAL
SAMPLE#	Mo	Cu		
G-1	4.001	.001		
338054	4.001	.015		
338054	4.001	.067		
338055	4.001	.019		
338056	4.001	.061		
338057	4.001	.021		
338058	4.002	.077		
338059	4.002	.023		
RE 338059	4.002	.024		
RRE 338059	4.002	.023		
338060	4.001	.008		
338061	4.001	.014		
338062	4.001	.009		
338063	4.001	.013		
338064	4.001	.008		
338065	4.001	.028		
338066	4.001	.067		
338067	4.001	.009		
338068	4.001	.009		
338069	4.001	.004		
338070	4.001	.016		
338071	4.001	.012		
338072	4.001	.003		
338073	4.001	.004		
338074	4.006	.006		
338075	4.001	.013		
338075	4.001	.028		
338077	4.001	.009		
338078	4.001	.013		
338079	4.001	.002		
338080	4.001	.004		
338081	4.001	.004		
338082	4.001	.001		
338083	4.001	.009		
338084	4.001	.004		
STANDARD R 2a	4.051	.586		

Sample type: DRILL CORE R150. Samples beginning 'RE' are Retruns and 'RRE' are Reject Retruns.

All results are considered the confidential property of the client. ACM assumes no liabilities for actual cost of the analysis only.

DLM *lva*

ACME ANALYTICAL LABORATORIES INC. 315 W. BASTINGS ST. VANCOUVER BC V6A 1K6 PHONE (604) 253-3788 FAX (604) 253-1718	
ANALYTICAL CERTIFICATE	
LTM Resources Inc. 511 W. MILLIKEN AVE. VANCOUVER BC V6A 1K6	
SAMPLE#	Au** gm/mt
G-1	.01
338021	.01
338022	.01
338023	.01
338024	.02
338025	.01
338026	.01
338027	.01
338028	.01
338029	.01
338030	.01
338031	.01
338032	.01
338033	.01
338034	.01
338035	.02
338036	.01
338037	.01
338038	.01
338039	.01
338040	.01
338041	.01
338042	.02
338043	.01
338044	.01
338045	.01
REF 338045	.01
REF 338045	.01
338046	.01
338047	.01
338048	.01
338049	.01
338050	.01
338051	.01
338052	.01
STANDARD R-2a/CXL34	158 5.70

GROUP G - PRECIOUS METALS BY FIRE ASSAY FROM S.A.T. SAMPLE, ANALYSIS BY ICP-MS.
 - SAMPLE TYPES: DRILL CORES RICH
 Sample designations "GR" are GRADES and "REF" are REFLECT RETURNS.

Date *d 7A* DATE RECEIVED: JUN 3 2006 DATE REPORT MAILED: 2006-06-23 10:33:11

All results are considered the confidential property of the client. Acme assumes the liability for actual cost of the analysis only.



AA ANALYTICAL		ITM Resources Inc. FILE # A5C4674	Page 2		AA ANALYTICAL	
SAMPLE#		Ag	Au			
		gm/mt	gr/mt			
338051		4.01	4.01			
338053		4.01	4.01			
338054		4.01	4.01			
338055		4.01	4.01			
338056		4.01	4.01			
338057		4.01	4.01			
338058		4.01	4.01			
338059		4.01	4.01			
RR 338059		4.01	4.01			
RRR 338059		4.01	4.01			
338060		4.01	4.01			
338061		4.01	4.01			
338062		4.01	4.01			
338063		4.01	4.01			
338064		4.01	4.01			
338065		4.01	4.01			
338066		4.01	4.01			
338067		4.01	4.01			
338068		4.01	4.01			
338069		4.01	4.01			
338070		4.01	4.01			
338071		4.01	4.01			
338072		4.01	4.01			
338073		4.01	4.01			
338074		4.01	4.01			
338075		4.01	4.01			
338076		4.01	4.01			
338077		4.01	4.01			
338078		4.01	4.01			
338079		4.01	4.01			
338080		4.01	4.01			
338081		4.01	4.01			
338082		4.01	4.01			
338083		4.01	4.01			
338084		4.01	4.01			
STANDARD R-2a/OxL34		157	5.70			

Sample type: DRILL CORE R150. Samples beginning 'RR' are Returns and 'RRE' are Reject Returns.

All results are considered the confidential property of the client. AIA Assumes the liabilities for actual cost of the analysis only. Date: FA

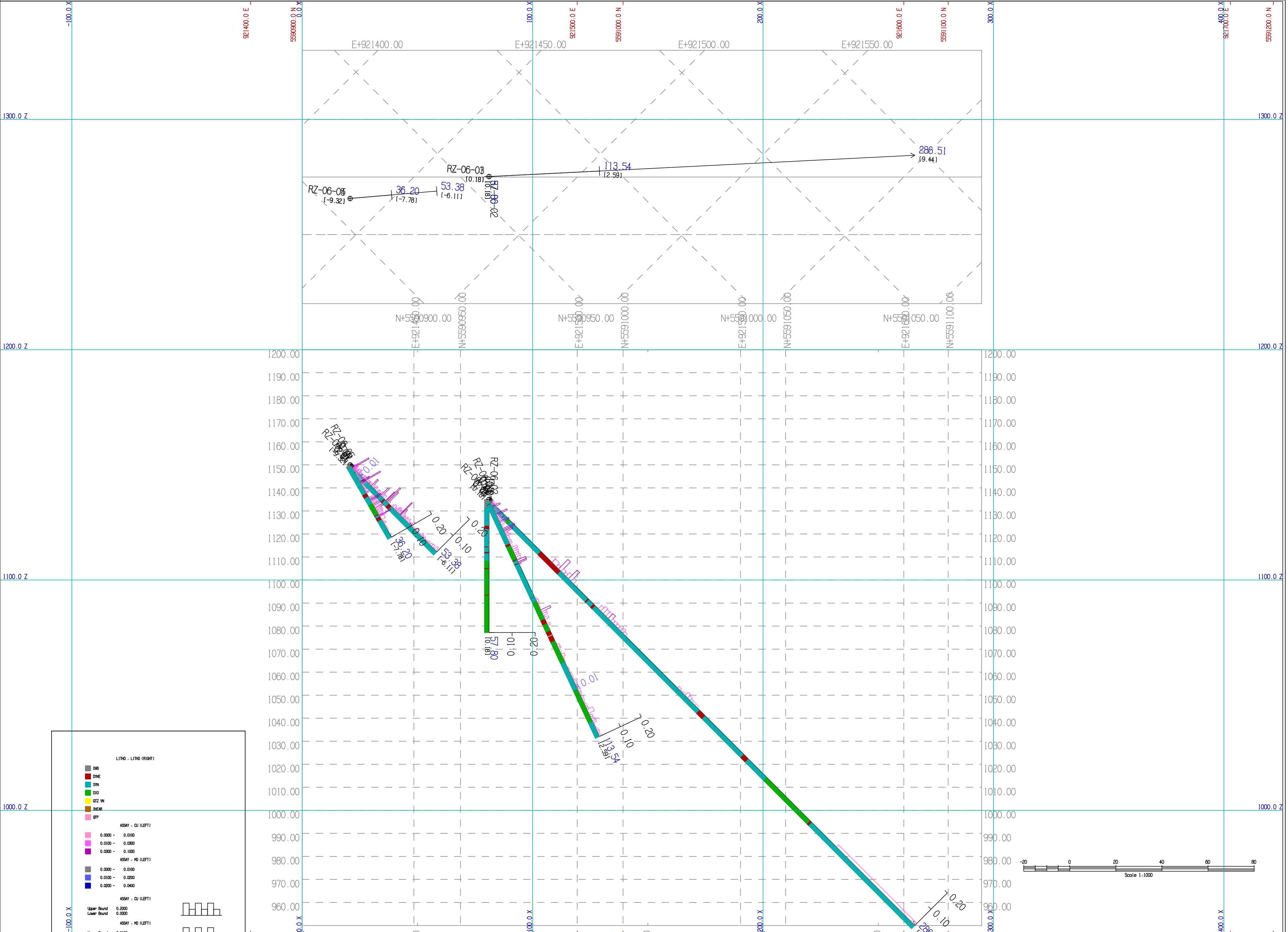

LITHO - LITHO (RIGHT)

- OMC
- OMC
- S1N
- O1D
- GIZ VN
- SHEAR
- QP

ASSAY - CI (LEFT)

- 0.0000 - 0.0100
- 0.0100 - 0.0200
- 0.0200 - 0.1000

ASSAY - M3 (LEFT)

- 0.0000 - 0.0100
- 0.0100 - 0.0200
- 0.0200 - 0.0400

ASSAY - CI (LEFT)

Upper Bound 0.0200
Lower Bound 0.0000

ASSAY - M3 (LEFT)

Upper Bound 0.0100
Lower Bound 0.0000

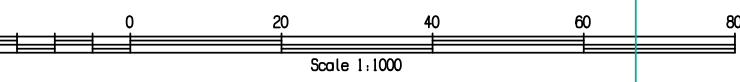

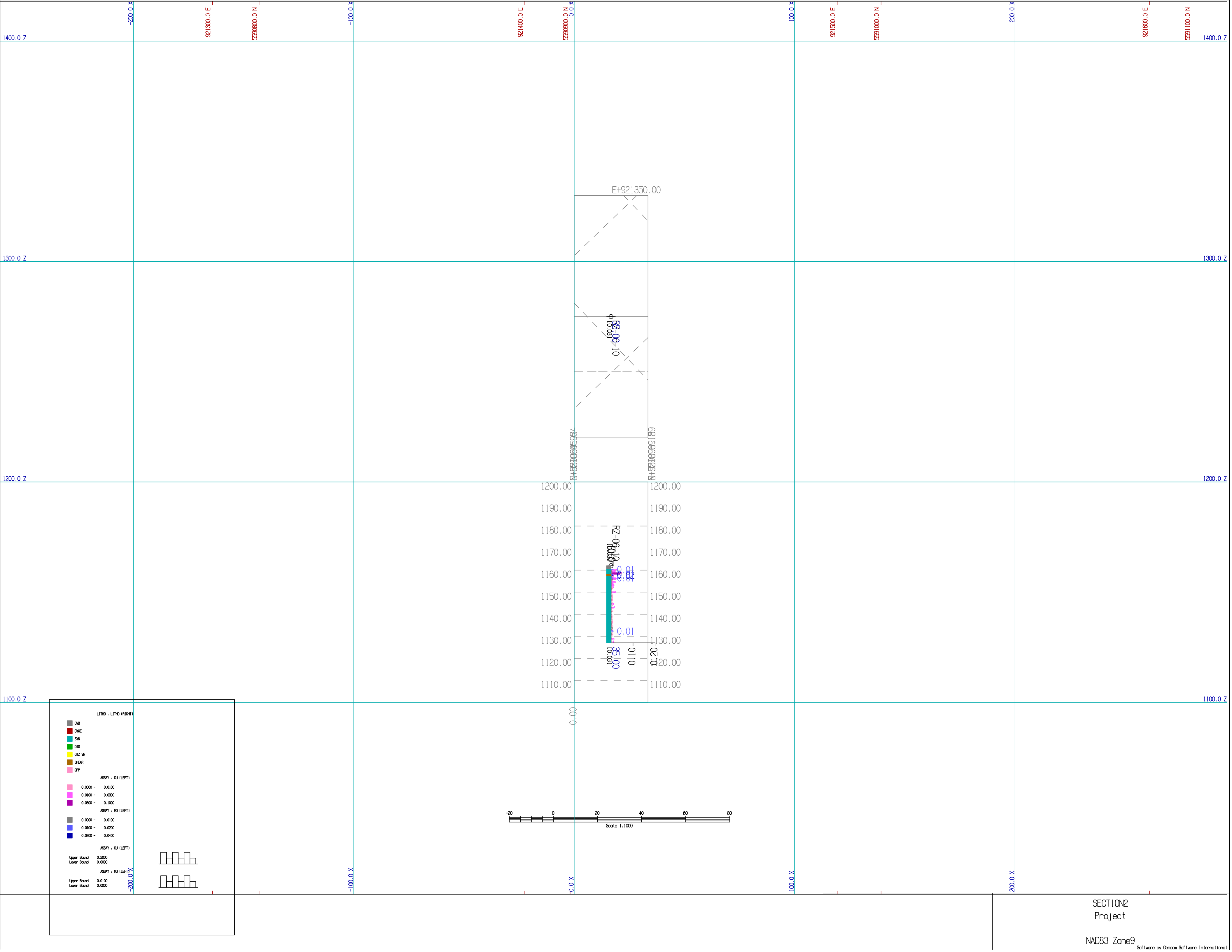

LT10 - LT10 (RIGHT)

- DM6
- DM6E
- SM
- D10
- GTZ W
- SHEAR
- GP

ASSAY - OU (LEFT)

- 0.0000 - 0.0100
- 0.0100 - 0.0300
- 0.0300 - 0.1000

ASSAY - MD (LEFT)

- 0.0000 - 0.0100
- 0.0100 - 0.0200
- 0.0200 - 0.0400

ASSAY - OU (LEFT)

Upper Bound 0.2000
Lower Bound 0.0000

ASSAY - MD (LEFT)

Upper Bound 0.0100
Lower Bound 0.0000

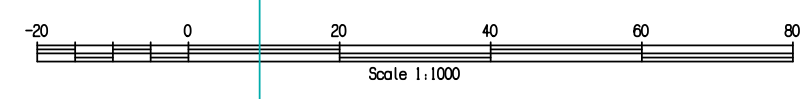

SECTION2
Project
NAD83 Zone9
Software by Geosoft Software International

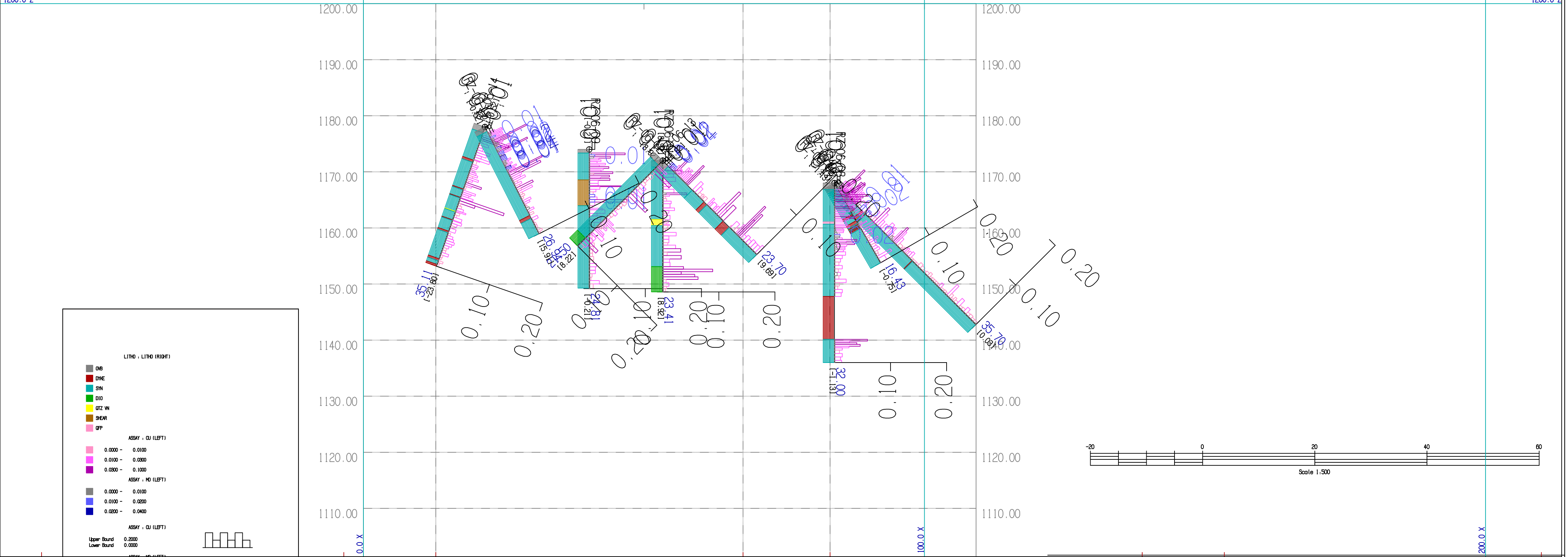
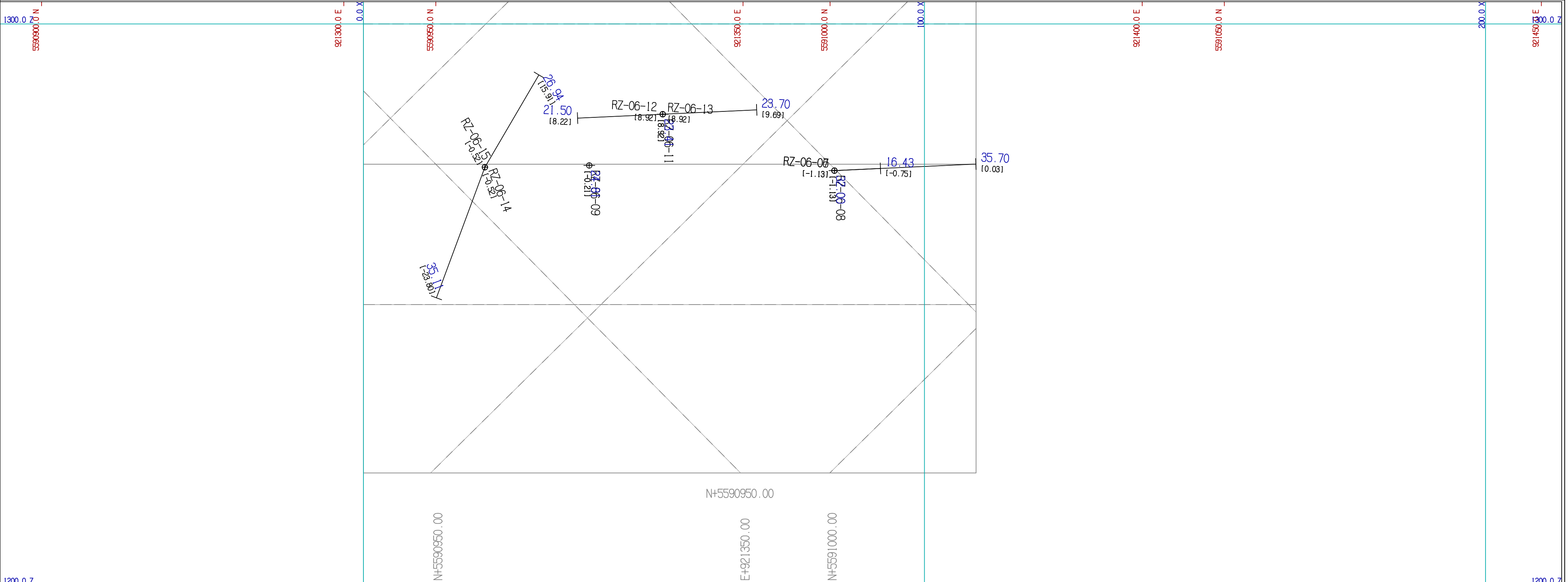

LITHO - LITHO (RIGHT)

- OMB
- OME
- SM
- SIN
- SND
- QTZ VN
- SEWR
- QP

ASSAY - CU (LEFT)

- 0.0000 - 0.0100
- 0.0100 - 0.0300
- 0.0300 - 0.1000

ASSAY - MO (LEFT)

- 0.0000 - 0.0100
- 0.0100 - 0.0200
- 0.0200 - 0.0400

ASSAY - CU (LEFT)

Upper Bound 0.2000
Lower Bound 0.0000

ASSAY - MO (LEFT)

Upper Bound 0.0100
Lower Bound 0.0000

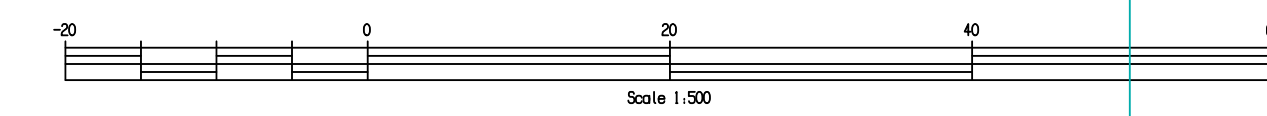

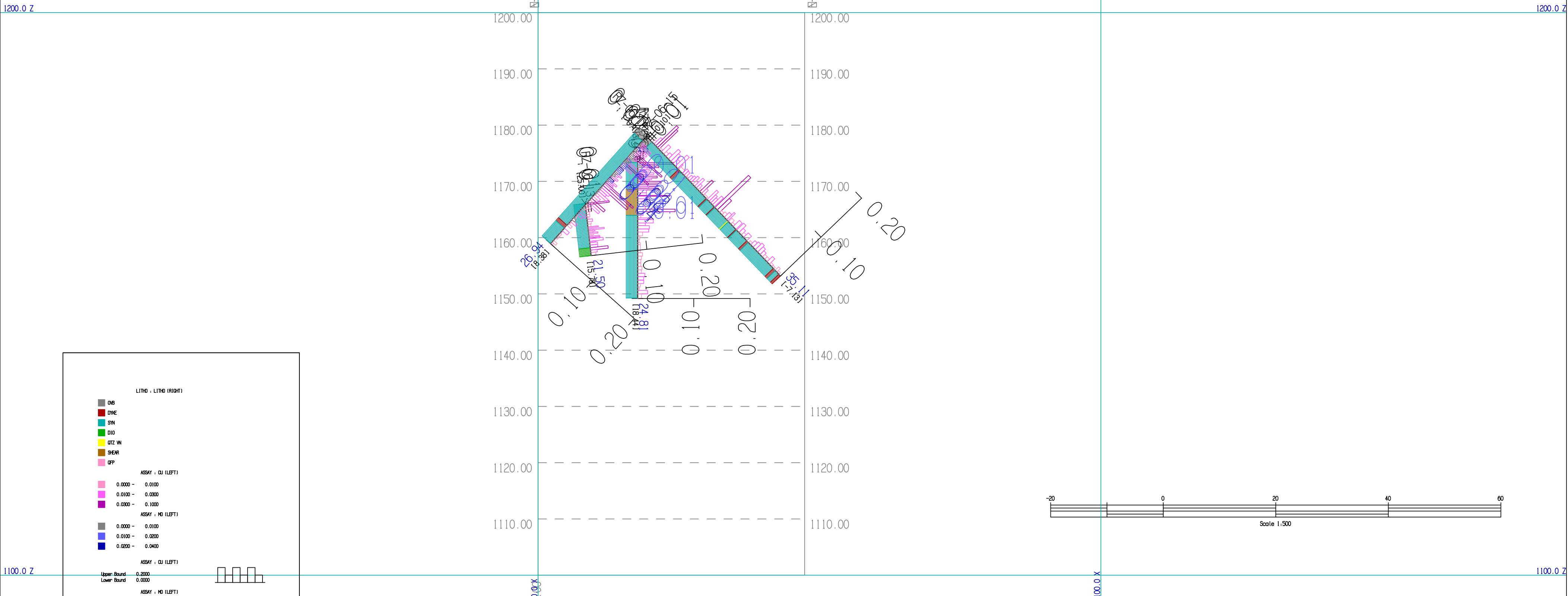
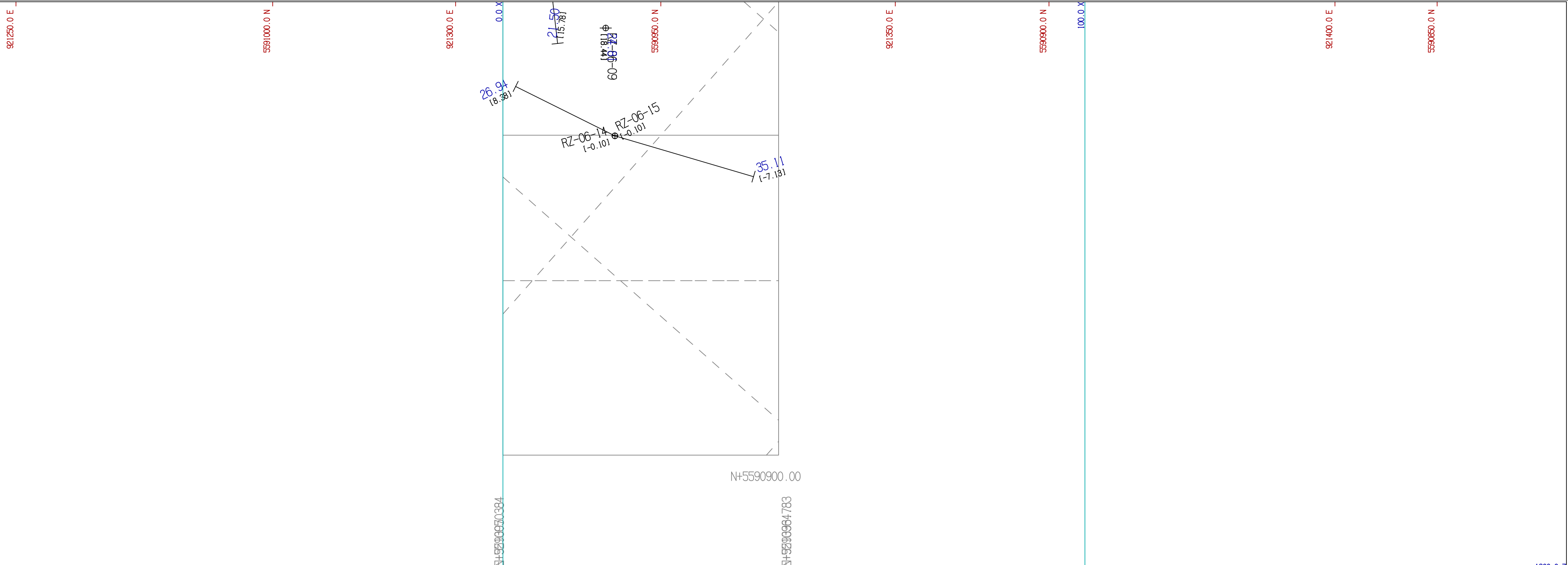

LITRO - LITRO (RIGHT)	
■	OM
■	DME
■	SM
■	DID
■	QTZ MN
■	SHEAR
■	OPP

ASSAY - QI (LEFT)	
■	0.0000 - 0.0100
■	0.0100 - 0.0300
■	0.0300 - 0.1000

ASSAY - MD (LEFT)	
■	0.0000 - 0.0100
■	0.0100 - 0.0200
■	0.0200 - 0.0400

ASSAY - QI (LEFT)	
Upper Bound	0.2000
Lower Bound	0.0000

ASSAY - MD (LEFT)	
Upper Bound	0.0100
Lower Bound	0.0000

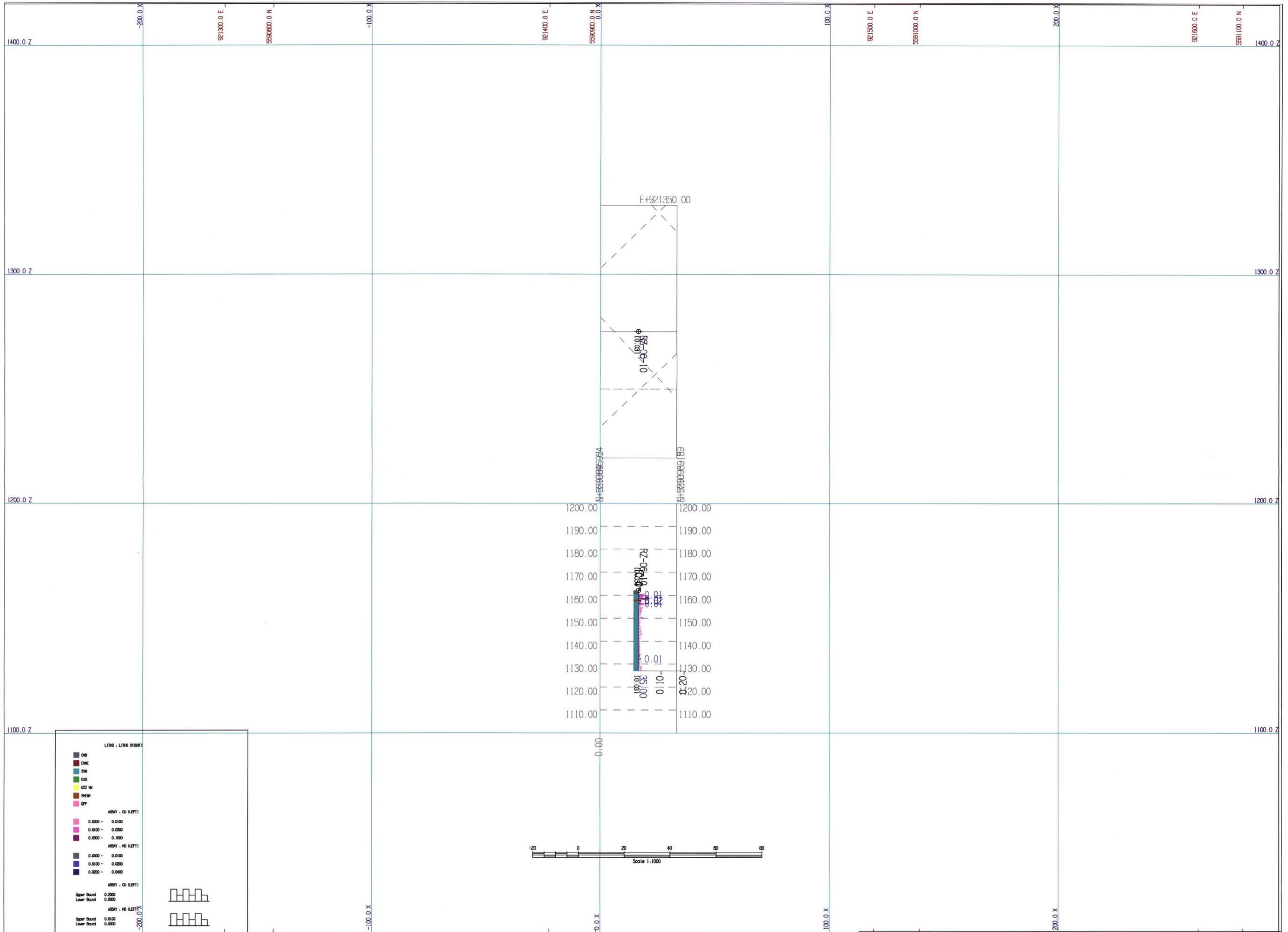

LRG - LRG (RIGHT)

- O6
- O6E
- SW
- O3
- O2 W
- O2E
- O7

ASRY - OJ (LEFT)

- 0.0000 - 0.0100
- 0.0100 - 0.0200
- 0.0200 - 0.1000

ASRY - FO (LEFT)

- 0.0000 - 0.0100
- 0.0100 - 0.0200
- 0.0200 - 0.0400

ASRY - OJ (LEFT)

- Upper Bound 0.2000
- Lower Bound 0.0000

ASRY - FO (LEFT)

- Upper Bound 0.0100
- Lower Bound 0.0000

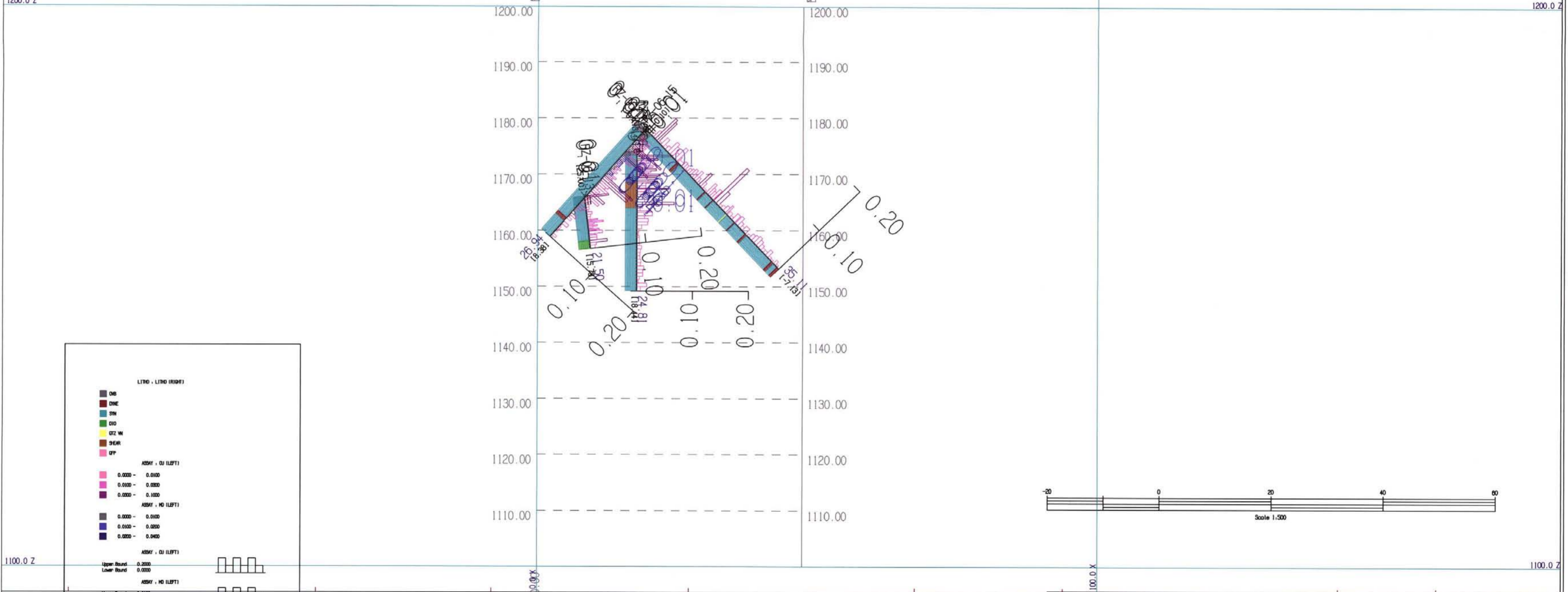
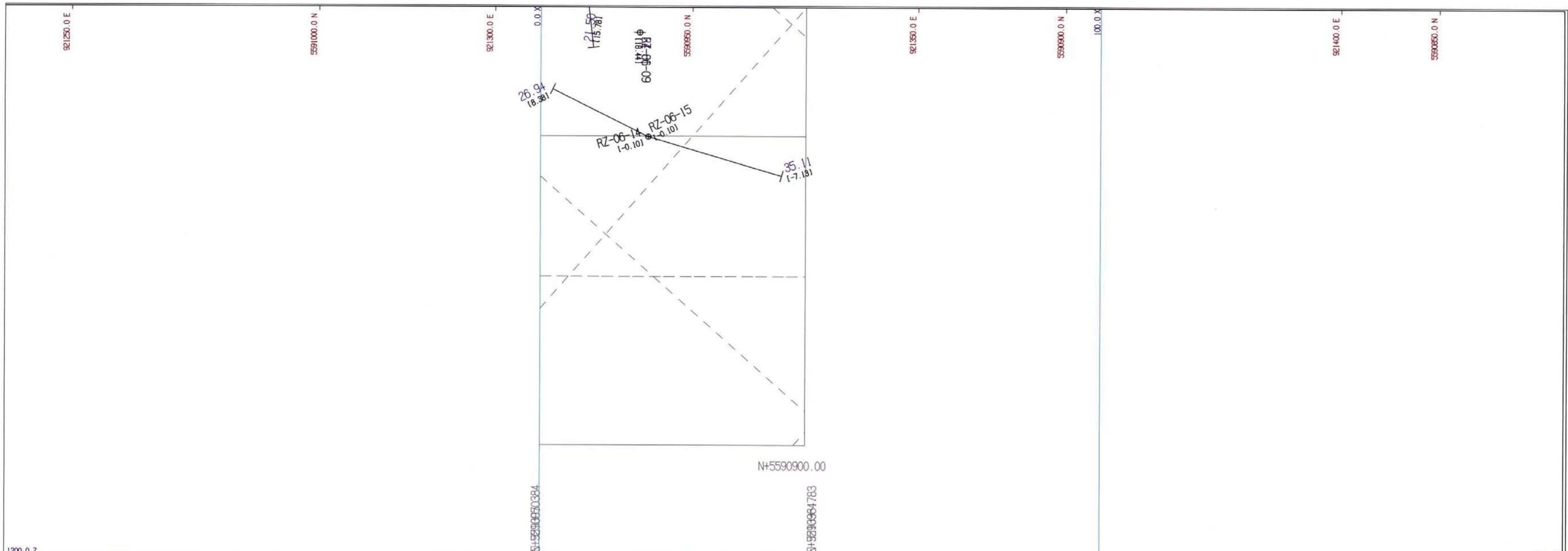

Legend

LINE - LINE (RIGHT)

- ONE
- TWO
- THREE
- FOUR
- FIVE
- SIX
- SEVEN
- EIGHT
- NINE
- TEN

ASSAY - DI (LEFT)

- 0.0000 - 0.0100
- 0.0100 - 0.0200
- 0.0200 - 0.0300

ASSAY - HD (LEFT)

- 0.0000 - 0.0100
- 0.0100 - 0.0200
- 0.0200 - 0.0300

ASSAY - DI (RIGHT)

- Upper Bound 0.0000
- Lower Bound 0.0000

ASSAY - HD (RIGHT)

- Upper Bound 0.0000
- Lower Bound 0.0000