

Exploration and Development Work Technical Report

Report Date: August 30, 2007

Report Author: Dean Michael Arbic FMC # 133434

Mineral Claim Tenure # 540291

Claim Name: Iron Horse

Mining District: Nanaimo

Technical Work / Prospecting / Sampling and Geochemical Assay Testing

Date Work Began: September 01, 2006

Date Work Completed: November 14, 2006

Work Description: Arrive at claim 2 pm on Sept 01 2006 and found a large vein of exposed bedrock near remnants of a de-activated logging road. I took a sample of approximately 2 liters in volume weighing approximately 2 kg. I used a hand pick and a hammer and chisel. I recorded the sample location with my eXplorist 100 GPS unit. The bedrock had blebs of chalcopyrite so I thought it should be tested. In October of 2006 I sent 150 grams of the bedrock to Acme Labs for testing. The Assay certificates are included (2 pages) and a location map.

Sept. 01 2006- Remove 2 kg. Of bedrock from claim from 2 pm to 4 pm totals 2 hours

October 11 2006- Ship 150 grams to Acme Analytical Laboratories for Geochemical Testing.

November 14 2006 Assay work completed and Acme sends the results to me in mail.

Statement of Work and Cost.

Labour 2 hours @ \$30.00 per hour equals.....\$60.00

Assay Costs for 1 sample Geo4 and R150 plus shipping and surcharge.....\$36.26

Total Technical Costs .....\$96.26

I declare this to be true and correct Dean M. Arbic Date Sept. 13 2007

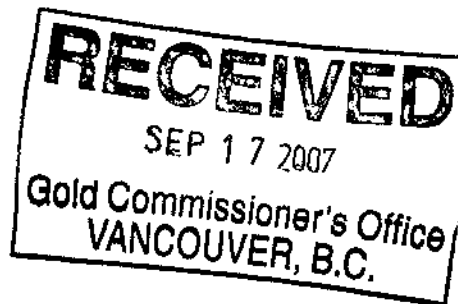

29321

### Additional Comments and Conclusions

The sample is chalcopyrite even though the appearance was very silvery, I thought it might be silver.

The assay results are interesting and I have staked another claim in the direction the vein of chalcopyrite was heading. The potential for a large deposit of copper or precious metals exists there. The sample is 16.54% iron, and 2452 ppm copper, a trace of silver was found at 1.9 ppm, a small trace of gold was also detected at 28 ppb.

GEOCHEMICAL ANALYSIS CERTIFICATE



Arbic, Dean Michael PROJECT MINERAL EXPLORATION File # A607623

P.O. Box 415 Lake Cowicha, B.C. V0R 2G0 Submitted by: Dean Michael Arbic



SAMPLE#	Mo ppm	Cu ppm	Pb ppm	Zn ppm	Ag ppm	Ni ppm	Co ppm	Mn ppm	Fe %	As ppm	U ppm	Au ppm	Th ppm	Sr ppm	Cd ppm	Sb ppm	Bi ppm	V ppm	Ca %	P %	La ppm	Cr ppm	Mg %	Ba ppm	Ti %	B ppm	Al %	Na %	K %	W ppm
G-1	<1	3	<3	45	<.3	4	3	541	1.80	<2	<8	<2	4	106	<.5	<3	<3	40	.65	.067	10	14	.55	231	.14	<3	1.31	.21	.61	<2
Chanterelle2A	1	26	8	70	<.3	14	11	309	3.14	<2	<8	<2	4	22	<.5	<3	<3	117	.26	.066	6	37	1.19	328	.16	<3	1.78	.12	.90	2
Socrates	1	28	3	77	.5	35	10	1407	4.10	4	<8	<2	<2	12	<.5	<3	<3	104	2.06	.057	5	33	1.30	34	.35	14	2.37	.09	.04	<2
Jupiter	9>10000	5	126	25.9	71	41	1743	31.29	118	<8	<2	2	1	1.2	<3	88	15	7.99	.011	6	8	.03	10	<.01	<3	.18	<.01	.01	36	
Iron Horse	19	2452	39	28	1.9	27	13	192	16.54	14	<8	<2	<2	13	<.5	5	<3	14	.26	.017	5	6	.17	9	<.01	<3	.55	.01	.25	<2
STANDARD DS7	20	101	66	407	.8	50	8	606	2.30	47	<8	<2	4	70	6.4	6	4	83	.90	.077	12	172	1.00	374	.12	37	.93	.08	.45	5

GROUP 1D - 0.50 GM SAMPLE LEACHED WITH 3 ML 2-2-2 HCL-HNO3-H2O AT 95 DEG. C FOR ONE HOUR, DILUTED TO 10 ML, ANALYSED BY ICP-ES.  
(>) CONCENTRATION EXCEEDS UPPER LIMITS. SOME MINERALS MAY BE PARTIALLY ATTACKED. REFRACTORY AND GRAPHITIC SAMPLES CAN LIMIT AU SOLUBILITY.  
ASSAY RECOMMENDED FOR ROCK AND CORE SAMPLES IF CU PB ZN AS > 1%, AG > 30 PPM & AU > 1000 PPB  
- SAMPLE TYPE: ROCK R150

Date 10/13/06 FA \_\_\_\_\_ DATE RECEIVED: OCT 13 2006 DATE REPORT MAILED:.....



ACME ANALYTICAL LABORATORIES LTD.  
(ISO 9001 Accredited Co.)

852 E. HASTINGS ST. VANCOUVER BC V6A 1R6

PHONE (604) 253-3158 FAX (604) 253-1716



GEOCHEM PRECIOUS METALS ANALYSIS



Arbic, Dean Michael PROJECT MINERAL EXPLORATION File # A607623

P.O. Box 415 Lake Cowicha, B.C. V0R 2G0 Submitted by: Dean Michael Arbic

SAMPLE#	Au** ppb	Pt** ppb	Pd** ppb
G-1	<2	<3	3
Chanterelle2A	<2	3	8
Socrates	<2	4	<2
Jupiter	207	<3	3
Iron Horse	28	<3	3
STANDARD FA-10R	489	473	471

GROUP 3B - FIRE GEOCHEM AU, PT, PD - 30 GM SAMPLE FUSION, DORE DISSOLVED IN AQUA - REGIA, ICP ANALYSIS. UPPER LIMITS = 10 PPM.  
GROUP 6 AU RECOMMENDED IF >10PPM FOR 30 GM, >5PPM FOR 50 GM.  
- SAMPLE TYPE: ROCK R150

Data FA

DATE RECEIVED: OCT 13 2006 DATE REPORT MAILED: 11-11-06

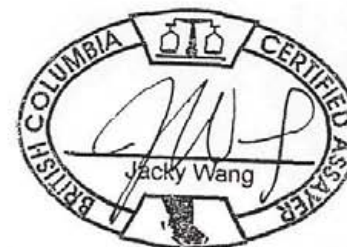



# Iron Horse 540291 Geochemical Sample Location

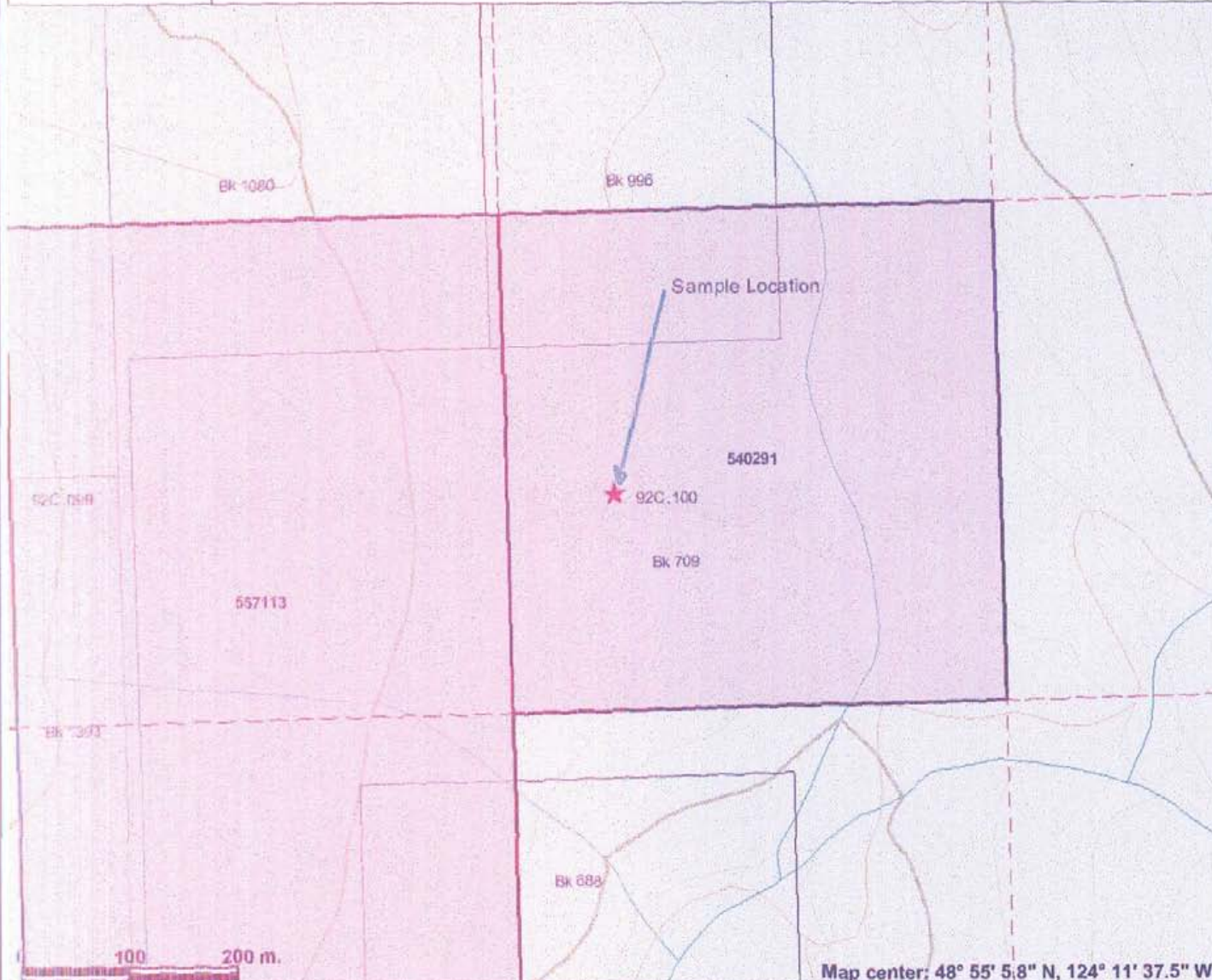

### Legend

- Indian Reserves
- National Parks
- Parks
- MTO Grid (MTO)
- Mineral Tenure (current)
  - Mineral Claim
  - Mineral Lease
  - Mineral Reserves (current)
    - Placer Claim Designation
    - Placer Lease Designation
    - No Staking Reserve
    - Conditional Reserve
    - Release Required Reserve
    - Surface Restriction
    - Recreation Area
    - Others
  - Integrated Cadastral Fabric
  - Survey Parcels
  - BCGS Grid
- Contours (TRIM)
  - Contour - Index
  - Contour - Index.Indefinite
  - Contour - Index.Depression
  - Contour - Index.Depression Indefinite
  - Contour - Intermediate
  - Contour - Intermediate.Indefinite
  - Contour - Intermediate.Depression
  - Contour - Intermediate.Depression Indefinite
- Area of Exclusion
- Area of Indefinite Contours
- Annotation (1:20K)
- Transportation - Points (TRIM)

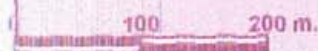

Map center: 48° 55' 5.8" N, 124° 11' 37.5" W

Scale: 1:5,613

This map is a user generated static output from an internet mapping site and is for general reference only. Data layers that appear on this map may or may not be accurate, current, or otherwise reliable. THIS MAP IS NOT TO BE USED FOR NAVIGATION.

Notes: The Location of the sample was determined using a Magellan eXplorist 100 GPS Unit. The Co-ordinates are Zone 10 N5419058 E412544

**ACME ANALYTICAL LABORATORIES LTD.**

852 East Hastings,, Vancouver, B.C., CANADA V6A 1R6

Phone: (604) 253-3158 Fax: (604) 253-1716

Our GST # 100035377 RT

**ARBIC, DEAN MICHAEL**P.O. Box 415  
Lake Cowichan, BC  
V0R 2G0Inv.#: **A607623**

Date: Nov 14 2006

QTY	ASSAY	PRICE	AMOUNT
4	GEO4 @	19.95	79.80
4	R150 - ROCK @	5.65	22.60
			102.40
	SURCHARGE FOR UNDER 20 SAMPLES PER BATCH		25.00
			127.40
	GST Taxable		7.64
	6.00% GST		
	CAD \$		<b>135.04</b>

Project: MINERAL EXPLORATION  
Samples submitted by Dean Michael Arbic

COPIES 1

Please pay last amount shown. Return one copy of this invoice with payment.

TERMS: Net two weeks. 1.5 % per month charged on overdue accounts.

[ COPY 2 ]