

RECEIVED

JAN 17 2008

Gold Commissioner's Office
VANCOUVER, B.C.

**ANNUAL REPORT
ON THE
GOLDEN NATION CLAIM
OMINECA MINING DIVISION, BC**

NTS 93 0/4

Latitude: 55 21'N

Longitude: 123 43'W

**OWNER:
Moose Creek Minerals LTD.
Box 419
Mackenzie, B.C.
V0J 2C0**

**BY:
Dave Forshaw**

November, 2007

29.532
GEOLOGICAL SURVEY BRANCH
ASSESSMENT REPORT

TABLE OF CONTENTS

LOCATION AND ACCESS	1
PROPERTY STATUS	1
PHYSIOGRAPHY	1
HISTORY	1
LOCATION MAP	2
CLAIM MAP	3
REGIONAL GEOLOGY	4
PROPERTY GEOLOGY	5
PROSPECTING TRAVERS MAP	6
SUMARY AND CONCLUSIONS	7
STATEMENT OF EXPENDITURES	8
STATEMENT OF QUALIFICATIONS	9
BIBLIOGRAPHY	10

LOCATION AND ACCESS

The Golden Nation mineral claim is located in Central British Columbia, 38 kilometers due west of the town of Mackenzie. Access to the property is by crossing Williston Lake from Mackenzie over the causeway. You drive north on the Finlay Main Line, a gravel logging road, you turn to the west on the Finlay/Nation Main Line when you come to it, Following this road, it will cross the Nation river, one kilometer further a logging road goes off to the left, this road will take you to the Golden Nation mineral claim at approximately the five kilometer singe.

PROPERTY STATUS

Name	Expiry Date	Record Number
Golden Nation	November 23 rd 07	#545815

PHYSIOGRAPHY

The property is located on an east facing side-hill which has a moderate gradient towards the Nation River. Several east-west drainages cut through the claim. Small outcrops can be found in the sides of these gullies.

Forest cover on the claim consists of spruce, balsam, alder and lodgepole pine. Approximately 1/3 of the claim has been logged and new growth of trees established.

History

The Nat property consisted of 34 contiguous two-post claims which were organized to form a single group, owned by Ruanco Enterprises Ltd. of Richmond, British Columbia. Placer Dome Inc. of Vancouver, British Columbia, optioned the Nat claims. These claims were allowed to laps and in 2007, David Forshaw staked the Golden Nation mineral claim in the approximate location

2.

MOOSE GREEK MINERALS LTD.

OMINECA M.D., BC **GOLDEN NATION**

NTS 93-0-4

LOCATION MAP

DATE: JULY 2007
BY: DF

FIGURE 1

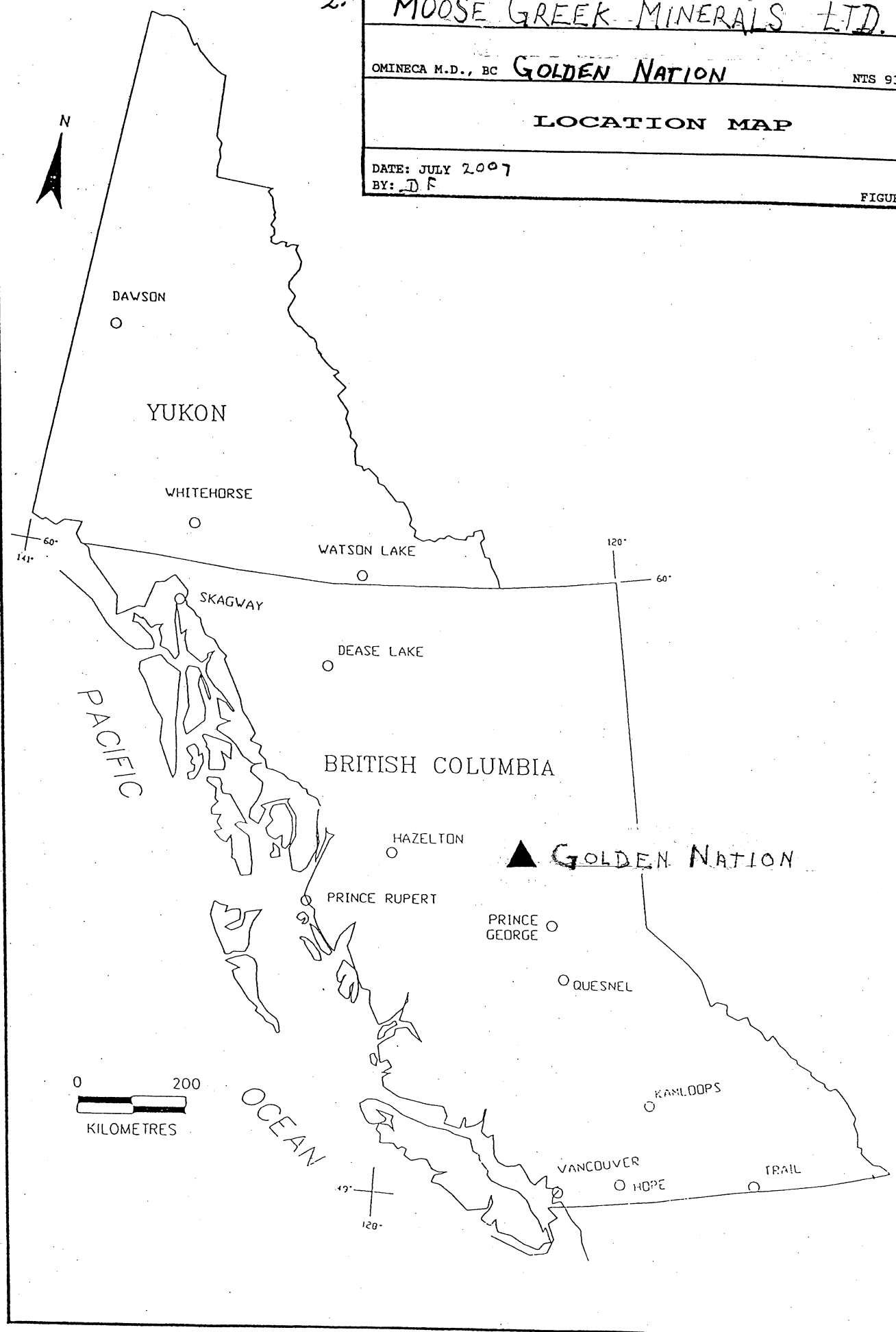

Golden Nation

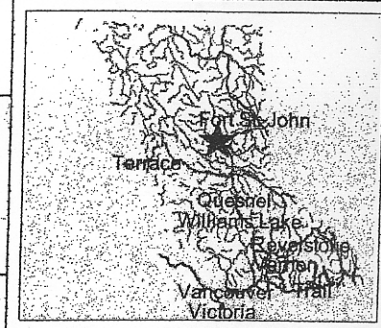
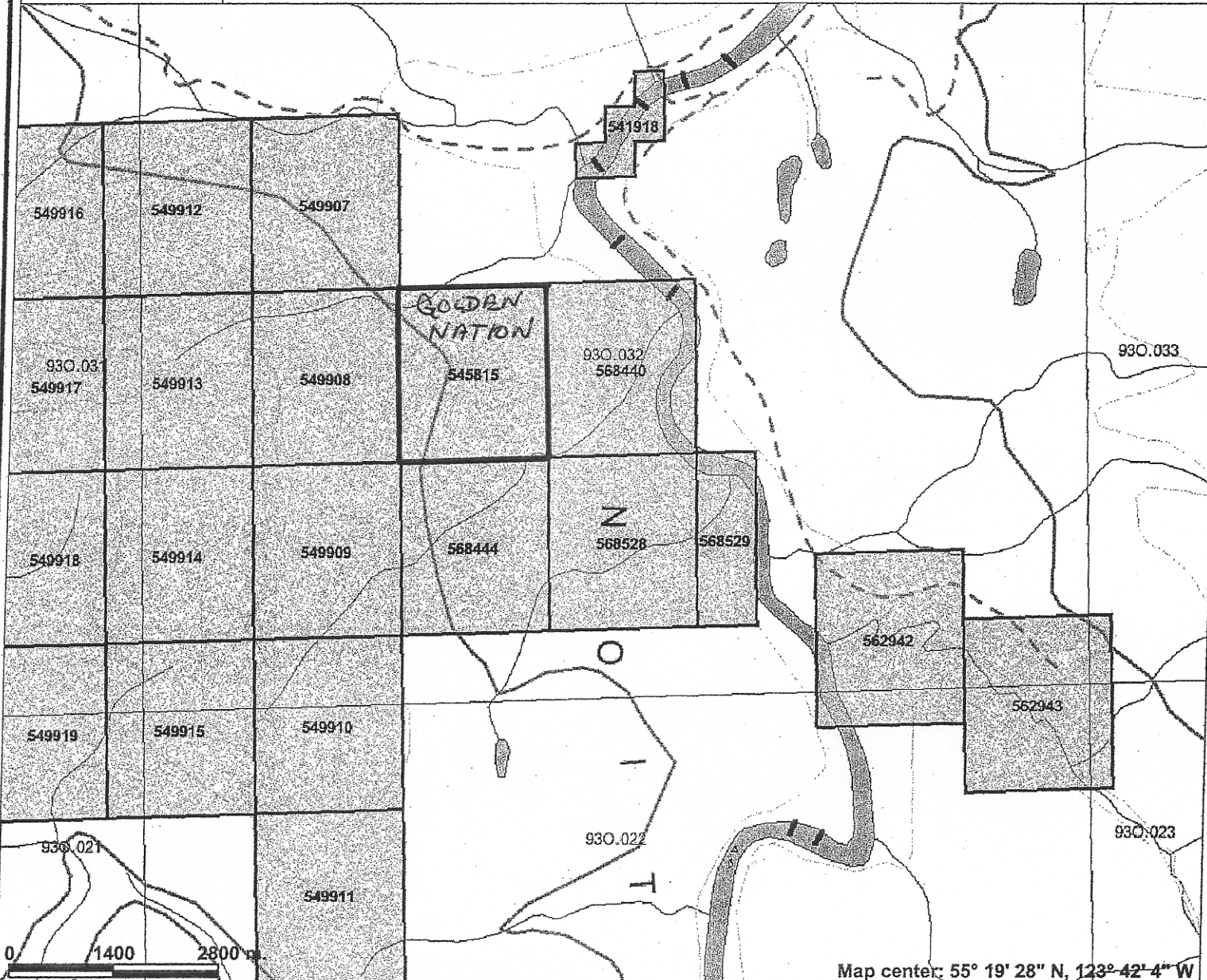

Legend

- Indian Reserves
- National Parks
- Parks
- Mineral Tenure (current)
- Mineral Claim
- Mineral Lease
- Mineral Reserves (current)
- Placer Claim Designation
- Placer Lease Designation
- No Staking Reserve
- Conditional Reserve
- Release Required Reserve
- Surface Restriction
- Recreation Area
- Others
- Survey Parcels
- BCGS Grid
- Contours (1:250K)
- Contour - Index
- Contour - Intermediate
- Area of Exclusion
- Area of Indefinite Contours
- Annotation (1:250K)
- Transportation - Points (1:250K)
- Airfield
- Anchorage - Seaplane
- Ferry Routes
- Heliport
- Seaplane Base
- Air Field
- Airport
- Air Feature - Condition Unknown
- Airport Abandoned

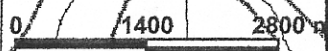

Map center: 55° 19' 28" N, 123° 42' 4" W



Scale: 1:80,668

This map is a user generated static output from an Internet mapping site and is for general reference only. Data layers that appear on this map may or may not be accurate, current, or otherwise reliable. THIS MAP IS NOT TO BE USED FOR NAVIGATION.

GEOLOGY - Regional Setting.

The Golden Nation claims are in a slice of Slide Mountain Terrane which forms part of the eastern assemblage of the Intermountain Superterrane (Wheeler et al., 1988). The Slide Mountain Terrane consists primarily of ocean-floor volcanic and sedimentary rocks probably deposited in an extensional marine tectonic environment. This terrane, as part of the large composite and allochthonous intermontane Superterrane, is believed to have been abducted onto the western margin of the North American craton in the Jurassic (Monger et al., 1982).

Government regional mapping of the area (Muller, 1961) indicates extensive deposits of glacial drift with exposed bedrock essentially restricted in areas along major drainages and at elevations above approximately 1200 m. The Golden Nation property is apparently underlain by Carboniferous volcanic and sedimentary rocks of the Slide Mountain Group or Cache Creek group. The whole region was covered during the Pleistocene by the Cordilleran ice-sheet which moved in a northeasterly direction and deposited the unconsolidated glacial materials observed today.

PROPERTY GEOLOGY = GOLDEN NATION

The claim is extensively covered with glacial deposits; bedrock exposures are very limited in number and extent. The Southern and eastern areas of the Golden Nation Property are overlain by widespread glaciofluvial deposits to a minimum of 60 m in thickness. The northern sector of the property is a very hummocky terrain with numerous large boulders at surface indication an area of ablation till.

There have been 16 outcrops found, either on the top of hills or in the banks of creeks or on very steep slopes. Three distinct rock units have been found on the Golden Nation property. These include bedrock exposures of argillite, ultramafic, and highly altered ultramafic rocks. The contacts between these units have not been found.

54191

549920

549916

549912

549907

549921

549917

549913

549908

549915

549922

549918

549914

549909

549919

549915

549910

549911

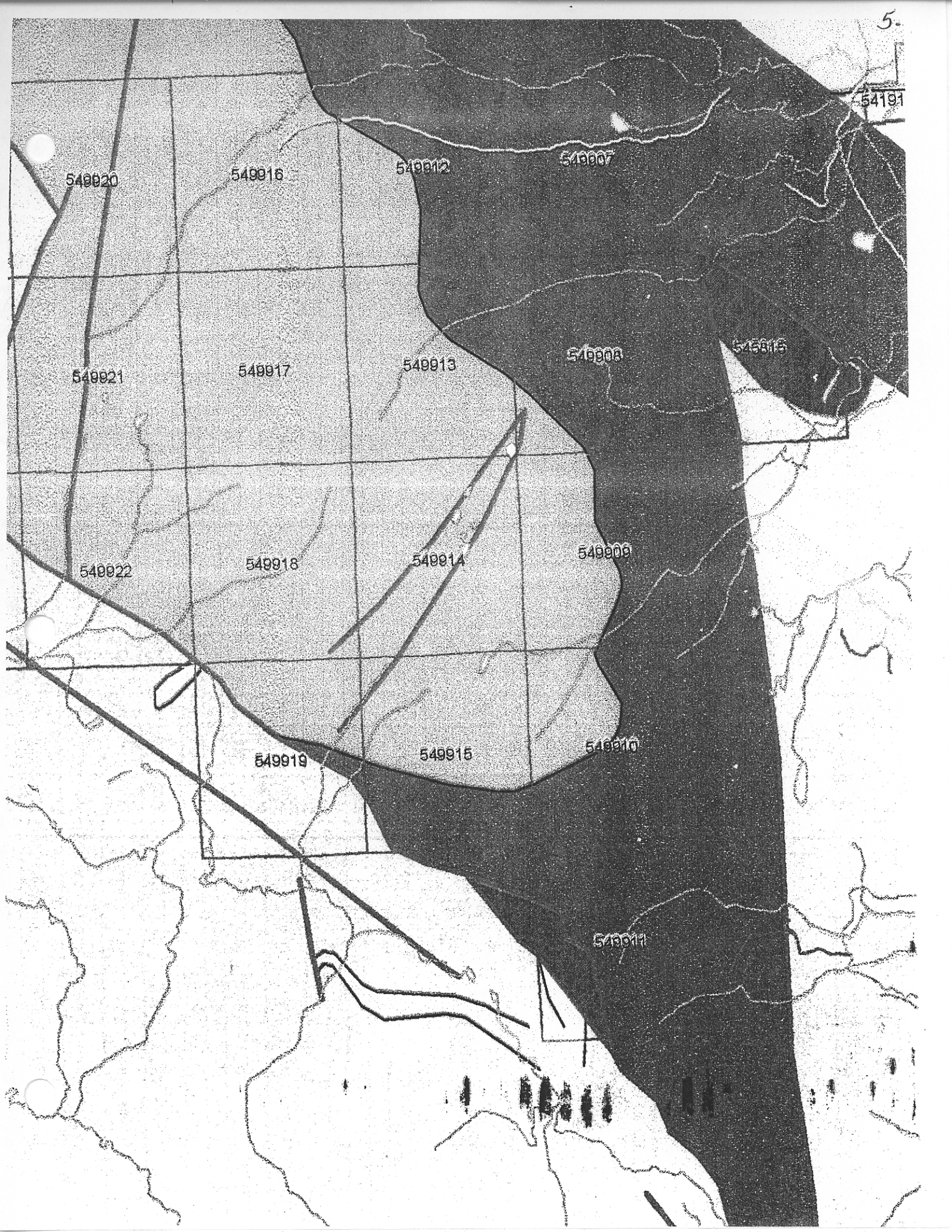

GOLDEN NATION

549908

X

X

X

X

545815

930 032

568440

549909

568444

Z

568528

549910



X ULTRAMAPHIC OUT CROP

SUMERY AND CONCLUSION

The Golden Nation first attracted attention when an outcrop containing Maraposite was discovered. Maraposite is an important indicator mineral when exploring for load gold deposits, such as the rich load gold vein deposits in California. This summer we worked on a program to understand the geology of the Golden Nation. First exploring all access, second, to locate the previously discovered outcrop and look for new situations. To the south east of the Golden Nation, on the Nation River we studied quartz and carbonate veins exposed along the river, and at the end of our exploration time , I found an exposure approximately forty meters by twenty meters containing Maraposite. This was trending in a south easterly direction. I acquired ground with good potential, to the east and to the south of the Golden Nation. This area is contained in the Wyatt 1 – 4 mineral claims.

RECAMENDED EXPLORATION

After seeking advice from people knowledgeable in this geology, I am recommending that a magnetometer survey be coupled with soil and rock analysis on the same grid. This would cover the south east part of the Golden Nation mineral claim and the North West to central part of the Wyatt mineral claims.

GOLDEN NATION CLAIM -- EXPENDITURES 2007

SALARIES

Dave Forshaw 7 man days @ 275/day	1025.00
Assistant - 2 man days @ 200/day	400.00

REPORT PREPARATION

Dave and Valerie Forshaw	180.00
--------------------------	--------

LOGISTICAL COSTS

Food and Lodging	300.00
Vehicle, Fuel and Maintenance	500.00

ANALYSIS - SOIL TESTING

Tax

EQUIPMENT COSTS

Chain Saw , Supplies and equipment	250.00
------------------------------------	--------

FILING FEES

180.00

SUBTOTAL

3735.00

ADMINISTRATION FEE (15%)

530.25

TOTAL

4265.25

STATEMENT OF QUALIFICATIONS

RICHARD DAVID FORSHAW
BOX 419
MACKENZIE, B.C., V0J 2C0

Email **forsh@telus.net**

PHONE # (250) 997-6047

1. Thirty-four years of active prospecting experience.
2. I have completed courses in the following: Basic Prospecting, Advanced Prospecting, Drift Prospecting, Radiometric Geology, Geochemical, Placer, Industrial Minerals and, Carlin Geology, (Microscopic Gold in Sediments), Type Au Deposits. I have attended the Cordilleran Roundup Mining Convention in Vancouver, the KEG conference in Kamloops and the Minerals North Conference each year. I have had ' ' booths to promote my properties. I have also attended a great number of talks given by specialists in the mining field.
3. I have organized and assisted in twelve Basic Prospecting Courses, one advanced Prospecting Course, one Placer Course, instructed one Basic Prospecting Course. led field trips, and assisted instructors in a number of Prospecting courses.
4. I am the mining representative for the District of Mackenzie Economic Development Advisory Committee.
5. I represented the B. C. & Yukon Chamber of Mines in the Mackenzie L.R.M.P. process.
6. I assist teachers in Mackenzie and Prince George Elementary and High Schools with their Geology related subjects, in the classroom and on field trips. I now do this through the CAST Program (Scientists & Innovators in the Schools).
7. I am a member of the Omineca Exploration Group and actively work to bring the prospectors in our area educational courses, field trips, and interesting speakers from all aspects of the mining field.
8. I have also taken courses in Holistic Forestry and other forest related courses to further my understanding of our environment and for reclamation purposes.

9. While working alone or with other prospectors and geologists in exploration, I have staked over one hundred mineral, placer, and industrial mineral claims, then completed different types of surveys on them. I then wrote reports regarding these surveys.
10. I have negotiated option agreements, as well as joint ventures on numerous mineral claims with companies.
11. I am the president of two mineral exploration companies, Gevast Holdings Ltd. and .. Moose Creek Minerals Ltd. I am also in the process of becoming a director of, .. Isabella Minerals Corp. (905) 664-3577.
12. In 2007, I was nominated chairman of the Omineca Beetle Action Coalition, Mining Initiative, in Central B.C.

I believe that this experience and training qualifies me as a prospector, and gives me good understanding of the mineral industry.

R.D. Forshaw - Prospector

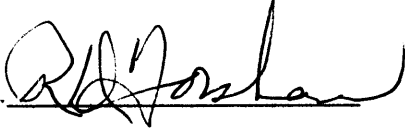
A handwritten signature in black ink, appearing to read 'R.D. Forshaw', written over a horizontal line.

BIBLIOGRAPHY

Cannon, R. 1988, Geophysical Survey Report on the Nat Claims, Omineca Mining Division: Company Report.

Gareau, M.B., 1988, Geology and Geochemistry Report on the Nat Property, Omineca Mining Division: Company Report.

Letient, H., 1989, Geophysical Report on the Nat Claims, Omineca Mining Division, Company Report.

Monger, J.W.H., Price, R.A., and Tempelman – Kluit, D.J., 1982, Tectonic accretion and the origin of the two major metamorphic and plutonic belts in the Canadian Cordillera; *Geology* v. 10, P. 70 – 75.

Muller, J.E., 1961, Geology, Pine Pass, British Columbia; Geological Survey Canada, Map 11 – 1961.

Wheeler, J.O., Brookfield, A.J., Gabrielse, H., Monger, J.W., Tipper, H.W., and Woodsworth, G.J., 1988, Terrane Map of the Canadian Cordillera: Geological Survey Canada, Open File 1984.