

**RECEIVED**  
AUG - 7 2008  
Gold Commissioner's Office  
VANCOUVER, B.C.

BC Geological Survey  
Assessment Report  
30141

**PROSPECTING AND  
PHYSICAL WORK REPORT**

on the

**Jl and Jl-I CLAIMS**

NTS Map Sheet 092G071

by

**D.K. BRAGG**  
OWNER-OPERATOR-AUTHOR  
Vancouver, B.C.

July 1, 2008

**GEOLOGICAL SURVEY BRANCH**  
ASSESSMENT REPORT  
**30141**

## TABLE OF CONTENTS

	<u>Page No.</u>
SUMMARY AND INTRODUCTION .....	1
LOCATION AND ACCESSIBILITY .....	1
GEOLOGY .....	4
FIELD WORK AND REPORT PREPARATION .....	5
RESULTS .....	6
RECOMMENDATIONS .....	7
CONCLUSION .....	7
STATEMENT OF COSTS .....	8
STATEMENT OF QUALIFICATIONS .....	9
BIBLIOGRAPHY .....	11
Figure 1    INDEX MAP .....	2
Figure 2    CLAIM MAP .....	3
Figure 3    TOPOGRAPHY AND GEOLOGY MAP .....	POCKET

## **SUMMARY AND INTRODUCTION**

The JI and JI-I Claims were located covering gold showings that had been worked on and high graded in the past (see Edward W. Grove, Ph.D., P.Eng., June 28, 1982).

The purpose of the current investigation was to assess the accessibility of the claim area by road, to locate any of the showings, to prospect and map the geology, and to get a general feel for the area.

The first reported work done in the area was in 1913 and again in 1961. The greatest amount of work was done during the late 1970's and early 1980's.

## **LOCATION AND ACCESSIBILITY**

JI and JI-I Claims overlie the northern portion of the Sechelt Peninsula. For the most part, they are north of Egmont Road from Highway 101 and south of Earl's Cove to Egmont, a paved road. The claims lie 85 km northwest of Vancouver (see Figure 1).

The claims can be reached via ferry from Horseshoe Bay to Langdale and via Highway 101 to the Egmont turnoff south of Earl's Cove, then easterly on the Egmont Road.



# Internet Mapping Framework

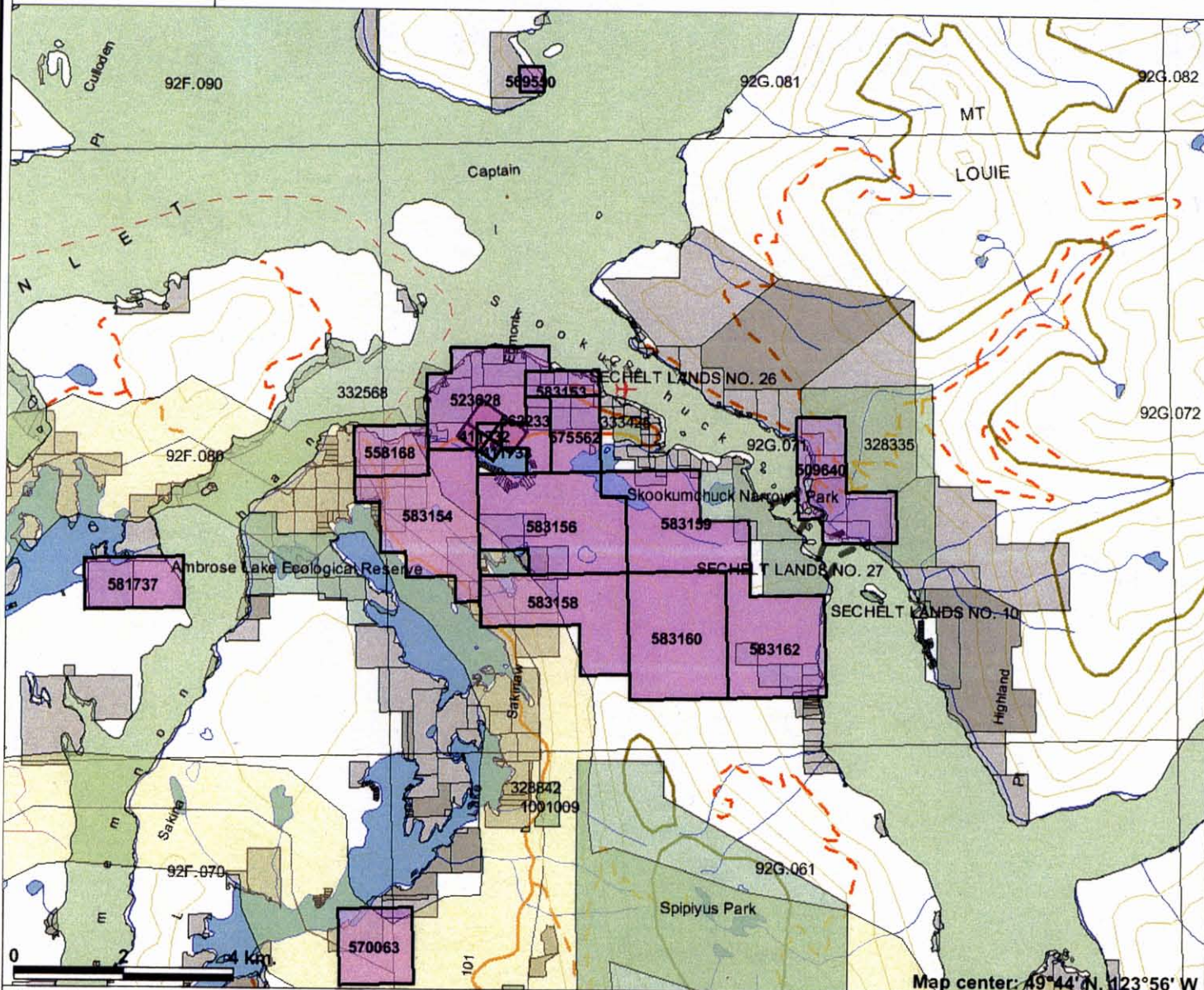

## Legend

- Indian Reserves
- National Parks
- Parks
- Mineral Tenure (current)**
- Mineral Claim
- Mineral Lease
- Mineral Reserves (current)**
- Placer Claim Designation
- Placer Lease Designation
- No Staking Reserve
- Conditional Reserve
- Release Required Reserve
- Surface Restriction
- Recreation Area
- Others
- Survey Parcels
- BCGS Grid
- Contours (1:250K)**
- Contour - Index
- Contour - Intermediate
- Area of Exclusion
- Area of Indefinite Contours
- Annotation (1:250K)**
- Transportation - Points (1:250K)**
- Airfield
- Anchorage - Seaplane
- Ferry Route
- Heliport
- Seaplane Base
- Air Field
- Airport
- Air Feature - Condition Unknown
- Airport.Abandoned



Scale: 1:110,159

Map center: 49°44' N, 123°56' W

This map is a user generated static output from an Internet mapping site and is for general reference only. Data layers that appear on this map may or may not be accurate, current, or otherwise reliable. THIS MAP IS NOT TO BE USED FOR NAVIGATION.

## GEOLOGY

Geology of the area has been well documented by others who have worked in the area in the past (see Bibliography). For the purpose of this investigation, little time was spent on the geology of the area other than to map the outcrops along the roads that were mapped and try to identify the northwesterly trending faults in the area.

It is the contention of the writer that these faults may play a very important role in the location and deposition of gold that has been reported in the past.

The strongest fault was observed by the writer just to the east of Lyon Lake to the south where mineralized fault breccia was observed in intrusive rocks. This fault is believed to continue northwesterly on the east side of Mt. Hallowell, through North Lake and just to the east of Agamemnon Bay. This fault, if not through the locus of the two areas where significant gold has been identified in the past, is very close. The direction of this fault is roughly 310°

Another fault lies 900 metres to the east of the first fault described and where, at 0430340E 5511735N, the fault scarp can be seen. The direction of this fault is approximately 335°.

A third fault lies another 450 to 500 metres of latter described fault. On the JI claim, this fault is roughly parallel to the second fault but to the south it appears to splay easterly through Waugh Lake.

All the outcrops that were mapped were granitic to dioritic. No time was spent in identifying the different types.

## **FIELD WORK AND REPORT PREPARATION**

A 1:5000 base map was prepared for this report and in preparation for future work. On this map, the claims of the area were plotted. Contours and topographic features are from a blow-up of B.C. Topographic Map 092G071 Egmont.

Roads were mapped in the field using a Garmin G.P.S. Map 60CS. These roads and other field data were plotted on the 1:5000 scale map.

More than three kilometres of road were mapped. Of these, one kilometre had to be brushed out in order to advance the vehicle up the road. Outcrops were mapped and only a cursory examination was made of them. No detailed mapping of the geology was done at this time. Other topographical features were noted.

Two stream sediment samples were collected during this trip but were not submitted for testing at this time since there were only two. They will be submitted for analyses at a later date.

## **RESULTS**

The Egmont Forest Service Road was in good condition except for the last kilometre down to the beach because of the steepness, recent selective logging and wetness of the road bed. Later in the season, this section of the road should not be a problem. Many of the other roads in the area have not been used for at least 15 to 20 years by 4x4 vehicles. As a result, they are overgrown and blocked by fallen trees and, for the most part, remain only as trails. The writer was able to brush out and remove fallen trees on one kilometre of these roads. Some of the roads were walked to see what condition they were in. Most were in fair shape but need a chain saw to clear out the larger trees.

There appears to be no road access in the northwestern portion of the JI Claim and the showings on the beach will have to be accessed by water.

Much of the area had been logged more than 100 years ago. As such, the forest is maturing and considerable debris and undergrowth hinder traversing and line cutting. There are small patches of forest that were logged some 40 years ago. Selective logging is being done in the northern area along the Egmont Forest Service Road. A small block is to be clear-cut in October 2008.

No evidence of the grids that were established in the late 1970's or early 1980's were found. However, some scattered drill core was found at 0430294E 5511610N, elevation 86 m.

## **RECOMMENDATIONS**

Trails should be cut along the traces of the faults where they are not now accessible by roads. The area of the faults should be prospected and mapped in detail with emphasis on geology, alteration, silicification and mineralization. Stream sediment samples should be collected along the streams within the fault zones at least every 250 metres. This should be followed up with soil sample grids in areas of interest.

All areas of interest indicated by surveys that were done in the past should be revisited, prospected, mapped and sampled.

## **CONCLUSION**

Work done in the past has identified two zones of some size with significant gold values with a number of smaller zones and single assay results that warrant follow up with the price of gold where it is today.

**STATEMENT OF COSTS**

D.K. Bragg:	4 days @ \$350/day	\$ 1,400.00
Truck Rental plus gas:	4 days @ \$70/day	280.00
Food:	4 days @ \$35/day	140.00
Equipment Rental:	4 days @ \$10/day	40.00
Camp Costs:	4 days @ \$10/day	40.00
Report:	Preparation, typing and copies	450.00
Ferry:	Horseshoe Bay to Langdale	<u>48.25</u>
	<b>TOTAL COST</b>	<b><u>\$ 2,398.25</u></b>

## STATEMENT OF D.K. BRAGG

I, Donald K. Bragg, Prospector, state as follows:

- Graduated Armstrong High School, Armstrong, B.C.
- Attended U.B.C. from 1958 to 1962, Faculty of Arts and Science, in Honours Geology.
- Worked in mineral exploration since 1956.
- Worked for Kenco Explorations during the summers of 1956, 1957 and 1959 in the Yukon and Northern B.C. as an assistant prospector, head prospector and geochemical sampler under the direction of Dr. R. Cambell and R. Woodcock.
- Worked as head prospector for the Nahanni Syndicate in the Northwest Territories in 1960 under the direction of Doug Wilmont.
- Worked as head prospector in the Yukon for Dualco in 1961 under the direction of E. Wozniak.
- Worked as head prospector for Mining Corp. of Canada, Southwestern B.C. in 1962 under J.S. Scott and Dr. K. Northcote.
- Worked as head prospector during the summer of 1963 for the Francis River Syndicate in central Yukon under the direction of D.r A. Aho.
- Worked as field geologist in the Greenwood area of B.C. for Scurry Rainbow Oil in 1965 under the direction of Bill Quinn.
- Worked as field supervisor for Alrae Explorations Ltd. from September 1965 to April 1967 under the direction of Rae Jury.
- Since 1956, self-employed contractor hired by various mining companies in the following fields: prospecting, property examination, claim staking, line cutting, topographical mapping, geological mapping, reconnaissance mineral sampling, draughting, air photo interpretation, geochemistry, geophysics, supervising property exploration programs, setting up bush camps, and camp manager.
- Since 1956, self-employed prospector working in various areas in British Columbia and on self-owned properties.

- Assisted in teaching field procedures for Geochemical Explorations Section of the Ministry of Energy, Mines and Petroleum Resources Mineral Exploration Course For Prospectors under the direction of Dr. S. Hoffman in 1984, 1985, 1986, 1987, 1988.
- Received the B.C. Provincial Grubstake Award for the years 1964, 1968, 1969, 1970, 1980, 1981, 1982, 1983, 1984, 1986, 1987, and 1988.
- Worked in the Rossland Camp from 1971 to 1991 as prospector/miner on the Snowdrop and Blue Bird Claims, and mining exploration contractor.
- Worked in the Osilinka and Cut Mountain area with Lysander Mining Corporation during the 2004, 2005, 2006, 2007 field seasons under the direction of Peter E. Fox, Ph.D., P.Eng., in setting up and managing the camp, prospecting, and mapping the area.

Respectfully submitted,

A handwritten signature in black ink that reads "D. K. Bragg". The signature is written in a cursive style with a prominent loop at the end of the last name.

**D. K. Bragg**

July 1, 2008  
Vancouver, B.C.

## BIBLIOGRAPHY

- EMPR AR 1913 - 288; 1961 - 80, 90
- EMPR GEM 1970 - 230
- EMPR ASS RPT 2722, 11129, 11333, 11334, 12451, 12641, 14264,  
14736, 15577, 17941, 18418
- EMPR BULL 39 p.39
- EMPR PF Tomlinson, F.C. (1969) Report on the R.C. Group of  
Mineral Claims
- Howell, W.A. (1988) Report on the Egmont Property,  
in Prospectus (Blu Chip resources Inc.)
- GSC P 80-1F pp 95-101
- GSC Map 42-1963; 1069A; 1386A
- GSC OF 611
- GCNL #197, 1984  
#16, #18, #23, #227, 1985
- IPDM February-March 1985  
May-June 1985
- Ditson, G.M. (1978) Metallogeny of the Vancouver-Hope Area, British  
Columbia, M.Sc. Thesis, University of British Columbia
- EMPR PF Fleming, D.B. (1983) Geological Assessment and Work  
Proposal - Bacon Claims

5513000

5512000

5511000

- LEGEND**
- Paved Road
  - Gravel or logging road
  - Trail or unused road
  - Stream
  - Intermittant stream or gully
  - Rock outcrop
  - Silt sample site ● JI 08 001
  - Soil sample site ○ JI 08 010
  - Rock sample site ⊙ JI 08 021
  - Fault (defined, approximate, assumed)

**TOPOGRAPHY & GEOLOGY**

**J1 & J1 1 CLAIMS**  
**NORTHERN SECHelt PENINSULA**

**092 G 071**



To accompany 'PROSPECTING & PHYSICAL WORK  
on the J1 & J1 1 Claims' by D.K. Briggs, Dated  
July 2, 2008

SCALE: 1 - 5000    DATE: July 2, 2008  
DRAWN BY: D.K. Briggs    Fig: 3

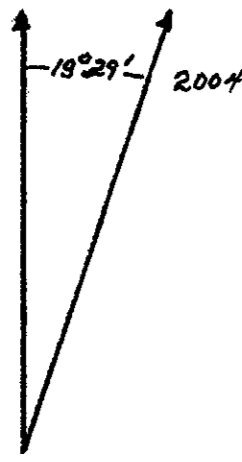

**GEOLOGICAL SURVEY BRANCH**  
**AGASSIZ REPORT**  
**50,141**

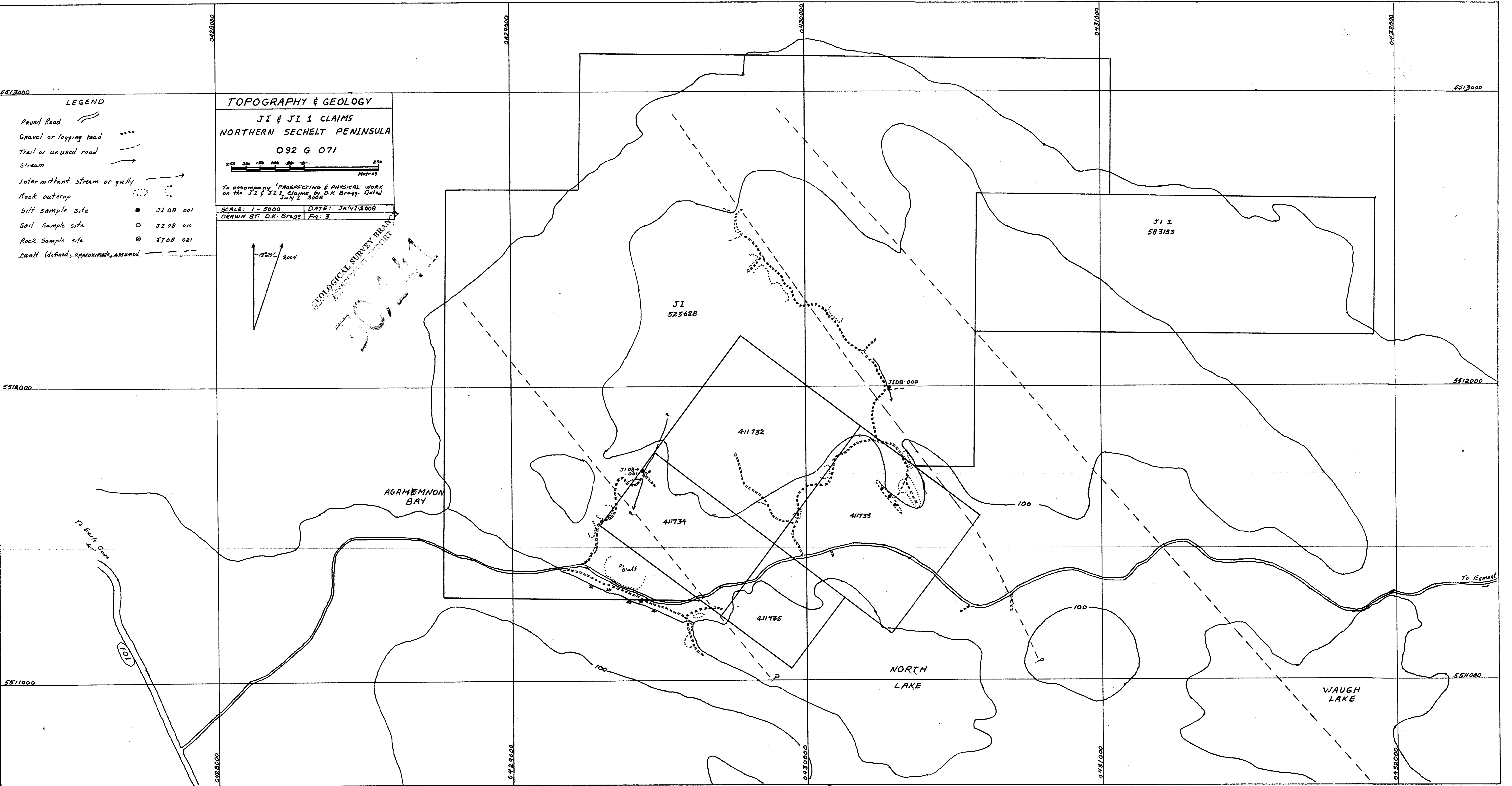

5513000

5512000

5511000

0422000

0422000

0422000

0422000

0422000

0422000

0422000

0422000

0422000

0422000