



Ministry of Energy & Mines
Energy & Minerals Division
Geological Survey Branch

ASSESSMENT REPORT
TITLE PAGE AND SUMMARY

TITLE OF REPORT [type of survey(s)] <u>Prospecting Report on the Otteson property</u>	TOTAL COST 400 <u>615056</u>
AUTHOR(S) <u>Chris Knudsen Ronald Otteson</u> SIGNATURE(S) <u>[Signatures]</u>	

NOTICE OF WORK PERMIT NUMBER(S)/DATE(S) N/A YEAR OF WORK 2008
 STATEMENT OF WORK - CASH PAYMENT EVENT NUMBER(S)/DATE(S) 4240409 Oct 6, 2008

PROPERTY NAME Otteson property
 CLAIM NAME(S) (on which work was done) 515101

COMMODITIES SOUGHT Au, Ag, Cu, Pb, Zn
 MINERAL INVENTORY MINFILE NUMBER(S), IF KNOWN N/A
 MINING DIVISION Vernon NTS 82L/2E
 LATITUDE 50° 12' 5" LONGITUDE 118° 38' 36" (at centre of work)

OWNER(S)
 1) Ronald Norman Otteson 2) _____

MAILING ADDRESS
68 Aumond Rd.
Lumby, B.C. VOE 2G3

OPERATOR(S) [who paid for the work]
 1) Ronald Otteson 2) _____

MAILING ADDRESS
(as above)

PROPERTY GEOLOGY KEYWORDS (lithology, age, stratigraphy, structure, alteration, mineralization, size and attitude):
Devonian to Triassic, mudstone, siltstone, shale, fine elastics,
Ag-Rich, CO₂ veinlets, quartz veinlets, metamorphose 4d.

REFERENCES TO PREVIOUS ASSESSMENT WORK AND ASSESSMENT REPORT NUMBERS
~~Previous Assessment Report 28413 Statement of Work 4036476 N/A~~

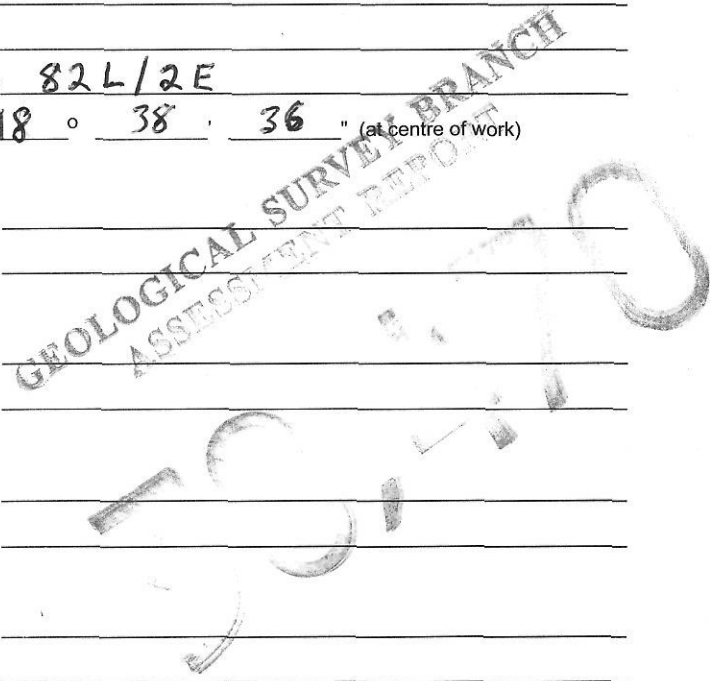

TYPE OF WORK IN THIS REPORT	EXTENT OF WORK (IN METRIC UNITS)	ON WHICH CLAIMS	PROJECT COSTS APPORTIONED (incl. support)
-----------------------------	----------------------------------	-----------------	---

GEOLOGICAL (scale, area)

Ground, mapping _____

Photo interpretation _____

GEOPHYSICAL (line-kilometres)

Ground

Magnetic _____

Electromagnetic _____

Induced Polarization _____

Radiometric _____

Seismic _____

Other _____

Airborne _____

GEOCHEMICAL

(number of samples analysed for ...)

Soil _____

Silt _____

Rock _____

Other _____

DRILLING

(total metres; number of holes, size)

Core _____

Non-core _____

RELATED TECHNICAL

Sampling/assaying _____

Petrographic _____

Mineralographic _____

Metallurgic _____

PROSPECTING (scale, area) 140 Ha at 1:10,000 Scale 515101 \$1,150

PREPARATORY/PHYSICAL

Line/grid (kilometres) _____

Topographic/Photogrammetric (scale, area) _____

Legal surveys (scale, area) _____

Road, local access (kilometres)/trail _____

Trench (metres) _____

Underground dev. (metres) _____

Other _____

TOTAL COST \$1,150

BC Geological Survey
Assessment Report
30470

RECEIVED

JAN 16 2009

Gold Commissioner's Office
VANCOUVER, B.C.

Prospecting Report

Otteson property tenure 515101

Creighton Valley Road
Vernon Mining Division

NTS 082L/2E

50°-12'-5" N x 118°-38'-36" W

By: Ronald Otteson (owner and operator)

68 Aumond Rd.

Lumby, B.C.

V0E 2G3

December 15, 2008

30470

Table of Contents

1) Introduction	1
2) Observations.....	1
3) Summary	2
4) Cost Statement.....	2
5) Statement of Qualifications	3
6) Map of claims and sample locations.....	4 - 5

1) Introduction

The claim is located approximately 65 Kilometers east of Vernon, B.C. off Creighton Valley road, in the Vernon Mining district, NTS 082L/2E, at 50°-12'-05"N latitude by 118°-38'-36"W Longitude. Access to the property is gained by Highway #6 from Vernon and logging roads. The area embraces part of the Columbia Mountains and is partly rugged with high relief and the valleys have low relief. The principal drainage is Ferry Creek which drains into the Shuswap River. The area is mainly covered by a mixed evergreen forest, which has been recently logged. This claim has been worked in conjunction with work carried out by Chris Knudsen on his claims (546709, 546928, 567577) which surround claim 515101. Previous logging activity in the area exposed mineralized veins and so there was stripping, prospecting and a sampling program carried out in the area. This year there was only prospecting done on claim 515101 by Ronald and Chris. The location map and claim map follow on separate pages.

2) Observations

Sometime during the spring a windstorm must have went through the area because many trees were blown down so Ronald Otteson and Chris Knudsen prospected the area and looked around where the roots had exposed the underlying rock. Most was found to be shale underneath with some quartz near Chris' claims. A couple samples were sent in for assaying and nothing of value was found. Chris and Ronald came back on a couple separate occasions to do more prospecting and try and figure out a work program for the area. Approximately 40 hectares was prospected in this area.

3) summary

Ronald Otteson and Chris Knudsen worked together in 2008 on claims as Chris had hired a geologist to look at the area and have come to the conclusion that soil sampling and or shallow trenching to expose the bedrock would be the next step that should be taken. Also a lot more prospecting in the area is warranted as there area very steep hills and a lot more ground needs to be prospected and more samples taken.

4) Cost Statement

Wages: Ronald Otteson	16 Hrs. at \$30/Hr.	\$480
Chris Knudsen	16 Hrs. at \$20/Hr.	\$320
Transportation: 1 Truck at 3 days		\$150
Km charge – Prospector from Kamloops .50/Km x 400		\$200

Total Cost:		\$1150

5) Statement of Qualifications

Ronald Otteson has been a prospector in the area for 29 years.

Chris Knudsen has graduated from the Saskatchewan Prospecting School in 1998, and have worked as a prospector, done mineral exploration, geophysics, and diamond drilling for the past 20 years.

Ronald Otteson

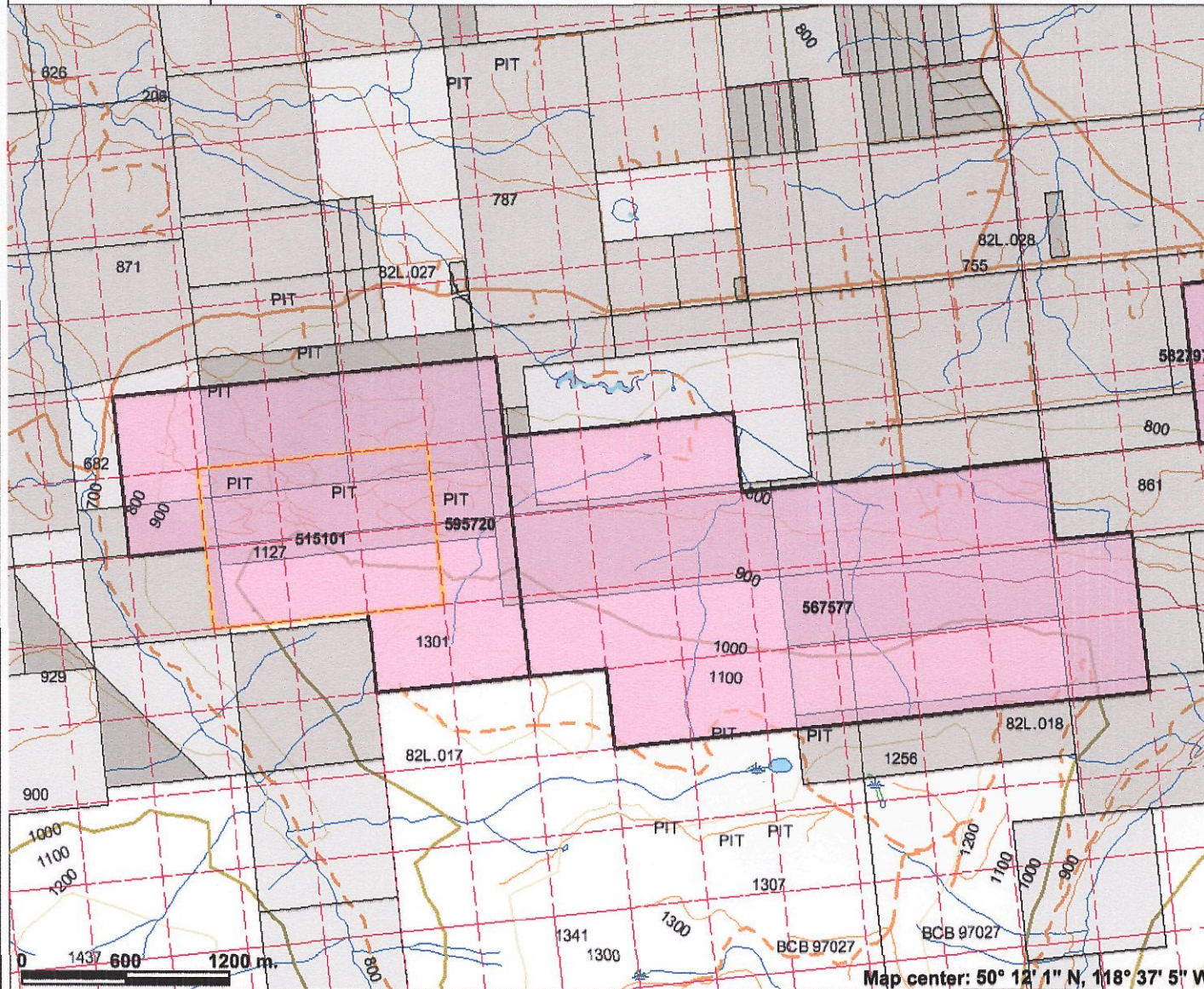

Legend

- Indian Reserves
- National Parks
- Parks
- MTO Grid (MTO)
- Blocked by MEM
- Other Mineral Tenure (current)
- Mineral Claim
- Mineral Lease
- Mineral Reserves (current)
- Placer Claim Designation
- Placer Lease Designation
- No Staking Reserve
- Conditional Reserve
- Release Required Reserve
- Surface Restriction
- Recreation Area
- Others
- Survey Parcels
- BCGS Grid
- Contours (1:250K)
- Contour - Index
- Contour - Intermediate
- Area of Exclusion
- Area of Indefinite Contours
- Annotation (1:20K)
- Transportation - Points (TRIM)
- Transportation - Lines (TRIM)
- Helipad
- Airfield
- Airport
- Airstrip

Scale: 1:35,026

This map is a user generated static output from an Internet mapping site and is for general reference only. Data layers that appear on this map may or may not be accurate, current, or otherwise reliable. THIS MAP IS NOT TO BE USED FOR NAVIGATION.

Notes: Cherryville Property

Map center: 50° 12' 1" N, 118° 37' 5" W

Otteson cherryville X= Areas Prospected

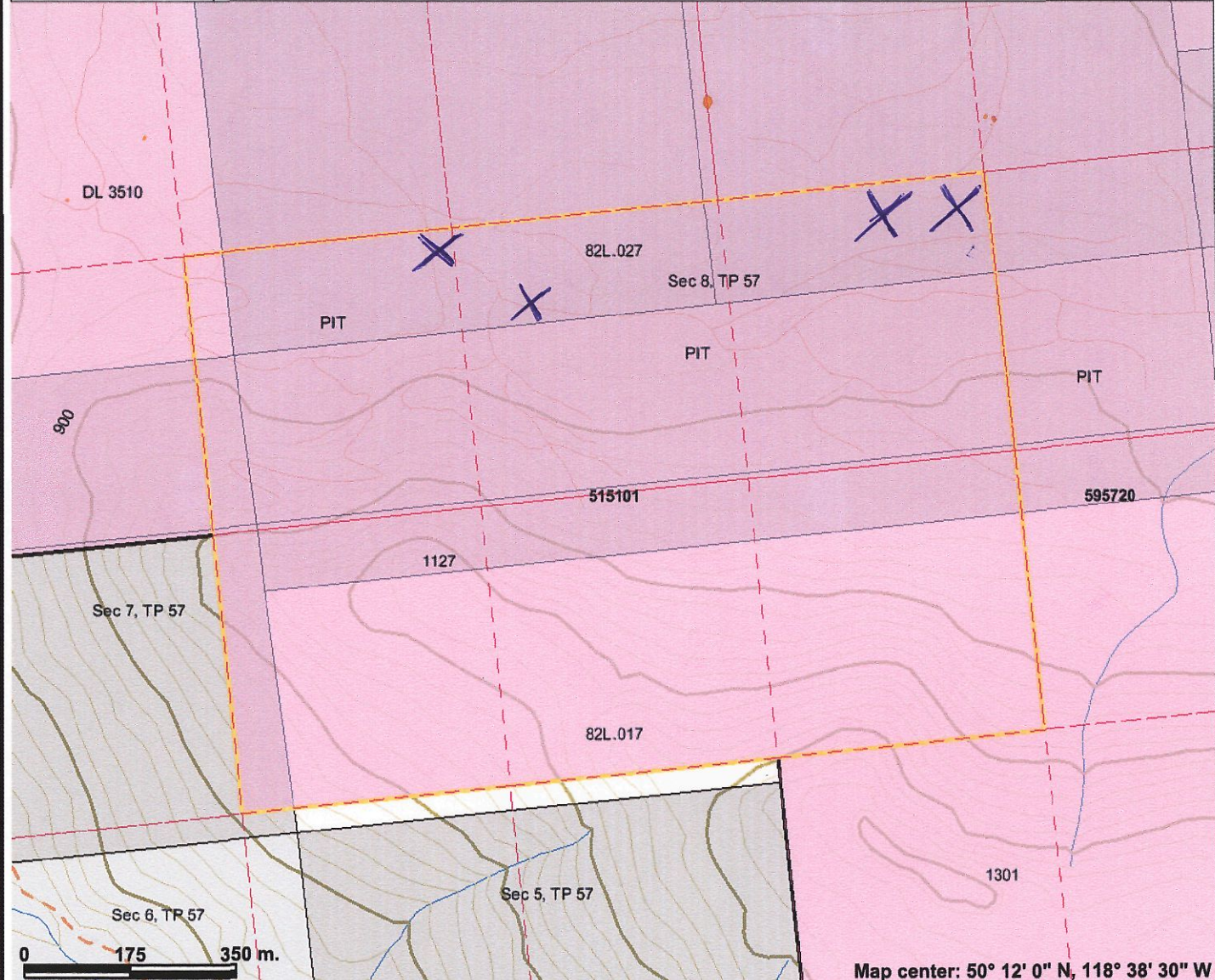
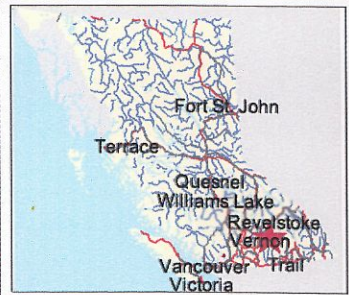

Legend

- Indian Reserves
- National Parks
- Parks
- MTO Grid (MTO)
- Blocked by MEM
- Other
- Mineral Tenure (current)
 - Mineral Claim
 - Mineral Lease
 - Mineral Reserves (current)
- Placer Claim Designation
- Placer Lease Designation
- No Staking Reserve
- Conditional Reserve
- Release Required Reserve
- Surface Restriction
- Recreation Area
- Others
- Integrated Cadastral Fabric
- Survey Parcels
- BCGS Grid
- Contours (TRIM)
 - Contour - Index
 - Contour - Index.Indefinite
 - Contour - Index.Depression
 - Contour - Index.Depression Indefinite
 - Contour - Intermediate
 - Contour - Intermediate.Indefinite
 - Contour - Intermediate.Depression
 - Contour - Intermediate.Depression Indefinite
- Area of Exclusion
- Area of Indefinite Contours
- Annotation (1:20K)

Map center: 50° 12' 0" N, 118° 38' 30" W

Scale: 1:10,000

This map is a user generated static output from an Internet mapping site and is for general reference only. Data layers that appear on this map may or may not be accurate, current, or otherwise reliable. THIS MAP IS NOT TO BE USED FOR NAVIGATION.