

**Assessment Report on  
Geochemical Work  
On The Following Claims**

Rocky #8.....579201  
Rocky #9.....579205  
Rocky #10.....579209  
Large CU Magnetic Low.....579210

**Located 8 km Northeast of  
Lytton, British Columbia**

**Kamloops Mining Division**

**50 degrees 16 minutes latitude  
121 degrees 28 minutes longitude**

**N.T.S. 92 I/6**

**Event #4287466**

**Project Period: May 20 to 22, 2009**

**On Behalf of  
Canada Minerals of  
Vancouver, BC**

**Report By  
A. Walus, M.Sc., P.Geo.**

**Date: July 10, 2009**

GEOLOGICAL SURVEY BRANCH  
ASSESSMENT REPORT

30,979

**RECEIVED**  
JUL 15 2009  
Gold Commissioner's Office  
VANCOUVER, B.C.

## LIST OF ATTACHED MAPS

	<u>After Page</u>
Location Map	1
Claim Map	1
Sample Location and Gold Geochemistry Map	3

## LIST OF APPENDICES

APPENDIX I	Rock Samples Descriptions
APPENDIX II	Geochemical Results
APPENDIX III	Mineral Claim Exploration Statement

## **INTRODUCTION**

During the 2009 geochemical program of rock sampling on Rocky claims a total of 23 float and 8 samples from outcrop were collected. In addition, one silt sample from a major creek was also collected. The program was conducted by the author of this report on behalf of Canada Minerals Inc. in May 2009. Sample locations are shown on the attached map. Descriptions of samples are given in Appendix I. Transportation to the claims area was done by walking 5 kilometres along the Canadian Pacific railway tracks from the bridge across the Thomson River just outside Lytton. Personnel stayed in a hotel in Lytton and acquired meals at hotel's restaurant. A complete list of sources used in this report is provided in references.

All samples were prepared and analyzed by Assayers Canada in Vancouver, British Columbia.

## **Location and Access**

The property, centered at 50 degrees 16 minutes North Latitude and 121 degrees 28 minutes West Longitude is located in the Kamloops Mining Division. It lies approximately 8 kilometres north-east from Lytton, British Columbia, on the north side of Thomson River. Property location is shown on the attached map printed from the ARIS website.

At the present time access to the claims is either by helicopter or by walking 5 kilometres along the Canadian Pacific railway tracks from the bridge across the Thomson River just outside Lytton.

## **Physiography and Topography**

The claims are located in semi-arid region of British Columbia. Mean annual precipitation is 40-50 cm per annum, mostly as rainfall, with very little snow accumulation. Mean annual temperatures range from 0-5 degrees in January to 20-22 degrees in July.

The claims cover a steep and incised south-facing slope at the entrance to the White Canyon area of the North Thomson River. Property elevation ranges from a low of 550 to a high of 1,220 metres. The slopes are covered by sparse pine forest. Outcrops are restricted to ridge tops and bottoms of the main creeks with extensive scree cover on the slopes. Creek draining the area is best described as debris flow channel. Surface water is scarce.

## **Property Ownership**

The Rocky property consists of six claims totaling 991.34 hectares located 8 kilometres to the north-east of Lytton, BC. Relevant claim information is summarized below:

# ARIS Map

 **ROCKY Location**

**Topographic Layers**

 **Lakes 1:6M**

 **Rivers 1:6M**

**BC Border Layers**

 **BC Border 1:6M**

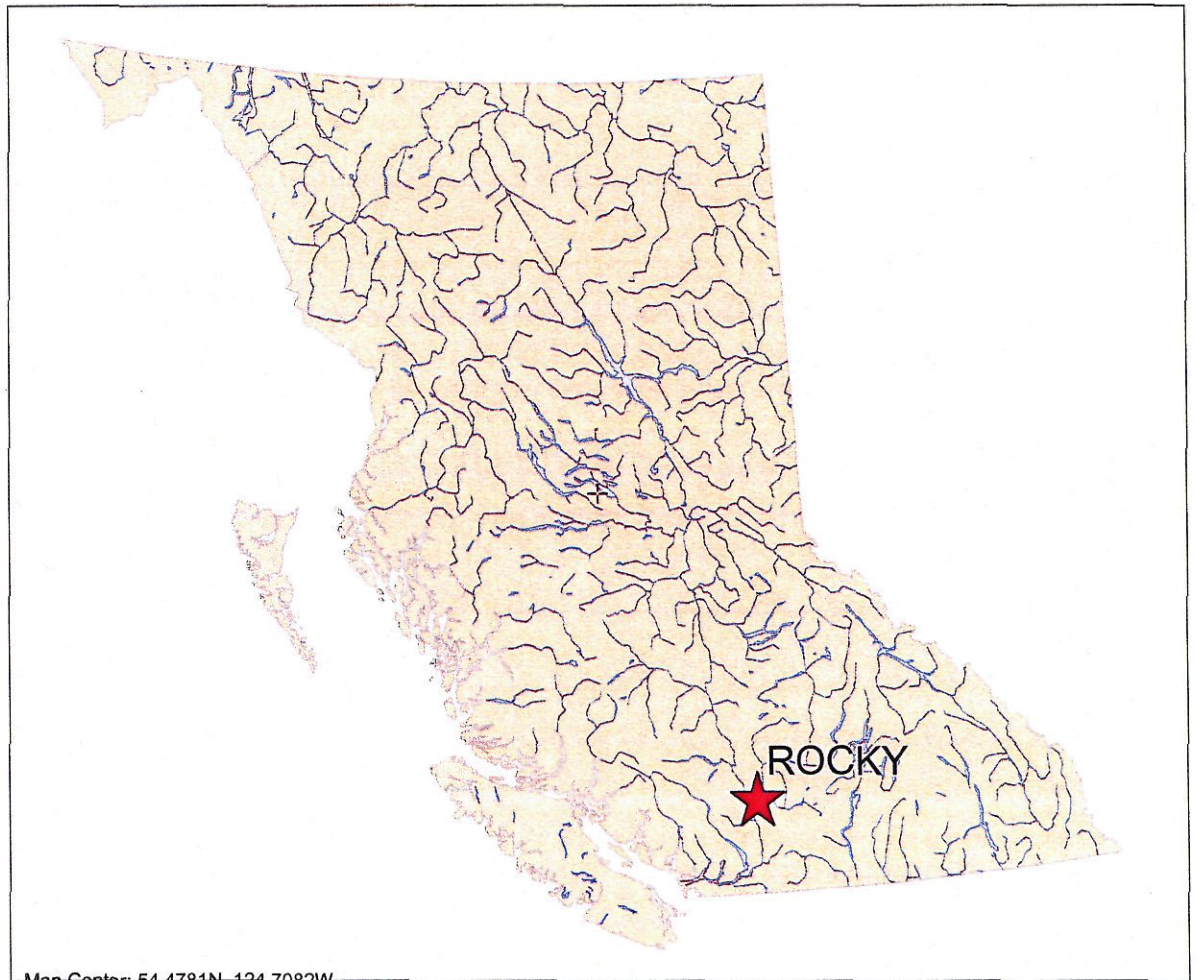

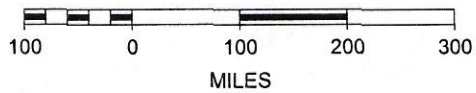

Map Center: 54.4781N, 124.7082W

SCALE 1 : 11,370,593









# ARIS Map

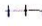

**Mineral Titles Layers**

-  **ROCKY Tenure**
-  **All Mineral Tenures**

**Topographic Layers**

-  **Railways 1:20K**
-  **Roads 1:20K**
  -  Gravel Road
  -  Paved Road
  -  Rough Road
-  **Lakes 1:20K**
-  **Rivers 1:20K**

**Grid Layers**

-  **Grid 1:20K - labels**
-  **Grid 1:20K - outline**

**BC Border Layers**

-  **BC Border 1:50K**

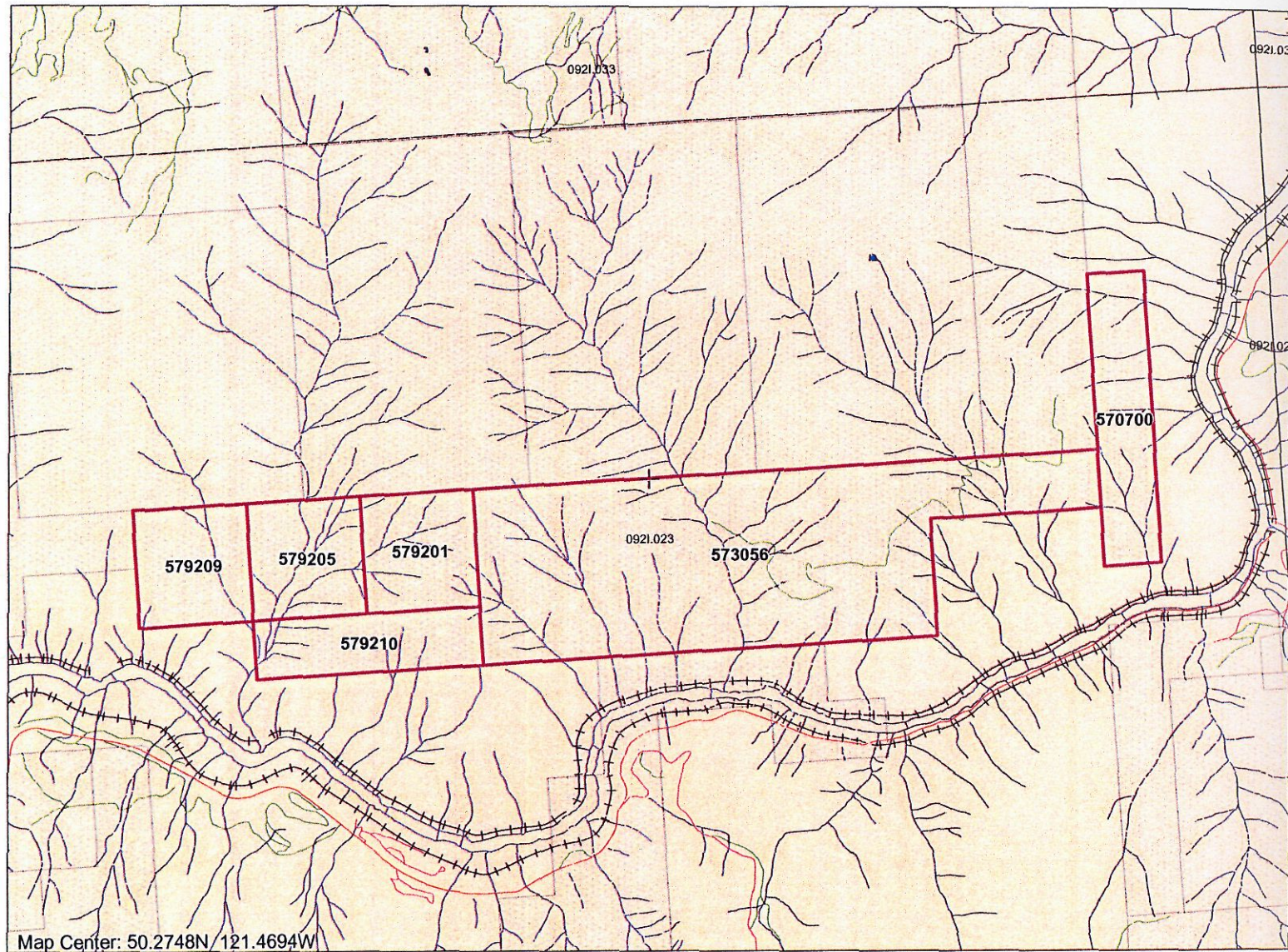

SCALE 1 : 49,429

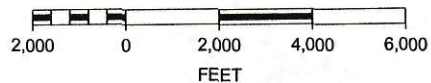

Tenure Number	Tenure Name	Map No.	Area (Ha)	Expiry Date
570700	ROCKY-K-PGMS-AU	092I	103.25	2011/may/24
573056	ROCKY CU AU PT ZN	092I	557.64	2011/may/24
579201	ROCKY#8	092I	82.61	2011/may/24
579205	ROCKY#9	092I	82.61	2009/jul/27
579209	ROCKY#10	092I	82.61	2009/jul/27
579210	LARGE CU MAGNETIC LOW	092I	82.62	2011/may/24
		<b>Total</b>	<b>991.34</b>	

Claims location is shown on the attached map printed from ARIS database.  
The claims are presently 100 % owned by Canadian Minerals Inc. of Vancouver, BC.

### **Work History**

To date, the bulk of exploration work on the property was conducted on or close to Rocky and Karen mineral showings located on the present Rocky Cu Au Pt Zn claim (573056). In 1963, twelve vertical holes (totaling less than 800 metres) along with some trenching were completed. Results of this program are not available. In 1970, Lytton Minerals carried out geological mapping and magnetometer survey. In 1971, Phelps Dodge Corporation of Canada examined the same area with a crew of five men. Geological mapping and bulldozer trenching was done over the claim block. No results were published. In conclusion of the report from this program it was stated that "sub marginal" copper values were obtained from the samples. In 1980 Tracer Resources conducted a program of soil sampling. The soil results did not reveal any anomalous zone. In 1988, Green Lake Resources conducted silt and rock sampling program.

### **GEOLOGY**

#### **Regional Geology**

Regionally, the rocks which underlie the Rocky claims belong to Permian to Triassic age rocks of Mount Lytton Formation which include dioritic intrusive rocks and lower Amphibolite/Kyanite grade metamorphic rocks.

#### **Property Geology**

According to Lytton Minerals geology map completed in 1970, the Rocky Cu, Au, Pt, Zn mineral claim (which contain the bulk of mineralization of the property) is underlined by granite, diorite,

syenite, pyritized country rocks, gabbro, rocks of felsic series, and so called lower basic series which may be part of large layered intrusion of unknown extent.

Portion of the property visited by the author in May 2009 i.e. Rocky # 8 to 10 claims and western part of Large Cu Magnetic Low claim are underlain by diorite and minor siltstone.

### **Alteration-Mineralization**

According to Minfile, the Rocky Cu, Au, Pt, Zn mineral claim feature disseminated chalcopyrite with associated minor magnetite and pyrrhotite which occur in layered intrusives comprising anorthosite, granodiorite and gabbro. Intense albitization occurs along fractures and faults. Chlorite is common. Quartz, calcite and minor chalcopyrite fill fractures. General attitude of the layering strike 325 degrees and dips 30 degrees east.

The western part of the property visited by author in May 2009 feature locally extensive zones of quartz-sericite-limonite altered rock with accompanying quartz veins. The zones are concentrated along the major creeks. In the eastern part of Rocky # 8 claim there are extensive zones of strong albite alteration. The quartz vein encountered during 2009 geochemical program contains small amounts of limonite and sporadically also hematite and manganese stain. One float sample contained minor coarse grained pyrite. One float sample was of quartz epidote vein.

Geochemical results obtained during 2009 field program are weak. Only 2 samples (both float) returned anomalous results. Sample AR-50 of quartz-epidote vein yielded 0.16 g/t Au, 1.3 g/t Ag, and 753 ppm Cu. Another float sample (AR-55) returned 0.11 g/t Au, 1063 ppm As, and 1033 ppm Cu. The remaining rock samples as well as silt sample from a major creek assayed less than 0.01 g/t gold.

## **GEOCHEMISTRY**

### **Introduction**

During the 2009 geochemical program of rock sampling on Rocky claims a total of 31 rock geochemical samples and 1 silt sample were collected. Of these 31 rock samples, 23 were float and 8 were samples from outcrop. Sample locations and gold geochemistry are shown on the attached map (next page). The location of the samples was determined using GPS. Descriptions of samples are provided in appendix I.

All samples were analyzed by Assayers Canada, in Vancouver, British Columbia. They were assayed for gold and 30 elements ICP. Complete geochemical results are presented in Appendix II.

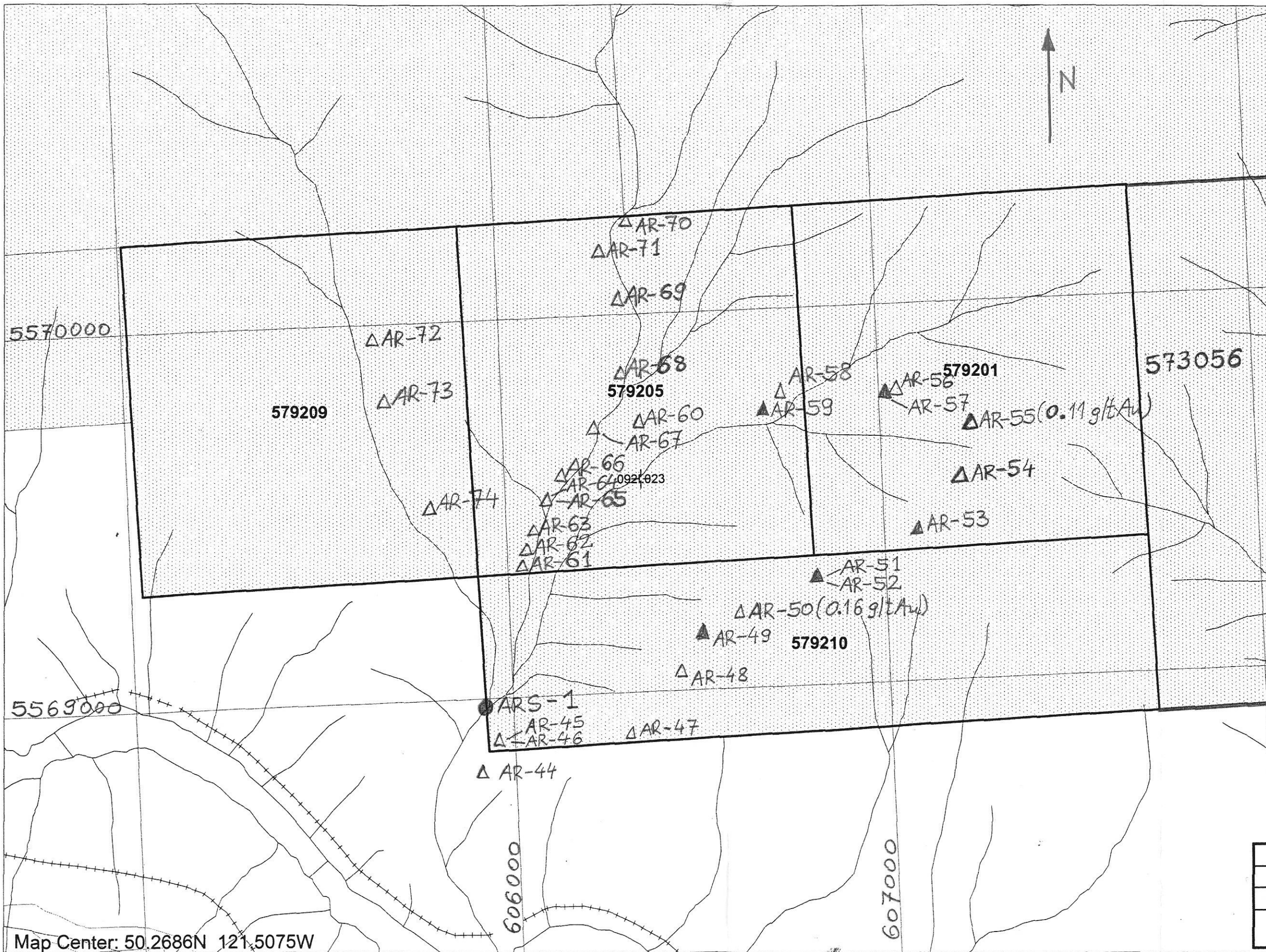

**LEGEND**

- △ Rock sample (float)
- ▲ Rock sample (in place)
- Silt sample
- AR-50 (0.16 g/t Au)

↓ Sample Number    ↓ Gold Assay

All samples assayed  
 ≤ 0.01 g/t Au except  
 samples AR-50 and AR-55

Coordinates are  
 UTM NAD 84



CANADA MINERALS INC.		
ROCKY PROPERTY (Western Part)		
Samples Location and Gold Geochemistry		
Scale: 1:10,000	Date: Jul-09	NTS Map 92 I/6

## **Field Procedure and Laboratory Technique**

Rock samples were taken in the field with a prospector's pick and collected in standard plastic sample bags. Weight of individual samples ranged from 0.5 to 2.0 kgs.

Rock samples were first crushed to minus 10 mesh (70 % of sample) using jaw and cone crushers. Then 250 grams of the minus 10-mesh material was pulverized to minus 150 mesh using a ring pulverizer. A modified Aqua Regia solution is added to each sample and leached for 1 hour at greater than 95 degrees Celsius. The resulting solution was then analyzed by atomic absorption. The analytical results were then compared to prepared standards for the determination of the absolute amounts. For the determination of the remaining trace and major elements Inductively Coupled Argon Plasma (ICP) was used. In this procedure a 0.5-gram portion of the minus 140-mesh material is digested with aqua regia for 1 hour at 95 degrees Celsius and made up to a volume of 20 mls prior to the actual analysis in the plasma. Again the absolute amounts were determined by comparing the analytical results to those of prepared standards.

Laboratory procedures for specific metals are presented below:

### **Procedure summary for gold fire assay:**

Lead flux and silver inquart are added to the sample and mixed. Samples are fused in batches of 24 assays along with natural standard and a reagent blank. This batch of 26 assays is carried through the whole procedure as a set.

After cupellation (which removes lead), the precious metal bead the precious metal bead is parted in nitric acid to remove the silver. The remaining gold bead is either weighted (gravimetric finish) or dissolved in aqua regia and analyzed on atomic adsorption spectrometer, using a suitable standard set. The natural standard fused along with the sample set must be within 2 standard deviations of its known value or the whole set is re-assayed.

10% of the samples in a set are re-assayed and reported in duplicate, along with the standard and reagent blank.

Detection limit: 0.01 g/tonne

## **CONCLUSIONS AND RECOMMENDATIONS**

The purpose of the 2009 rock sampling program was to examine extensive alteration zones present in the western part of the property which drew no attention by previous property operators preoccupied with copper, gold and platinum mineralization located on the central Rocky Cu Au Pt Zn mineral claim. The collected samples showed no presence of base metals and only minor amount of gold in two float samples. In conclusion, it is recommended to drop the Rocky # 9 and 10 claims. The central Rocky Cu Au Pt Zn claim has very good, attractive mineralization and along with the adjacent claims should be retained.

## REFERENCES

1. BRADFORD, M. (1970); "Report of Geological and Magnetometer Surveys on Pitquah Group Claims" for Lytton Minerals.
2. DAY, W.C. (1988); Report on the Pitquah Property, Silt, Rock chip and Float sampling Program" for Green Lake Resources.
3. MALCOLM, D.C. (1971); "Bod Group Geological Report" for Phelps Dodge Corporation of Canada.
4. MINFILE
5. MORGAN, D.R. (1980); "Report on Geochemical Survey on the Karen 1-8 Claim Group" for Tracer Resource Corporation.

**APPENDIX I**

**ROCK SAMPLES DESCRIPTION**

- AR-44 Float of semiangular, vuggy, strongly limonitic quartz.
- AR-45 Small angular float of strongly limonitic quartz vein with a network of microfractures.
- AR-46 Small angular float of strongly limonitic quartz vein.
- AR-47 Angular float of limonitic quartz with microfractures.
- AR-48 Angular float of quartz cemented breccia.
- AR-49 Grab sample from a small outcrop 1.1 m across (or a large boulder?) of completely quartz-sericite-limonite altered rock.
- AR-50 Float of quartz-epidote vein.
- AR-51 Grab from small, irregular veining within diorite.
- AR-52 Grab from small irregular veining within diorite.
- AR-53 Grab sample from 30 metres wide zone of albitized (?) rock.
- AR-54 Grab sample from completely albite (?) lesser chlorite altered rock
- AR-55 Float from limonite cemented breccia of ultramafic rock. Ultramafic fragments are very strongly altered. Many similar boulders are nearby.
- AR-56 Grab from completely quartz-sericite-limonite altered rock.
- AR-57 Chip 1.0 m from strongly limonitic, completely quartz-sericite altered rock.
- AR-58 Fragment of a large (0.5x0.6m) angular float of completely quartz-sericite altered rock with 1-2% disseminated pyrite.
- AR-61 Angular float of altered diorite cut by 2 cm wide limonitic quartz vein.
- AR-62 Angular float from suboutcrop of limonitic quartz.
- AR-63 Angular float of limonitic quartz with minor coarse grained oxidized pyrite.
- AR-64 Angular float of limonitic quartz
- AR-65 Angular float of strongly altered diorite cut by quartz vein.

- AR-66 Angular float from suboutcrop of slightly limonitic quartz vein.
- AR-67 Angular float of limonitic quartz with minor manganese stain.
- AR-68 Angular float of limonitic quartz hosted in banded amphibolite.
- AR-69 Large float of completely quartz-sericite altered rock with abundant limonite-hematite stain.
- AR-70 Small float of weakly limonitic quartz.
- AR-71 Angular float of limonitic quartz.
- AR-72 Angular float of strongly hematite stained quartz.
- AR-73 Composite sample of 2 small quartz vein float.
- AR-74 Small float of quartz with minor chlorite.
- ARS-1 Silt sample

**APPENDIX II**

**GEOCHEMICAL RESULTS**



*Quality Assaying for over 25 Years***Assay Certificate****9V-0639-RA2**Company: **Alex Walus**  
Project: **ROCKY**  
Attn: **Alex Walus****Jun-03-09**

We hereby certify the following assay of 9 rocks and silt samples submitted May-23-09

<b>Sample Name</b>	<b>Au g/tonne</b>	<b>Au-check g/tonne</b>
AR-66	<0.01	0.02
AR-67	<0.01	
AR-68	<0.01	
AR-69	<0.01	
AR-70	0.01	
AR-71	<0.01	
AR-72	<0.01	
AR-73	<0.01	
AR-74	<0.01	
ARS-1	<0.01	
*0211	2.13	
*BLANK	<0.01	

Certified by \_\_\_\_\_

# Assayers Canada

8282 Sherbrooke St., Vancouver, B.C., V5X 4R6

Tel: (604) 327-3436 Fax: (604) 327-3423

Report No : 9V0639RJ

Date : Jun-03-09

**Alex Walus**

Attention: Alex Walus

Project: ROCKY

Sample type: Rocks and Silt

## Multi-Element ICP-AES Analysis

Aqua Regia Digestion

Sample Number	Ag ppm	Al %	As ppm	Ba ppm	Be ppm	Bi ppm	Ca %	Cd ppm	Co ppm	Cr ppm	Cu ppm	Fe %	Hg ppm	K %	La ppm	Mg %	Mn ppm	Mo ppm	Na %	Ni ppm	P ppm	Pb ppm	S %	Sb ppm	Sc ppm	Sr ppm	Th ppm	Ti %	Tl ppm	U ppm	V ppm	W ppm	Zn ppm	Zr ppm
AR-44	0.4	0.94	<5	23	<0.5	<5	0.09	2	7	196	52	5.53	<1	0.09	<10	0.75	366	13	0.01	5	229	11	0.10	10	4	7	<5	0.03	<10	<10	57	<10	32	4
AR-45	<0.2	0.08	8	<10	<0.5	<5	0.02	1	3	208	47	2.20	<1	0.01	<10	0.02	46	3	0.01	5	52	2	0.01	7	<1	2	<5	<0.01	<10	<10	10	<10	4	1
AR-46	<0.2	0.20	<5	46	<0.5	<5	0.03	<1	2	142	6	0.92	<1	0.08	<10	0.02	120	4	0.05	3	69	3	<0.01	<5	2	3	<5	0.03	<10	<10	3	<10	12	1
AR-47	<0.2	0.02	<5	<10	<0.5	<5	<0.01	<1	1	220	4	0.41	<1	0.01	<10	0.01	24	<2	0.01	6	29	<2	<0.01	6	<1	1	<5	<0.01	<10	<10	1	<10	3	1
AR-48	7.0	0.22	11	13	<0.5	<5	0.25	1	3	190	23	0.49	<1	0.05	<10	0.11	165	9	0.01	5	87	5	<0.01	5	1	6	<5	0.02	<10	<10	27	<10	15	<1
AR-49	<0.2	0.70	7	14	0.7	<5	0.47	2	9	86	6	5.66	<1	0.03	<10	0.30	167	2	0.04	1	165	7	1.00	7	5	45	<5	0.23	<10	<10	106	<10	12	3
AR-50	1.3	1.19	10	<10	0.8	<5	1.36	1	17	219	753	3.63	<1	0.03	<10	0.95	261	4	0.02	18	484	9	0.22	9	6	43	<5	0.10	<10	<10	128	<10	41	2
AR-51	<0.2	0.61	5	56	<0.5	<5	0.55	1	6	125	4	1.91	<1	0.04	<10	0.35	278	<2	0.07	3	485	4	0.01	5	2	14	<5	0.11	<10	<10	32	<10	16	6
AR-52	<0.2	0.90	10	102	0.7	<5	0.99	1	10	97	24	2.07	<1	0.24	<10	0.52	395	2	0.06	7	592	7	0.01	<5	3	40	<5	0.16	<10	<10	78	<10	52	2
AR-53	<0.2	2.05	<5	19	<0.5	<5	1.23	1	17	54	51	2.61	<1	0.03	<10	1.10	282	<2	0.04	23	1605	9	<0.01	6	3	42	<5	0.08	<10	<10	55	<10	39	2
AR-54	<0.2	2.85	6	17	0.8	<5	1.44	1	22	71	29	3.28	<1	0.02	<10	1.42	383	<2	0.11	22	513	11	<0.01	6	4	62	<5	0.15	<10	<10	121	<10	44	3
AR-55	0.4	1.72	1063	35	0.8	<5	0.83	22	24	17	1033	12.44	<1	0.04	<10	0.74	154	5	0.03	11	532	18	0.08	21	15	38	<5	0.18	<10	19	116	<10	31	12
AR-56	<0.2	2.63	72	47	1.0	<5	0.38	4	9	44	33	9.68	<1	0.15	<10	1.58	223	33	0.05	<1	557	16	0.80	11	9	36	<5	0.12	<10	12	148	<10	20	6
AR-57	0.2	1.04	11	25	<0.5	<5	0.60	2	53	80	171	4.25	<1	0.04	<10	0.11	36	5	0.03	5	189	8	1.63	7	<1	32	<5	0.07	<10	<10	20	<10	8	3
AR-58	<0.2	2.46	22	17	1.3	<5	0.47	3	59	71	251	8.69	<1	0.03	<10	2.26	238	3	0.04	17	206	16	>5.00	10	6	19	<5	0.28	<10	10	206	<10	31	9
AR-59	0.5	0.22	<5	74	<0.5	<5	0.01	1	1	100	17	1.87	<1	0.10	<10	0.05	30	<2	0.04	2	99	5	0.04	<5	<1	2	<5	<0.01	<10	<10	5	<10	6	1
AR-60	<0.2	0.08	<5	<10	<0.5	<5	0.02	<1	1	244	4	0.28	<1	0.01	<10	0.04	27	6	0.01	5	12	4	0.01	6	<1	4	<5	<0.01	<10	<10	2	<10	5	<1
AR-61	<0.2	0.51	<5	11	<0.5	<5	0.02	1	7	98	11	2.12	<1	0.04	<10	0.43	161	3	0.05	3	204	4	0.14	5	2	3	<5	0.01	<10	<10	16	<10	22	1
AR-62	<0.2	0.80	7	16	<0.5	<5	0.42	1	12	135	9	1.34	<1	0.06	<10	0.31	325	4	0.04	8	189	4	0.04	5	2	32	<5	0.04	<10	<10	18	<10	24	1
AR-63	<0.2	0.24	<5	<10	<0.5	<5	0.07	<1	4	185	16	0.99	<1	0.02	<10	0.15	99	3	0.02	7	61	2	0.07	6	1	4	<5	0.02	<10	<10	8	<10	8	1
AR-64	<0.2	0.50	<5	<10	<0.5	<5	0.03	1	6	161	32	1.70	<1	0.04	<10	0.32	284	9	0.05	3	88	4	0.01	5	1	1	<5	0.01	<10	<10	17	<10	32	1
AR-65	<0.2	0.28	<5	<10	<0.5	<5	0.01	<1	1	121	7	0.72	<1	0.02	<10	0.23	83	4	0.06	3	45	2	0.01	<5	2	1	<5	0.01	<10	<10	9	<10	7	1
AR-66	<0.2	0.06	<5	<10	<0.5	<5	0.01	<1	1	181	3	0.25	<1	0.01	<10	0.03	42	<2	0.01	5	16	<2	0.01	<5	<1	1	<5	<0.01	<10	<10	1	<10	5	<1
AR-67	<0.2	0.12	5	<10	<0.5	<5	<0.01	<1	1	180	9	0.46	<1	0.01	<10	0.09	194	<2	0.01	6	29	3	<0.01	5	2	1	<5	<0.01	<10	<10	3	<10	19	<1
AR-68	<0.2	0.28	<5	32	<0.5	<5	0.01	<1	1	111	2	0.51	<1	0.21	<10	0.01	13	3	0.02	2	29	2	0.13	<5	<1	1	<5	<0.01	<10	<10	1	<10	2	1
AR-69	<0.2	0.31	<5	18	<0.5	<5	0.09	1	2	92	3	1.59	<1	0.06	<10	0.11	33	<2	0.06	2	86	2	0.65	<5	1	8	<5	0.03	<10	<10	6	<10	5	1
AR-70	<0.2	0.25	<5	26	<0.5	<5	<0.01	<1	1	89	1	0.25	<1	0.15	<10	0.01	11	2	0.02	2	31	2	0.02	<5	<1	1	<5	<0.01	<10	<10	1	<10	1	1
AR-71	0.2	0.11	5	<10	<0.5	<5	0.05	1	5	187	34	1.21	<1	0.04	<10	0.06	34	<2	0.01	9	43	2	0.11	6	<1	4	<5	0.01	<10	<10	5	<10	4	1
AR-72	<0.2	0.01	<5	<10	<0.5	<5	<0.01	<1	1	216	3	0.39	<1	<0.01	<10	<0.01	36	<2	0.01	6	37	<2	<0.01	5	<1	<1	<5	<0.01	<10	<10	1	<10	2	<1
AR-73	<0.2	0.71	10	19	<0.5	<5	0.16	1	5	140	6	1.67	<1	0.06	<10	0.50	375	3	0.03	3	255	8	0.03	5	2	4	<5	0.04	<10	<10	25	<10	58	1

A .5 gm sample is digested with 5 ml 3:1 HCl/HNO3 at 95°C for 2 hours and diluted to 25ml.

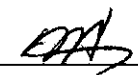

# Assayers Canada

8282 Sherbrooke St., Vancouver, B.C., V5X 4R6

Tel: (604) 327-3436 Fax: (604) 327-3423

Report No : 9V0639RJ

Date : Jun-03-09

**Alex Walus**

Attention: Alex Walus

Project: ROCKY

Sample type: Rocks and Silt

## Multi-Element ICP-AES Analysis

Aqua Regia Digestion

Sample Number	Ag ppm	Al %	As ppm	Ba ppm	Be ppm	Bi ppm	Ca %	Cd ppm	Co ppm	Cr ppm	Cu ppm	Fe %	Hg ppm	K %	La ppm	Mg %	Mn ppm	Mo ppm	Na %	Ni ppm	P ppm	Pb ppm	S %	Sb ppm	Sc ppm	Sr ppm	Th ppm	Ti %	Tl ppm	U ppm	V ppm	W ppm	Zn ppm	Zr ppm
AR-74	<0.2	1.00	5	14	<0.5	<5	0.33	2	6	102	49	1.33	<1	0.04	<10	0.39	514	<2	0.04	3	185	9	0.01	5	3	17	<5	0.07	<10	<10	9	<10	275	1
ARS-1	<0.2	3.58	10	57	1.1	<5	2.59	2	15	58	45	3.47	<1	0.16	<10	0.99	481	<2	0.09	11	1072	17	0.01	7	4	161	<5	0.12	<10	<10	112	<10	60	4

A .5 gm sample is digested with 5 ml 3:1 HCl/HNO3 at 95°C for 2 hours and diluted to 25ml.