

Ministry of Energy & Mines  
 Energy & Minerals Division  
 Geological Survey Branch

ASSESSMENT REPORT  
 TITLE PAGE AND SUMMARY

TITLE OF REPORT [type of survey(s)] DIAMOND DRILL REPORT TOTAL COST \$ 18,594.00

AUTHOR(S) WILLY KOVACEVIC SIGNATURE(S) [Signature]

NOTICE OF WORK PERMIT NUMBER(S)/DATE(S) MX-4-536 YEAR OF WORK 2009

STATEMENT OF WORK - CASH PAYMENT EVENT NUMBER(S)/DATE(S) 4628373

PROPERTY NAME CLINTON SILICA

CLAIM NAME(S) (on which work was done) GLASS TENURE #591410

COMMODITIES SOUGHT SILICA

MINERAL INVENTORY MINFILE NUMBER(S), IF KNOWN NONE

MINING DIVISION CLINTON NTS 92P013

LATITUDE 51 ° 12 ' \_\_\_\_\_ " \_\_\_\_\_ LONGITUDE 121 ° 55 ' \_\_\_\_\_ " \_\_\_\_\_ (at centre of work)

OWNER(S)  
 1) AL HARVEY 2) \_\_\_\_\_

MAILING ADDRESS  
Box 67  
CLINTON, B.C. V0K 1K0

OPERATOR(S) [who paid for the work]  
 1) AL HARVEY 2) \_\_\_\_\_

MAILING ADDRESS  
Box 67  
CLINTON, B.C. V0K 1K0

PROPERTY GEOLOGY KEYWORDS (lithology, age, stratigraphy, structure, alteration, mineralization, size and altitude):

The property is underlined by two main rock types: Permian to Triassic Cache Creek Complex – marine sedimentary and volcanic rocks in contact with Miocene to Pleistocene Chilcotin Group – basaltic volcanic rocks.

REFERENCES TO PREVIOUS ASSESSMENT WORK AND ASSESSMENT REPORT NUMBERS NONE AVAILABLE

TYPE OF WORK IN THIS REPORT	EXTENT OF WORK (IN METRIC UNITS)	ON WHICH CLAIMS	PROJECT COSTS APPORTIONED (incl. support)
-----------------------------	----------------------------------	-----------------	---

GEOLOGICAL (scale, area)

Ground, mapping \_\_\_\_\_

Photo interpretation \_\_\_\_\_

GEOPHYSICAL (line-kilometres)

Ground

Magnetic \_\_\_\_\_

Electromagnetic \_\_\_\_\_

Induced Polarization \_\_\_\_\_

Radiometric \_\_\_\_\_

Seismic \_\_\_\_\_

Other \_\_\_\_\_

Airborne \_\_\_\_\_

GEOCHEMICAL

(number of samples analysed for ...)

Soil \_\_\_\_\_

Silt \_\_\_\_\_

Rock \_\_\_\_\_

Other \_\_\_\_\_

DRILLING

(total metres; number of holes, size)

Core 2 BH HOLES "80" 64 METERS TENURE # 591410 \$ 18,594

Non-core     

RELATED TECHNICAL

Sampling/assaying \_\_\_\_\_

Petrographic \_\_\_\_\_

Mineralographic \_\_\_\_\_

Metallurgic \_\_\_\_\_

PROSPECTING (scale, area) \_\_\_\_\_

PREPARATORY/PHYSICAL

Line/grid (kilometres) \_\_\_\_\_

Topographic/Photogrammetric (scale, area) \_\_\_\_\_

Legal surveys (scale, area) \_\_\_\_\_

Road, local access (kilometres)/trail \_\_\_\_\_

Trench (metres) \_\_\_\_\_

Underground dev. (metres) \_\_\_\_\_

Other \_\_\_\_\_

TOTAL COST 18,594

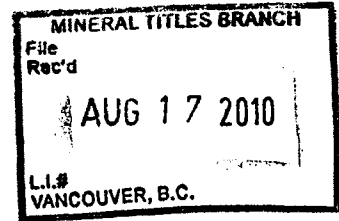

**DIAMOND DRILL REPORT  
ON  
CLINTON SILICA CLAIMS**

Clinton mining division  
51° 12 N' 1 21° 55' W  
NTS 92P 013

**BC Geological Survey  
Assessment Report  
31656**

for  
Al Harvey of  
Clinton, B.C.

Property Owner: **Al Harvey**  
Operator and Owner **Al Harvey**  
Report Prepared by: **Willy Kovacevic  
Tilava Mining Corporation**

August 6, 2010

**31,656**  
**GEOLOGICAL SURVEY BRANCH  
ASSESSMENT REPORT**

## SUMMARY OF CONTENTS

Page No.

### SUMMARY

<b>1. INTRODUCTION</b>	<b>1</b>
1. Location and Access	1
2. Property	
3. Physiography and Vegetation	1
<b>3. PROPERTY GEOLOGY</b>	<b>2</b>
<b>4. 2009 DRILL PROGRAM</b>	<b>2</b>
<b>5. CONCLUSION AND RECOMMENDATIONS</b>	<b>3</b>
<b>6. STATEMENT OF EXPENDITURES</b>	<b>4</b>
<b>7. STATEMENT OF QUALIFICATION</b>	<b>5</b>

### APPENDICES

**APPENDIX I Drill Logs S-09-01 and S-09-02**

**APPENDIX II Certificates of Analysis**

## **SUMMARY**

During the period September 15, 2009 to November 10, 2009, a short diamond drill program consisting of two diamond drill holes totaling 64 meters was carried on Clinton Silica Claims to test silica zone in an exposed ledge. The silica zone is approximately 30 meters wide and is dipping to the southwest. There is no historical evidence that any diamond drilling took place on the site nor any reports of work or Minfile records is known to exist therefore, references are omitted in this Report.

The purpose of this report is to describe the results of the 2009 diamond drilling on this target.

## INTRODUCTION

### Location and Access

The Clinton Silica claim group is covered by NTS sheet 92P 013 approximately 2.8 kilometers northeast from Clinton, B.C. The access to the claims is by taking gravel road north from Clinton rail station to app. 650 meters to a fork with dirt road and traveling east along for about 1.8 kilometers.

### Property

The property described in this report consists of 3 Tenures totaling 446.29 hectares as follows:

Tenure No	Claim Name	Good Until	Area (ha)
591410	Glass	May 15, 2015	121.72
602367	Glass	May 15, 2015	243.445
629563	Glass B	May 15, 2015	81.1321

The property is owned by Al Harvey of Clinton, British Columbia.

### Physiography and Vegetation

The topography at Clinton Silica claims is characterized by rolling hills, between 900 and 1200 meters. Situated within semi-arid climatic belt. The area vegetation consists mainly of Ponderosa pine, bunch grass.

# Clinton Silica Location Map



Map Center: 54.4781N 124.7082W

SCALE 1 : 8,501,378

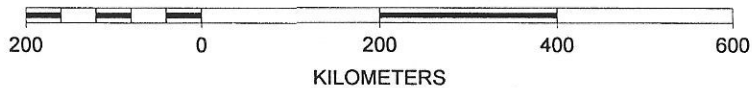
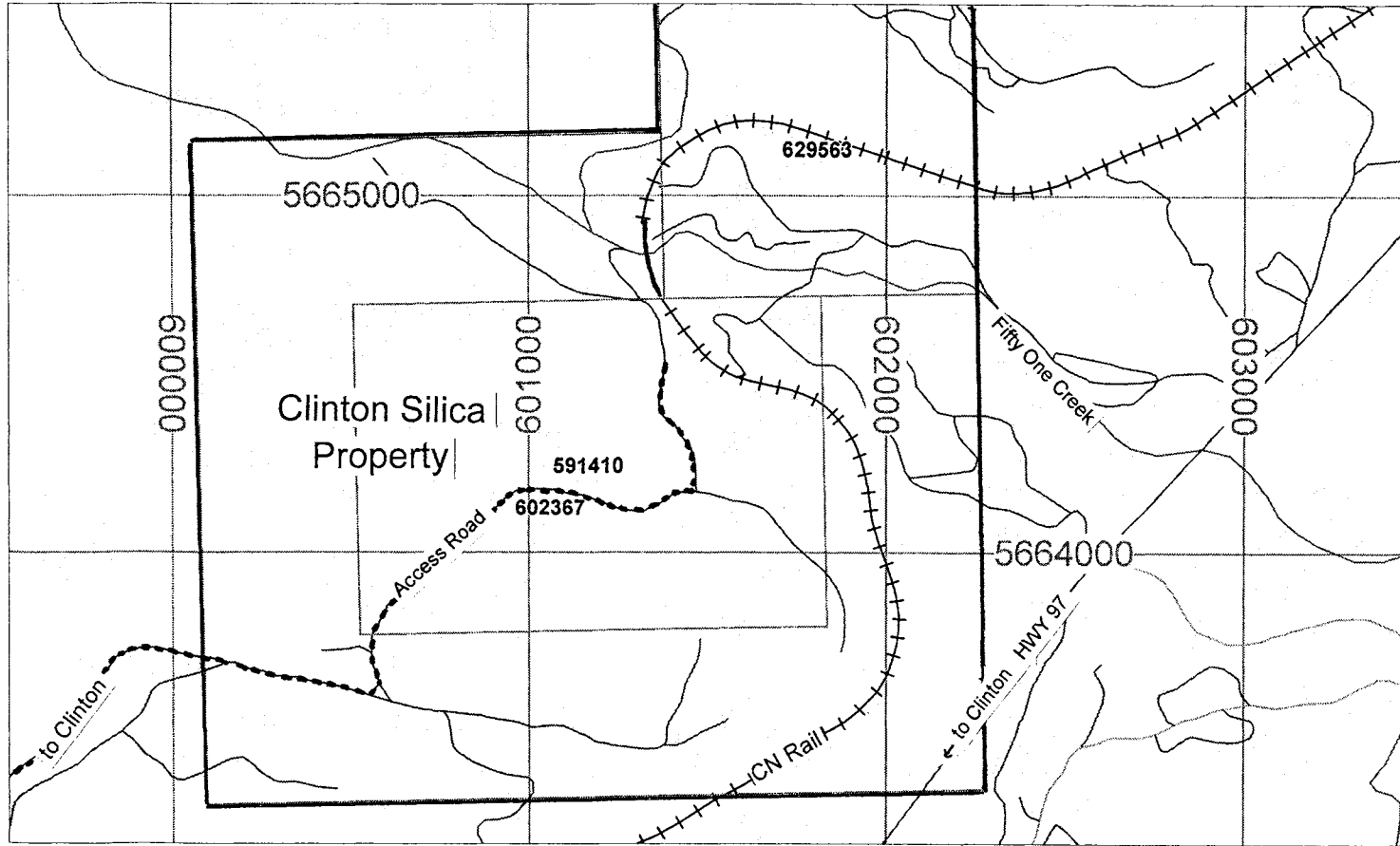

FIG. 1



# Clinton Silica Location Map - FIG. 1-A



SCALE 1 : 20,000

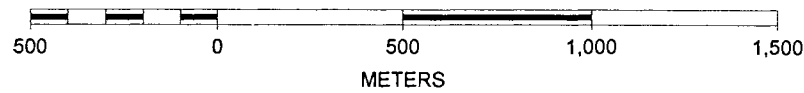



The climate is typical of Kamloops and Cariboo region with cold winters and warm summers which may last for five month. Field work can generally carried out from April to November but drilling can continue year round.

## **GEOLOGY AND MINERALIZATION**

The property is underline by two main rock types Permian to Triassic Cache Creek Complex – marine sedimentary and volcanic rocks in contact to Miocene to Pleistocene Chilcotin Group – basaltic volcanic rocks (Fig.3). The Aeromag 1<sup>st</sup> Vertical Gradient also suggests that the property is underline by limestone (Fig. 4).

The property is overlain by overburden and outcrops are sparse. An open face ledge centered at about 601044 E and 56644165 N represents the best rock exposure. The size of the exposed rocks at this location is about 200 meters wide and about 40-50 meters high. A silicified zone measuring about 30 meters is exposed in the open ledge. The apparent trend of the zone is northwest and is dipping to the west. The silica content of the zone is of high grade. There is no evidence that the zone was ever drilled or trenched.

## **2009 DRILL PROGRAM**

A program of diamond drilling was completed during November, 2009. A total of 64 meters of “BQ” size core was carried out by Core Enterprise Ltd. of Clinton B.C. Core recovery was excellent. Logging of the core and splitting of appropriate section was carried on the Owner’s property in Clinton, B.C. and the core is presently stored on the same property.

# Clinton Silica Drill Hole location - FIG. 2

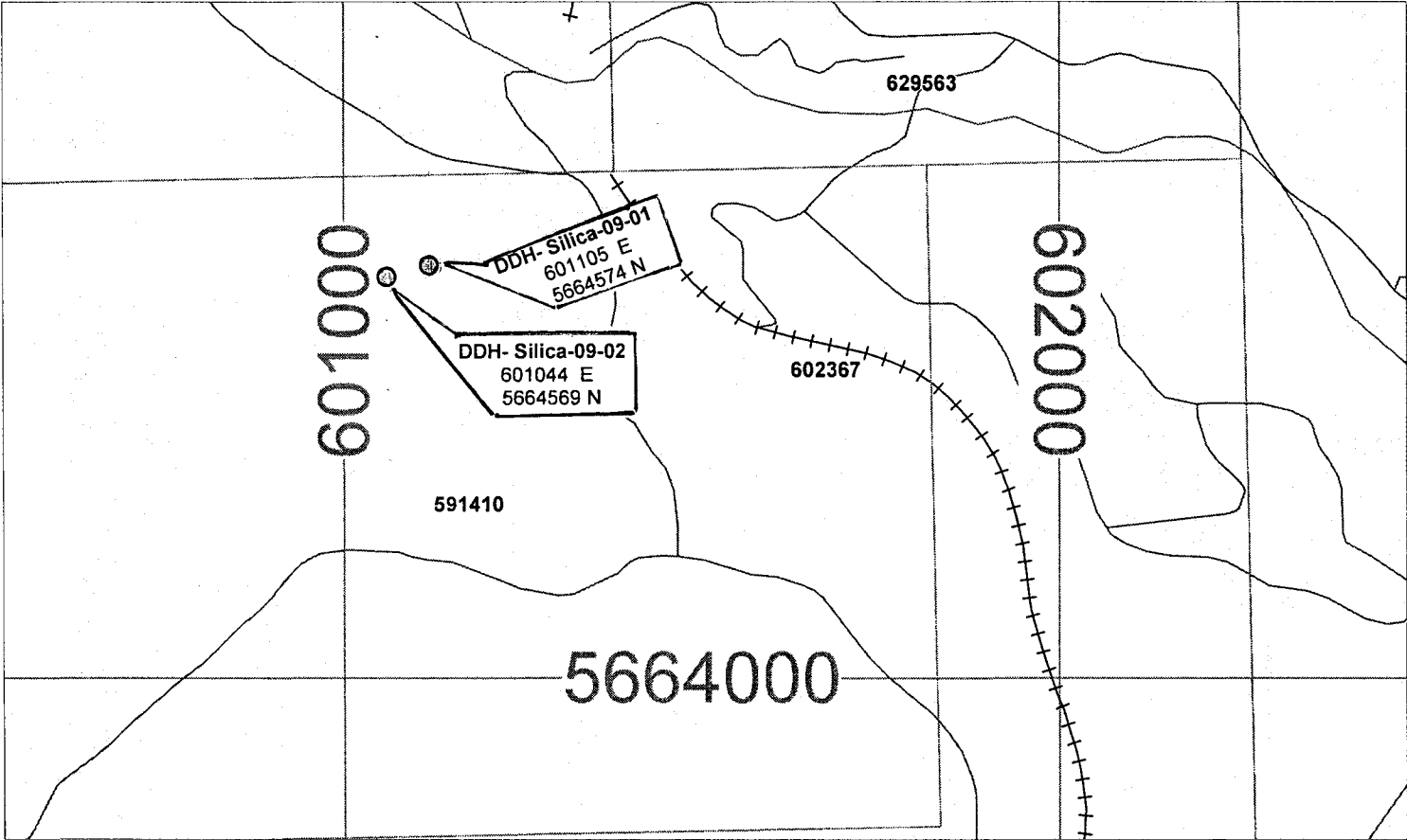

SCALE 1 : 10,000

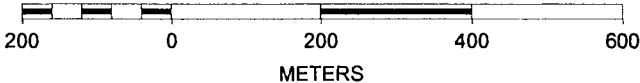

# Clinton Silica Property Geology Map

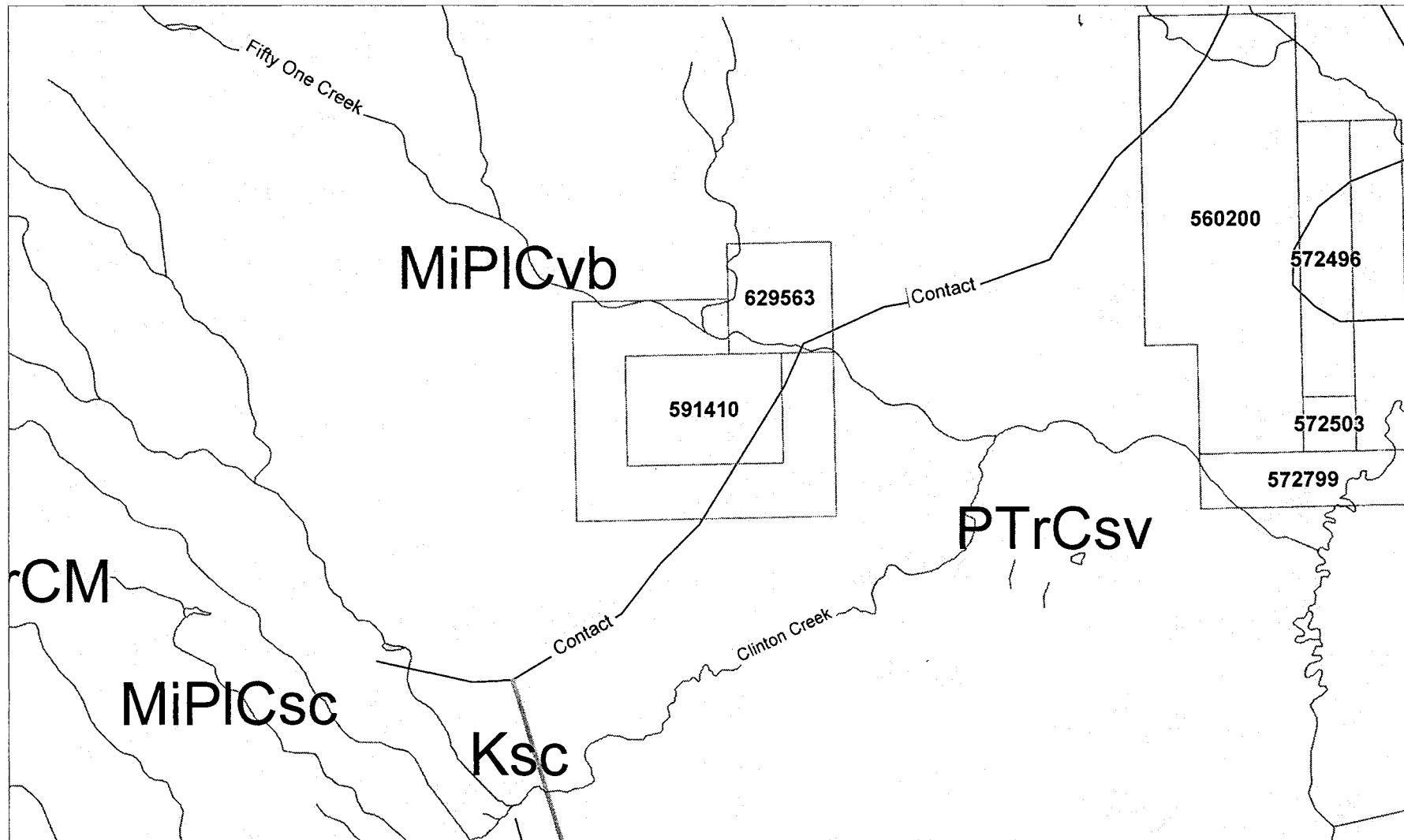

SCALE 1 : 50,000

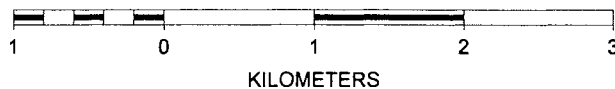

KILOMETERS

Fig. 3



## Legend

### **MiPICvb**

Miocene to Pleistocene  
Chilcotin Group  
basaltic volcanic rocks

### **PTrCsv**

Permian Triassic  
Cache Creek Complex  
marine sedimentary rocks

### **MiPICsc**

Miocene to Pleistocene  
Chilcotin Group  
coarse clastic sedimentary rocks

# Clinton Silica Property Aeromag 1st Vertical Derivative

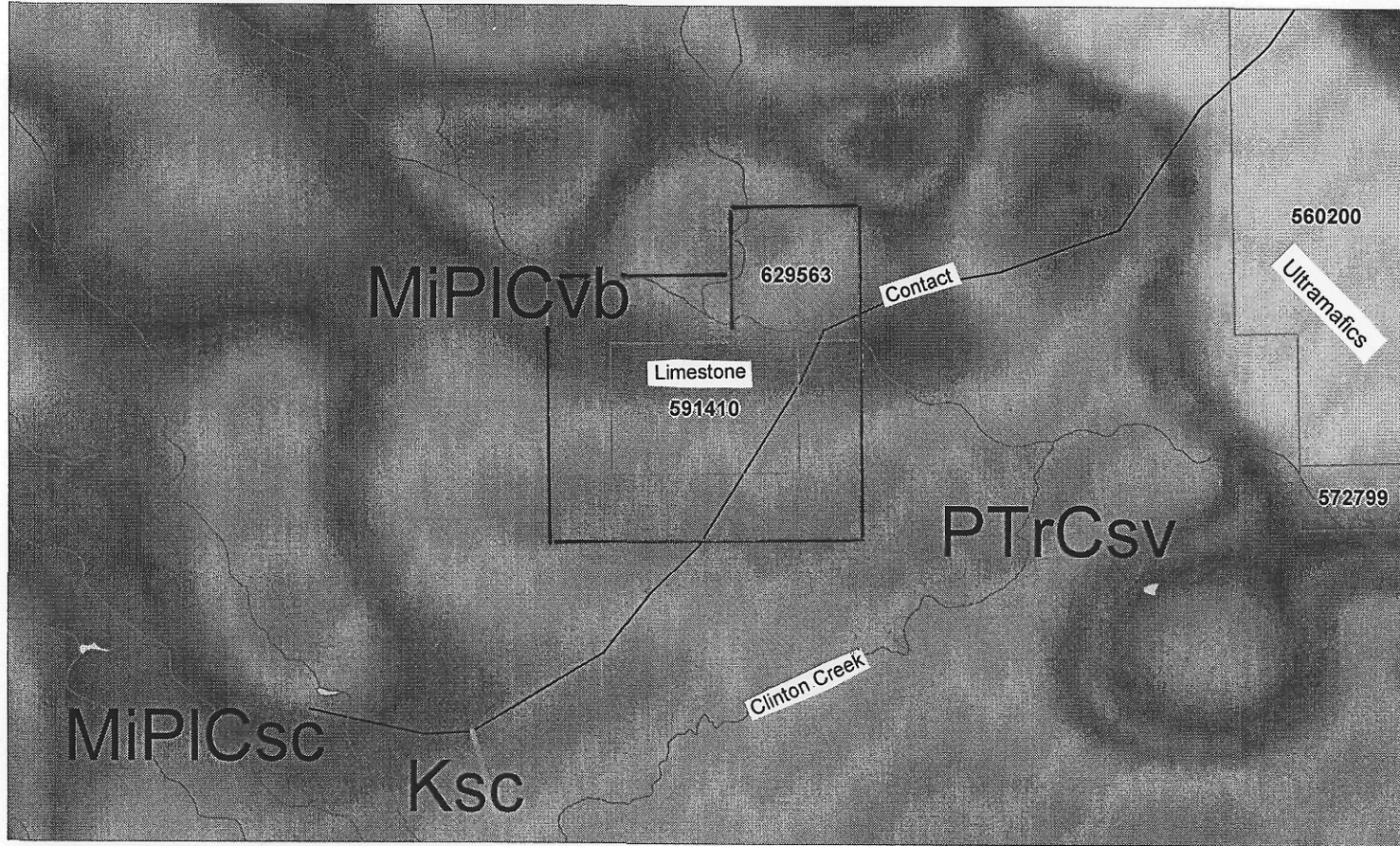

SCALE 1 : 50,000

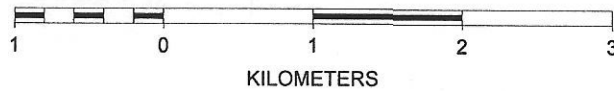

Fig. 4



**CONCLUSION AND RECOMMENDATION**

The short drill program was successful in proving that the substantial silica deposit of fair quality 75-90% may exist on the drilled site and, elsewhere on the property, however a single short drill was not adequate to estimate the extent of the showing drilled. It is recommended that the owner plan additional 3-6 diamond drill holes program to evaluate the silica deposit.

**Statement of Expenditures**

---

1	Personnel Al Harvey Project Manager 5 days @ \$200/day	\$ 1,000.00
2.	Contract Diamond Drilling Core Enterprises Ltd Clinton, B.C.	16,020.00
3.	Geochemical Analyses Eco-Tech Lab Kamloops, B.C.	574.00
4.	Core splitting, handling and miscellaneous equipment	500.00
5	Report preparation and Drafting Tilava Mining Corporation Clinton, B.C.	500.00
	Total Project Cost	\$18,594.00 =====

### Statement of Qualification

I, Willy Kovacevic, of the Village of Clinton, British Columbia, DO HEREBY CERTIFY THAT I have the following prospecting and related experience:

- 1971            Completed The Canadian Securities Course (The Investment Dealers Association of Canada)
  
- 1972            Attended a prospecting course (hard rock) organized by the B.C. & Yukon Chamber of Mines.
  
- 1975-1976    Developed and shipped polymetallic ore from Adams Plateau, B.C. to Cominco (Borex Mining Ltd. Spar 1 and Spar 2 claims).
  
- 1976            Attended a prospecting course (placer gold recovery) organized by B.C. & Yukon Chamber of Mines.
  
- 1977-1978    As the President of Lorcan Resources Ltd. (VSE public company) supervised and participated in geophysical survey and diamond drilling (Lost Cabin Mine, California) – worked as diamond driller helper.
  
- 1977-1979    Prospected and geochemically surveyed group of claims owned by Mineta Resources Ltd. (VSE public company) in Monashee Range, B.C. Prospected and geochemically surveyed in south-central B.C. for Tilava Mining Corporation (as owner).
  
- 1980-1983    Explored for oil and gas in USA, produced and marketed oil in Clinton County, Kentucky for Robico Investment Ltd (as owner) and for group of VSE public companies, Mineta Resources Ltd., Westam Oil Ltd and Boram Oil Ltd (as principal).
  
- 1983-1900    Supervised and participated in various phases of exploration on the properties owned by Star of Mineta Ltd (VSE public company) as principal (Kirkland Lake, Ontario, Adams Plateau, B.C. and Golden Loon claims, Little Fort, B.C.)
  
- 1993-2009    Prospected Golden Loon Claims, Little Fort, B.C. for Star of Mineta (VSE public company) as principal and Tilava Mining Corporation as owner and WK and AW claims group, Clinton, B.C as owner mainly for industrial minerals: Chromium, Pozzolan and Bentonite.

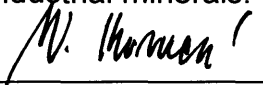

---

Willy Kovacevic  
Prospector



## Appendix I

Property: Clinton Silica

**DDH Silica-09-01**

Collar: 601105 E 5664574 N

Azimuth 180 South

Dip -45

TD 48.76 meters

Logged by: Al Harvey

Intervals Meters	SiO2
<hr/>	
0-3 meters overburden	
3- 45.72 silica zone	
3.04 to 6.08	87.97
6.09 to 9.14	86.34
9.15 to 12.19	87.98
12.20 to 15.24	83.62
15.25 to 18.28	81.09
18.28 to 21.33	86.13
21.34 to 24.38	85.75
24.38 to 27.43	73.66
27.44 to 30.48	85.74
30.49 to 33.66	83.89
36.56 to 36.57	81.36
36.58 to 39.62	82.78
39.63 to 42.67	82.25
42.68 to 47.72	67.66
45.73 to 48.76	62.22

TD 48.76

Note: At section 45.73 to TD rock appears to be less silicified and more graphitic possibly indicate end of the silica zone.

Property: Clinton Silica

**DDH Silica-09-02**

Collar: 601044 E 5664569 N

Azimuth 0 (365) North

Dip - 50

TD 15.24

Intervals  
Meters

---

0 to 9.14 overburden

9.14 to 15.24 clay and heavy sand

Note: DDH abandoned - heavy overburden

## Appendix II

Eco Tech Laboratory Ltd.  
 2953 Shuswap Road  
 Kamloops, BC  
 V2H 1S9 Canada  
 Tel + 1 250 573 5700  
 Fax + 1 250 573 4557  
 Toll Free + 1 877 573 5755  
 www.stewartgroupglobal.com



**StewartGroup**  
 Geochemical & Assay

**WHOLE ROCK CERTIFICATE OF ANALYSIS AK 2010-0135**

**Core Enterprises Ltd**  
 Box 67  
**Clinton, BC**  
 V0K 1K0

11-Mar-10

No. of samples received: 15  
 Sample Type: Core  
 Project: Silica  
 Submitted by: Al Harvey

Note: Values expressed in percent

ET #.	Tag #	BaO	P2O5	SiO2	MnO	Fe2O3	MgO	Al2O3	CaO	TiO2	Na2O	K2O	L.O.I.
1	Silica #1 10-20	0.11	0.05	87.97	0.07	2.23	0.82	3.47	1.19	0.16	0.19	1.08	2.1
2	Silica #2 20-30	0.08	0.01	86.34	0.10	1.63	1.23	1.53	3.26	0.06	0.05	0.59	4.4
3	Silica #3 30-40	0.08	0.02	87.98	0.12	1.38	0.94	1.67	3.11	0.06	0.05	0.67	3.5
4	Silica #4 40-50	0.15	0.04	83.62	0.12	2.13	1.09	3.03	3.35	0.13	0.06	1.17	4.5
5	Silica #5 50-60	0.14	0.04	81.09	0.17	2.21	1.38	3.67	3.78	0.15	0.05	1.46	5.2
6	Silica #6 60-70	0.09	0.02	86.13	0.09	1.73	1.33	2.19	2.85	0.08	0.08	0.83	4.9
7	Silica #7 70-80	0.08	0.03	85.75	0.14	1.67	0.74	2.55	3.27	0.10	0.09	0.93	4.0
8	Silica #8 80-90	0.11	0.05	73.66	0.16	2.21	0.88	4.52	2.96	0.20	0.08	1.53	13.3
9	Silica #9 90-100	0.09	0.03	85.74	0.17	1.80	0.82	3.28	3.23	0.14	0.08	1.08	3.3
10	Silica #10 100-110	0.13	0.02	83.89	0.20	1.37	1.18	2.04	4.77	0.08	0.06	0.82	5.4
11	Silica #11 110-120	0.09	0.02	81.36	0.20	1.59	2.24	2.32	4.72	0.09	0.10	0.83	6.3
12	Silica #12 120-130	0.07	0.02	82.78	0.17	1.93	1.86	2.93	3.22	0.11	0.06	0.96	4.9
13	Silica #13 130-140	0.14	0.03	82.25	0.10	2.46	1.68	4.66	2.00	0.19	0.08	1.58	4.1
14	Silica #14 140-150	0.24	0.12	67.66	0.09	5.29	5.61	9.98	1.12	0.66	0.66	2.41	5.6
15	Silica #15 150-160	0.13	0.10	62.22	0.10	4.54	7.16	7.34	5.76	0.56	0.24	1.71	9.4

**QC DATA:**

**Repeat:**

1	Silica #1 10-20	0.11	0.05	88.48	0.07	2.25	0.84	3.50	1.23	0.17	0.21	1.10	2.0
---	-----------------	------	------	-------	------	------	------	------	------	------	------	------	-----

**Resplit:**

1	Silica #1 10-20	0.12	0.06	87.60	0.07	2.34	0.93	3.66	1.33	0.17	0.23	1.13	1.9
---	-----------------	------	------	-------	------	------	------	------	------	------	------	------	-----

**Standard:**

LOI STD													32.4
TBD1		0.03	0.23	50.24	0.20	14.38	5.89	13.76	9.85	2.24	2.27	0.91	0.3

**ECO TECH LABORATORY LTD.**

Norman Monteith

B.C. Certified Assayer

df/wr

XLS/10