

**GEOLOGICAL MAPPING,
PROSPECTING & SAMPLING REPORT**

on the

JI 2 TO JI 7 CLAIMS

NTS Map Sheet 092G071



**BC Geological Survey
Assessment Report
31885**

by

D.K. BRAGG
OWNER-OPERATOR-AUTHOR
Vancouver, B.C.

June 21, 2010

**GEOLOGICAL SURVEY BRANCH
ASSESSMENT REPORT**

31,885

TABLE OF CONTENTS

	<u>Page No.</u>
SUMMARY AND INTRODUCTION	1
LOCATION AND ACCESSIBILITY	2
GEOLOGY	2
FIELD WORK AND REPORT PREPARATION	2
RESULTS	11
RECOMMENDATIONS	12
CONCLUSIONS	12
STATEMENT OF COSTS	13
QUALIFICATIONS - Donald K. Bragg	14
QUALIFICATIONS - Zoran Pudar	16
BIBLIOGRAPHY	17

Table 1

Figure 1	Index Map	4
Figure 2	Claim Map (dated June 5, 2010)	5
Figure 2a	Claim Map (dated December 2010)	6
Figure 3	Topography and Geology Map Showing 2010 Sample Sites North of North Lake	POCKET
Figure 4	Sample Location Map From A.R. 14736	7
Figure 5/6/7	Google of North Sechelt Peninsula	8,9,10
Figure 8	Topography and Geology Map South of Klein Lake	POCKET

APPENDIX 1 SAMPLE DESCRIPTIONS AND CERTIFICATES OF ANALYSES

SUMMARY AND INTRODUCTION

The JI Claim, Tenure Number 523628, was acquired on December 9, 2005 and inadvertently was allowed to be forfeited on March 31, 2010. The error was discovered and the area of the JI claim plus a few other cells were located on June 6, 2010 by the JAY 1 claim Tenure Number 787762.

The JI-1 to JI-7 claims, Tenure Numbers 583153, 583154, 583156, 583158, 583159, 583160, and 583162, were acquired on April 29, 2008. The JI and JI-1 claims were acquired to cover the old showings that had been worked on and high graded in the past. (See Edward W. Grove, Ph.D., P.Eng., June 28, 1962, Assessment Report 11,129). The JI-2 to JI-7 claims were acquired to cover regional geochemistry to the south of the JI, the JI-1, and the Dancer group of claims.

The JI-8, 9, 10, 11 claims, Tenure Numbers. 605549, 605550, 605551, and 605552, were acquired on June 5, 2009 to expand the tenure holdings on the Sunshine Coast. Unfortunately, these claims were inadvertently allowed to be forfeited on June 5, 2010. A very good friend of D.K. Bragg notified him that these claims had forfeited and then he was able to reacquire the same area with the JAY 8, 9, 10, 11 claims, Tenure Numbers. 787782, 787802, 787822, and 787842.

The first reported work done in the area was in 1913 and again in 1961. The greatest amount of work was done during the late 1970's and early 1980's.

During the period April 19 to April 24, 2009, D.K. Bragg, accompanied by Zoran Pudar, B.Sc., Geol. and Vice President of Exploration for Golden Reign Resources Ltd. of Vancouver, visited the property to try to find and sample the showings that were indicated on the Sample Location map from AR14736 (See Fig. 4 this report). Although 23 samples were taken, only one sample, other than the samples taken from the NL Vein, suggested we found the sample sites indicated on Figure 4 in this report.

Since Golden Reign Resources Ltd. was looking for a property to work on, it was decided to visit the property again in 2010 when John LaRue was asked to accompany us with the hope that he could remember where the sample sites could be found.

LOCATION AND ACCESSIBILITY

The J1, JI-1 to JI-7, and the JAY 8 to JAY 11 claims, along with the Dancer 1 to 4 claim overlie most of the northern portion of the Sechelt Peninsula southerly to Spiipiyus Park and to the east of the northern part of the park.

The claims can be reached from Vancouver via ferry from Horseshoe Bay to Langdale and via Highway 101 to the Egmont turnoff south of Earl's Cove.

The area is typical West Coast rain forest of fir, cedar, hemlock, poplar and alder. In places, a very dense understorey that impedes travel though the forest. The ground is covered by smaller plants and very thick moss that covers most outcrops which requires being cleaned off in order to see the rocks.

GEOLOGY

The geology of the area has been well documented by others who have worked in the area in the past (see Bibliography).

The NL Vein is the most exposed and visible showing. Assays as high as 8.8 oz/ton Au and 10.6 oz/ton of Ag have been obtained from this showing but the writer suspects this may have been high graded or concentrated.

FIELD WORK AND REPORT PREPARATION

In preparation for the 2010 field season, two more Google representations of the North Sechelt Peninsula were obtained (Figs. 6 and 7) and blown up for field use. And again, although the resolution was not the best, they did help in delineating some probable faults and fault intersections, but many of the old roads and trails did not show up. In order to help with orientating to these Google representations, roads were mapped in some detail. While doing this, the roads were prospected and interesting areas were sampled.

Since Golden Reign Resources Ltd. was still looking for a new project, their Vice President of Exploration Zoran Padder, along with John LaRue of Lillooet a prospector of many years experience, and the owner of the Dancer 1-4 claims, joined D.K. Bragg on the property on May 16, 2010.

John LaRue spent considerable time in the area during the late 1970's and early 1980's and had worked on the Dancer 1-4 claims since then.

During May 16 and 17 John LaRue was able to locate a number of the old showings but, since much of the area he worked on has been logged and many of the current roads are new, some of the old showings were not found. But Mr. LaRue was able to suggest some areas where he thought the old sample sites were located. At best, these areas were a start for detailed follow up prospecting.

During May 16 and 17, Zoran Padder was able to collect nine samples from the zones that John LaRue was able to find and identify. The resulting assays of these samples are contained in Table 1. Using the topography and geology base map that was produced for the Prospecting and Physical Work Report on the JI and JI-1 by D.K. Bragg, July 1, 2008, the 2010 sample locations were plotted.

From May 18 to 25, the writer mapped and prospected the area south of Klein Lake. During this period, a topographic and geology map was produced. eight rock samples and six stream samples were taken and plotted on this map.

On the evening of May 25, the writer returned to the beach area and on May 26, prospected the area and took two rock samples and one rusty seep sample.

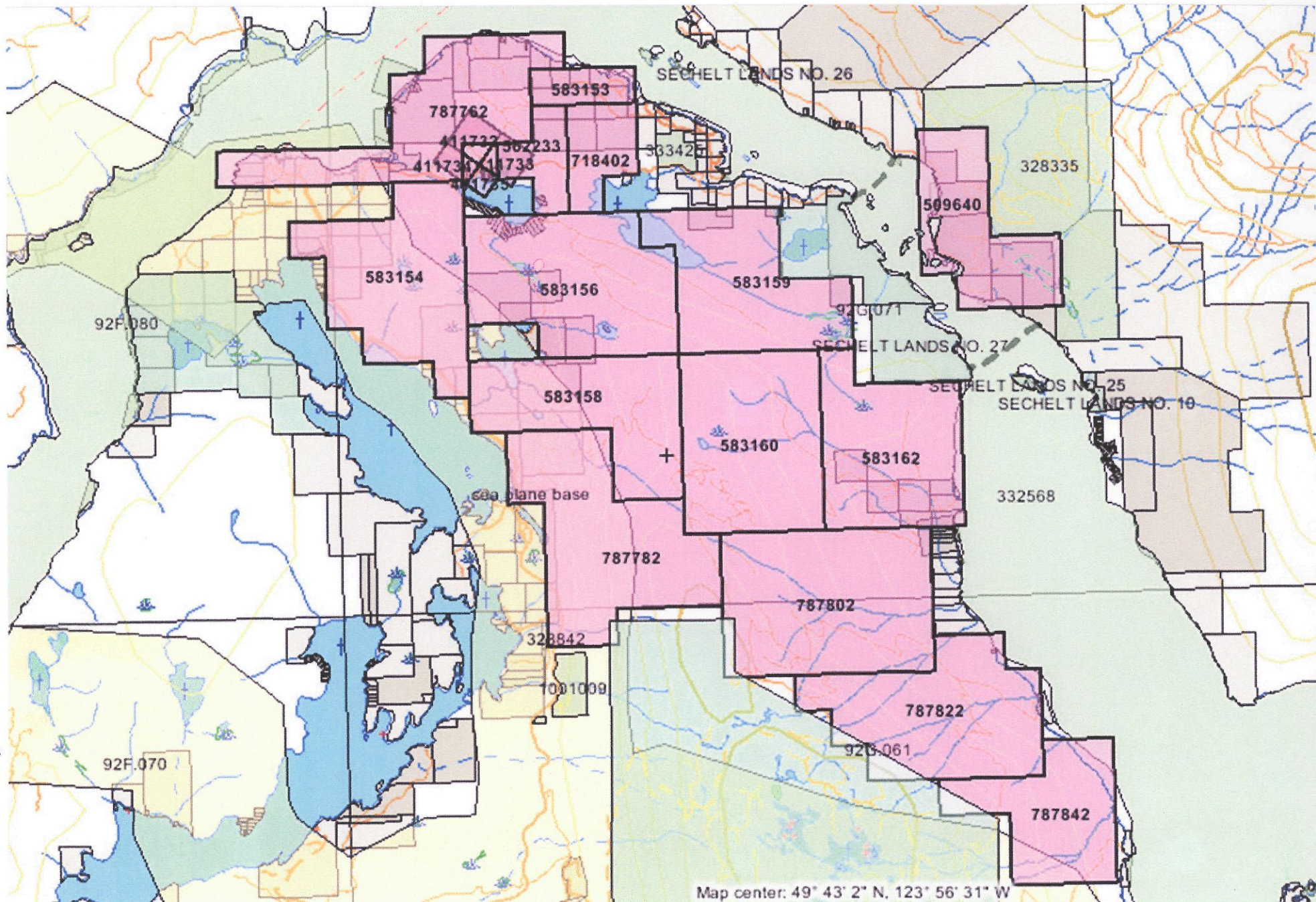

FIG. 2a

Page 6

Map center: 49° 43' 2" N, 123° 56' 31" W

Date Dec 2010 FIG 2a

CHALICE MINING INC.

Au FA oz/to	Ag FA oz/to	Map No.	Name
0.796	1.18	1	Hoser I
0.816	1.00	2	Hoser II
0.356	0.34	3	Hoser III
0.342	0.46	4	"y"
1.054	1.12	5	750N/750W
1.080	1.84	6	175N/150W
0.194	3.86	7	Wally III
0.220	0.34	8	Trench II
1.994	1.86	9	"3V" Qtz & Gd
1.726	3.45	9	"3V" Stockwork
5.344	10.14	9	"3V" Massive Py.
2.650	3.65	C1	Pit 1
5.158	4.39	C2	Pit 2
0.750	-	C3	Stockwork 2M Chip
1.364	-	C3	Stockwork Grab
4.290	1.53	C4	C4 Stockwork
1.240	1.53	C4A	C4A
0.489	0.61	C5	C5
3.560	5.5	C6	C6
0.010	0.016	C7	C7 Gd
1.648	1.80	C8	C8
8.800	10.6	NL	NL
0.034	0.05	NLX1	Stockwork Vein
1.410	2.15	NLX2	Stockwork Vein
0.170	0.31	NLX3	Stockwork Vein
0.190	0.21	NLX4	Stockwork Vein
1.470	1.59	NLX5	Stockwork Vein
1.100	1.57	NLX6	Stockwork Vein
0.204	5.12	TY	TY
2.024	-	DF	DF
1.162	-	10	1400N/1460E

From Assessment Report 147736

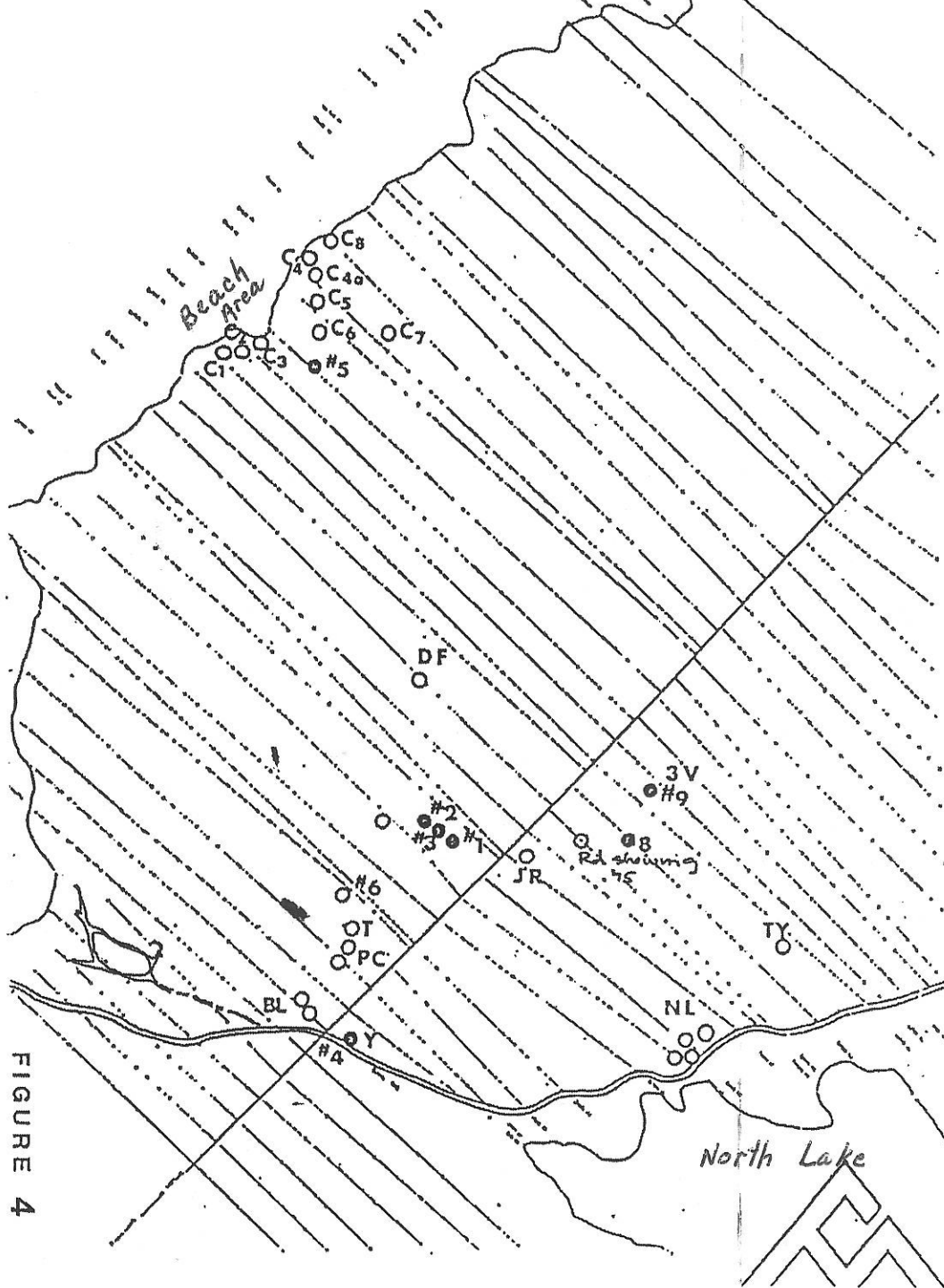

FIGURE 4

See map in pocket for larger scale
TEK

Chalice I Property, Egmont, BC

Scale Apprx 1:12 500

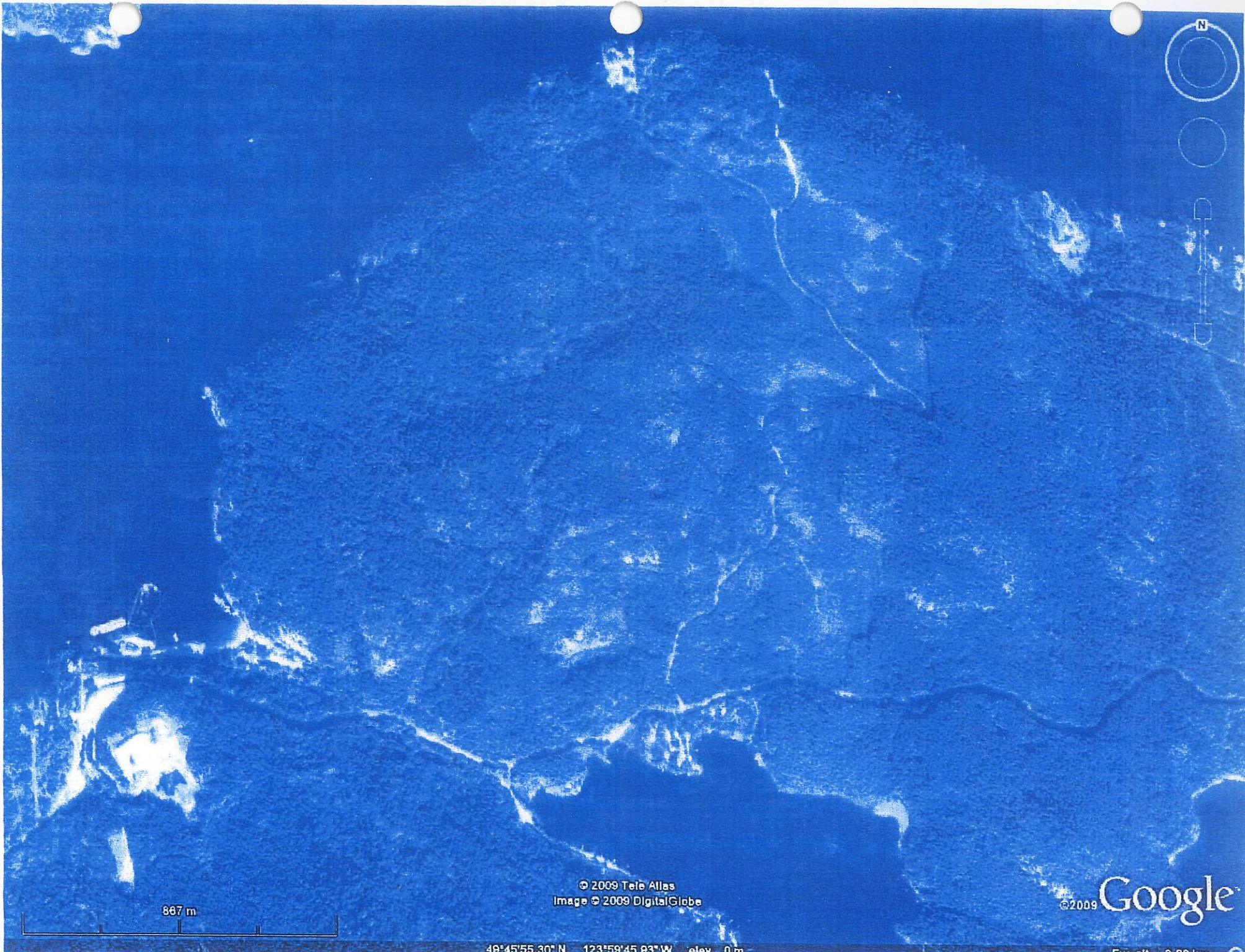

Fig 5

Page 8

867 m

© 2009 Tele Atlas
Image © 2009 DigitalGlobe

© 2009 Google

49°45'55.30" N 123°59'45.83" W elev. 0 m

Eye alt 2.90 km

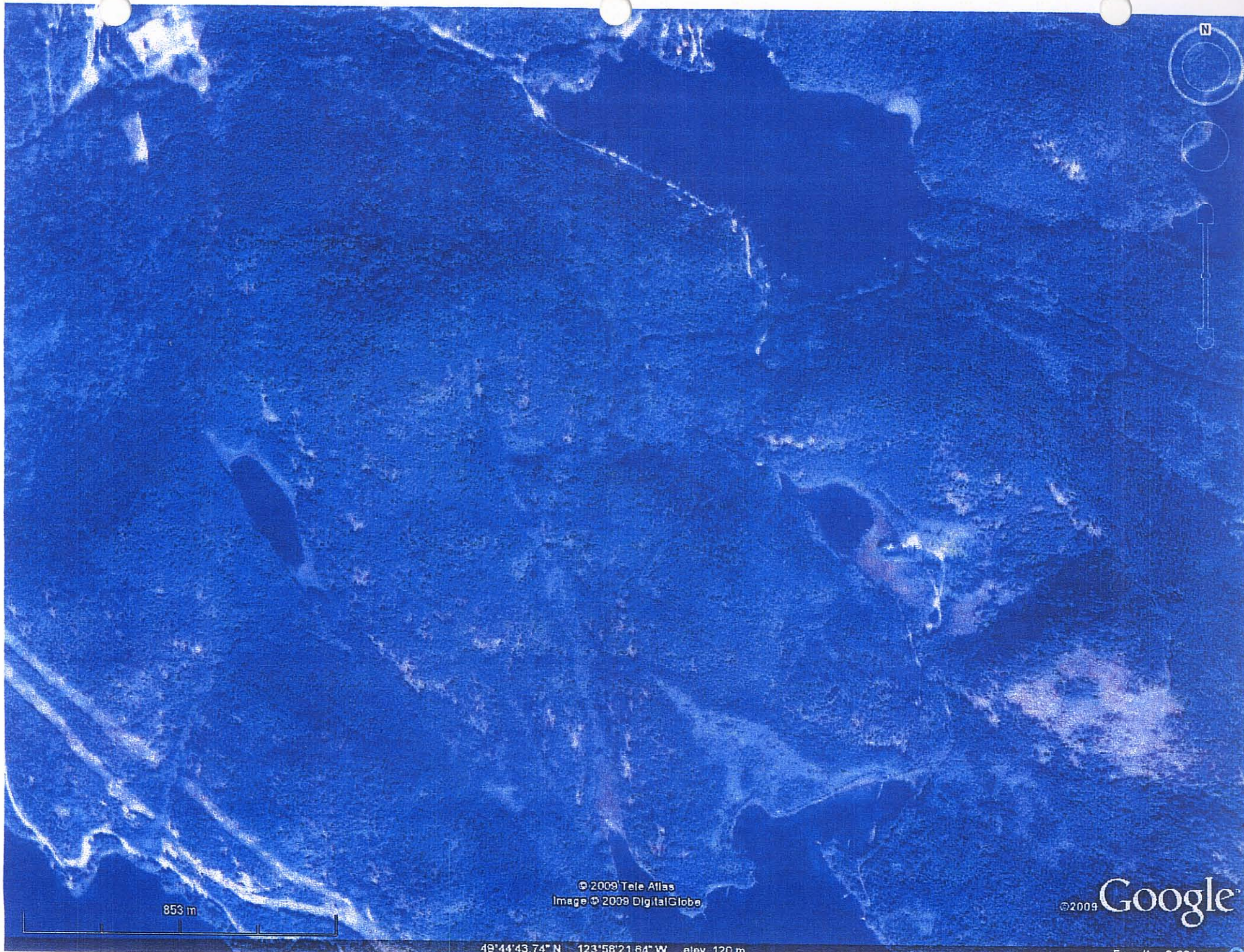

FIG 6

Page 4

© 2009 Tele Atlas
Image © 2009 DigitalGlobe

© 2009 Google

853 m

49°44'43.74" N 123°58'21.64" W elev 120 m

Eye alt 2.90 km

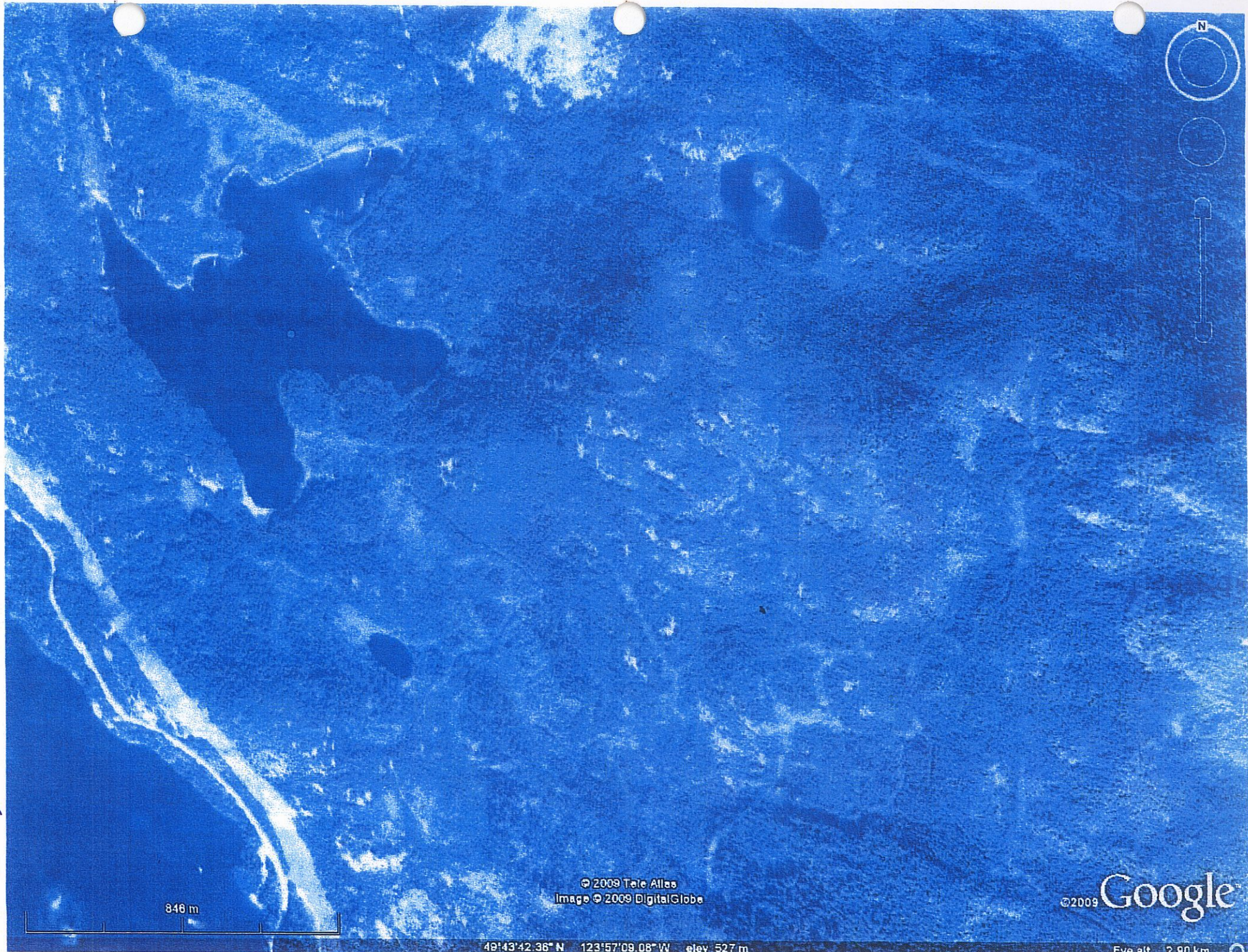

846 m

© 2009 Tele Atlas
Image © 2009 DigitalGlobe

© 2009 Google

49°43'42.36" N 123°57'09.08" W elev 527 m

Eye alt 2.80 km

RESULTS

John LaRue was able to identify some of the showings as indicated on Figure 4 of this report. Most of these were on the Dancer claims. However, he was able to find the DF Showing on the JAY 1 claim. But because of the more recent cultural modifications and recent logging with regrowth, it was difficult in the limited time he had to find most of the showing.

Again, one of the main problems is that much of the rock outcrops are covered by a blanket of moss. That in many places has to be removed in order to see and sample potential mineralized zones. This can be very time consuming. This was a problem also in the area mapped south of Klein Lake.

Of particular interest were the results from the DF Showing. Although the vein is narrow, it did return better than 58 g/ton Au and 79 g/ton Ag. Also of interest was Sample JI-09-009, which was a grab sample across six metres on the Beach Zone, that returned 1.1 g/ton Au.

RECOMMENDATIONS

Since it is so difficult to relocate so many of the old showings, it may be necessary to grid the areas where these old showings may be located and detail and map the areas. This may necessitate new grids as the original grid will be very difficult to reestablish.

CONCLUSIONS

So far, the NL Vin seems to be the best showing in the area. However, more time should be spent on locating the old showings especially in the beach area. Further prospecting should be undertaken in the area where the northeast faults intersect the northwest faults.

STATEMENT OF COSTS

Wages including transportation time:

- D.K. Bragg - May 16 to 26	112 hrs @ \$35/hr	\$ 3,920.00
- Zoran Pudar - May 16 & 17	21 hrs @ \$40/hr	840.00
May 16 & 17	29 hrs @ \$35/hr	1,015.00
Truck Rental	11 days @ \$50/day	550.00
Food	6 man days @ \$70/day	420.00
	9 man days @ \$50/day	450.00
Equipment Rental & Field Supplies - 11 days @ \$15/day		165.00
Cabin Rental	3 days	362.25
Ferry		50.90
John LaRue Truck Rental	2 days @ \$50/day	100.00
Ferry		63.00
General Expenses, gas, printing, maps		150.00
Assays		842.43
Report Preparation		<u>1,000.00</u>
	TOTAL COST	\$ 9,928.58
	FILED FOR ASSESSMENT CREDIT	\$ <u>8,432.55</u>
	EXCESS	\$ <u>1,496.03</u>

ZORAN PUDAR

#119-4371 Mayberry St.
Burnaby, B.C. V5H 4H8
Telephone: 604-430-3429
Fax: 604-685-4675
Email: zpudar@telus.net

I, Zoran Pudar, B. Sc.Geol. Do hereby certify that:

1. I am Vice President of Exploration of:
Golden Reign Resources Ltd.
#501-595 Howe St.
Vancouver, B.C., Canada
V6C 2T5
2. I graduated with a Bachelor of Science degree in Geology from University in Tuzla, Bosnia and Herzegovina, Yugoslavia 1987.
3. I was a member of the Association of Professional Engineers and Geoscientists of former Yugoslavia.
4. I have worked as a geologist for a total of 22 years since my graduation from University. From 1996, I have worked for several Canadian public and private companies involved in mineral property exploration.
5. I visited the property in April and June, 2009, when I examined several mineral showings within the property and collected several samples.
7. I am not responsible for the preparation of all sections of the technical report titled:
8. I have not had prior involvement with the property that is the subject of the Technical Report.
9. I am not aware of any material fact or material change with respect to the subject matter of the Technical Report that is not reflected in the Technical Report, the omission to disclose which makes the Technical Report misleading.
10. I have no direct or indirect interest in the property that is the subject of the Technical Report.
11. I consent to the filing of the Technical Report with any stock exchange and other regulatory authority and any publication by them for regulatory purposes, including electronic publication in a public company files on their websites accessible by the public of the Technical Report.

Dated this 19th day of August, 2009

"Zoran Pudar"
Signature

Zoran Pudar
Print Name

QUALIFICATIONS OF DONALD K. BRAGG

I, Donald K. Bragg, Prospector, state as follows:

- Graduated Armstrong High School, Armstrong, B.C.
- Attended U.B.C. from 1958 to 1962, Faculty of Arts and Science, in Honours Geology.
- Worked in mineral exploration since 1956.
- Worked for Kenco Explorations during the summers of 1956, 1957 and 1959 in the Yukon and Northern B.C. as an assistant prospector, head prospector and geochemical sampler under the direction of Dr. R. Cambell and R. Woodcock.
- Worked as head prospector for the Nahanni Syndicate in the Northwest Territories in 1960 under the direction of Doug Wilmont.
- Worked as head prospector in the Yukon for Dualco in 1961 under the direction of E. Wozniak.
- Worked as head prospector for Mining Corp. of Canada, Southwestern B.C. in 1962 under J.S. Scott and Dr. K. Northcote.
- Worked as head prospector during the summer of 1963 for the Francis River Syndicate in central Yukon under the direction of Dr A. Aho.
- Worked as field geologist in the Greenwood area of B.C. for Scurry Rainbow Oil in 1965 under the direction of Bill Quinn.
- Worked as field supervisor for Alrae Explorations Ltd. from September 1965 to April 1967 under the direction of Rae Jury.
- Since 1956, self-employed contractor hired by various mining companies in the following fields: prospecting, property examination, claim staking, line cutting, topographical mapping, geological mapping, reconnaissance mineral sampling, draughting, air photo interpretation, geochemistry, geophysics, supervising property exploration programs, setting up bush camps, and camp manager.
- Since 1956, self-employed prospector working in various areas in British Columbia and on self-owned properties.

- Assisted in teaching field procedures for Geochemical Explorations Section of the Ministry of Energy, Mines and Petroleum Resources Mineral Exploration Course For Prospectors under the direction of Dr. S. Hoffman in 1984, 1985, 1986, 1987, 1988.
- Received the B.C. Provincial Grubstake Award for the years 1964, 1968, 1969, 1970, 1980, 1981, 1982, 1983, 1984, 1986, 1987, and 1988.
- Worked in the Rossland Camp from 1971 to 1991 as prospector/miner on the Snowdrop and Blue Bird Claims, and mining exploration contractor.
- Worked in the Osilinka and Cut Mountain area with Lysander Mining Corporation during the 2004, 2005, 2006, 2007, 2008 field seasons under the direction of Peter E. Fox, Ph.D., P.Eng., in setting up and managing the camp, prospecting, and mapping the area.

Respectfully submitted,

A handwritten signature in black ink that reads "D. K. Bragg". The signature is written in a cursive style with a large, stylized "B" and "g".

D. K. Bragg

June 21, 2010

Vancouver, B.C.

BIBLIOGRAPHY

- EMPR AR 1913 - 288; 1961 - 80, 90
- EMPR GEM 1970 - 230
- EMPR ASS RPT 2722, 11129, 11333, 11334, 12451, 12641, 14264, 14736, 15577, 17941, 18418
- EMPR BULL 39 p.39
- EMPR PF Tomlinson, F.C. (1969) Report on the R.C. Group of Mineral Claims
- Howell, W.A. (1988) Report on the Egmont Property, in Prospectus (Blue Chip resources Inc.)
- GSC P 80-1F pp 95-101
- GSC Map 42-1963; 1069A; 1386A
- GSC OF 611
- GCNL #197, 1984
#16, #18, #23, #227, 1985
- IPDM February-March 1985
May-June 1985
- Ditson, GM (1978) Metallogeny of the Vancouver-Hope Area, British Columbia, M.Sc. Thesis, University of British Columbia
- EMPR PF Fleming, D.B. (1983) Geological Assessment and Work Proposal - Bacon Claims
- Assessment Report 30611 Prospecting and Physical report on the JI and JI Claims dated July 1, 2008 by D.K. Bragg
- Assessment report on Geophysical Work, Technical Work and First Nations Consultation re the Dancer 1-4 Claims, dated August 18, 2008 by John P. LaRue
- Assessment Report 32010 Prospecting and Sampling Report on the JI and J1-2 Claims dated July 1, 2009 by D.K. Bragg

APPENDIX I

SAMPLE DESCRIPTIONS

and

CERTIFICATES OF ANALYSES

No	Sample No	Showings	Sample Description	Assay Results (Fire Assays)	
				Ag g/t	Au g/t
1	DF 1	DF	Quartz vein, 16cm wide, very rusty, with open boxwork. Visible mineralization, pyrite, about 2%. Representative sample - entire width of the vein.	79	58.69
2	DF 2	DF	Same qtz vein, 5m above the previous sample. Very rusty, wuggy, open boxwork, 16cm wide. Visible pyrite mineralization about 2%	22	11.76
3	DF 3	DF	Sample collected from the footwall of the vein, 20cm wide chip sample. Rusty and altered granodioritic rock with 1% of pyrite mineralization. More alteration close to the vein and greater amount of silica in gd.	13	3.01
4	3V	3V	Float sample from old trenches covered with debris. Granodiorite with qtz-veins (very siliceous rock with a suggestion of silica stockwork). Very rusty with magnesite staining, very mineralized with pyrite/markasite mineralization - 5%. May have tellurides.	7	2.44
5	Trench 2A	Trench 2	Float sample collected from old trench. Quartz vein material with open boxwork, rusty with mn staining, highly mineralized, 25-30% sulphides (py/markasite).	49	48.35
6	Trench 2B	Trench 2	Float sample granodiorite. Very heavy with open boxwork. Sample contains 4cm wide qtz vein, plus qtz stockwork. Sulphide mineralization approx. 3% (py, aspy, cpy?).	10	4.95
7	Trench 2C	Trench 2	Sample of granodiorite with silica influx, plus epidotization, contains 0.5% sulphides (cpy/py and malachite?).	7	1
8	T-zone	T-zone	Quartz vein 8cm wide within granodiorite. Contains py mineralization - 1%	8	0.7
9	JR	JR	Original zone (rusty veining) not found. Zone drilled (9 feet of 0.9oz/t Au). Sample collected from diorite porphyry dyke. Mineralization presented by py and maybe cpy and situated mostly in epidote clots up to 4mm.	<5	0.03

TABLE 1



1020 Cordova St. East Vancouver BC V6A 4A3 Canada
Phone (604) 253-3158 Fax (604) 253-1716

Acme Analytical Laboratories (Vancouver) Ltd.

www.acmelab.com

Client: **Golden Reign Resources**
501 - 595 Howe St.
Vancouver BC V6C 2T5 Canada

Project: Egmont
Report Date: July 10, 2009

Page: 2 of 2 Part 1

CERTIFICATE OF ANALYSIS

VAN09002554 1

Method	WGHT	G6	G6
Analyte	Wgt	Ag	Au
Unit	kg	gm/mt	gm/mt
MDL	0.01	5	0.01
DF-1	Rock	1.94	79 58.69
DF-2	Rock	0.90	22 11.76
DF-3	Rock	1.08	13 3.01
3V	Rock	2.16	7 2.44
TRENCH 2A	Rock	0.38	49 48.35
TRENCH 2B	Rock	3.94	10 4.95
TRENCH 2C	Rock	0.91	7 1.00
T-ZONE	Rock	0.55	8 0.70
JR	Rock	3.32	<5 0.03



1020 Cordova St. East Vancouver BC V6A 4A3 Canada
 Phone (604) 253-3158 Fax (604) 253-1716

Acme Analytical Laboratories (Vancouver) Ltd.

www.acmelab.com

Client: **Golden Reign Resources**
 501 - 595 Howe St.
 Vancouver BC V6C 2T5 Canada

Project: Egmont
 Report Date: July 10, 2009

Page: 1 of 1 Part 1

QUALITY CONTROL REPORT

VAN09002554.1

Method	WGHT	G6	G6	
		Wgt	Ag	Au
Analyte	Unit	kg	gm/mt	gm/mt
MDL		0.01	5	0.01
DF-3	Rock	1.08	13	3.01
Reference Materials				
STD AGPROOF	Standard		91	0.04
STD OXE56	Standard			
STD OXE56	Standard		<5	0.67
STD AGPROOF Expected			100	0
STD OXE56 Expected				0.611
BLK	Blank		<5	<0.01
BLK	Blank		<5	<0.01
BLK	Blank		<5	<0.01
Prep Wash				
G1	Prep Blank	<0.01	<5	<0.01

This report supersedes all previous preliminary and final reports with this file number dated prior to the date on this certificate. Signature indicates final approval; preliminary reports are unsigned and should be used for reference only.

PROJECT	PROJECT	PROJECT
JI 09-001	JI 09-002	JI 09-003
PROJECT <u>JI</u>	PROJECT <u>JI</u>	PROJECT <u>JI</u>
SAMPLER <u>Don Bragg</u>	SAMPLER <u>Don Bragg</u>	SAMPLER <u>Don Bragg</u>
DATE <u>May 21</u>2010	DATE <u>May 21</u>2010	DATE <u>May 21</u>2010
PROPERTY	PROPERTY	PROPERTY
UTM N <u>5507578</u>	UTM N <u>5507725</u>	UTM N <u>5508085</u>
UTM E <u>0431175</u>	UTM E <u>0430945</u>	UTM E <u>0431100</u>
GRID N	GRID N	GRID N
GRID E	GRID E	GRID E
TYPE: Soil Silt <u>Grab</u> Chip Water Pan	TYPE: Soil Silt <u>Grab</u> Chip Water Pan	TYPE: Soil Silt <u>Grab</u> Chip Water Pan
MATERIAL: Till Gravel Silt Sand Talus Organic <u>Bedrock</u> <u>Float</u>	MATERIAL: Till Gravel Silt Sand Talus Organic <u>Bedrock</u> Float	MATERIAL: Till Gravel Silt Sand Talus Organic <u>Bedrock</u> Float
HORIZON: A B C Topsoil Humus Caliche	HORIZON: A B C Topsoil Humus Caliche	HORIZON: A B C Topsoil Humus Caliche
COLOUR: White Black Brown Orange Red Grey Green	COLOUR: White Black Brown Orange Red Grey Green	COLOUR: White Black Brown Orange Red Grey Green
TOPOGRAPHY: Hilltop <u>Hillside</u> Gulley Flat Dry Creek Bog	TOPOGRAPHY: Hilltop <u>Hillside</u> Gulley Flat Dry Creek Bog	TOPOGRAPHY: <u>Hilltop</u> Hillside Gulley Flat Dry Creek Bog
REMARKS: <u>Grab of 12 Rx</u> <u>along rd. Pyrite</u>	REMARKS: <u>Grab across 18</u> <u>metres of a rusty siliceous</u> <u>out crop</u>	REMARKS: <u>Chip sample of</u> <u>mineralized silica</u> <u>Stock work very hard to</u> <u>sample this rock</u>

PROJECT	PROJECT	PROJECT
JI 09-004	JI 09-005	JI 09-006
PROJECT JI	PROJECT JI	PROJECT JI
SAMPLER	SAMPLER	SAMPLER
DATE May 22 2010	DATE May 22 2010	DATE May 23 2010
PROPERTY	PROPERTY	PROPERTY
UTMN... 5508285	UTMN... 5508405	UTMN... 5508081
UTME... 0430943	UTME... 0430392	UTME... 0431103
GRID N.....	GRID N.....	GRID N.....
GRID E.....	GRID E.....	GRID E.....
TYPE: Soil Silt <u>Grab</u> Chip Water Pan	TYPE: Soil Silt <u>Grab</u> Chip Water Pan	TYPE: Soil Silt <u>Grab</u> <u>Chip</u> Water Pan
MATERIAL: Till Gravel Silt Sand Talus Organic <u>Bedrock</u> Float	MATERIAL: Till Gravel Silt Sand Talus Organic <u>Bedrock</u> Float	MATERIAL: Till Gravel Silt Sand Talus Organic <u>Bedrock</u> Float
HORIZON: A B C Topsoil Humus Caliche	HORIZON: A B C Topsoil Humus Caliche	HORIZON: A B C Topsoil Humus Caliche
COLOUR: White Black Brown Orange Red Grey Green	COLOUR: White Black Brown Orange Red Grey Green	COLOUR: White Black Brown Orange Red Grey Green
TOPOGRAPHY: Hilltop <u>Hillside</u> Gulley Flat Dry Creek Bog	TOPOGRAPHY: Hilltop <u>Hillside</u> Gulley Flat Dry Creek Bog	TOPOGRAPHY: Hilltop <u>Hillside</u> Gulley Flat Dry Creek Bog
REMARKS: Grab over 20 metres along the side of the road. Had to clean all the mess off to see the outcrop	REMARKS: Grab across 2 metres of the outcrop	REMARKS: Grab + chip of the bed rock away from the Silica stockwork

J109-007

J109-008

J109-009

PROJECT J1.....

PROJECT J1.....

PROJECT J1.....

SAMPLER Don Bragg
DATE May 24.....2010
PROPERTY

SAMPLER Don Bragg
DATE May 24.....2010
PROPERTY

SAMPLER Don Bragg
DATE May 26.....2010
PROPERTY

UTM N 5507426
UTM E 0431125
GRID N

UTM N 5507731
UTM E 0431098
GRID N

UTM N 5512560
UTM E 0429123
GRID N

TYPE: Soil Silt Grab Chip Water Pan

TYPE: Soil Silt Grab Chip Water Pan

TYPE: Soil Silt Grab Chip Water Pan

MATERIAL: Till Gravel Silt Sand Talus
Organic Bedrock Float

MATERIAL: Till Gravel Silt Sand Talus
Organic Bedrock Float

MATERIAL: Till Gravel Silt Sand Talus
Organic Bedrock Float

HORIZON: A B C Topsoil Humus Caliche

HORIZON: A B C Topsoil Humus Caliche

HORIZON: A B C Topsoil Humus Caliche

COLOUR: White Black Brown Orange Red
Grey Green

COLOUR: White Black Brown Orange Red
Grey Green

COLOUR: White Black Brown Orange Red
Grey Green

TOPOGRAPHY: Hilltop Hillside Gulley
Flat Dry Creek Bog

TOPOGRAPHY: Hilltop Hillside Gulley
Flat Dry Creek Bog

TOPOGRAPHY: Hilltop Hillside Gulley
Flat Dry Creek Bog

REMARKS: A grab across 30 metres of outcrop on the east side of the road. Hail to clean moss off of much of the rock.

REMARKS: Grab across 5 m of lg dark dike rock

REMARKS: Grab across 6 m of silica stock work below the old cabin at high tide level

PROJECT JI JI 09-010
 SAMPLER Don Bragg
 DATE May 24 2010
 PROPERTY
 UTM N 5507682
 UTM E 0431061
 GRID N
 GRID E
 TYPE: Soil (Silt) Grab Chip Water Pan
 + Moss Mat
 MATERIAL: Till (Gravel Silt Sand) Talus
 (Organic) Bedrock Float
 HORIZON: A B C Topsoil Humus Caliche
 COLOUR: White (Black) Brown Orange Red
 (Grey) Green
 TOPOGRAPHY: Hilltop (Hillside) Gulley
 Flat Dry Creek Bog
 REMARKS: Stream 30 cm x 1 cm.
 0.5 m/sec

PROJECT JI JI 09-011
 SAMPLER Don Bragg
 DATE May 24 2010
 PROPERTY
 UTM N 5507752
 UTM E 0431158
 GRID N
 GRID E
 TYPE: Soil (Silt) Grab Chip Water Pan
 + Moss Mat
 MATERIAL: Till (Gravel Silt Sand) Talus
 Organic Bedrock Float
 HORIZON: A B C Topsoil Humus Caliche
 COLOUR: White Black (Brown) Orange Red
 Grey Green
 TOPOGRAPHY: Hilltop (Hillside) Gulley
 Flat Dry Creek Bog
 REMARKS: Stream 4 m x 5 cm
 x 1 m/sec

PROJECT JI JI 09-012
 SAMPLER Don Bragg
 DATE May 24 2010
 PROPERTY
 UTM N 5507820
 UTM E 0431159
 GRID N
 GRID E
 TYPE: Soil Silt Grab Chip Water Pan
 + Moss Mat
 MATERIAL: Till Gravel (Silt Sand) Talus
 Organic Bedrock Float
 HORIZON: A B C Topsoil Humus Caliche
 COLOUR: White (Black Brown) Orange Red
 Grey Green
 TOPOGRAPHY: Hilltop (Hillside) Gulley
 Flat Dry Creek Bog
 REMARKS: Stream 20 cm x 2 cm
 x 1 m/sec

PROJECT	PROJECT	PROJECT
JI 09-013	JI 09-014	JI 09-015
PROJECT <u>JI</u>	PROJECT <u>JI</u>	PROJECT <u>JI</u>
SAMPLER <u>Don Bragg</u>	SAMPLER <u>Don Bragg</u>	SAMPLER <u>Don Bragg</u>
DATE <u>May 24</u> 2010	DATE <u>May 24</u> 2010	DATE <u>May 24</u> 2010
PROPERTY	PROPERTY	PROPERTY
UTM N <u>5507964</u>	UTM N <u>5507989</u>	UTM N <u>5508044</u>
UTM E <u>0431169</u>	UTM E <u>0431151</u>	UTM E <u>0431128</u>
GRID N	GRID N	GRID N
GRID E	GRID E	GRID E
TYPE: Soil Silt Grab Chip Water Pan <u>Moss Mat</u>	TYPE: Soil Silt Grab Chip Water Pan <u>Moss Mat</u>	TYPE: Soil Silt Grab Chip Water Pan <u>Moss Mat</u>
MATERIAL: Till Gravel <u>Silt Sand</u> Talus Organic Bedrock Float	MATERIAL: Till Gravel <u>Silt Sand</u> Talus Organic Bedrock Float	MATERIAL: Till Gravel <u>Silt Sand</u> Talus Organic Bedrock Float
HORIZON: A B C Topsoil Humus Caliche	HORIZON: A B C Topsoil Humus Caliche	HORIZON: A B C Topsoil Humus Caliche
COLOUR: White <u>Black Brown</u> Orange Red Grey Green	COLOUR: White <u>Black Brown</u> Orange Red Grey Green	COLOUR: White <u>Black Brown</u> Orange Red Grey Green
TOPOGRAPHY: Hilltop <u>Hillside</u> Gulley Flat Dry Creek Bog	TOPOGRAPHY: Hilltop <u>Hillside</u> Gulley Flat Dry Creek Bog	TOPOGRAPHY: Hilltop <u>Hillside</u> Gulley Flat Dry Creek Bog
REMARKS: <u>Stream 20 cm x 2 cm</u> <u>x 0.05 m/sec</u>	REMARKS: <u>Stream 20 cm x 5 cm</u> <u>x 0.05 m/sec</u> <u>Stream enters from east over</u> <u>Very rusty rock</u>	REMARKS: <u>Stream 50 cm x 1 cm</u> <u>x 1.5 m/sec</u>

51-09-016

PROJECT J.I.

SAMPLER Don Bragg
DATE May 26 2010
PROPERTY

UTM N 5512671
UTM E 0429136
GRID N

TYPE: Soil Silt Grab Chip Water Pan

MATERIAL: Till Gravel Silt Sand Talus
Organic Bedrock Float

HORIZON: A B C Topsoil Humus Caliche

COLOUR: White Black Brown Orange Red
Grey Green

TOPOGRAPHY: Hilltop Hillside Gulley
Flat Dry Creek Bog

REMARKS: Silt of rusty
Seep east of 51-09-009
at high tide line
Stream 20 cm x 0.05 cm x 0.05
m/sec

51-09-017

PROJECT J.I.

SAMPLER Don Bragg
DATE May 26 2010
PROPERTY

UTM N 5512509
UTM E 0429120
GRID N

TYPE: Soil Silt Grab Chip Water Pan

MATERIAL: Till Gravel Silt Sand Talus
Organic Bedrock Float

HORIZON: A B C Topsoil Humus Caliche

COLOUR: White Black Brown Orange Red
Grey Green

TOPOGRAPHY: Hilltop Hillside Gulley
Flat Dry Creek Bog

REMARKS: Grab + chip across
15 meters of the fault
Slip zone

51-09-018

PROJECT

SAMPLER Don Bragg
DATE May 26 2010
PROPERTY

UTM N

TYPE: Soil Silt Grab Chip Water Pan

MATERIAL: Till Gravel Silt Sand Talus
Organic Bedrock Float

HORIZON: A B C Topsoil Humus Caliche

COLOUR: White Black Brown Orange Red
Grey Green

TOPOGRAPHY: Hilltop Hillside Gulley
Flat Dry Creek Bog

REMARKS: Grab of N.V.

J1-09-019

PROJECT J.I.

SAMPLER

DATE May 26 2010

PROPERTY

UTM N

UTM E

GRID N

GRID E

TYPE: Soil Silt Grab Chip Water Pan

MATERIAL: Till Gravel Silt Sand Talus
Organic Bedrock Float

HORIZON: A B C Topsoil Humus Caliche

COLOUR: White Black Brown Orange Red
Grey Green

TOPOGRAPHY: Hilltop Hillside Gulley
Flat Dry Creek Bog

REMARKS: Grab of Nk Vein
and concentrating the vein
by selecting only the well
mineralized section

PROJECT

SAMPLER

DATE 2010

PROPERTY

UTM N

UTM E

GRID N

GRID E

TYPE: Soil Silt Grab Chip Water Pan

MATERIAL: Till Gravel Silt Sand Talus
Organic Bedrock Float

HORIZON: A B C Topsoil Humus Caliche

COLOUR: White Black Brown Orange Red
Grey Green

TOPOGRAPHY: Hilltop Hillside Gulley
Flat Dry Creek Bog

REMARKS:

PROJECT

SAMPLER

DATE 2010

PROPERTY

UTM N

UTM E

GRID N

GRID E

TYPE: Soil Silt Grab Chip Water Pan

MATERIAL: Till Gravel Silt Sand Talus
Organic Bedrock Float

HORIZON: A B C Topsoil Humus Caliche

COLOUR: White Black Brown Orange Red
Grey Green

TOPOGRAPHY: Hilltop Hillside Gulley
Flat Dry Creek Bog

REMARKS:

SAMPLE DESCRIPTIONS

JI-09-001 0431175, 5507578 - Float

Took samples of 12 rocks found along the road for 12 metres on each side of the GPS position. This was the highest incidence of rusty rocks along the road. May indicate something upslope. All sample are very rusty, 80% of the sample are granitic medium-grained well fractured grading from granite to granodiorite. One that may be an erratic was dark granodiorite with chalcopyrite and bornite. The mineralization is mostly disseminated pyrite but with concentrations of pyrite along fractures. Mineral content grading from .05% to 3%. Thirty percent of the sample is fine-grained greenish, siliceous rocks (dyke?) again well fractured with .05% to 3% sulphide both disseminated and along fractures.

JI-09-002 0430945, 5507725

Grab across 18 m of well fractured very rusty silica outcrop. Very fine-grained pyrite up to 1%. This could have some tonnage potential. There is a lot of manganese stain along fractures. Non-magnetic.

JI-09-003 0431098, 5508085

Sample of high grade mineralized silica stock work veins in camp. Veins very difficult to sample. Width of veins between 3 cm to 10 cm.

Also epidote along with silica stock work.

JI-09-004 0430945, 5508285 - Grab over 20 m

Medium grained diorite (granodiorite) with up to 1% pyrite and (chalcopyrite?). Some of the mineral is quite yellowish. Mineralization is from very fine grained up to clots 2 mm in diameter. Rocks are all very rusty. One piece is of very fine grained silica dyke? with up to 1% fine grained mineralization with clots up to 2 mm.

JI-09-005 0430392, 5508405 - Grab across 2 m
Medium grained diorite with up to 2% sulphides (very rusty rocks) disseminated but with a lot more mineralization along rusty fracture planes.

JI-09-006 0431103, 5508081 - Camp Showing
Grab away from the high silica stock work. Darker diorite with pink feldspar. Mineralization less than .05% but there are some rusty clots up to 1 cm in diameter. Rock has been fractured and healed with silica and epidote.

JI-09-007 0431125, 5507426 - Grab across 30 m
Medium grained granodiorite 40% orthoclase well fractured healed with epidote. In places fractures quite rusty. About 40% of the sample collected has better than 1% sulphides both disseminated and along fractures. The fractures in these rocks are quite rusty. About 60% of the sample has less than .05% sulphides mostly disseminated and are less rusty along fractures. Most of the mineral is pyrite. The GPS position is midway of the sampled sections.

JI-09-009 0429123, 5512560
Grab across 6 m of silica stock work just below the old cabin. 50% of the sample is medium grained granodiorite (10% orthoclase) with less than .05% very fine grained sulphides mostly pyrite.

The rest of the sample is silica-epidote stock work with silica enriched granodiorite that was along the boundaries of the silica-epidote stock work. Sulphide content ranges from weathered boxwork up to approximately 2% sulphides disseminated and with small clots of massive sulphides

JI-09-008 0431098 5507731

*Grab of rusty pods within a very (fine grained dike rock ??)
The sample is very rusty. Sulfide content varies from 1-2 % disseminated to 1 cm clots of 50 % pyrite. In this area there is a lot of float that is very similar. This sample was high-graded. If it runs the whole outcrop needs to be systematically sampled. The rock is quite dense. Non magnetic*

Jl-09-017 **0429120, 5512509** - Beach Zone

Grab chip across 15 m of fault slickensides? Very minimal sulphides can be seen although in places there appears to be remnant boxwork. Considerable manganese can be seen. Much of the sample is silica and fine grained dyke material inter-layered. Some of the sample appears to be silica-enriched granodiorite that may be on the boundary of the silica epidote stock work.

This zone is parallel to the fault and may represent part of the fault slip. The dip is about 75° to the east. The GPS was the centre of the sample area.

BRAGG, DON-X09

Ref/I.D.: ROCKS: JI09-1 - JI09-19
 Report Date: 6 AUG 2009
 GDL Job No: V09-0157R



LAB NO	FIELD NUMBER	Au ppb	Wt Au gram	Au(4) g/t	Au(2) g/t
R0908179	JI09-001	<10	10		
R0908180	JI09-002	<10	10		
R0908181	JI09-003	116	10		
R0908181 rpt		104	10		
R0908182	JI09-004	<10	10		
R0908183	JI09-005	<10	10		
R0908184	JI09-006	<10	10		
R0908185	JI09-007	<10	10		
R0908186	JI09-008	<10	10		
R0908186 rpt		<10	10		
R0908187	JI09-009	1100	10		
R0908188	JI09-017	<10	10		
R0908189	JI09-018	7700	10	6.410	
R0908190	JI09-019	80000	10	145.540	161.200
R0908190 rpt				148.800	
STD: CDN-GS-15A				14.486	

Waiting on certification from Ken Kwok

I=insufficient sample

If requested analyses are not shown, results are to follow

ANALYTICAL METHODS

Au Aqua regia decomposition / solvent extraction / AAS

Wt Au The weight of sample taken to analyse for gold (geochem)

Au(4) Fire Assay-Lead Collection/AA Finish (low level) 1 A.T.

Au(2) Fire Assay-Lead Collection/Gravimetric Finish (high grade) 1 A.T.

ASSIGNED FOR ASSAYS

COMMENTS

There will be no charge for the low level assaying of sample R09:08190 - this sample should have gone straight to a gravimetric method.

BRAGG, DON-X09

Ref/L.D.: ROCKS: J109-1 - J109-19
 Report Date: 17 JULY 2009
 GDL Job No: V09-0157R



LAB NO	FIELD NUMBER	Ag ppm	Al %	As ppm	Ba ppm	Bi ppm	Ca %	Cd ppm	Co ppm	Cr ppm	Cu ppm	Fe %	Ga ppm	Hg ppb	K %	La ppm	Mg %	Mn ppm	Mo ppm	Na %	Ni ppm	P ppm	Pb ppm	S %	Sb ppm	Sc ppm	Se ppm	Sr ppm	Te ppm	Th ppm	Ti %	Ti ppm	U ppm	V ppm	W ppm	Y ppm	Zn ppm
R0908179	J109-001	0.1	1.52	2.4	41.3	0.1	0.85	<.1	10.9	53.9	17.3	3.24	5.3	31	0.09	2.2	1.21	453.5	3.1	0.17	8.7	871.0	2.4	0.44	<.1	2.8	<.5	57.2	0.3	0.9	0.09	<.1	0.2	61.3	0.2	2.8	55.8
R0908180	J109-002	0.1	0.38	5.8	9.9	<.1	0.34	0.3	3.9	61.7	32.7	1.56	2.7	<10	0.02	12.6	0.05	233.9	8.2	0.15	15.7	562.3	33.5	0.30	<.1	2.1	1.4	4.4	<0.05	9.9	0.03	<.1	1.7	32.9	0.2	26.4	50.2
R0908181	J109-003	2.8	1.30	57.6	14.0	1.1	0.46	0.2	146.7	66.7	705.9	8.88	4.4	43	0.04	1.6	0.86	310.7	7.5	0.10	12.2	348.7	4.8	5.15	<.1	2.0	3.3	33.7	1.1	0.8	0.08	<.1	0.3	50.4	0.5	2.3	50.9
R0908182	J109-004	<.1	1.85	3.4	83.4	<.1	1.35	<.1	10.6	40.7	53.0	3.92	7.3	<10	0.32	4.8	1.22	482.6	1.1	0.28	2.1	1656.3	0.8	0.83	<.1	3.8	<.5	171.8	<0.05	0.9	0.12	<.1	0.2	70.5	0.2	8.6	38
R0908183	J109-005	0.1	1.36	3.4	71.0	0.1	0.38	<.1	14.9	69.3	43.6	4.00	5.0	<10	0.38	2.4	1.10	408.3	2.7	0.17	9.6	473.4	2.2	2.24	<.1	9.0	<.5	35.2	0.5	1.3	0.12	<.1	0.4	71.9	0.2	4.6	39.7
R0908184	J109-006	0.1	1.57	2.1	18.6	<.1	0.57	<.1	18.3	55.5	131.1	3.49	5.2	<10	0.08	2.4	1.40	583.7	1.0	0.14	7.5	578.2	1.9	0.12	<.1	4.1	<.5	26.5	<0.05	1.7	0.10	<.1	0.4	63.1	0.2	2.9	51.8
R0908184 rpt		0.1	1.64	2.3	21.0	0.1	0.66	<.1	19.6	62	143.8	3.82	5.9	<10	0.09	2.9	1.54	636.8	1.3	0.15	8.1	625.3	2.1	0.12	<.1	4.5	<.5	32.5	<0.05	1.8	0.11	<.1	0.4	72.3	0.3	3.4	57.1
R0908185	J109-007	<.1	0.92	1.8	35.8	<.1	0.22	<.1	5.1	72.6	12.0	1.96	3.5	<10	0.10	5.3	0.46	327.0	1.9	0.15	1.7	353.4	2.7	0.08	<.1	2.6	<.5	13.9	<0.05	4.1	0.05	<.1	0.7	13.7	0.2	9	26.5
R0908186	J109-008	1	2.03	19.5	35.6	0.5	0.90	<.1	116.2	11.7	406.4	13.58	16.7	46	0.08	4.7	1.23	697.7	6.2	0.17	46.4	1646.3	5.3	4.54	<.1	11.6	3.2	10	0.2	0.8	0.23	<.1	0.2	206.2	0.3	11.2	70.6
R0908187	J109-009	1	1.19	2.3	23.4	1.2	0.72	<.1	9.1	69.4	48.3	2.38	5.4	32	0.22	5.2	0.73	618.7	3.8	0.19	5	740.1	3.0	0.24	<.1	2.2	<.5	20.6	1.8	1.8	0.06	<.1	0.4	41.1	1.9	2.5	57
R0908188	J109-017	<.1	2.28	8.6	42.9	<.1	1.76	<.1	13.7	79	29.9	2.74	7.8	<10	0.12	1.6	1.91	518.6	0.6	0.31	32.3	508.6	3.0	<0.05	<.1	5.1	<.5	73.1	<0.05	0.7	0.11	<.1	0.3	64.3	0.3	3.1	69.6
R0908189	J109-018	6	0.33	<.5	45.1	4.3	0.04	<.1	10.8	107.8	3.4	3.02	<.1	37	0.31	<.1	0.02	17.6	35.4	0.09	3.5	91.5	1.0	3.18	<.1	0.4	<.5	2.2	9.6	0.4	0.00	<.1	0.2	7.9	0.8	0.3	1.5
R0908190	J109-019	57.8	0.04	0.9	2.8	26.6	0.01	<.1	10.7	47.6	6.9	11.39	<.1	447	0.03	<.1	<.01	8.7	4.6	0.08	1.7	10.5	3.7	13.32	<.1	<.1	<.5	<.2	104.5	<.2	0.00	<.1	<.1	2.3	0.2	<.1	3.4

I=insufficient sample

If requested analyses are not shown, results are to follow

ANALYTICAL METHODS

GROUP 1BA ICPMS: 36 element package digested in hot reverse aqua regia.

BRAGG, DON-X09

**GLOBAL
DISCOVERY
LABS**

Ref/I.D.: SILTS: JI09-10 - JI09-16
Report Date: 20 JULY 2009
GDL Job No: V09-0156S

LAB NO	FIELD NUMBER	Au ppb	Wt Au gram
S0900754	JI09-10	<10	10
S0900755	JI09-11	11	10
S0900756	JI09-12	<10	10
S0900757	JI09-13	<10	10
S0900758	JI09-14	<10	10
S0900759	JI09-15	<10	10
S0900760	JI09-16	<10	10
S0900757 rpt		<10	10

l=insufficient sample

If requested analyses are not shown, results are to follow

ANALYTICAL METHODS

Au Aqua regia decomposition / solvent extraction / AAS

Wt Au The weight of sample taken to analyse for gold (geochem)

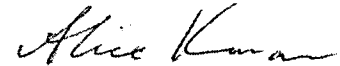

Alice Kwan, Chemist-Teck Cominco G.D.L.

Teck Resources Ltd.

Global Discovery Labs 1486 East Pender Street Vancouver, B.C. Canada V5L 1V8 Phone: (604) 699-4380 Fax: (604) 699-4735

BRAGG, DON-X09



Refl.D.: SILTS: JI09-10 - JI09-16
 Report Date: 17 JULY 2009
 GDL Job No: V09-0156S

LAB NO	FIELD NUMBER	Ag ppm	Al %	As ppm	Ba ppm	Bi ppm	Ca %	Cd ppm	Co ppm	Cr ppm	Cu ppm	Fe %	Ga ppm	Hg ppb	K %	La ppm	Mg %	Mn ppm	Mo ppm	Na %	Ni ppm	P ppm	Pb ppm	S %	Sb ppm	Sc ppm	Se ppm	Sr ppm	Te ppm	Th ppm	Ti %	Tl ppm	U ppm	V ppm	W ppm	Y ppm	Zn ppm
S0900754	JI09-10	0.3	1.52	23.4	68	0.1	1.28	3.5	16.4	15.9	68	2.20	5.1	81	0.06	20.1	0.39	1189.3	4.8	0.11	10.3	652.9	7.8	0.10	0.6	4.9	2.8	28.2	<0.05	1.0	0.05	<1	6.3	55.3	0.4	41.1	56.3
S0900755	JI09-11	0.1	2.20	18.1	77	0.1	0.78	0.3	16.4	22.3	70	3.56	6.5	46	0.13	5.9	0.85	829.9	2.7	0.12	15.2	768.4	5.0	<0.05	<1	5.5	<.5	29	0.1	1.8	0.08	<1	1.5	73.7	0.2	10.3	53.4
S0900756	JI09-12	0.1	1.76	5	102	<1	0.83	0.4	13.1	15.7	33	2.18	4.1	72	0.08	7.5	0.59	1092	1.7	0.11	11.4	781.5	6.2	0.10	0.1	2.8	<.5	48.7	<0.05	0.7	0.03	<1	1.3	36.9	0.2	7.8	88.9
S0900757	JI09-13	0.1	1.88	7.8	89	0.1	0.88	0.2	9.2	15.5	40	1.91	4.7	75	0.09	11.1	0.40	707.5	2.1	0.12	9.8	829.5	7.8	0.09	0.2	2.7	<.5	34.3	<0.05	1.1	0.04	<1	2.0	40.9	0.4	9.9	39.4
S0900757 rpt		0.1	1.88	8.1	89	0.1	0.87	0.2	9.5	17.8	39	2.14	4.9	77	0.10	11.7	0.41	721.3	2.2	0.11	10.1	845.7	7.6	0.09	0.2	2.8	0.6	35.4	<0.05	1.5	0.05	<1	2.0	45.5	0.4	10.3	41
S0900758	JI09-14	0.1	1.48	6.6	88	<1	0.72	0.2	14.4	10.6	26	2.49	4.8	71	0.06	8.5	0.23	1651.3	6.3	0.10	6.6	479.1	6.2	0.09	0.2	1.6	<.5	32.8	<0.05	0.9	0.06	<1	1.6	43.9	0.4	5.5	29.4
S0900759	JI09-15	0.2	1.75	7.2	79	0.1	0.95	0.2	17.7	10.8	39	1.89	3.8	97	0.08	13.0	0.26	1473.5	3.7	0.12	7.3	730.6	7.2	0.11	0.2	2.0	0.8	43	<0.05	0.8	0.04	<1	2.5	35.6	0.6	8.7	27.5
S0900760	JI09-16	<1	1.03	43.3	33	<1	0.25	0.1	28.7	5.5	8	21.48	1.2	58	0.03	5.9	0.11	2952.5	20.2	0.12	3	724.3	8.3	0.10	1.1	0.7	0.7	56	0.3	0.7	0.01	<1	7.4	53.5	1.0	5.6	18.4
STD: MS2		0.2	1.74	18.6	88	4.9	0.12	0.3	12.6	32.6	134	3.39	7.5	62	0.33	22.0	0.64	617.7	12.8	0.11	28.4	563.3	21.3	<0.05	0.2	4.9	<.5	11.2	<0.05	10.0	0.07	0.2	2.7	40.3	1.2	9.6	102.2

l=insufficient sample
 If requested analyses are not shown, results are to follow

ANALYTICAL METHODS
 GROUP 1BA ICPMS: 36 element package digested in hot reverse aqua regia.

LEGEND

Paved Road

Gravel or logging road

Trail or unused road

Stream

Intermittant stream or gully

Rock outcrop

Silt sample site ● JI 08 001

Soil sample site ○ JI 08 010

Rock sample site ⊗ JI 08 021

Fault (defined, approximate, assumed)

TOPOGRAPHY & GEOLOGY
J1 & J1 1 CLAIMS
NORTHERN SECHLT PENINSULA
092 G 071

To accompany 'PROSPECTING & PHYSICAL WORK on the J1 & J1 1 Claims by D.K. Bragg, Dated July 2, 2008'

SCALE: 1 - 5000 DATE: Jul 4, 2008
 DRAWN BY: D.K. Bragg FIG: 3

Revised June 10 2010

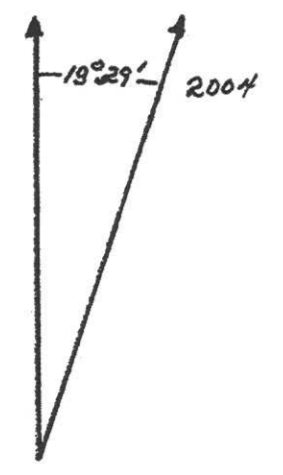

GEOLOGICAL SURVEY OF CANADA
 ASSESSMENT REPORT
 31,885

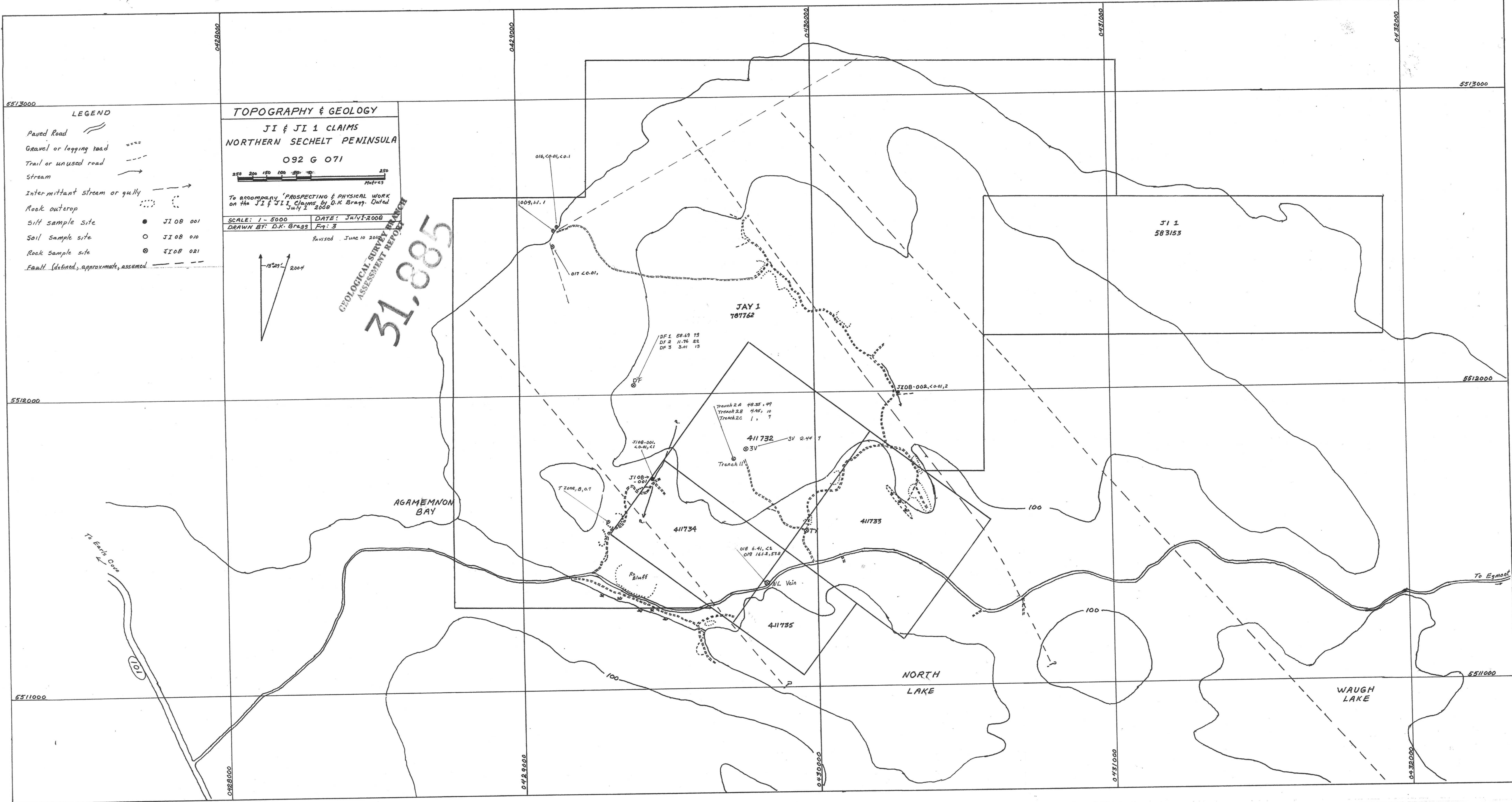

5509000

5508000

TOPOGRAPHY & GEOLOGY

J1 & JAY CLAIMS
NORTHERN SECHELT PENINSULA

092 G 071

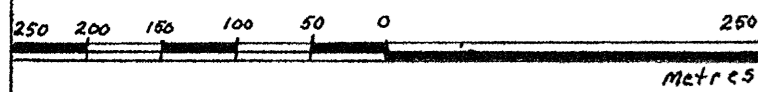

To accompany TOPOGRAPHY & GEOLOGY REPORT
on the J1 & JAY Claims by D.K Bragg
Dated June 21 2010

SCALE: 1 - 5000 DATE: June 21 2010
DRAWN BY: D.K. Bragg FIG: 8

5507000

LEGEND

- Gravel Road
- Decommissioned Road, Logging Rd Trail
- Road not mapped in detail
- Stream
- Intermittent Stream or gully
- Rock outcrop
- Silt sample site J1 004
- Soil sample site 005
- Rock sample site 006

Sample No	Au gm/mt	Ag gm/mt
10	0.56	0.27

1	Granite, Granodiorite, Diorite
2	Dike Rocks
3	Silica rich intrusives or Dikes

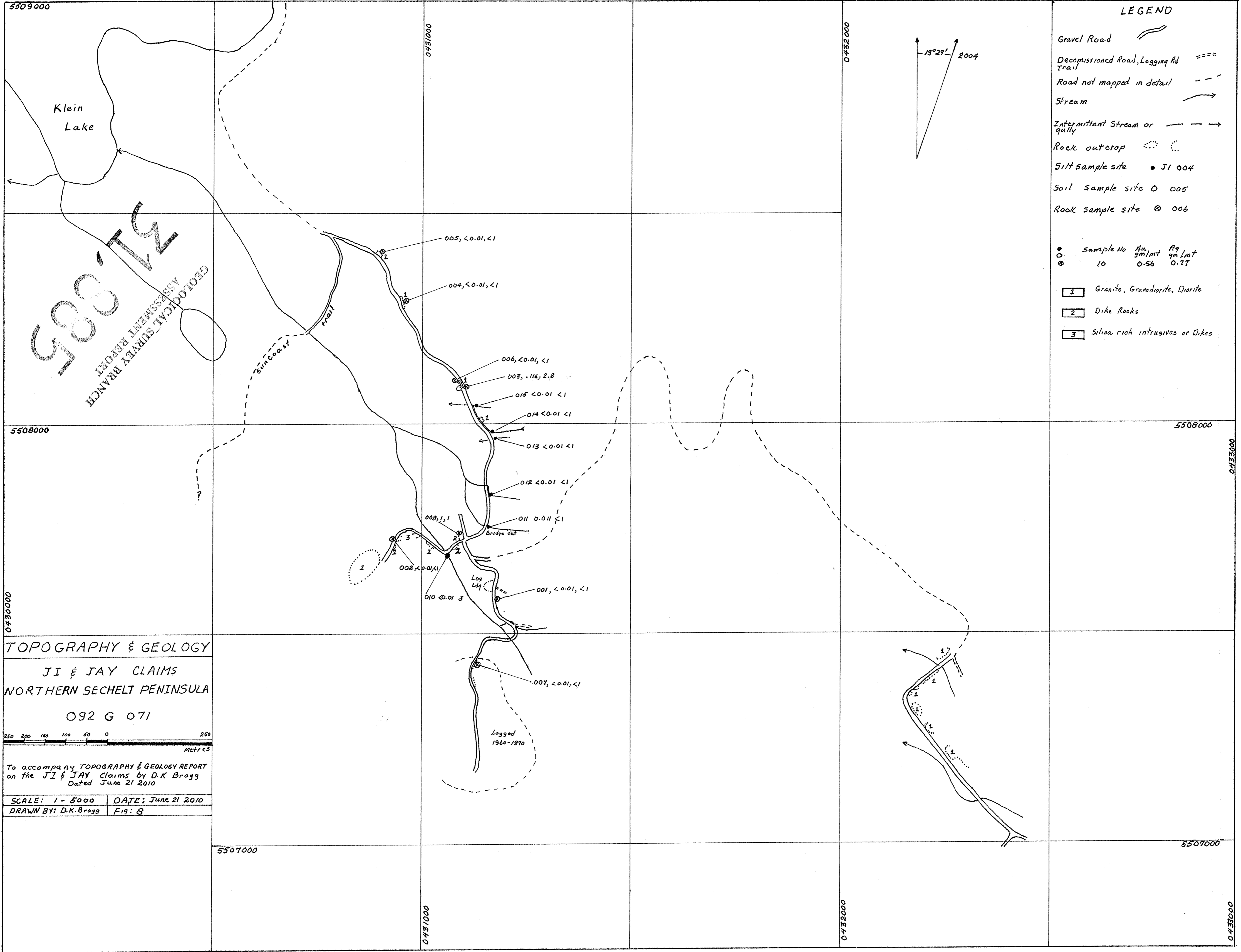
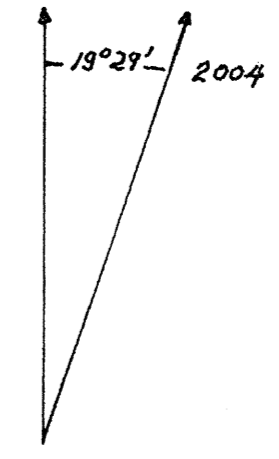

5508000
31, 895
GEOLOGICAL SURVEY BRANCH
ASSESSMENT REPORT

5508000

0433000

5507000

0432000