



Statement of Exploration and Development

2011

Jade Fever 4 Claim

Liard Mining Division Mapsheet 104J080

58° 45' 40" N
130° 03' 30" W

For
Donald Bunce
21670 Chief Lake Road
Prince George, B.C.
V2K - 5K5

BC Geological Survey
Assessment Report
32861

By
Donald Bunce
21670 Chief Lake Road
Prince George, B.C.
V2K - 5K5

operator
Donald Bunce

Date Submitted

Dec. 17 2011

GEOLOGICAL SURVEY BRANCH
ASSESSMENT REPORT

32,861

Statement of Exploration and Development

Table of Contents

Index	2
2011 Exploration Program	3
Objective and Results	3
Property Description	3
Access to work site	4
Assay Results	5
Statement of costs	21
Author's Qualifications	22
Map # 1 of British Columbia	23
Map # 2 showing the nearest Town	24
Map # 3 showing access to work sites	25
Map # 4 showing work sites relative to claim boundaries	26
Pictures of Exploration Trail	27

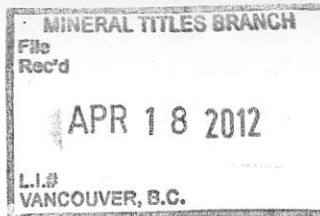

Ministry of Energy, Mines & Petroleum Resources
Mining & Minerals Division
BC Geological Survey

Assessment Report
Title Page and Summary

TYPE OF REPORT [type of survey(s)]:

Related Technical (Sampling/assaying)

TOTAL COST: \$ 8870.95

AUTHOR(S): Donald Bunce

SIGNATURE(S): [Signature]

NOTICE OF WORK PERMIT NUMBER(S)/DATE(S): MX-1-817-2010/Jan/11 to 2013/Nov/30 YEAR OF WORK: 2011

STATEMENT OF WORK - CASH PAYMENTS EVENT NUMBER(S)/DATE(S): #5079453 - 2011/oct/17

PROPERTY NAME: Jade Fever

CLAIM NAME(S) (on which the work was done):

Jade Fever #4 Tenure #666783

COMMODITIES SOUGHT: Jade (Nephrite)

MINERAL INVENTORY MINFILE NUMBER(S), IF KNOWN:

MINING DIVISION: Liard

NTS/BCGS: 104J080

LATITUDE: 58° 45' 40" LONGITUDE: 130° 03' 30" (at centre of work)

OWNER(S):

1) Donald Bunce

2)

MAILING ADDRESS:

21670 Chief Lake Rd.
Prince George, B.C., V2K-5K5

OPERATOR(S) [who paid for the work]:

1) Donald Bunce

2)

MAILING ADDRESS:

21670 Chief Lake Rd.
Prince George, B.C., V2K-5K5

PROPERTY GEOLOGY KEYWORDS (lithology, age, stratigraphy, structure, alteration, mineralization, size and attitude):

Triassic, Intrusive, Ultramafics, Nephrite

REFERENCES TO PREVIOUS ASSESSMENT WORK AND ASSESSMENT REPORT NUMBERS:

TYPE OF WORK IN THIS REPORT	EXTENT OF WORK (IN METRIC UNITS)	ON WHICH CLAIMS	PROJECT COSTS APPORTIONED (incl. support)
GEOLOGICAL (scale, area)			
Ground, mapping			
Photo interpretation			
GEOPHYSICAL (fina-kilometres)			
Ground			
Magnetic			
Electromagnetic			
Induced Polarization			
Radiometric			
Seismic			
Other			
Airborne			
GEOCHEMICAL			
(number of samples analysed for ...)			
Soil			
Sill			
Rock			
Other			
DRILLING			
(total metres; number of holes, size)			
Core			
Non-core			
RELATED TECHNICAL			
Sampling/assaying	10 samples in 16.2 m of trenches	Jade Fever 4 Tenure # 666783	\$481.04
Petrographic			
Mineralographic			
Metallurgic			
PROSPECTING (scale, area)			
PREPARATORY/PHYSICAL			
Line/grid (kilometres)			
Topographic/Photogrammetric (scale, area)			
Legal surveys (scale, area)			
Road, local access (kilometres)/trail	1.14 km	Tenure # 666783	\$6911.42
Trench (metres)			
Underground dev. (metres)			
Other	Transportation 20%		\$1478.49
TOTAL COST			\$8870.95

Statement of Exploration and Development

2011 Exploration Program

During the period of Aug. 12, 2011 to Sept. 23, 2011, a rock sampling / assaying of five trenches, and the construction of the exploration trail was under taken on the Jade Fever 4 claim.

Objective and Results

The objective of the trenching program was to determine where the contact zone between the Intrusive (serpentinite) rocks and the Met Sedimentary (chert) rocks, looking for in-situ deposits of nephrite jade.

Results indicate that: In trench, TR01/11 it is on the edge of a Intrusive rock outcrop. There were two rock samples taken #01A2 and #01B2.

In trench, TR02/11 is in MetaSedimentary rocks. There were two rock samples taken #02A1 and #02B1.

In trench, TR03/11 is in MetaSedimentary rocks. There were two rock samples taken #03A1 and #03B1.

In trench, TR04/11 is in MetaSedimentary rocks. There were two rock samples taken #04A1 and #04B1.

In trench, TR05/11 is in MetaSedimentary rocks. There were two rock samples taken #05A1 and #05B1.

There was one sample #01B2 in trench #TR01/11. It had high readings of Ni - 2476 ppm and Cr - 1174 ppm.

Recommendations

Next summer we intend to do more exploration work in the area around TR01/11. We also intend to do more exploration work in the area north east of TR05/11.

Property Description and Access

Area is situated on the divide between the Omineca Belt to the north east, and the Intermontane Belt to the south west. Rocks of the Cache Creek Complex (Mississippian to Triassic age) are on both sides of the divide. There are Intrusive rock formations scattered through out the immediate area, on both sides of the divide between the Omineca belt and the Intermontane belt. The age of the Intrusive rocks are unknown.

Statement of Exploration and Development

Access to Work Site

Access to the site is via Highway 37 at km. 528.5, which is 1 km. south of the Sawmill Point camp grounds on the north east side of Diese Lake.

Assay Results

There were 10 samples taken, they are #01A2, #01B2, #02A1, #02B1, #03A1, #03B1, #04A1, #04B1, #05A1, and #05B1.

The results are found on pages 5 through 18.



Acme Analytical Laboratories (Vancouver) Ltd.
1020 Cordova St. East Vancouver BC V6A 4A3 Canada

www.acmelab.com

Client: **Donald Bunce**
21670 Chief Lake Rd.
Prince George BC V2K 5K5 Canada

Submitted By: Donald Bunce
Receiving Lab: Canada-Smithers
Received: September 05, 2011
Report Date: November 07, 2011
Page: 1 of 2

CERTIFICATE OF ANALYSIS

SMI11000413.1

CLIENT JOB INFORMATION

Project: Jade Fever
Shipment ID:
P.O. Number
Number of Samples: 2

SAMPLE PREPARATION AND ANALYTICAL PROCEDURES

Method Code	Number of Samples	Code Description	Test Wgt (g)	Report Status	Lab
R200-250	2	Crush, split and pulverize 250 g rock to 200 mesh			SMI
1F05	2	1:1:1 Aqua Regia digestion Ultratrace ICP-MS analysis	15	Completed	VAN

SAMPLE DISPOSAL

DISP-PLP Dispose of Pulp After 90 days
DISP-RJT Dispose of Reject After 90 days

ADDITIONAL COMMENTS

Acme does not accept responsibility for samples left at the laboratory after 90 days without prior written instructions for sample storage or return.

Invoice To: Donald Bunce
21670 Chief Lake Rd.
Prince George BC V2K 5K5
Canada

CC:



This report supersedes all previous preliminary and final reports with this file number dated prior to the date on this certificate. Signature indicates final approval; preliminary reports are unsigned and should be used for reference only. All results are considered the confidential property of the client. Acme assumes the liabilities for actual cost of analysis only. Results apply to samples as submitted. *** asterisk indicates that an analytical result could not be provided due to unusually high levels of interference from other elements.



AcmeLabs

Acme Analytical Laboratories (Vancouver) Ltd.

1020 Cordova St. East Vancouver BC V6A 4A3 Canada

Phone (604) 253-3158 Fax (604) 253-1716

www.acmelab.com

Client: Donald Bunce
21670 Chief Lake Rd.
Prince George BC V2K 5K5 Canada

Project: Jade Fever
Report Date: November 07, 2011

Page: 2 of 2 **Part** 1

CERTIFICATE OF ANALYSIS

SMI11000413.1

Method	WGHT	1F15	1F15	1F15	1F15	1F15	1F15	1F15	1F15	1F15	1F15	1F15	1F15	1F15	1F15	1F15	1F15	1F15	1F15	1F15	
Analyte	Wgt	Mo	Cu	Pb	Zn	Ag	Ni	Co	Mn	Fe	As	U	Au	Th	Sr	Cd	Sb	Bi	V	Ca	
Unit	kg	ppm	ppm	ppm	ppm	ppb	ppm	ppm	ppm	%	ppm	ppm	ppb	ppm	ppm	ppm	ppm	ppm	ppm	%	
MDL	0.01	0.01	0.01	0.01	0.1	2	0.1	0.1	1	0.01	0.1	0.1	0.2	0.1	0.5	0.01	0.02	0.02	2	0.01	
01A2	Rock	0.29	0.09	2.69	12.78	55.0	10	99.8	14.5	1027	3.08	<0.1	0.2	<0.2	6.0	41.9	0.11	<0.02	0.05	90	1.81
01B2	Rock	0.29	0.35	12.47	0.09	25.6	9	2476	99.6	756	4.18	1.0	0.4	0.9	<0.1	1.2	0.08	0.07	<0.02	28	0.02

This report supersedes all previous preliminary and final reports with this file number dated prior to the date on this certificate. Signature indicates final approval; preliminary reports are unsigned and should be used for reference only.



AcmeLabs

Acme Analytical Laboratories (Vancouver) Ltd.

1020 Cordova St. East Vancouver BC V6A 4A3 Canada

Phone (604) 253-3158 Fax (604) 253-1716

www.acmelab.com

Client: Donald Bunce
21670 Chief Lake Rd.
Prince George BC V2K 5K5 Canada

Project: Jade Fever
Report Date: November 07, 2011

Page: 2 of 2 Part 2

CERTIFICATE OF ANALYSIS

SMI11000413.1

Method	1F15	1F15	1F15	1F15	1F15	1F15	1F15	1F15	1F15	1F15	1F15	1F15	1F15	1F15	1F15	1F15	1F15	1F15	1F15	1F15	
Analyte	P	La	Cr	Mg	Ba	Tl	B	Al	Na	K	W	Sc	Tl	S	Hg	Se	Te	Ga	Cs	Ge	
Unit	%	ppm	ppm	%	ppm	%	ppm	%	%	%	ppm	ppm	ppm	%	ppb	ppm	ppm	ppm	ppm	ppm	
MDL	0.001	0.5	0.5	0.01	0.5	0.001	1	0.01	0.001	0.01	0.1	0.1	0.02	0.02	5	0.1	0.02	0.1	0.02	0.1	
01A2	Rock	0.032	15.5	94.0	4.04	321.6	0.210	1	2.78	<0.001	0.09	<0.1	9.2	<0.02	<0.02	57	0.2	<0.02	7.0	0.09	<0.1
01B2	Rock	<0.001	<0.5	1174	18.22	23.8	0.004	75	0.54	<0.001	<0.01	0.2	6.9	<0.02	<0.02	<5	<0.1	0.02	1.0	<0.02	<0.1

This report supersedes all previous preliminary and final reports with this file number dated prior to the date on this certificate. Signature indicates final approval; preliminary reports are unsigned and should be used for reference only.



Acme Analytical Laboratories (Vancouver) Ltd.
 1020 Cordova St. East Vancouver BC V6A 4A3 Canada
 Phone (604) 253-3158 Fax (604) 253-1716

www.acmelab.com

Client: **Donald Bunce**
 21670 Chief Lake Rd.
 Prince George BC V2K 5K5 Canada

Project: **Jade Fever**
 Report Date: **November 07, 2011**

Page: 2 of 2 Part 3

CERTIFICATE OF ANALYSIS

SMI11000413.1

Method	1F15	1F15	1F15	1F15	1F15	1F15	1F15	1F15	1F15	1F15	1F15	1F15	1F15	1F15	
Analyte	Hf	Nb	Rb	Sn	Ta	Zr	Y	Ce	In	Re	Be	Li	Pd	Pt	
Unit	ppm	ppm	ppm	ppm	ppm	ppm	ppm	ppm	ppm	ppb	ppm	ppm	ppb	ppb	
MDL	0.02	0.02	0.1	0.1	0.05	0.1	0.01	0.1	0.02	1	0.1	0.1	10	2	
01A2	Rock	0.16	0.13	1.4	1.0	<0.05	2.8	10.51	37.9	<0.02	<1	<0.1	59.7	<10	<2
01B2	Rock	<0.02	<0.02	0.2	<0.1	<0.05	0.1	0.65	1.6	<0.02	<1	<0.1	1.3	<10	5

This report supersedes all previous preliminary and final reports with this file number dated prior to the date on this certificate. Signature indicates final approval; preliminary reports are unsigned and should be used for reference only.



Acme Labs

Acme Analytical Laboratories (Vancouver) Ltd.

1020 Cordova St. East Vancouver BC V6A 4A3 Canada
Phone (604) 253-3158 Fax (604) 253-1716

www.acmelab.com

Client: Donald Bunce
21670 Chief Lake Rd.
Prince George BC V2K 5K5 Canada

Project: Jade Fever
Report Date: November 07, 2011

Page: 1 of 1 **Part** 1

QUALITY CONTROL REPORT

SMI11000413.1

Method	WGHT	1F15	1F15	1F15	1F15	1F15	1F15	1F15	1F15	1F15	1F15	1F15	1F15	1F15	1F15	1F15	1F15	1F15	1F15	1F15	1F15
Analyte	Wgt	Mo	Cu	Pb	Zn	Ag	Ni	Co	Mn	Fe	As	U	Au	Th	Sr	Cd	Sb	Bi	V	Ca	
Unit	kg	ppm	ppm	ppm	ppm	ppb	ppm	ppm	ppm	%	ppm	ppm	ppb	ppm	ppm	ppm	ppm	ppm	ppm	%	
MDL	0.01	0.01	0.01	0.01	0.1	2	0.1	0.1	1	0.01	0.1	0.1	0.2	0.1	0.5	0.01	0.02	0.02	2	0.01	
Pulp Duplicates																					
REP G1	QC	0.16	3.85	2.77	47.1	7	3.5	4.3	544	2.01	0.2	1.5	0.5	5.3	60.0	0.02	0.06	0.04	37	0.48	
Reference Materials																					
STD DS8	Standard	12.96	108.5	116.2	321.9	1732	41.7	7.5	621	2.51	26.6	2.6	99.1	6.4	65.7	2.64	5.10	6.01	41	0.72	
STD DS8 Expected		13.44	110	123	312	1690	38.1	7.5	615	2.46	26	2.8	107	6.89	67.7	2.38	5.7	6.67	41.1	0.7	
BLK	Blank	<0.01	<0.01	<0.01	<0.1	<2	<0.1	<0.1	<1	<0.01	<0.1	<0.1	<0.2	<0.1	<0.5	<0.01	<0.02	<0.02	<2	<0.01	
Prep Wash																					
G1	Prep Blank																				
G1	Prep Blank	0.12	3.57	2.53	44.5	7	3.4	3.9	517	1.91	<0.1	1.3	0.5	4.8	51.3	0.01	0.05	0.05	34	0.41	

This report supersedes all previous preliminary and final reports with this file number dated prior to the date on this certificate. Signature indicates final approval; preliminary reports are unsigned and should be used for reference only.



Acme Labs

Acme Analytical Laboratories (Vancouver) Ltd.

1020 Cordova St. East Vancouver BC V6A 4A3 Canada
Phone (604) 253-3158 Fax (604) 253-1716

www.acmelab.com

Client: **Donald Bunce**
21670 Chief Lake Rd.
Prince George BC V2K 5K5 Canada

Project: **Jade Fever**
Report Date: **November 07, 2011**

Page: 1 of 1 Part 2

QUALITY CONTROL REPORT

SMI11000413.1

Method	Analyte	Unit	MDL	1F15 P	1F15 La	1F15 Cr	1F15 Mg	1F15 Ba	1F15 Ti	1F15 B	1F15 Al	1F15 Na	1F15 K	1F15 W	1F15 Sc	1F15 Ti	1F15 S	1F15 Hg	1F15 Se	1F15 Te	1F15 Ga	1F15 Cs	1F15 Ge
Pulp Duplicates																							
REP G1	QC			0.075	12.5	6.0	0.57	221.5	0.119	<1	0.96	0.081	0.49	<0.1	2.1	0.28	<0.02	<5	<0.1	<0.02	5.1	2.75	0.1
Reference Materials																							
STD DS8	Standard			0.085	14.3	121.0	0.59	280.2	0.109	2	0.91	0.086	0.43	3.1	2.2	5.30	0.17	213	5.6	5.26	5.0	2.61	<0.1
STD DS8 Expected				0.08	14.6	115	0.6045	279	0.113	2.6	0.93	0.0883	0.41	3	2.3	5.4	0.1679	192	5.23	5	4.7	2.48	0.13
BLK	Blank			<0.001	<0.5	<0.5	<0.01	<0.5	<0.001	<1	<0.01	<0.001	<0.01	<0.1	<0.1	<0.02	<0.02	<5	<0.1	<0.02	<0.1	<0.02	<0.1
Prep Wash																							
G1	Prep Blank																						
G1	Prep Blank			0.068	11.0	5.5	0.54	205.4	0.100	<1	0.88	0.072	0.47	<0.1	1.7	0.26	<0.02	<5	<0.1	<0.02	4.6	2.62	<0.1

This report supersedes all previous preliminary and final reports with this file number dated prior to the date on this certificate. Signature indicates final approval; preliminary reports are unsigned and should be used for reference only.



Acme Analytical Laboratories (Vancouver) Ltd.
 1020 Cordova St. East Vancouver BC V6A 4A3 Canada
 Phone (604) 253-3158 Fax (604) 253-1716

www.acmelab.com

Client: **Donald Bunce**
 21670 Chief Lake Rd.
 Prince George BC V2K 5K5 Canada

Project: **Jade Fever**
 Report Date: **November 07, 2011**

Page: 1 of 1 Part 3

QUALITY CONTROL REPORT

SMI11000413.1

Method	1F15	1F15	1F15	1F15	1F15	1F15	1F15	1F15	1F15	1F15	1F15	1F15	1F15	1F15	
Analyte	Hf	Nb	Rb	Sn	Ta	Zr	Y	Ce	In	Re	Be	Li	Pd	Pt	
Unit	ppm	ppm	ppm	ppm	ppm	ppm	ppm	ppm	ppm	ppb	ppm	ppm	ppb	ppb	
MDL	0.02	0.02	0.1	0.1	0.05	0.1	0.01	0.1	0.02	1	0.1	0.1	10	2	
Pulp Duplicates															
REP G1	QC	0.08	0.40	41.2	0.5	<0.05	1.4	5.24	24.8	<0.02	<1	0.4	30.3	<10	<2
Reference Materials															
STD DS8	Standard	0.08	1.28	39.8	6.9	<0.05	2.1	6.05	28.8	2.38	53	5.4	27.8	93	345
STD DS8 Expected		0.08	1.65	39	6.7	0.003	2.3	6.1	29.8	2.19	55	5.2	26.34	110	339
BLK	Blank	<0.02	<0.02	<0.1	<0.1	<0.05	<0.1	<0.01	<0.1	<0.02	<1	<0.1	<0.1	<10	<2
Prep Wash															
G1	Prep Blank														
G1	Prep Blank	0.08	0.34	37.8	0.4	<0.05	1.0	4.17	20.7	<0.02	1	0.4	28.2	<10	<2

This report supersedes all previous preliminary and final reports with this file number dated prior to the date on this certificate. Signature indicates final approval; preliminary reports are unsigned and should be used for reference only.



Acme Analytical Laboratories (Vancouver) Ltd.
1020 Cordova St. East Vancouver BC V6A 4A3 Canada

www.acmelab.com

Client: **Donald Bunce**
21670 Chief Lake Rd.
Prince George BC V2K 5K5 Canada

Submitted By: Donald Bunce
Receiving Lab: Canada-Smithers
Received: October 04, 2011
Report Date: November 15, 2011
Page: 1 of 2

CERTIFICATE OF ANALYSIS

SMI11000543.1

CLIENT JOB INFORMATION

Project: Jade Fever
Shipment ID:
P.O. Number
Number of Samples: 8

SAMPLE PREPARATION AND ANALYTICAL PROCEDURES

Method Code	Number of Samples	Code Description	Test Wgt (g)	Report Status	Lab
R200-250	8	Crush, split and pulverize 250 g rock to 200 mesh			SMI
1F05	8	1:1:1 Aqua Regia digestion Ultratrace ICP-MS analysis	15	Completed	VAN

SAMPLE DISPOSAL

DISP-PLP Dispose of Pulp After 90 days
DISP-RJT Dispose of Reject After 90 days

ADDITIONAL COMMENTS

Acme does not accept responsibility for samples left at the laboratory after 90 days without prior written instructions for sample storage or return.

Invoice To: Donald Bunce
21670 Chief Lake Rd.
Prince George BC V2K 5K5
Canada

CC:



This report supersedes all previous preliminary and final reports with this file number dated prior to the date on this certificate. Signature indicates final approval; preliminary reports are unsigned and should be used for reference only. All results are considered the confidential property of the client. Acme assumes the liabilities for actual cost of analysis only. Results apply to samples as submitted. *** asterisk indicates that an analytical result could not be provided due to unusually high levels of interference from other elements.



AcmeLabs

Acme Analytical Laboratories (Vancouver) Ltd.

1020 Cordova St. East Vancouver BC V6A 4A3 Canada

Phone (604) 253-3158 Fax (604) 253-1716

www.acmelab.com

Client: Donald Bunce
21670 Chief Lake Rd.
Prince George BC V2K 5K5 Canada

Project: Jade Fever
Report Date: November 15, 2011

Page: 2 of 2 **Part** 1

CERTIFICATE OF ANALYSIS

SMI11000543.1

Method	Analyte	Unit	WGHT	1F15	1F15	1F15	1F15	1F15	1F15	1F15	1F15	1F15	1F15	1F15	1F15	1F15	1F15	1F15	1F15	1F15	1F15	
			Wgt	Mo	Cu	Pb	Zn	Ag	Ni	Co	Mn	Fe	As	U	Au	Th	Sr	Cd	Sb	Bi	V	Ca
		MDL	kg	ppm	ppm	ppm	ppm	ppb	ppm	ppm	ppm	%	ppm	ppm	ppb	ppm	ppm	ppm	ppm	ppm	ppm	
02 A1	Rock		0.23	0.28	25.11	5.91	60.1	30	13.1	9.8	581	2.70	2.2	0.3	<0.2	1.2	121.0	0.13	0.14	0.04	85	3.13
02 B1	Rock		0.35	0.77	8.19	3.24	25.5	18	6.3	4.3	317	1.56	1.8	0.1	1.1	0.4	323.7	0.05	0.07	0.03	40	4.54
03 A1	Rock		0.32	0.26	57.84	28.25	56.8	113	16.7	10.7	391	2.56	2.9	0.4	<0.2	1.7	55.0	0.12	0.20	0.21	56	1.34
03 B1	Rock		0.29	0.43	34.67	7.60	46.5	35	20.4	12.4	465	2.44	4.8	0.3	<0.2	1.3	46.8	0.09	0.18	0.07	66	1.80
04 A1	Rock		0.19	0.48	22.38	10.31	54.8	53	19.3	9.1	493	2.42	2.3	0.4	<0.2	1.6	189.4	0.16	0.12	0.05	67	3.12
04 B1	Rock		0.26	0.43	31.38	13.63	50.0	103	18.6	8.4	320	1.76	1.9	0.5	<0.2	2.4	109.8	0.16	0.12	0.09	49	1.38
05 A1	Rock		0.33	0.26	22.70	12.17	46.7	43	19.4	9.4	398	2.32	1.9	0.5	0.2	2.1	62.2	0.26	0.13	0.08	63	1.55
05 B1	Rock		0.37	0.19	20.08	5.80	58.8	51	16.7	9.8	604	2.91	0.9	0.4	0.5	1.6	212.5	0.11	0.14	0.04	98	3.27

This report supersedes all previous preliminary and final reports with this file number dated prior to the date on this certificate. Signature indicates final approval; preliminary reports are unsigned and should be used for reference only.



AcmeLabs

Acme Analytical Laboratories (Vancouver) Ltd.

1020 Cordova St. East Vancouver BC V6A 4A3 Canada
Phone (604) 253-3158 Fax (604) 253-1716

www.acmelab.com

Client: **Donald Bunce**
21670 Chief Lake Rd.
Prince George BC V2K 5K5 Canada

Project: Jade Fever
Report Date: November 15, 2011

Page: 2 of 2 Part 2

CERTIFICATE OF ANALYSIS

SMI11000543.1

Method		1F15	1F15	1F15	1F15	1F15	1F15	1F15	1F15	1F15	1F15	1F15	1F15	1F15	1F15	1F15	1F15	1F15	1F15	1F15	1F15
Analyte		P	La	Cr	Mg	Ba	Ti	B	Al	Na	K	W	Sc	Tl	S	Hg	Se	Te	Ga	Cs	Ge
Unit		%	ppm	ppm	%	ppm	%	ppm	%	%	%	ppm	ppm	ppm	%	ppb	ppm	ppm	ppm	ppm	ppm
MDL		0.001	0.5	0.5	0.01	0.5	0.001	1	0.01	0.001	0.01	0.1	0.1	0.02	0.02	5	0.1	0.02	0.1	0.02	0.1
02 A1	Rock	0.071	5.5	32.0	1.01	103.7	0.198	60	2.93	0.041	0.11	0.5	5.2	<0.02	<0.02	18	0.2	<0.02	10.0	0.22	0.1
02 B1	Rock	0.030	2.4	16.2	0.45	54.5	0.086	12	2.12	0.020	0.06	0.2	2.6	<0.02	<0.02	9	<0.1	0.04	8.0	0.11	<0.1
03 A1	Rock	0.087	5.6	19.6	0.84	133.4	0.212	5	2.01	0.049	0.35	0.3	3.6	0.04	<0.02	27	0.2	0.06	5.5	0.31	<0.1
03 B1	Rock	0.079	5.8	28.7	0.88	115.5	0.195	5	2.44	0.073	0.36	0.3	4.7	0.03	<0.02	14	0.1	0.03	5.6	0.30	<0.1
04 A1	Rock	0.087	7.5	23.5	0.75	125.7	0.173	5	2.72	0.125	0.22	0.3	4.7	<0.02	<0.02	10	<0.1	0.03	8.0	0.13	<0.1
04 B1	Rock	0.093	8.8	10.7	0.45	604.7	0.166	4	1.81	0.150	0.45	0.2	2.7	0.06	0.03	19	0.2	0.02	4.7	0.36	<0.1
05 A1	Rock	0.107	8.7	19.8	0.66	152.0	0.183	5	2.25	0.185	0.43	0.3	3.7	0.04	<0.02	14	<0.1	<0.02	7.1	0.40	<0.1
05 B1	Rock	0.083	8.5	30.7	0.88	281.3	0.194	4	2.34	0.226	0.22	0.3	4.9	<0.02	<0.02	24	<0.1	<0.02	8.1	1.07	<0.1

This report supersedes all previous preliminary and final reports with this file number dated prior to the date on this certificate. Signature indicates final approval; preliminary reports are unsigned and should be used for reference only.

- 14 -



AcmeLabs

Acme Analytical Laboratories (Vancouver) Ltd.

1020 Cordova St. East Vancouver BC V6A 4A3 Canada

Phone (604) 253-3158 Fax (604) 253-1716

www.acmelab.com

Client: Donald Bunce
21670 Chief Lake Rd.
Prince George BC V2K 5K5 Canada

Project: Jade Fever
Report Date: November 15, 2011

Page: 2 of 2 **Part** 3

CERTIFICATE OF ANALYSIS

SMI11000543.1

Method	Analyte	1F15	1F15	1F15	1F15	1F15	1F15	1F15	1F15	1F15	1F15	1F15	1F15	1F15	
		Hf	Nb	Rb	Sn	Ta	Zr	Y	Ce	In	Re	Be	Li	Pd	Pt
Unit		ppm	ppm	ppm	ppm	ppm	ppm	ppm	ppm	ppm	ppb	ppm	ppm	ppb	ppb
MDL		0.02	0.02	0.1	0.1	0.05	0.1	0.01	0.1	0.02	1	0.1	0.1	10	2
02 A1	Rock	0.24	0.13	2.6	0.5	<0.05	7.0	8.57	11.7	<0.02	2	1.0	16.7	13	<2
02 B1	Rock	0.09	0.08	1.6	0.4	<0.05	2.4	4.12	4.8	<0.02	1	0.4	8.1	<10	<2
03 A1	Rock	0.34	0.13	8.1	0.4	<0.05	9.6	9.29	11.7	<0.02	<1	0.3	13.2	<10	<2
03 B1	Rock	0.27	0.15	6.7	0.4	<0.05	7.3	9.18	12.1	0.03	<1	0.6	12.2	<10	<2
04 A1	Rock	0.32	0.21	4.7	0.5	<0.05	9.3	8.25	15.7	<0.02	1	0.7	9.4	<10	<2
04 B1	Rock	0.29	0.22	8.7	0.4	<0.05	8.8	7.62	17.2	<0.02	3	0.5	6.9	<10	<2
05 A1	Rock	0.30	0.21	8.4	0.4	<0.05	9.2	9.67	18.4	<0.02	<1	0.5	9.7	<10	<2
05 B1	Rock	0.31	0.21	4.9	0.5	<0.05	8.9	9.14	16.7	<0.02	<1	0.6	9.1	<10	<2

This report supersedes all previous preliminary and final reports with this file number dated prior to the date on this certificate. Signature indicates final approval; preliminary reports are unsigned and should be used for reference only.



Acme Analytical Laboratories (Vancouver) Ltd.
 1020 Cordova St. East Vancouver BC V6A 4A3 Canada
 Phone (604) 253-3158 Fax (604) 253-1716

www.acmelab.com

Client: **Donald Bunce**
 21670 Chief Lake Rd.
 Prince George BC V2K 5K5 Canada

Project: Jade Fever
 Report Date: November 15, 2011

Page: 1 of 1 Part 1

QUALITY CONTROL REPORT

SMI11000543.1

Method	WGHT	1F15	1F15	1F15	1F15	1F15	1F15	1F15	1F15	1F15	1F15	1F15	1F15	1F15	1F15	1F15	1F15	1F15	1F15	1F15	1F15
Analyte	Wgt	Mo	Cu	Pb	Zn	Ag	Ni	Co	Mn	Fe	As	U	Au	Th	Sr	Cd	Sb	Bi	V	Ca	
Unit	kg	ppm	ppm	ppm	ppm	ppb	ppm	ppm	ppm	%	ppm	ppm	ppb	ppm	ppm	ppm	ppm	ppm	ppm	%	
MDL	0.01	0.01	0.01	0.01	0.1	2	0.1	0.1	1	0.01	0.1	0.1	0.2	0.1	0.5	0.01	0.02	0.02	2	0.01	
Reference Materials																					
STD DS8	Standard	11.89	110.6	128.2	338.2	1810	38.5	7.5	613	2.48	26.7	2.6	96.3	6.4	63.9	2.40	5.38	6.77	40	0.69	
STD DS8	Expected	13.44	110	123	312	1690	38.1	7.5	615	2.46	26	2.8	107	6.89	67.7	2.38	5.7	6.67	41.1	0.7	
BLK	Blank	<0.01	<0.01	<0.01	<0.1	<2	<0.1	<0.1	<1	<0.01	<0.1	<0.1	<0.2	<0.1	<0.5	<0.01	<0.02	<0.02	<2	<0.01	
Prep Wash																					
G1	Prep Blank	0.50	12.86	8.29	55.6	30	2.4	4.1	545	1.90	0.9	1.7	1.3	5.5	63.1	0.07	0.04	0.10	35	0.49	
G1	Prep Blank	0.81	8.40	3.55	54.3	14	3.2	3.7	593	2.01	1.0	1.6	<0.2	5.3	65.7	0.04	0.02	0.06	36	0.48	

This report supersedes all previous preliminary and final reports with this file number dated prior to the date on this certificate. Signature indicates final approval; preliminary reports are unsigned and should be used for reference only.



AcmeLabs

Acme Analytical Laboratories (Vancouver) Ltd.

1020 Cordova St. East Vancouver BC V6A 4A3 Canada
Phone (604) 253-3158 Fax (604) 253-1716

www.acmelab.com

Client: **Donald Bunce**
21670 Chief Lake Rd.
Prince George BC V2K 5K5 Canada

Project: **Jade Fever**
Report Date: **November 15, 2011**

Page: 1 of 1 Part 2

QUALITY CONTROL REPORT

SMI11000543.1

Method	1F16	1F16	1F16	1F16	1F16	1F16	1F16	1F16	1F16	1F16	1F16	1F16	1F16	1F16	1F16	1F16	1F16	1F16	1F16	1F16	1F16
Analyte	P	La	Cr	Mg	Ba	Tl	B	Al	Na	K	W	Sc	Tl	S	Hg	Se	Te	Ga	Cs	Ge	
Unit	%	ppm	ppm	%	ppm	%	ppm	%	%	%	ppm	ppm	ppm	%	ppb	ppm	ppm	ppm	ppm	ppm	
MDL	0.001	0.5	0.5	0.01	0.5	0.001	1	0.01	0.001	0.01	0.1	0.1	0.02	0.02	5	0.1	0.02	0.1	0.02	0.1	
Reference Materials																					
STD DS8	Standard	0.081	12.9	123.8	0.60	250.0	0.114	2	0.99	0.074	0.46	3.0	2.0	5.59	0.16	196	5.3	5.13	4.6	2.52	<0.1
STD DS8	Expected	0.08	14.6	115	0.6045	279	0.113	2.6	0.93	0.0883	0.41	3	2.3	5.4	0.1679	192	5.23	5	4.7	2.48	0.13
BLK	Blank	<0.001	<0.5	<0.5	<0.01	<0.5	<0.001	<1	<0.01	<0.001	<0.01	<0.1	<0.1	<0.02	<0.02	<5	<0.1	<0.02	<0.1	<0.02	<0.1
Prep Wash																					
G1	Prep Blank	0.070	13.2	7.3	0.49	170.4	0.127	<1	1.05	0.136	0.54	<0.1	2.0	0.30	<0.02	<5	<0.1	<0.02	4.8	2.84	0.2
G1	Prep Blank	0.076	12.4	5.3	0.48	157.9	0.113	<1	1.07	0.147	0.53	<0.1	2.3	0.31	<0.02	<5	<0.1	<0.02	4.7	2.71	<0.1

This report supersedes all previous preliminary and final reports with this file number dated prior to the date on this certificate. Signature indicates final approval; preliminary reports are unsigned and should be used for reference only.

- 17 -



AcmeLabs

Acme Analytical Laboratories (Vancouver) Ltd.

1020 Cordova St. East Vancouver BC V6A 4A3 Canada

Phone (604) 253-3158 Fax (604) 253-1716

www.acmelab.com

Client: **Donald Bunce**
21870 Chief Lake Rd.
Prince George BC V2K 5K5 Canada

Project: **Jade Fever**
Report Date: **November 15, 2011**

Page: 1 of 1 Part 3

QUALITY CONTROL REPORT

SMI11000543.1

Method		1F15	1F15	1F15	1F15	1F15	1F15	1F15	1F15	1F15	1F15	1F15	1F15	1F15	1F15
Analyte		Hf	Nb	Rb	Sn	Ta	Zr	Y	Ce	In	Re	Be	Li	Pd	Pt
Unit		ppm	ppm	ppm	ppm	ppm	ppm	ppm	ppm	ppb	ppm	ppm	ppb	ppb	ppb
MDL		0.02	0.02	0.1	0.1	0.05	0.1	0.01	0.1	0.02	1	0.1	0.1	10	2
Reference Materials															
STD DS8	Standard	0.07	0.97	38.2	7.2	<0.05	1.9	5.23	23.5	2.36	67	4.9	26.9	119	358
STD DS8 Expected		0.08	1.65	39	6.7	0.003	2.3	6.1	29.8	2.19	55	5.2	26.34	110	339
BLK	Blank	<0.02	<0.02	<0.1	<0.1	<0.05	<0.1	<0.01	<0.1	<0.02	<1	<0.1	<0.1	<10	<2
Prep Wash															
G1	Prep Blank	0.08	0.43	42.6	0.6	<0.05	1.2	5.57	24.1	<0.02	<1	0.3	30.6	<10	<2
G1	Prep Blank	0.05	0.47	42.8	0.5	<0.05	1.0	4.51	22.4	0.02	<1	0.2	29.0	<10	<2

This report supersedes all previous preliminary and final reports with this file number dated prior to the date on this certificate. Signature indicates final approval; preliminary reports are unsigned and should be used for reference only.

- 18 -



Acme Analytical Laboratories (Vancouver) Ltd.
 1020 Cordova St. East
 Vancouver, BC Canada V6A 4A3
 Phone 604 253 3158 Fax 604 253 1716
 GST # 843013921 RT

Bill To: Donald Bunce
 21670 Chief Lake Rd.
 Prince George, BC V2K 5K5
 Canada

bcjade@telus.net

Send to Claudia@JadeCity.com

Invoice Date: October 11, 2011
 Invoice Number: **VANI098871**
 Submitted by: Donald Bunce
 Job Number: SMI11000413
 Order Number:
 Project Code: Jade Fever
 Shipment ID:
 Quote Number:

Item	Package	Description	Sample No.	Unit Price	Amount
1	R200-250	Crush and Pulverize 250 g	2	\$6.85	\$13.70
2	1F05	15g Full Suite (53 Elements)	2	\$25.75	\$51.50
3	DIS-PLP	Warehouse disposition of pulps	2	\$0.10	\$0.20
4	DIS-RJT	Warehouse disposition of reject	2	\$0.25	\$0.50
5	BATCH	Batch Surcharge for <20 samples	1	\$50.00	\$50.00
			Net Total		\$115.90
			BC HST		\$13.91
			Grand Total	CAD	\$129.81

Invoice Stated In Canadian Dollars

Payment Terms:

Due upon receipt of invoice. Please pay the last amount shown on the invoice.

For cheque payments, please remit payment to the above address, made payable to: Acme Analytical Laboratories (Vancouver) Ltd.
 Please specify Acme invoice number on cheque remittance.

For electronic payments, please wire funds to one of the following accounts:

For payment in Canadian Funds:

Acme Analytical Laboratories (Vancouver) Ltd.
 HSBC
 885 West Georgia St
 Vancouver, BC Canada V6C 3G1
 Account # 428755-001
 Bank Transit # 10270-016
 Swift Code: HKBCCATT

For payment in US Funds:

Acme Analytical Laboratories (Vancouver) Ltd.
 HSBC
 885 West Georgia St
 Vancouver, BC Canada V6C 3G1
 Account # 428755-070
 Bank Transit # 10270-016
 Swift Code: HKBCCATT

Please specify Acme invoice number for reference on transfer forms when making payment.



Acme Analytical Laboratories (Vancouver) Ltd.
 1020 Cordova St. East
 Vancouver, BC Canada V6A 4A3
 Phone 604 253 3158 Fax 604 253 1716
 GST # 843013921 RT

Bill To: Donald Bunce
 21670 Chief Lake Rd.
 Prince George, BC V2K 5K5
 Canada

 client.fax@acmelab.com

Invoice Date: November 7, 2011
 Invoice Number: **VANI103254**
 Submitted by: Donald Bunce
 Job Number: SMI11000543
 Order Number:
 Project Code: Jade Fever
 Shipment ID:
 Quote Number:

Item	Package	Description	Sample No.	Unit Price	Amount
1	R200-250	Crush and Pulverize 250 g	8	\$6.85	\$54.80
2	1F05	15g Full Suite (53 Elements)	8	\$25.75	\$206.00
3	DIS-PLP	Warehouse disposition of pulps	8	\$0.10	\$0.80
4	DIS-RJT	Warehouse disposition of reject	8	\$0.25	\$2.00
5	BATCH	Batch Surcharge for <20 samples	1	\$50.00	\$50.00
			Net Total		\$313.60
			BC HST		\$37.63
			Grand Total	CAD	\$351.23

Invoice Stated In Canadian Dollars

Payment Terms:

Due upon receipt of invoice. Please pay the last amount shown on the invoice.

For cheque payments, please remit payment to the above address, made payable to: Acme Analytical Laboratories (Vancouver) Ltd.
 Please specify Acme invoice number on cheque remittance.

For electronic payments, please wire funds to one of the following accounts:

For payment in Canadian Funds:

Acme Analytical Laboratories (Vancouver) Ltd.
 HSBC
 885 West Georgia St
 Vancouver, BC Canada V6C 3G1
 Account # 428755-001
 Bank Transit # 10270-016
 Swift Code: HKBCCATT

For payment in US Funds:

Acme Analytical Laboratories (Vancouver) Ltd.
 HSBC
 885 West Georgia St
 Vancouver, BC Canada V6C 3G1
 Account # 428755-070
 Bank Transit # 10270-016
 Swift Code: HKBCCATT

Please specify Acme invoice number for reference on transfer forms when making payment.

Statement of Exploration and Development

Statement of Costs

2011 Exploration costs (Jade Fever Project)

A - Compact Excavator (KX41) costs	
- Trail construction - 1.14 km. 129 hours at \$53.37 per/hour	\$6,884.73
- Trail Reclaimed - 14.2 meters 0.5 hours at \$53.37 per/hour	\$26.69
	<hr/>
	\$6,911.42
B - Rock Analysis costs	\$481.04
	<hr/>
	Total - \$7,392.46
C - Transportation costs - 20% of the value of exploration work done	\$1,478.49
An explanation of transportation costs are on page 22	<hr/>
	Total Costs - \$8,870.95

Statement of Exploration and Development

Explanation of transportation costs

We traveled from Jade city to the claims at the north end of Diese Lake every day, round trip is 150 km. per day for 27 days with a 2005, F150 4x4.

150 km. x 27 days = 4050 km. at \$0.55 per km. is a Total of \$2227.50

There - fore Transportation costs are 20% - \$1478.49

Author's Qualifications

I, Donald Bunce am the recorded holder of the Jade fever claims. I have been a jade prospector since 2005



Internet Mapping Framework

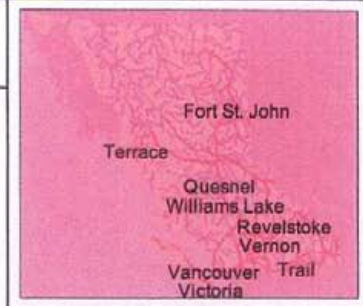
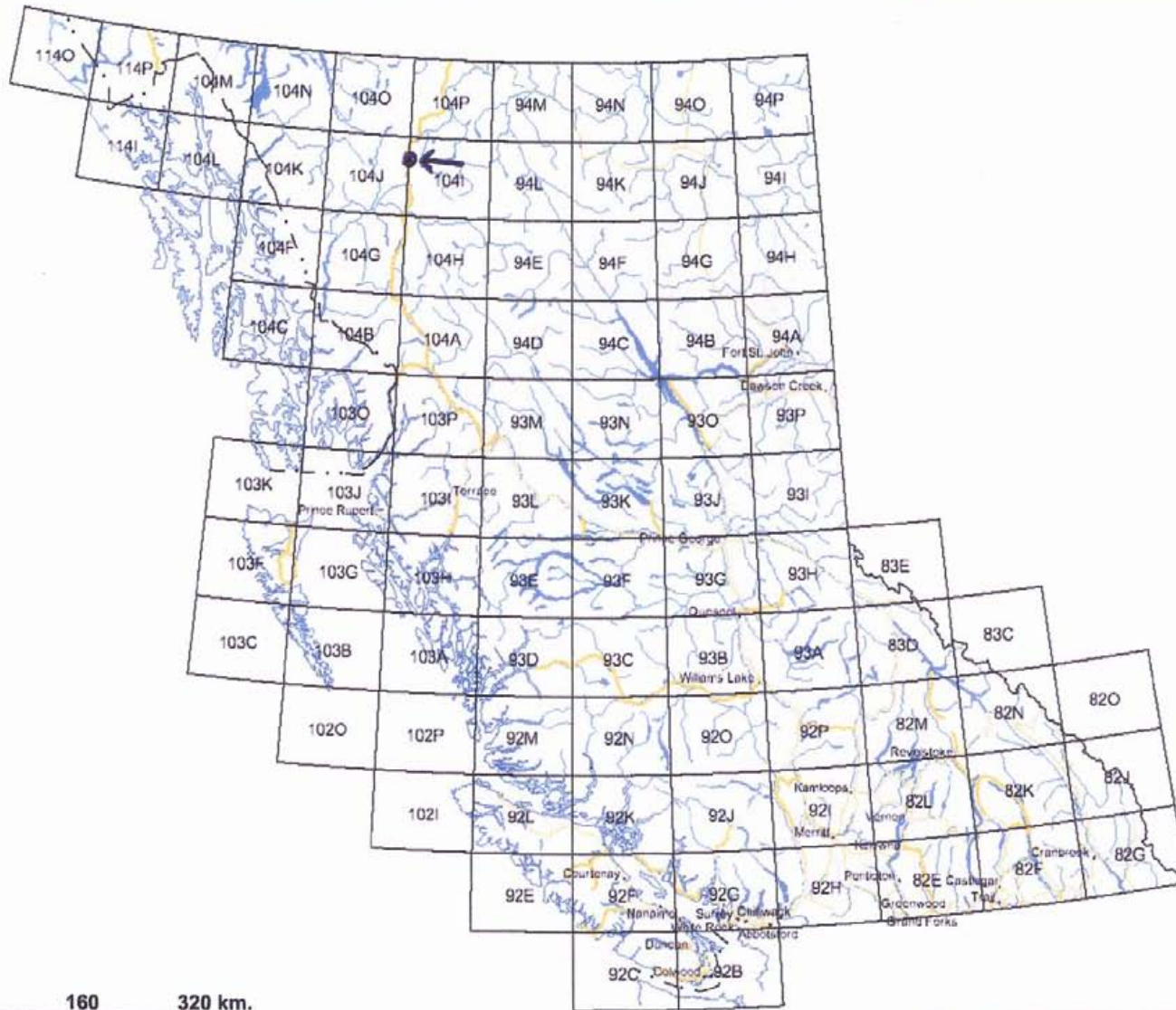

Legend

- Provincial Boundary (1:6M)
- Boundary (International)
- Boundary (Interprovincial)
- NTS Grid
- Transportation - Lines (1:6M)
 - Road - Trunk
 - Road - Main
 - Rail Line
- Water - Lines (1:6M)
 - River/Stream - Definite
 - Lake - Definite
 - Island - Definite
 - Coastline - Definite
- Water - Polygons (1:6M)
 - River/Stream - Definite
 - Lake - Definite
- Major Cities
- ⊗ Location of Jade Fever

0 160 320 km.

Map center: 54°20' N, 125°25' W

Scale: 1:9,150,657

This map is a user generated static output from an Internet mapping site and is for general reference only. Data layers that appear on this map may or may not be accurate, current, or otherwise reliable. THIS MAP IS NOT TO BE USED FOR NAVIGATION.

Map #1 of British Columbia

MAP #2 Showing Jade Fever from the nearest town

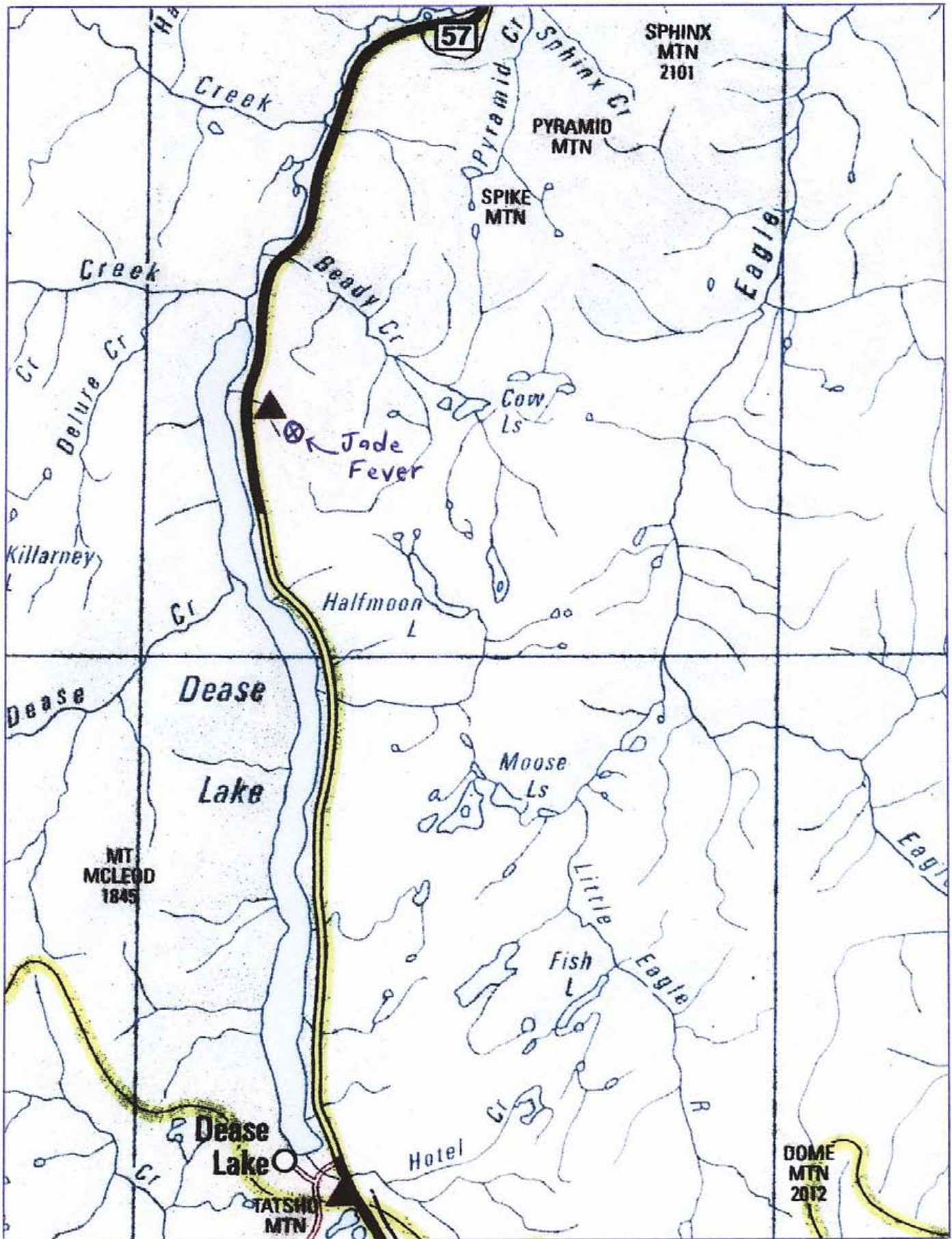

Internet Mapping Framework

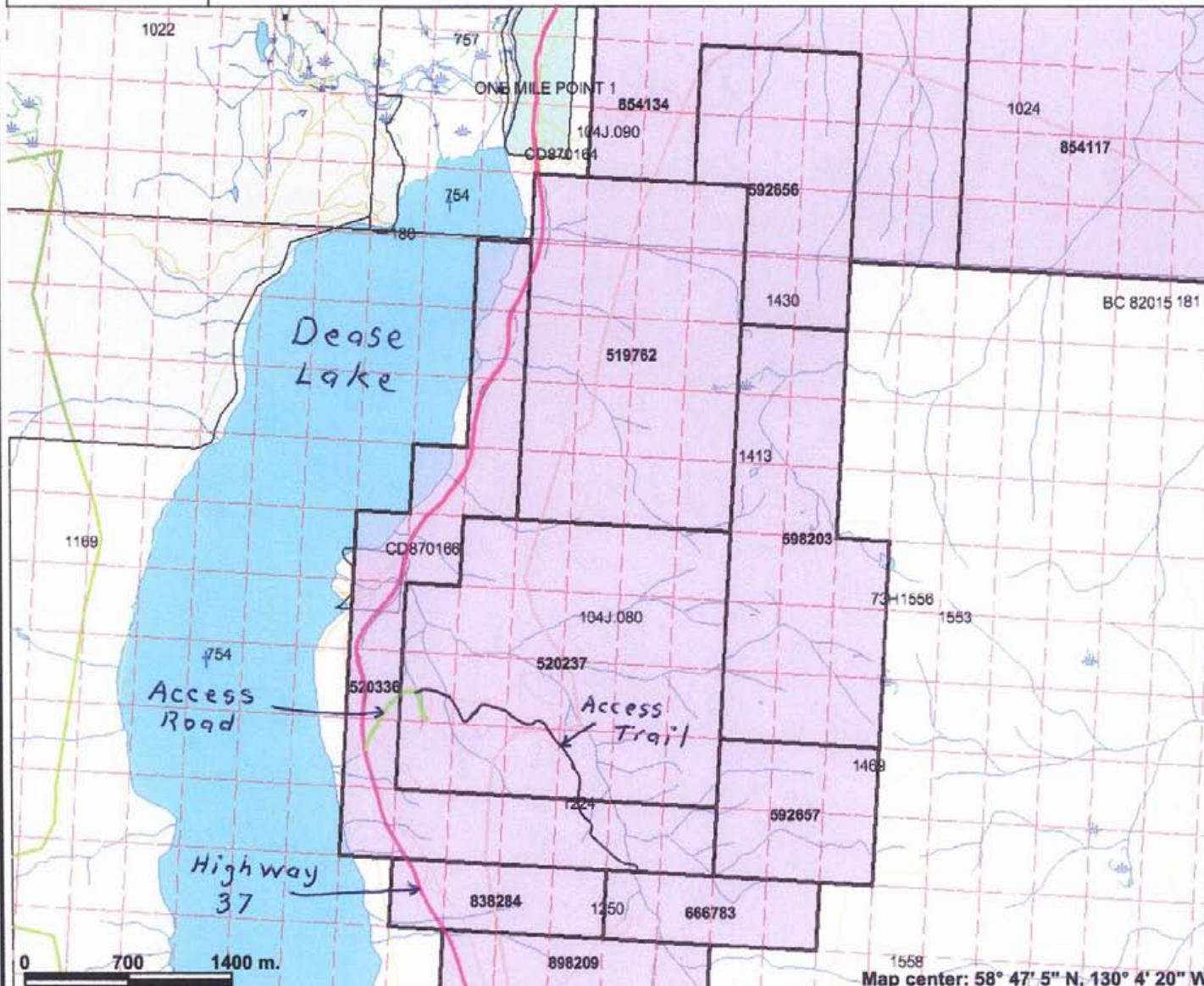

Legend





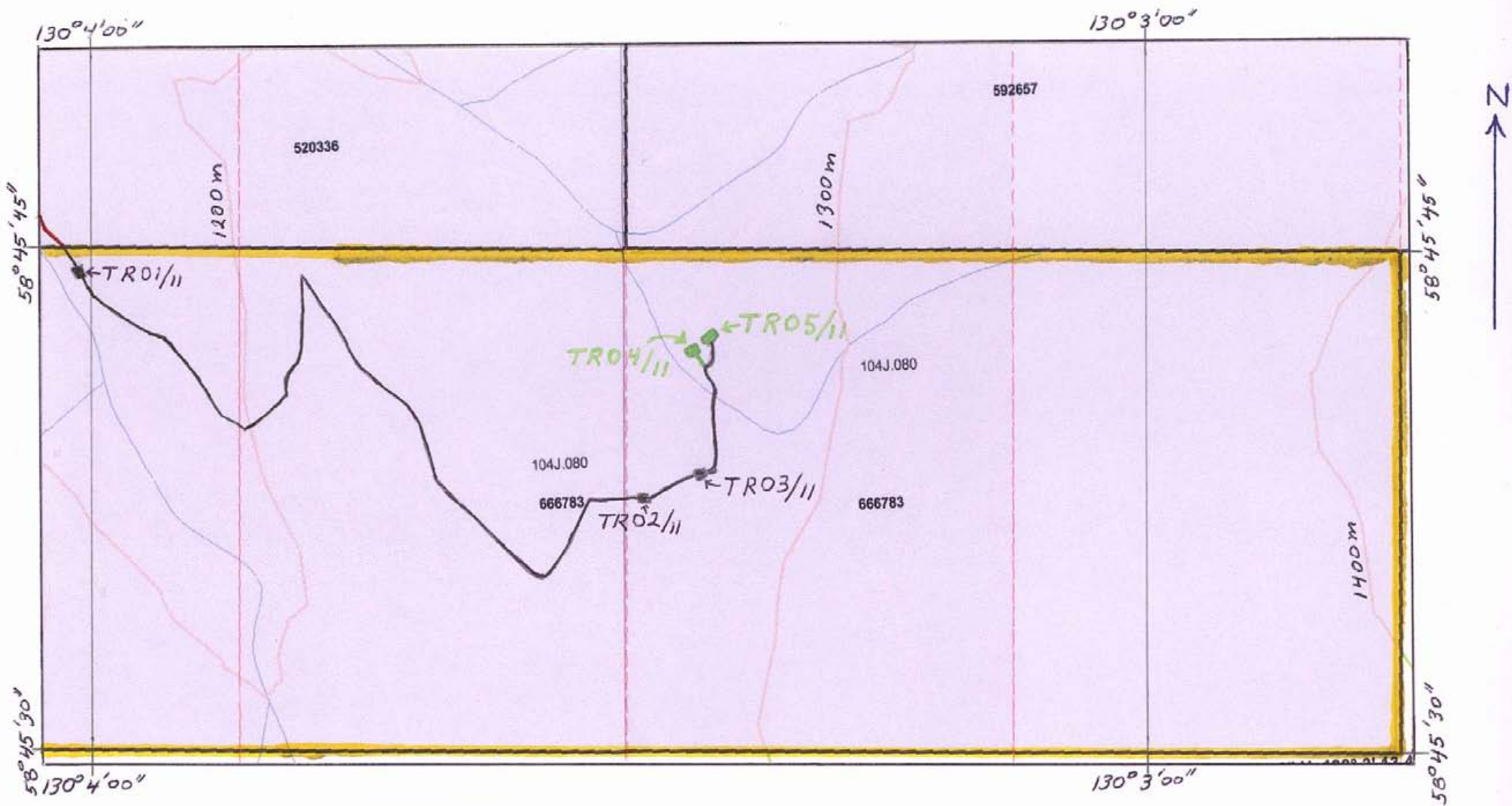

- Indian Reserves
- National Parks
- Conservancy Areas
- Parks
- MTO Grid (MTO)
- Blocked by MEM
- Other
- Mineral Tenure (current)
- Mineral Claim
- Mineral Lease
- Mineral Reserves (current)
- Placer Claim Designation
- Placer Lease Designation
- No Staking Reserve
- Conditional Reserve
- Release Required Reserve
- Surface Restriction
- Recreation Area
- Others
- Survey Parcels
- BCGS Grid
- Contours (1:250K)
- Contour - Index
- Contour - Intermediate
- Area of Exclusion
- Area of Indefinite Contours
- Annotation (1:20K)
- Transportation - Points (TRIM)
- Helipad
- Transportation - Lines (TRIM)
- Airfield
- Airport

Scale: 1:40,761

This map is a user generated static output from an Internet mapping site and is for general reference only. Data layers that appear on this map may or may not be accurate, current, or otherwise reliable. THIS MAP IS NOT TO BE USED FOR NAVIGATION.

Map #3 Showing Highway 37, Access road and Access trail



Legend	
	Access Trail
	Exploration Trail made in 2011
	Trenchs made in 2011
	Claim boundaries
	Exploration Trail made in 2011 and Reclaimed
	Trenchs made in 2011 and Reclaimed

Scale 1:5000

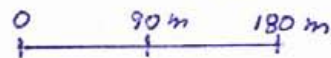

Map # 4

Showing work sites relative to the claim boundaries

Picture of Exploration trail



Picture of Exploration trail



Picture of Exploration trail



Picture of Exploration trail

