



**BC Geological Survey
Assessment Report
37694**



Ministry of Energy and Mines
BC Geological Survey

Assessment Report
Title Page and Summary

TYPE OF REPORT [type of survey(s)]: Prospecting, Physical, Geochemical Assessment

TOTAL COST: \$5150.00

AUTHOR(S): Le Baron Prospecting - Scott Phillips

SIGNATURE(S):

NOTICE OF WORK PERMIT NUMBER(S)/DATE(S): _____ YEAR OF WORK: 2018

STATEMENT OF WORK - CASH PAYMENTS EVENT NUMBER(S)/DATE(S): 5695348

PROPERTY NAME: The Andy Claim & Caycuse Friends group - #0802354 - BC LTD

CLAIM NAME(S) (on which the work was done): tenure #1051605

COMMODITIES SOUGHT: Au, Ag, Cu, Fe

MINERAL INVENTORY MINFILE NUMBER(S), IF KNOWN: M092108, c017, c018,

MINING DIVISION: Victoria NTS/BCGS: M092c089

LATITUDE: 48 ° 52 ' 7 " LONGITUDE: 124 ° 17 ' 31 " (at centre of work)

OWNER(S):

- 1) Andy Halusiahk 2) _____
- Scott Phillips

MAILING ADDRESS:

andy - #36 Hammond Rd - Lake Cowichan BC

scott - 3317 Henry Rd - Chemainus BC

OPERATOR(S) [who paid for the work]:

- 1) Andy Halusiahk 2) _____

MAILING ADDRESS:

#36 Hammond Rd - Lake Cowichan BC

PROPERTY GEOLOGY KEYWORDS (lithology, age, stratigraphy, structure, alteration, mineralization, size and attitude):

Wrangella, West Coast Complex, Cowichan uplift, Sicker Group, Nanaimo Group, upper Triassic, lower Jurassic,

copper skarns, Cowichan sediments and alluvial gravels.

REFERENCES TO PREVIOUS ASSESSMENT WORK AND ASSESSMENT REPORT NUMBERS: 2015 - (34,893) forfeited tenure

TYPE OF WORK IN THIS REPORT	EXTENT OF WORK (IN METRIC UNITS)	ON WHICH CLAIMS	PROJECT COSTS APPORTIONED (incl. support)
GEOLOGICAL (scale, area)			
Ground, mapping		tenure # 1051605	\$5150.00
Photo interpretation			
GEOPHYSICAL (line-kilometres)			
Ground			
Magnetic			
Electromagnetic			
Induced Polarization			
Radiometric			
Seismic			
Other			
Airborne			
GEOCHEMICAL (number of samples analysed for...)			
Soil 5		Certificate VA12865758	
Silt		Certificate VA18265756	
Rock			
Other			
DRILLING (total metres; number of holes, size)			
Core			
Non-core			
RELATED TECHNICAL			
Sampling/assaying			
Petrographic			
Mineralographic			
Metallurgic			
PROSPECTING (scale, area)			
PREPARATORY / PHYSICAL			
Line/grid (kilometres)			
Topographic/Photogrammetric (scale, area)			
Legal surveys (scale, area)			
Road, local access (kilometres)/trail			
Trench (metres)			
Underground dev. (metres)			
Other	Hand dig test pits x 5 ----3.91 cubic yards of	alluvial gravels removed from pits	
		TOTAL COST:	\$5150.00



**Le Baron Prospecting
Port Renfrew BC**

Physical, Technical, Geochemical Assessment Report

The Andy Claim
Tenure # 1051605

Victoria Mining Division
Map # 092C089
48'5207" N x 124'1731" W

Tenure owner
Andy Halusiahk
FMC #213251

**Report Written By
Scott Phillips
Le Baron Prospecting
Port Renfrew BC
V0S-1K0**

2018

The Andy Claim - Lake Cowichan





**Le Baron Prospecting
Port Renfrew BC**

Table of Contents

Cover page.....	1
Table of contents.....	2
Executive summary.....	3
Tenure ownership.....	4
Author, disclaimer, property representative.....	5
Statement of costs.....	6
Location, access, biodiversity,	7
Geological setting.....	8
Area history.....	9
Exploration overview.....	10
Appendix A	
Work site #1.....	11 to 12
Appendix B	
Work site #2.....	13 to 14
Appendix C	
Work site #3.....	15 to 16
Appendix D	
Work site #4.....	17 to 18
Appendix E	
Work site #5.....	19 to 20
Summary of exploration / recommendations.....	21
ALS Certificate of Analysis.....	22 to 23

The Andy Claim - Lake Cowichan

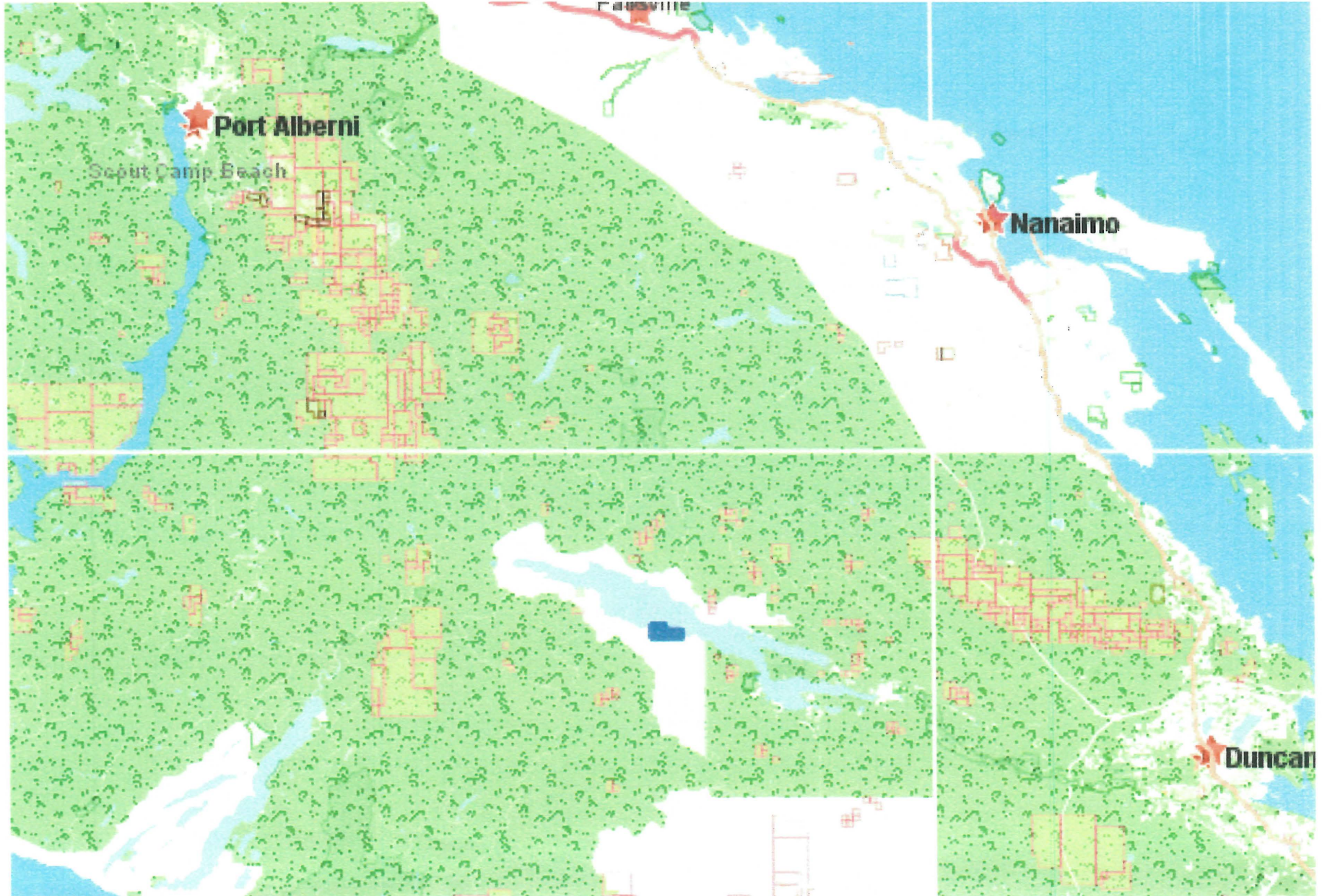



#0802354 - BC. LTD - Mineral Tenure

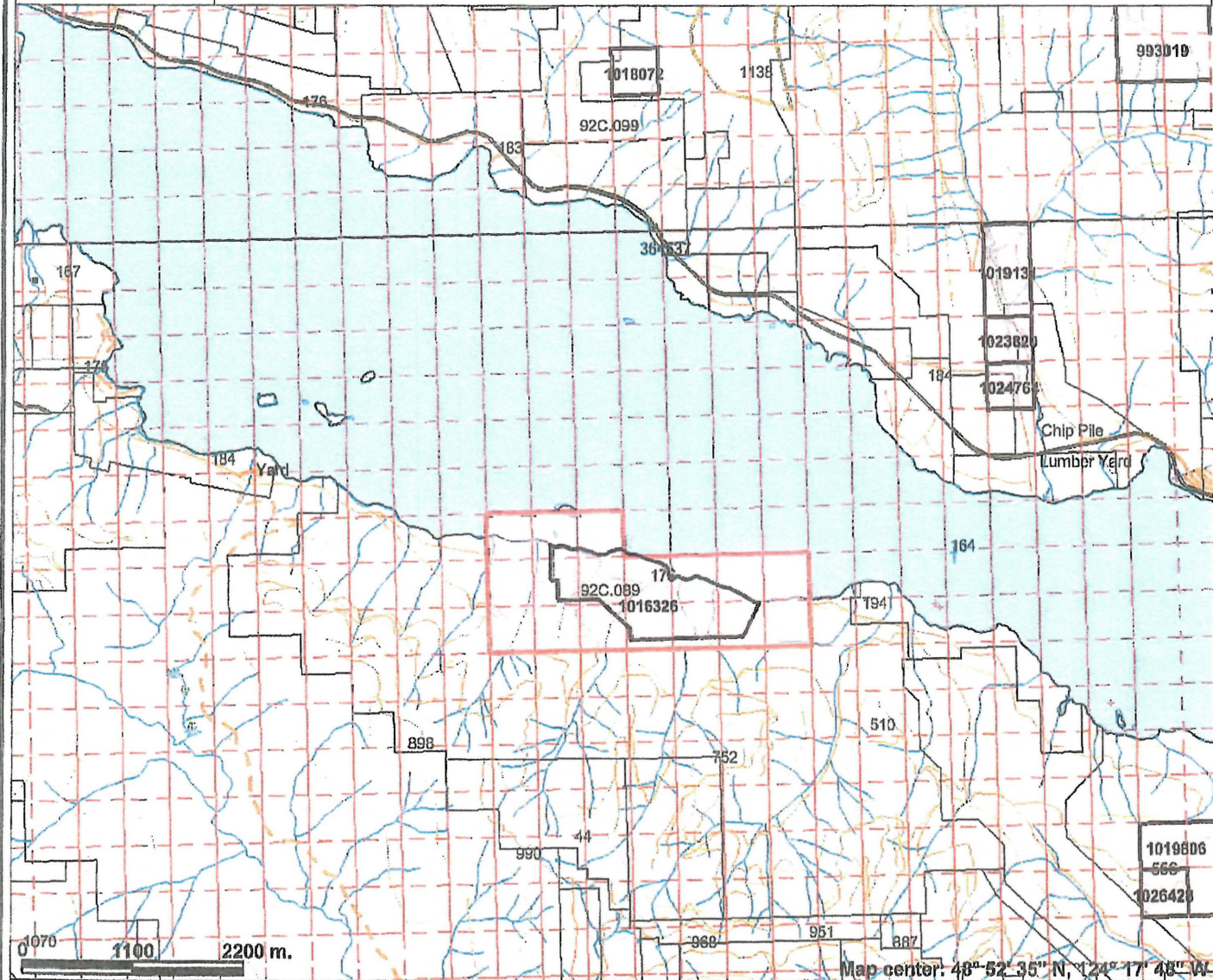
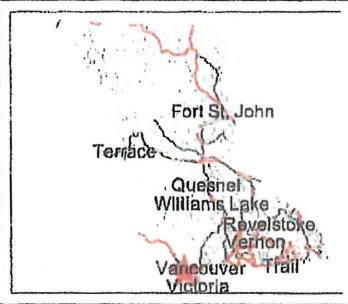

Legend

- Indian Reserves
- National Parks
- Conservancy Areas
- Parks
- Federal Transfer Lands
- MTO Grid (MTO)
- Mineral Tenure (current)
- Mineral Claim
- Mineral Lease
- Mineral Reserves (current)
- Placer Claim Designation
- Placer Lease Designation
- No Staking Reserve
- Conditional Reserve
- Release Required Reserve
- Surface Restriction
- Recreation Area
- Others
- First Nations Treaty Related Lands
- First Nations Treaty Lands
- Survey Parcels
- BCGS Grid
- Contours (1:250K)
- Contour - Index
- Contour - Intermediate
- Area of Exclusion
- Area of Indefinite Contours
- Transportation - Points (TRIM)
- Heliped
- Transportation - Lines (TRIM)

Scale: 1:60,000

0 1070 1100 2200 m.

Map center: 48° 52' 35" N, 124° 17' 48" W

This map is a user generated static output from an Internet mapping site and is for general reference only. Data layers that appear on this map may or may not be accurate, current, or otherwise reliable. THIS MAP IS NOT TO BE USED FOR NAVIGATION.

Notes: Tenure location overview map
Lake Cowichan BC

The Andy Claim tenure locaiton map

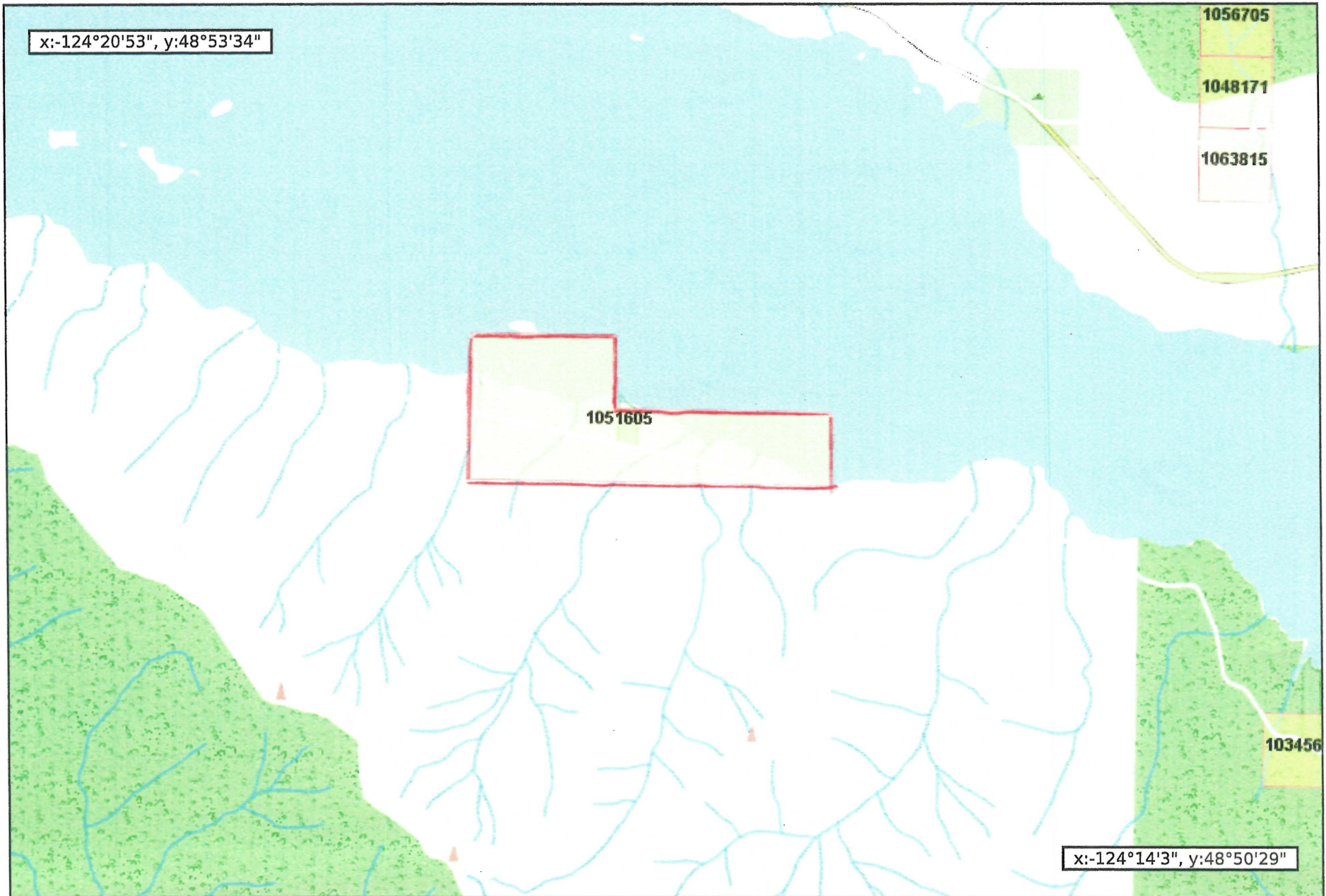



**Le Baron Prospecting
Port Renfrew BC**

Executive Summary:

This mineral tenure is 99% owned by tenure owner Andy Halusiahk (FMC #213251) of Lake Cowichan BC and 1% co-owned by Scott Phillips (FMC #145817) of Port Renfrew BC.

Andy Halusiahk is also part of a group of representatives who also own the surface rights of this subject property (Block 12 property) #0802354 – BC LTD. The Block 12 property was part of Timber West private land sales, it was purchase by the group of individuals was for private recreation purposes and for future development into recreational lots.

The original tenure #573971 was established in January 17th 2008, it forfeited on January 12th 2012 due to disagreements. It was re-established January 24th 2012 and forfeited January 13th 2013 due to technical MTO issues. It was once again re-established on January 13th 2013 and forfeited January 26th 2017 due to non-payment. Finally, it was re-established on a smaller scale April 27th 2017 with assessment work progressing and the tenure was pushed out to April 22nd 2022.

As a property or surface owner of property in the Province of British Columbia it may come as a surprise to find out that you do not own the mineral rights or subsurface rights to your own property. While it is very obvious that in urban areas there can be no mineral exploration, however when travelling outside of cities and towns it is possible to come across mineral and or placer tenures which are owned by prospectors. There are a few case studies in the Province in which disputes between surface and subsurface ownership of rights has been challenged.

Within the Province of British Columbia, it is important for large property owners to protect all rights to their property, both to the surface and the subsurface. Since the Province of British Columbia owns the mineral rights to most of the Province, the chief gold commissioner must establish and maintain a mineral titles online registry for the purposes of registrations respecting claims, leases and notices, the Mineral Titles Online staking system allows any prospector with a valid FMC (free miners license) to establish a mineral claim to your property in a few minutes if warranted.

With this in mind Andy Halusiak contacted Scott Phillips of Le Baron Prospecting of Port Renfrew to assist the Caycuse Friends to establish a mineral tenure on their property to protect the subsurface rights, and to potentially look into the vast amounts of gravel and the minerals within as a possible source of an alternate use of part of the property.

To date, work on this property has been extensive for the development into recreational lots in the northern or waters edge of the property. This work is not related to the work on the mineral tenure, or work claimed for the assessment. (Some of the information is referenced only for this report)

There is a lot of documentation on this property which pertains to the development of part of this property for recreational purposes and is subject to privacy act and remains with the owners. Limited access to documentation has been provided to Le Baron Prospecting for the purposes of this mineral assessment report. Most of the work on the Block 12 property is not part of the mineral assessment of tenure # 1051605

Le Baron Prospecting has conducted a basic site survey (one day), to verify information provided for the documentation of this report.



**Le Baron Prospecting
Port Renfrew BC**

Tenure Ownership

Tenure / Property Ownership: Surface and subsurface ownership:

Surface rights: The surface rights to this tenure / property are owned jointly by a group of individuals known as the Caycuse Friends or #0802354 - BC. LTD. The surface rights to part of the mineral tenure are subject property Cowichan Lake District, Plan # 775 (Appendix A) the rest of the mineral tenure the surface rights are owned by privately by Timber West.

Subsurface rights:

Andy Halusiak of Lake Cowichan BC.

FMC # 213251 - 99% owner

Scott Phillips of Port Renfrew BC.

FMC #145817 – 1% owner

The status of this tenure is as follows:

Tenure	Staked	Good to date	Area
1051605	2017 / Apr / 27	2022 / Apr / 27	148.73 ha



**Le Baron Prospecting
Port Renfrew BC**

Author / disclaimer

Scott Phillips of Le Baron Prospecting am the author of this report. I hold no interests in the mineral tenure referred to in this technical report. Information provided for this assessment was provided to the author (filed notes, maps, charts, access to documentation) the author did not conduct any of the technical field work, except for a site visit for verification purposes.

I am the owner of Le Baron Prospecting which owns or co-owns many mineral tenures and projects located in the Port Renfrew area.

Le Baron Prospecting's main mineral project is to continue to explore its vast Fe deposits within the huge Pearson Project being conducted by Pacific Iron Ore Corporation located within Port Renfrew.

Author;

- Scott Phillips [FMC # 145817]
- Many years experience prospecting the Port Renfrew area.
- Member in good standing with VIPMA. [Vancouver Island Miners Assn].
- Owns several mineral and placer tenures within the Port Renfrew Area.
- Author of many prospecting reports accepted within the Ministry standards.
- Is presently studying the formation of Wrangell, West Coast Crystalline Complex and the Leech River Complex.

Author  Date 11/12/18

Author Disclaimer;

I, Scott Phillips have a valued interest (1 %) in the tenure that is mentioned in this report.

I consent to the use of the material within this prospecting report to further enhance the exploration and development of the subject tenure. This report is correct in the information within and any use of this information to a second or third party is the responsibilities of those parties.

• I have only verified some of the field work and found it to be correct, and assume that the rest of the field work meets all the data provided to the author of this report.

The purpose of the mineral tenure is to ensure the protection of ownership to both the surface rights and the subsurface rights to this piece of private property in the Province of British Columbia.

Mineral Tenure / Property Representative:

Name (print) _____ Date: _____



**Le Baron Prospecting
Port Renfrew BC**

Statement of Costs

Dates of assessment work

April 14th to 20th -2018

Andy Halusiahk

FMC #213251

\$350.00 / day rate / x 7 days = \$2450.00

Field Labor

S. Ludvickson

\$200.00 / day rate / x 7 days = \$1400.00

April 21st 2018

Scott Phillips

FMC # 145817

\$350.00 / day rate / x 1 day = \$350.00

Field Assistant

B. Bradshaw

\$200.00 / day rate / x 1 day = \$200.00

Total = \$4400.00\$4400.00

Transportation

Andy Halusiahk

\$50.00 / day rate / x 7 days = \$350.00

Scott Phillips

\$50.00 / day rate / x 1 day = \$50.00

Total = \$400.00\$400.00

Assessment Report

Le Baron Prospecting

\$350.00 / day rate / x 1 day\$350.00

ALS Laboratory

Geochemical analysis (not included at time of assessment filing)(\$235.18)

Total Exploration (2018)\$5150.00



**Le Baron Prospecting
Port Renfrew BC**

Property Location / access

The Caycuse Friends Mineral tenure (#1051605) is located within the Victoria Mining Division, NTS Map 092C089, UTM location - 48 degrees - 52' - 7" N x 124 degrees - 17* - 31" W. its location is approximately 140 kilometers north / west of Victoria BC on the south shore of Cowichan Lake BC and is located 4.7 kilometers east of Caycuse between Misery Creek and Rock Cut Creek on the South Shore Logging road which is privately owned by Timber West Forest Products.

Property biodiversity:

The surface rights to this property was originally registered with land titles in the Province of British Columbia as Block 12, which was owned by Island Pacific Timberlands and subsequently sold to the Caycuse Friends group in 2007. The property has been logged twice and was subsequently replanted in recent years with a small young forest established, there are several creeks which traverse this property that due to the topographic conditions outside of this property the creeks are considered high runoff and are usually dry by mid July, there has been a Environmental Assessment conducted for the property owners on this property by Ted Burns - a registered Biologist on the creeks within this property (Report confidential at this time, a summarized version by Le Baron Prospecting is included as reference information only)

Property topography:

Topographic conditions can best be described as mild, with low / gentle elevations of 183 meters at lakeshore in the northern part of the tenure north of the South Shore road and eventually climbing in the southern portion to 500 meters in the southern tenure where there is some excellent exposures of Cu with pyrite along the rock faces on bedrock exposures. Within the tenure there are four small creeks which in the summer months become dry but sufficient water in the late fall to early spring supported panning exploration. Climatic conditions are considered mild and therefore are favorable for year-round exploration.



**Le Baron Prospecting
Port Renfrew BC**

Regional Geology

Lake Cowichan lies at the eastern end of the Cowichan uplift, a major geanticline on Vancouver Island. The area is underlain by pyroclastic, sedimentary and volcanic rocks of the Paleozoic Sicker Group, the Mississippian to Permian Buttle Lake Formation, the Upper Triassic Vancouver Group and the Lower Jurassic Bonanza Group. Intrusions include Triassic gabbro (informally named Mount Hall) and Early to Middle Jurassic plutonic rocks. Upper Cretaceous sediments of the Nanaimo Group overlap the older rocks

The Cowichan Lake area lies on the southern flank of the Cowichan / Home Lake Uplift, one of a series of geanticlines which make up Southern Vancouver Island. The area is underlain by all the formations typical of Wrangella (Sicker Group, Nanaimo Group, Bonanza Group, Island Intrusions, West Coast Crystalline Complex to name a few)

Tenure geology:

In general, the property is underlain by the glacial aluvial rocks of the Vancouver Group which consist of the Karmutsen Formation volcanic rocks which are a combination of the limestones of the Quatsino Formation, sediments of the Parson Bay Formation, which are a combination of Tuffaceous argillites and breccias of the Parson Bay Formation. The Karmutsen volcanics (basalts) are dark green to black, fine-grained to aphanitic and generally exhibit brownish weathered surfaces. Locally the basalts are porphyritic with some chloritic alteration and disseminated pyrite and magnetite are present also within the alluvial. The alluvial gravels are measured in the test pits in the drainages are from very fine sands <1mm to massive boulders >2meters.

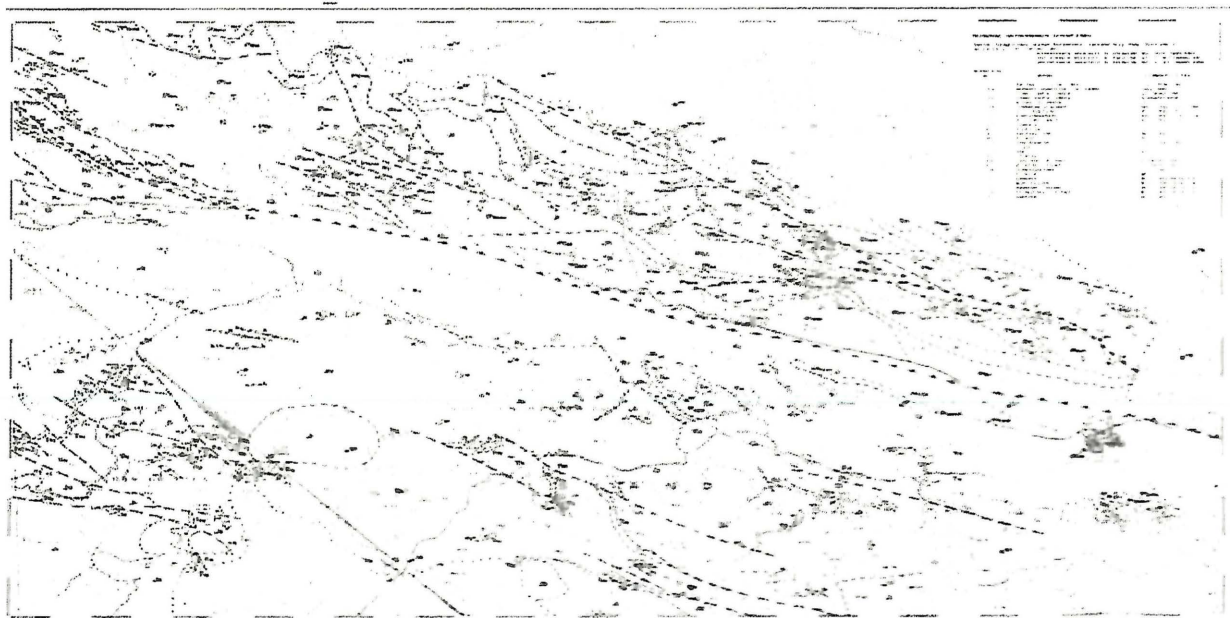



PROVINCE OF BRITISH COLUMBIA
MINISTRY OF ENERGY, MINES AND PETROLEUM RESOURCES
OPEN FILE 1987/2 SHEET 2 OF 9

GEOLOGY OF THE COMICHAN LAKE AREA
NTS 92C/16

Geology by N. W. D. Massey, S. T. Friday, P. Terrier and V. J. Rublee, 1986.

Includes geology from reports and maps by J. T. Fyles, A. Sutherland Brown and P. Cowley.

Compilation by N. W. D. Massey

LEGEND FOR SHEETS 3 - 9

INTRUSIVE ROCKS

AGE UNCERTAIN

MINOR INTRUSIONS



- A pyroxene-feldspar diabase (?Jurassic)
F feldspar, quartz-feldspar porphyry (?Paleozoic or Jurassic)
H hornblende-feldspar porphyry (?Jurassic or Tertiary)

LOWER TO MIDDLE JURASSIC

ISLAND INTRUSIONS



- a aplite
b mafic dykes
d diorite, gabbro
f feldspar porphyry
g granodiorite
M diorite with abundant mafic xenoliths
n granodiorite with abundant mafic xenoliths
z quartz diorite
z quartz monzonite

UPPER TRIASSIC



- SILLS AND DYKES (COEVAL WITH KARLUTSEN FORMATION)
i diabase and gabbro

VOLCANIC AND SEDIMENTARY ROCKS

UPPER CRETACEOUS

HANAIMO GROUP



- HASLAM FORMATION
a argillite, shale
s sandstone



- COMOX FORMATION
s sandstone, pebbly sandstone
g granule conglomerate
p pebble conglomerate
b boulder conglomerate
l limestone

LOWER JURASSIC



BOHAINA GROUP

- Sedimentary rocks
c conglomerate
s sandstone, granule sandstone
u argillite, siltstone +/- sulphides
l limestone, calcarenite

Volcanic rocks

- t tuff, sandy tuff
r maroon tuff, tuffaceous sandstone
p feldspar crystal tuff, lapilli tuff
k pyroxene-feldspar crystal lapilli tuff, breccia
n mafic tuff, lapilli tuff
h heterolithic lapilli tuff (mafic-intermediate)
j heterolithic lapilli tuff with limestone clasts
b heterolithic breccia
g monolithic lapilli tuff (mafic-intermediate)
e felsic lapilli tuff
o aphyric, massive mafic flow
c porphyritic basalt
f feldspar basalt, andesite (may be intrusive in part)
a andesite, porphyritic andesite
d dacite

UPPER TRIASSIC

VANCOUVER GROUP



- PARSON BAY FORMATION
t laminated tuff, tuffaceous argillite, argillite
l laminated siltstone, argillite
b lapilli tuff +/- felsic clasts
r calcarenite, sandy limestone
s flaggy limestone, biohermal limestone
p porcellaneous limestone



- QUATSINO FORMATION
q massive micrite
r bedded micrite, bedded calcirudite
u bioclastic micrite, sparite
c oolitic limestone
o hyaloclastite, hyaloclastite breccia with limestone clasts
t laminated tuff, tuffaceous argillite, argillite
l laminated siltstone, argillite



- KARLUTSEN FORMATION
m massive flows
g glomeroporphyritic flows
p pillowed flows
b pillow breccia
h hyaloclastite, hyaloclastite breccia
a glomeroporphyritic hyaloclastite breccias
c hyaloclastite, hyaloclastite breccia with limestone clasts
t laminated tuff, tuffaceous argillite, argillite
i diabase, gabbro dykes and sills

UPPER SILURIAN TO LOWER PERMIAN
SICKER GROUP



BUTTLE LAKE SUB-GROUP

- PSmm MOUNT MARK FORMATION
j limestone, crinoidal limestone, bedded limestone, marble
t intercalated thinly bedded sandstone, siltstone, argillite
c chert



CAMERON RIVER FORMATION

- c chert, cherty tuff
l laminated tuff, cherty tuff
t intercalated thinly bedded sandstone, siltstone, argillite
g graphitic argillite +/- sulphides
s massive tuffaceous sandstone
k lithic tuff, lithic tuffaceous sandstone
u epiclastic sandstone, granule and pebble conglomerate
h heterolithic conglomerate, breccia
z felsic tuff, crystal tuff
r rhyolite, dacite (flows and intrusions)

YOUBOU SUB-GROUP



MCLAUGHLIN RIDGE FORMATION

- s massive tuff, tuffaceous sandstone
k lithic tuff, lithic tuffaceous sandstone
u epiclastic sandstone, granule and pebble conglomerate
t intercalated thinly bedded sandstone, siltstone, argillite
l laminated tuff, cherty tuff
c chert, cherty tuff
f feldspar crystal tuff, lapilli tuff
a pyroxene crystal tuff, lapilli tuff
b pyroxene rich volcanic breccia, agglomerate
n heterolithic lapilli tuff, breccia
h heterolithic conglomerate
o massive aphyric mafic flows
q pyroxene porphyry (flows and intrusions)
d felsic lapilli tuff, crystal lapilli tuff
e felsic tuff, crystal tuff
r rhyolite, dacite (flows and intrusions)
w hornfelsed sediment (?sandstone)
y chlorite schist (protolith uncertain)
z maroon and green phyllite (protolith uncertain)



NITINAT FORMATION

- a pyroxene crystal tuff, lapilli tuff
b pyroxene rich volcanic breccia, agglomerate
m monolithic lapilli tuff, breccia
n heterolithic lapilli tuff, breccia
h heterolithic conglomerate, breccia
o massive aphyric mafic flows
p pillowed flows
q pyroxene porphyry (flows and intrusions)
f feldspar crystal tuff, lapilli tuff
d felsic lapilli tuff, crystal lapilli tuff
r rhyolite, dacite (flows and intrusions)
s massive tuff, tuffaceous sandstone
k lithic tuff, lithic tuffaceous sandstone
u epiclastic sandstone, granule and pebble conglomerate
l laminated tuff, cherty tuff
t intercalated thinly bedded sandstone, siltstone, argillite

Notes:

- a This is a field legend and applies to all seven 1:20 000 maps. Not all lithologies listed are present on each map.
b Position in the legend of lithologies within each formation does not imply any age or stratigraphic relationship.
c Where two or more lithologic codes are shown for an outcrop, the designated units are interbedded and are listed in approximate order of abundance. Where a comma is used to separate two or more lithologic codes, an intrusive relationship is implied.

SYMBOLS

- Geological contact (defined, approximate, transitional)
Limit of drift covered area
Limit of mapping
Bedding (horizontal, inclined, overturned)
Strike and dip of pillows, tops known
Schistosity (inclined, vertical)
Fault (defined, approximate)
Thrust fault (defined, approximate, assumed) teeth indicate upthrust side with dip indicated.
Shearing and dip.
Axes of minor folds.
Lineation of unknown age
S intersections.
Microcrenulation.
Anticline (with plunge indicated).
Syncline (with plunge indicated).
Fossil locality.

Index map for sheets 3-9

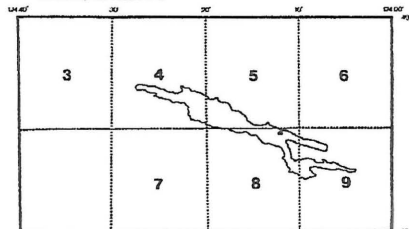

**GEOLOGY OF THE COVICHAN LAKE AREA
 NES 92C/16**

Geology by N. W. D. Massey, G. T. Friday, P. Torrier
 and V. J. Rublee, 1986.
 Includes geology from reports and maps by J. T. Pyle,
 A. Sutherland Brown and P. Crowley.
 Compilation by N. W. D. Massey



LEGEND

- INTRUSIVE ROCKS**
- MINOR INTRUSIONS (age unknown): pyroxene-feldspar diabase (A); feldspar porphyry (F); hornblende-feldspar porphyry (H)
 - JURASSIC ISLAND INTRUSIONS: diorite, granodiorite, quartz diorite often with abundant xenoliths, spilitic
 - TRIASSIC SILLS AND DYKES: diabase and gabbro (coeval with Harrison Formation)
- UPPER CRETACEOUS**
- KANINE GROUP
 (BASEL FORMATION): argillite, shale and minor sandstone
 - CLUSE FORMATIONS: boulder conglomerate, sandstone and conglomerate
- LOWER JURASSIC**
- BONANZA GROUP: feldspar basalt, andesite, dacite, tuff, sandy tuff, crystal tuff, lapilli tuff and breccia, with minor argillite and sandstone
- UPPER TRIASSIC**
- VANCOUVER GROUP
 VANCOUVER FORMATION: laminated siltstone, argillite, tuff, flaggy and bioheral limestone
 - QUATERNARY FORMATION: massive and bedded siltite, bioclastic siltite, laminated tuffaceous argillite and siltstone, hyaloclastite with limestone clasts
 - HARRISON FORMATION: pillowed and massive basaltic flows, hyaloclastite and hyaloclastite breccia
- UPPER SILURIAN TO LOWER PERMIAN**
- SICKER GROUP
 SICKER FORMATION: crystalline limestone, bedded limestone, marble, chert, cherty argillite and siltstone
 - GARDEN RIVER FORMATION: ribbon chert, cherty tuff, graphitic argillite, intercalated thin bedded sandstone, siltstone and argillite, epidotitic sandstone, conglomerate
 - MCLACHLAN RIDGE FORMATION: thickly bedded tuff, tuffaceous sandstone and lithic tuff, crystal tuff, heterolithic lapilli tuff and breccia, aphyric and pyroxene porphyritic flows, rhyolite, dacite, laminated tuff and chert
 - HITTINAT FORMATION: pyroxene-feldspar phyrlo conglomerate, breccias and lapilli tuff, massive and pillowed flows, massive tuffaceous sandstone, lithic tuff, laminated tuff and chert
- SYMBOLS**
- Geological contact (defined, approximate, transitions).....
 - Limit of drift covered area.....
 - Roof pendant (with code indicated; too small to map separately).....
 - Limit of mapping.....
 - Bedding (horizontal, inclined, overturned).....
 - bedding estimated from pillars (inclined).....
 - Schistosity (inclined, vertical).....
 - Fault (defined, approximate).....
 - Thrust fault (defined, approximate, assumed) teeth indicate upthrust side with dip indicated.....

LOCATION MAP

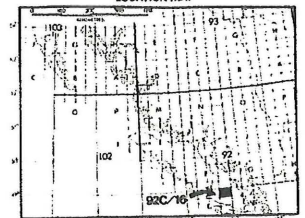

MINERAL OCCURRENCE LOCATIONS

Data compiled from Mineral Inventory Map 92C(16)
 Accuracy of location:
 accurate within a radius of 500 metres
 accurate within a radius of 1 kilometre
 accurate within a radius of 5 kilometres

MINIFILE NO.	NAME	COMMODITIES
13	Delphi (Jubilee)	Cu, Ag, Au
14	Mount Battle (Alice)	Cu, Mo
15	Covichan Lake	Li-crostone
16	Covichan Lake	limestone
17	Blue Grouse	Cu
18	Conogo (Anne)	Au, Ag, Cu, Mo
19	St. Coplan	Au, Ag, Cu
20	Cottonwood	Au, Ag, Cu, Co
21	Silverleaf	Au, Ag, Cu
22	Loery	Cu
23	Vahine	Cu
24	Vallet Pot	Au, Ag, Cu
25	Ingot	Au
26	St. Coplan	Cu, Au, Ag
27	Katerston	Cu, Au, Ag
28	Fogg	Cu, Pb, Zn
29	AB	Cu
30	Candy	Cu
31	Garden River	limestone
32	Nixon Creek	limestone
33	Sunnyvale	Cu, Ag
34	Cluse	Mo
35	Rocky	Mo, Rhodochite
36	Wardroper	Mo, Rhodochite
37	Meade Creek	Mo, Rhodochite
38	Hanley Creek	Mo, Rhodochite
39	Amec	Au, Ag

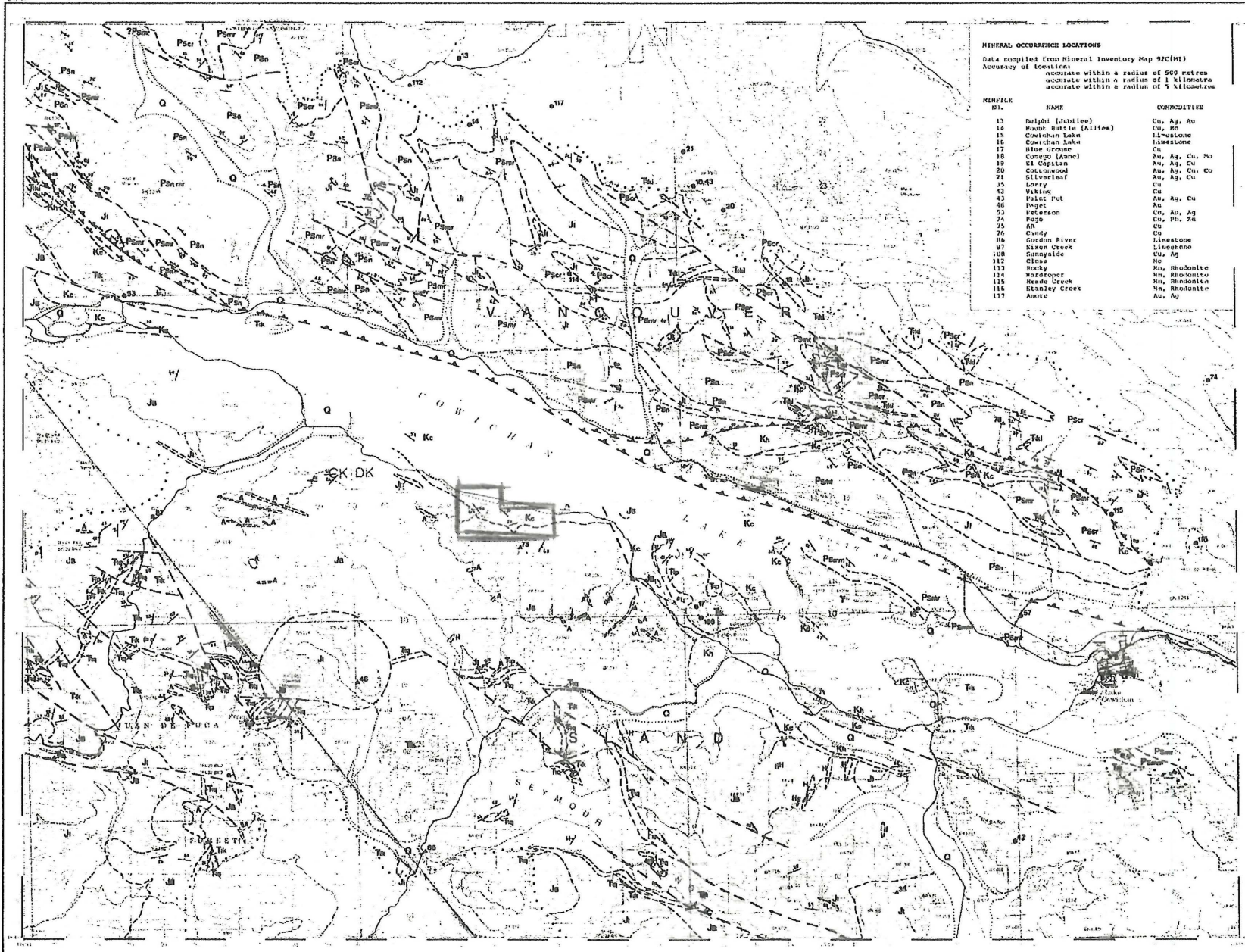



**Le Baron Prospecting
Port Renfrew BC**

History:

There is a lot of area history when it comes to mineral exploration within the Cowichan Lake area. The best documentation is the historic Blue Grouse Copper Mine which is located 5 kilometers east of this mineral tenure in an area known as the Gordon Bay on the Cowichan Lake.

According to the Annual Report of the Ministry of Energy and Mines, exploration began on this massive sulphide deposit in 1906 that work on the Blue Grouse and Sunny Side tenures consisted of trenching and open cut work with the first tunnel passing through an ill-defined body of copper.

By 1917, according to the Annual Report of the Ministry of Energy and Mines 114 tons of ore were produced of which 9169 lbs of copper, and 7 ounces of Au. (Minfile # 092C108)

Then from 1917 to 1919 exploration on the Blue Grouse mine ramped up extensively with 2113 tons of ore mined from underground. (Minfile # 092C017)

In 1928, the property ownership changed hands with further underground exploration for several years.

In 1953 to 1960 the property produced 272,000 tons of high grade copper ore.

In 1964 to 1978 the property produced no copper ore due to hardship.

In 1979 to 1981 further underground exploration at the 2300 ft level a new discovery of a highly mineralized body of copper ore was discovered by drilling but underground work to remove the body was ceased.

From 1982 to 2002 several companies and individuals geochemical sampled both above and partially below ground the ore body and subsequent slag piles. 1988 the underground workings were determined by the forest companies to be hazardous and the entrance ways were in-filled.

2014 to 2017 only a limited amount of grass roots exploration has occurred on the original Blue Grouse Property.



**Le Baron Prospecting
Port Renfrew BC**

Exploration overview:

This assessment report will consist of five (5) appendixes. Each appendix will have its own individual work reference map and each of the appendix will discuss and describe from field notes provided by the operator to the author the work conducted at each of the five (5) work site locations. Specific physical work will be described as what work was conducted, tools used, and a brief discussion on the alluvial sample submitted for geochemical assessment.

At each of the work site locations a hole was excavated to a depth of approximately 5 feet to a width of 4 feet in the alluvial gravels by utilizing hand tools next to the creek bed just above the water flowing in the drainages. Each test hole excavated was approximately 1.5 cubic yards of alluvial rocks and gravels. The gravel was screened through two different screens and finally hand panned into a concentrate sent for analysis.

The holes were infilled back in with the alluvial rocks to prevent a tripping hazard.

The results of the Geochemical analysis are in this assessment report.

The summary of this exploration assessment will be discussed further in this assessment report.

Tools utilized:

GPS: - Lowrance global map – e-trek
compass – hand held
MTO field map
shovel
pick
large screen – (1.0cm mesh)
small screen – (0.5mm mesh)
gold pan
sample bags



Andy Claim - work site

locations
Legend

All Ortho Index

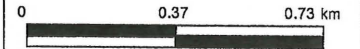

1: 18,056

Copyright/Disclaimer

The material contained in this web site is owned by the Government of British Columbia and protected by copyright law. It may not be reproduced or redistributed without the prior written permission of the Province of British Columbia. To request permission to reproduce all or part of the material on this web site please complete the Copyright Permission Request Form which can be accessed through the Copyright Information Page

CAUTION: Maps obtained using this site are not designed to assist in navigation. These maps may be generalized and may not reflect current conditions. Uncharted hazards may exist. DO NOT USE THESE MAPS FOR NAVIGATIONAL PURPOSES.

Datum: NAD83

Projection: WGS_1984_Web_Mercator_Auxiliary_Sphere

Key Map of British Columbia

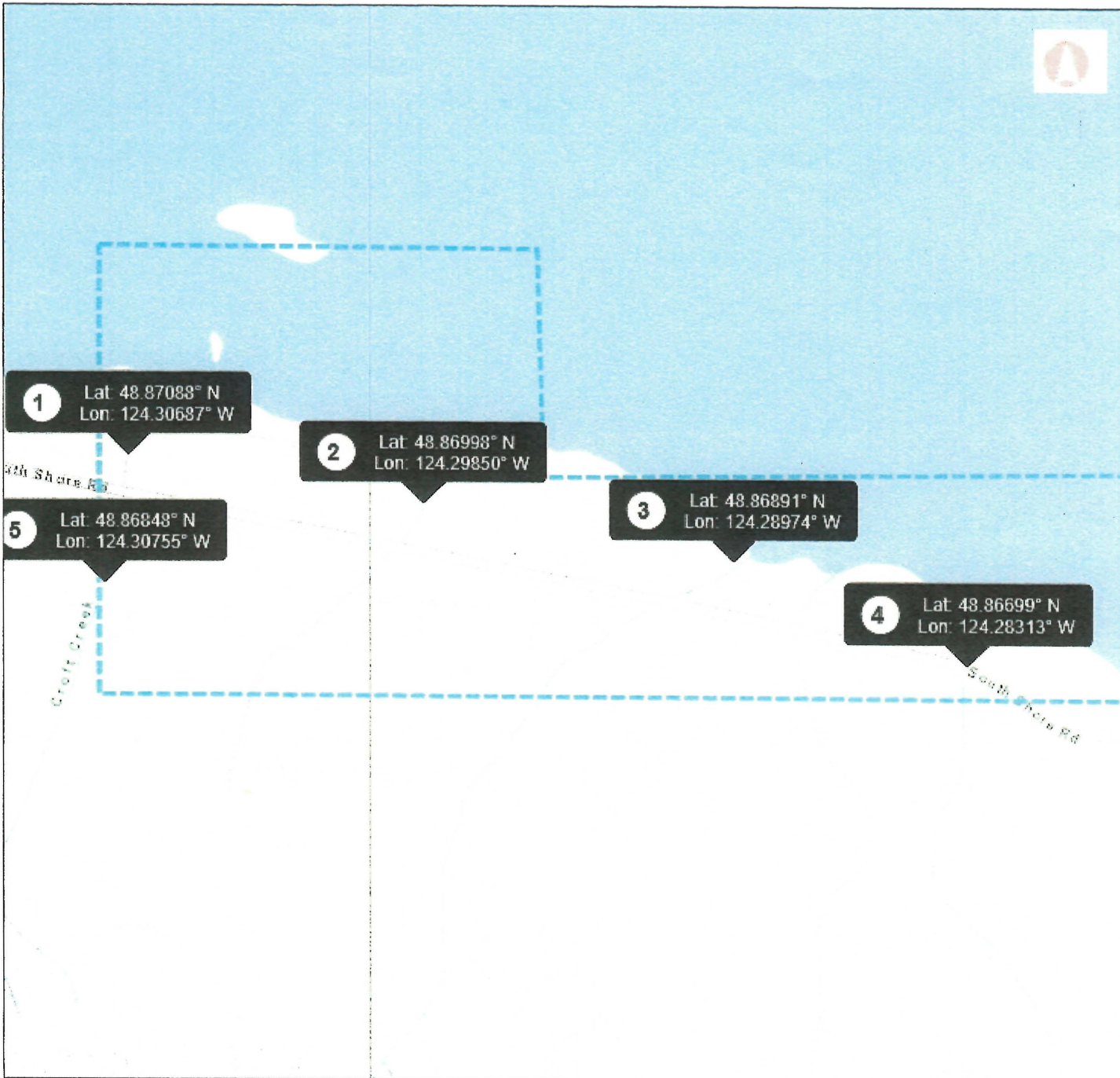

1 Lat: 48.87088° N
Lon: 124.30637° W

2 Lat: 48.86998° N
Lon: 124.29850° W

3 Lat: 48.86891° N
Lon: 124.28974° W

4 Lat: 48.86699° N
Lon: 124.28313° W

5 Lat: 48.86843° N
Lon: 124.30755° W

FIGURE MAP - 5

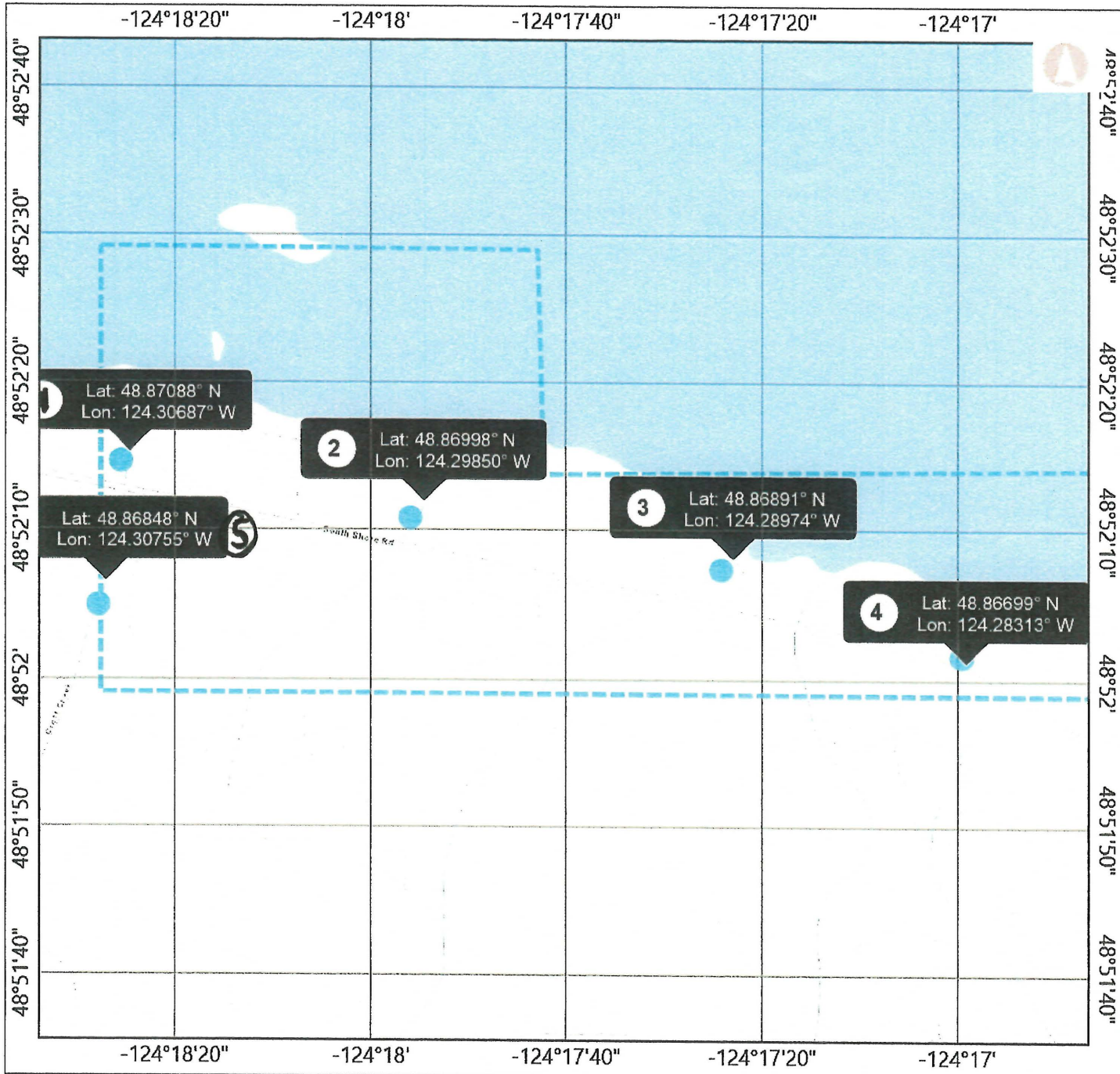

Andy Claim - ALS
sample site locations
Legend

All Ortho Index

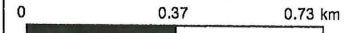

1: 18,056

Copyright/Disclaimer

The material contained in this web site is owned by the Government of British Columbia and protected by copyright law. It may not be reproduced or redistributed without the prior written permission of the Province of British Columbia. To request permission to reproduce all or part of the material on this web site please complete the Copyright Permission Request Form which can be accessed through the Copyright Information Page
CAUTION: Maps obtained using this site are not designed to assist in navigation. These maps may be generalized and may not reflect current conditions. Uncharted hazards may exist. **DO NOT USE THESE MAPS FOR NAVIGATIONAL PURPOSES.**

Datum: NAD83
 Projection: WGS_1984_Web_Mercator_Auxiliary_Sphere

Key Map of British Columbia





**Le Baron Prospecting
Port Renfrew BC**

Appendix A

Work site #1

GPS location

48'87088" N x 124'30687" W

ALS – Q029964

Figure map(s) 5, 6, 7

FIGURE MAP 7

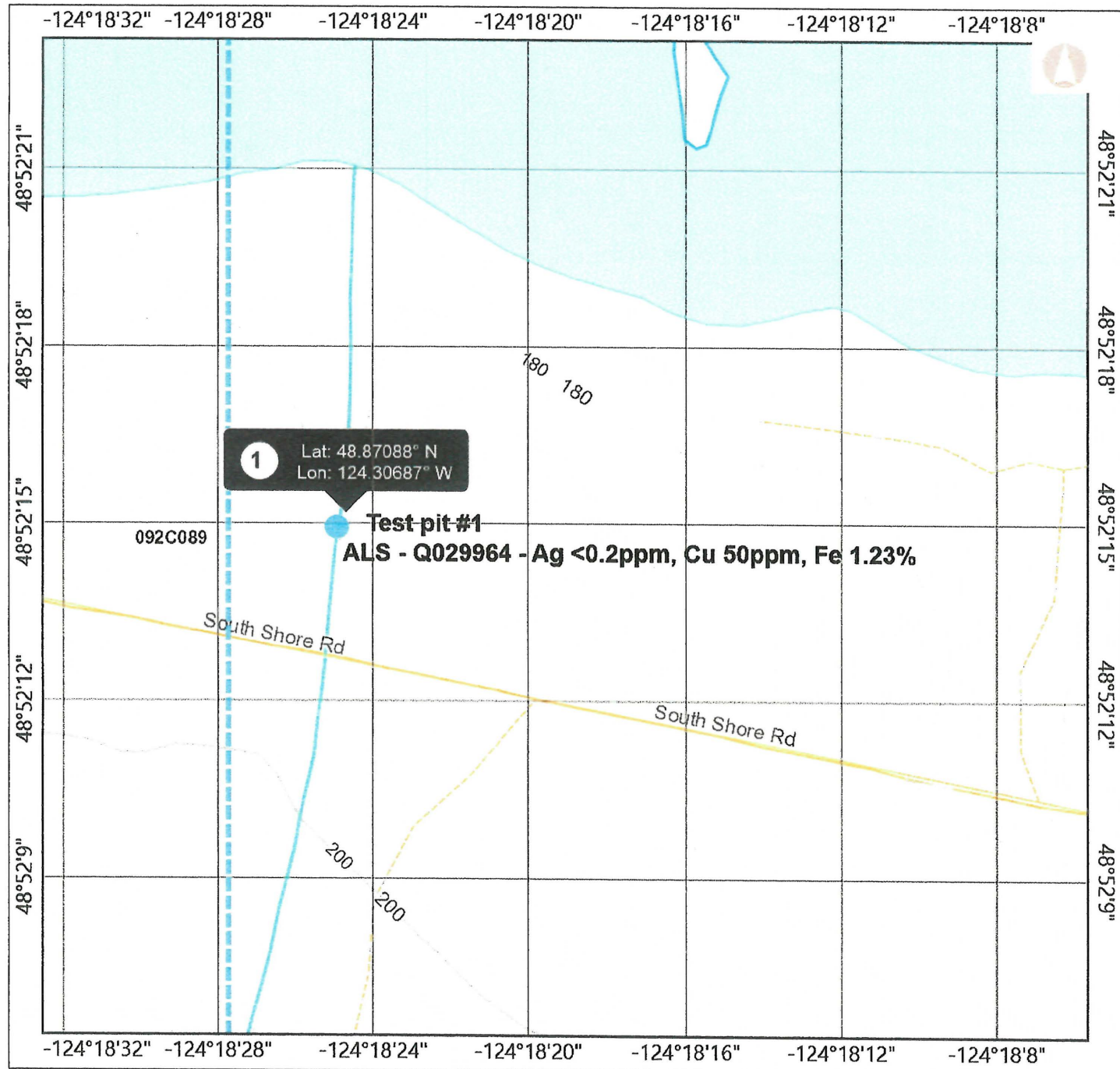

Andy Claim - ALS
sample site locations
Legend

- Elevation - Points (1:20,000', FCODE)
- Spot Height
 - Mountain Peak
- Geographic Names Points - FEATURE_TYPE
- Abandoned Locality
 - Airfield
 - Airport
 - Anchorage
 - Canadian Forces Base
 - City
 - Community
 - Cove

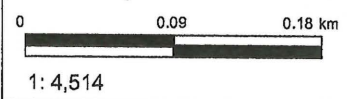

Copyright/Disclaimer

The material contained in this web site is owned by the Government of British Columbia and protected by copyright law. It may not be reproduced or redistributed without the prior written permission of the Province of British Columbia. To request permission to reproduce all or part of the material on this web site please complete the Copyright Permission Request Form which can be accessed through the Copyright Information Page

CAUTION: Maps obtained using this site are not designed to assist in navigation. These maps may be generalized and may not reflect current conditions. Uncharted hazards may exist. DO NOT USE THESE MAPS FOR NAVIGATIONAL PURPOSES.

Datum: NAD83
Projection: WGS_1984_Web_Mercator_Auxiliary_Sphere

Key Map of British Columbia

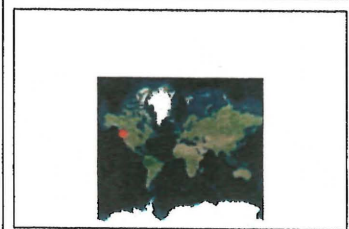



**Le Baron Prospecting
Port Renfrew BC**

Work site #1

See Figure reference map # 7

Date(s) – April 14th to 15th

Andy Halusiahk

S. Ludvickson

This work site is located 100 meters north of the South Shore Road, it is located on the east side of the creek bed, the creek was flowing somewhat at the time of exploration yet it was well below the high water flow level that can occur during the rainy months, the steep gradient farther south can attribute to a quickly rising creek bed that can also lessen to a small flow and to a dry creek bed during the summer months too.

A test hole was excavated and returned to near original state over the course of two days of hand work.

The test hole was excavated below the high-water mark yet outside of the creek flow. Large boulders were encountered and moved out of the way, the alluvial gravels were screened onto a tarp and then further screened through a smaller screen and then finally hand panned into a concentrate.

The test hole final depth was 4' (feet) and the width was 5'(feet), that is approximately 0.75 cubic yards of material moved (including alluvial rocks) with a total amount 10 (ten) five-gallon buckets of alluvial gravel, prior to fine screening which resulted into a half of a five-gallon bucket of material to be hand panned into a concentrate.

The resulting concentrate weighed into a 0.84kg (1.85 lbs) of concentrate submitted for analysis.

ALS – Q029964 – Ag <0.2ppm threshold, Cu 50ppm (minor elevation of threshold), Fe 1.23% (minor elevation of threshold)

No Au was discovered in the concentrate or geochemical analyzed for at this location.

The alluvial gravels at this location possibly are of great depth, no significant mineralization was discovered.

The test pit was back filled with the alluvial rock.

Future exploration of this specific area is not warranted at this time.



**Le Baron Prospecting
Port Renfrew BC**

Appendix B

Work site #2

GPS location

48'86998" N x 124'298850" W

ALS – Q029965

Figure maps 5, 6, 8

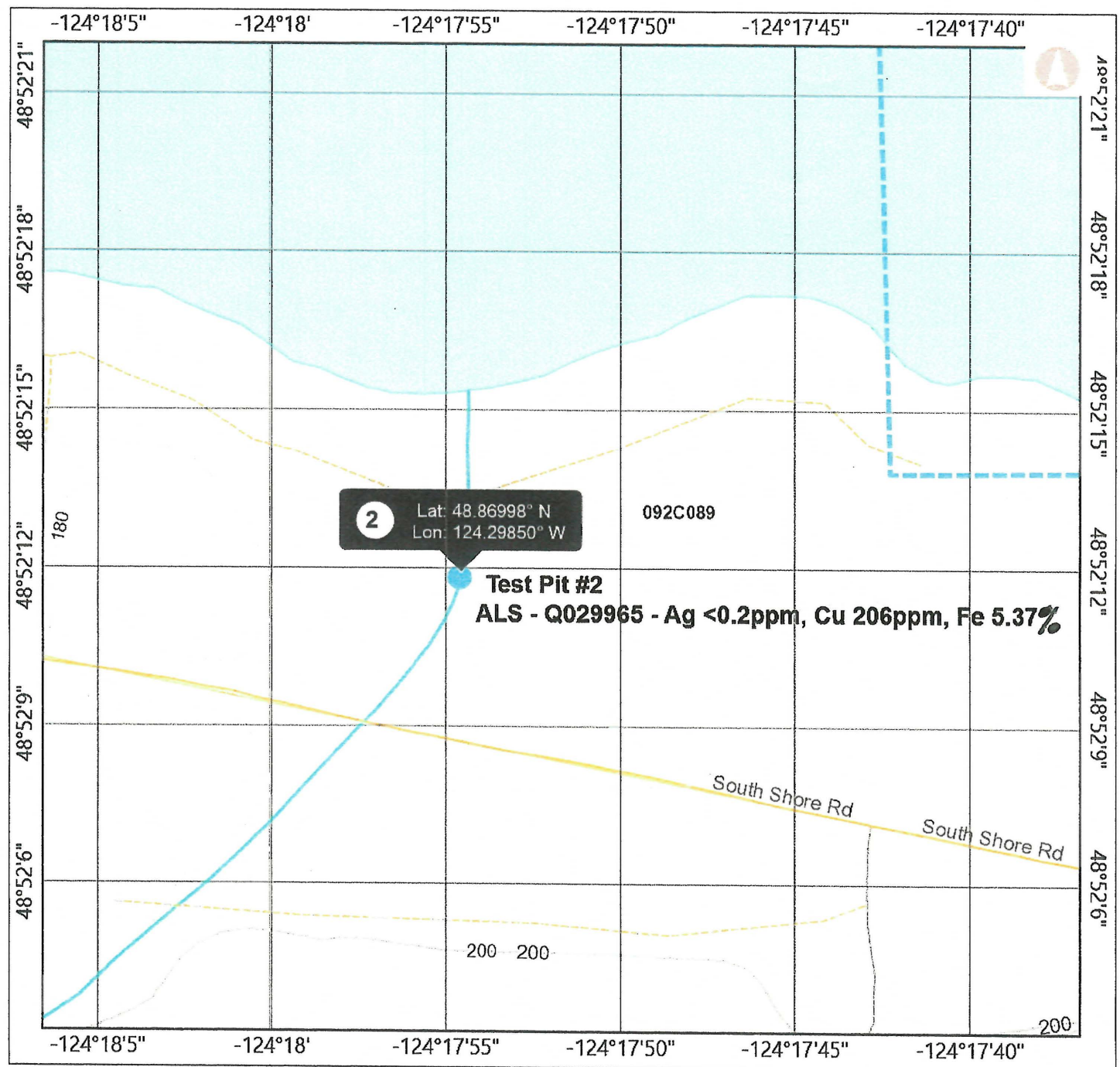

Andy Claim - ALS
sample site locations
Legend

- Elevation - Points (1:20,000),
FCODE
- ⋮ Spot Height
 - ⋮ Mountain Peak
- Geographic Names Points -
FEATURE_TYPE
- ◆ Abandoned Locality
 - ✈ Airfield
 - ✈ Airport
 - ◆ Anchorage
 - Canadian Forces Base
 - City
 - Community
 - + Cone

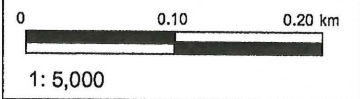

Copyright/Disclaimer

The material contained in this web site is owned by the Government of British Columbia and protected by copyright law. It may not be reproduced or redistributed without the prior written permission of the Province of British Columbia. To request permission to reproduce all or part of the material on this web site please complete the Copyright Permission Request Form which can be accessed through the Copyright Information Page

CAUTION: Maps obtained using this site are not designed to assist in navigation. These maps may be generalized and may not reflect current conditions. Uncharted hazards may exist. DO NOT USE THESE MAPS FOR NAVIGATIONAL PURPOSES.

Datum: NAD83
Projection: WGS_1984_Web_Mercator_Auxiliary_Sphere

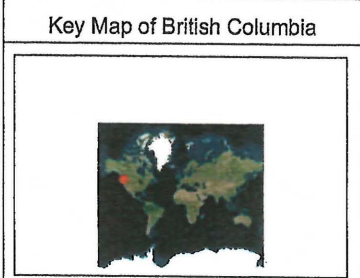



**Le Baron Prospecting
Port Renfrew BC**

Work site #2

See Figure reference map # 8

Date(s) – April 16th to 17th

Andy Halusiahk

S. Ludvickson

This work site is located 175 meters north of the South Shore Road, it is located on the east side of the creek bed, the creek was flowing somewhat at the time of exploration yet it was well below the high water flow level that can occur during the rainy months, the steep gradient farther south can attribute to a quickly rising creek bed that can also lessen to a small flow and to a dry creek bed during the summer months too.

A test hole was excavated and returned to near original state over the course of two days of hand work.

The test hole was excavated at the high-water mark outside of the creek flow. Large boulders were encountered and moved out of the way, the alluvial gravels were screened onto a tarp and then further screened through a smaller screen and then finally hand panned into a concentrate.

The test hole was hand dug to a depth of 6' (feet) with a width of 5' (feet) equals approximately 1.1 cubic yards of alluvial material moved. This resulted in 10 five-gallon buckets of screened alluvial gravel placed onto a tarp and then further screened through a finer screen into a five-gallon bucket of fine material which was then hand panned into a concentrate

The resulting concentrate weighed into 0.62kg or (1.36) lbs sample submitted for geochemical analysis.

ALS – Q029965 – Ag <0.2ppm (threshold), Cu 206ppm (minor to medium threshold), Fe 5.37% (moderate threshold).

Very minor, very fine Au was discovered in the concentrate, No Au geochemical analyzed for at this location.

The alluvial gravels at this location possibly are of great depth, no significant mineralization was discovered.

The test pit was back filled with the alluvial rock.

Future exploration of this specific area is not warranted at this time.



**Le Baron Prospecting
Port Renfrew BC**

Appendix C

Work site #3

GPS location

48'86891" N x 124'28973" W

ALS – Q029966

Figure maps 5, 6, 9

FIGURE MAP 9

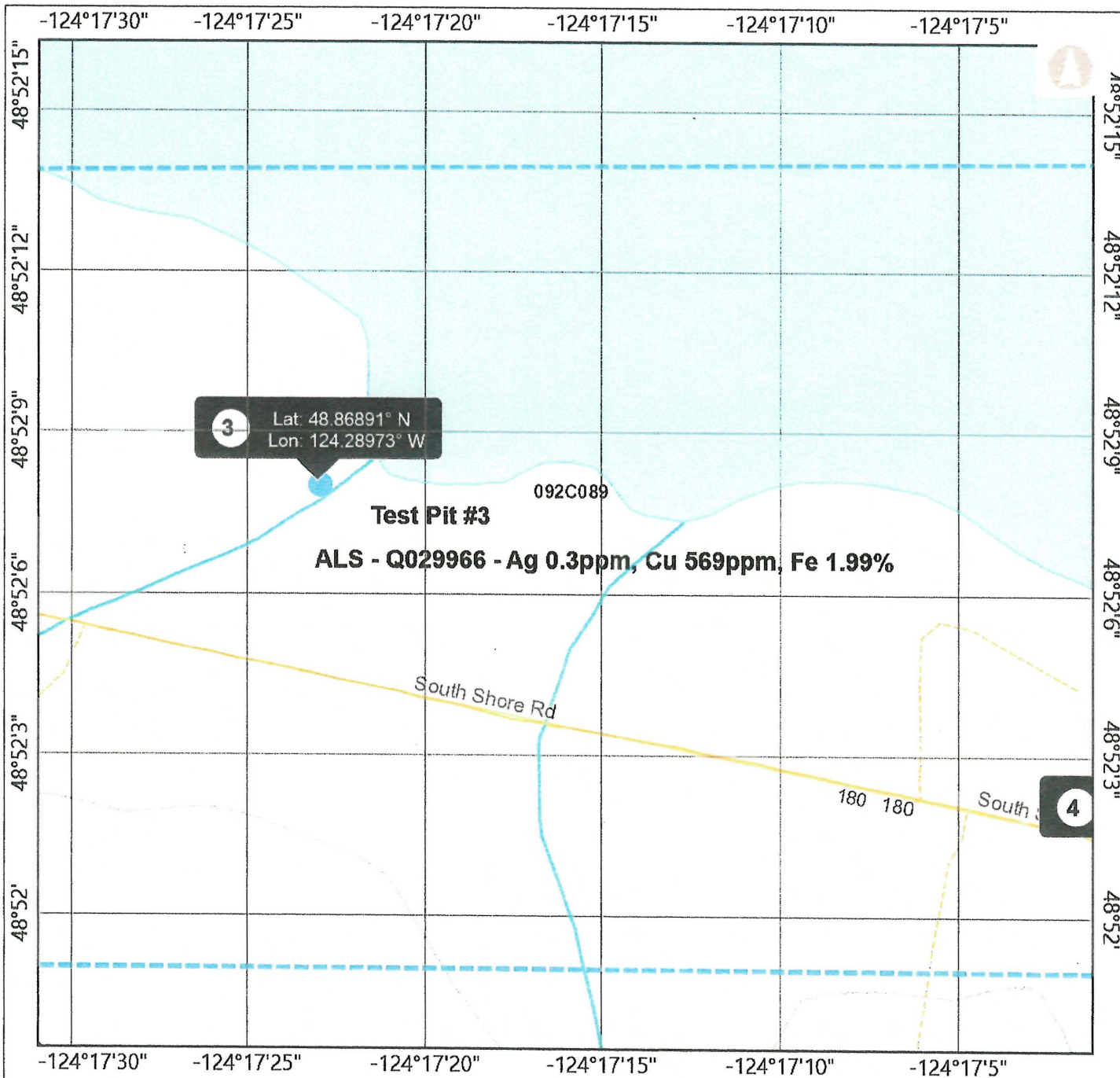

Andy Claim - ALS
sample site locations
Legend

Elevation - Points (1:20,000)

FCODE

Spot Height

Mountain Peak

Geographic Names Points -

FEATURE_TYPE

Abandoned Locality

Airfield

Airport

Anchorage

Canadian Forces Base

City

Community

Cone

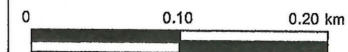

1: 5,000

Copyright/Disclaimer

The material contained in this web site is owned by the Government of British Columbia and protected by copyright law. It may not be reproduced or redistributed without the prior written permission of the Province of British Columbia. To request permission to reproduce all or part of the material on this web site please complete the Copyright Permission Request Form which can be accessed through the Copyright Information Page.

CAUTION: Maps obtained using this site are not designed to assist in navigation. These maps may be generalized and may not reflect current conditions. Uncharted hazards may exist. DO NOT USE THESE MAPS FOR NAVIGATIONAL PURPOSES.

Datum: NAD83

Projection: WGS_1984_Web_Mercator_Auxiliary_Sphere

Key Map of British Columbia





**Le Baron Prospecting
Port Renfrew BC**

Work site #3

See Figure reference map # 9

Date(s) – April 18th

Andy Halusiahk

S. Ludvickson

This work site is located 275 meters north of the South Shore Road, it is located on the east side of the creek bed, the creek was flowing somewhat at the time of exploration yet it was well below the high water flow level that can occur during the rainy months, the steep gradient farther south can attribute to a quickly rising creek bed that can also lessen to a small flow and to a dry creek bed during the summer months too.

A test hole was excavated and returned to near original state over the course of one day of hand work.

The test hole was excavated at the high-water mark outside of the creek flow. Large boulders were encountered and moved out of the way, the alluvial gravels were screened onto a tarp and then further screened through a smaller screen and then finally hand panned into a concentrate.

The smaller test hole was hand dug to a depth of 4' (feet) with a width of 3' (feet) equals approximately 0.5 cubic yards of alluvial material moved. This resulted in 6 five-gallon buckets of screened alluvial gravel placed onto a tarp and then further screened through a finer screen into a five-gallon bucket of fine material which was then hand panned into a concentrate

The resulting concentrate weighed into 0.68kg or (1.78) lbs sample submitted for geochemical analysis.

ALS – Q029966 – Ag 0.3 ppm (threshold), Cu 569ppm (medium to moderate threshold), Fe 1.99% (low threshold)

Very minor, very fine Au was discovered in the concentrate, No Au geochemical analyzed for at this location.

The alluvial gravels at this location possibly are of great depth, no significant mineralization was discovered.

The test pit was back filled with the alluvial rock.

Future exploration of this specific area is not warranted at this time.



**Le Baron Prospecting
Port Renfrew BC**

Appendix D

Work site #4

GPS location

48'86699" N x 124'28313" W

ALS – Q029967

Figure maps 5, 6, 10

FIGURE MAP #10

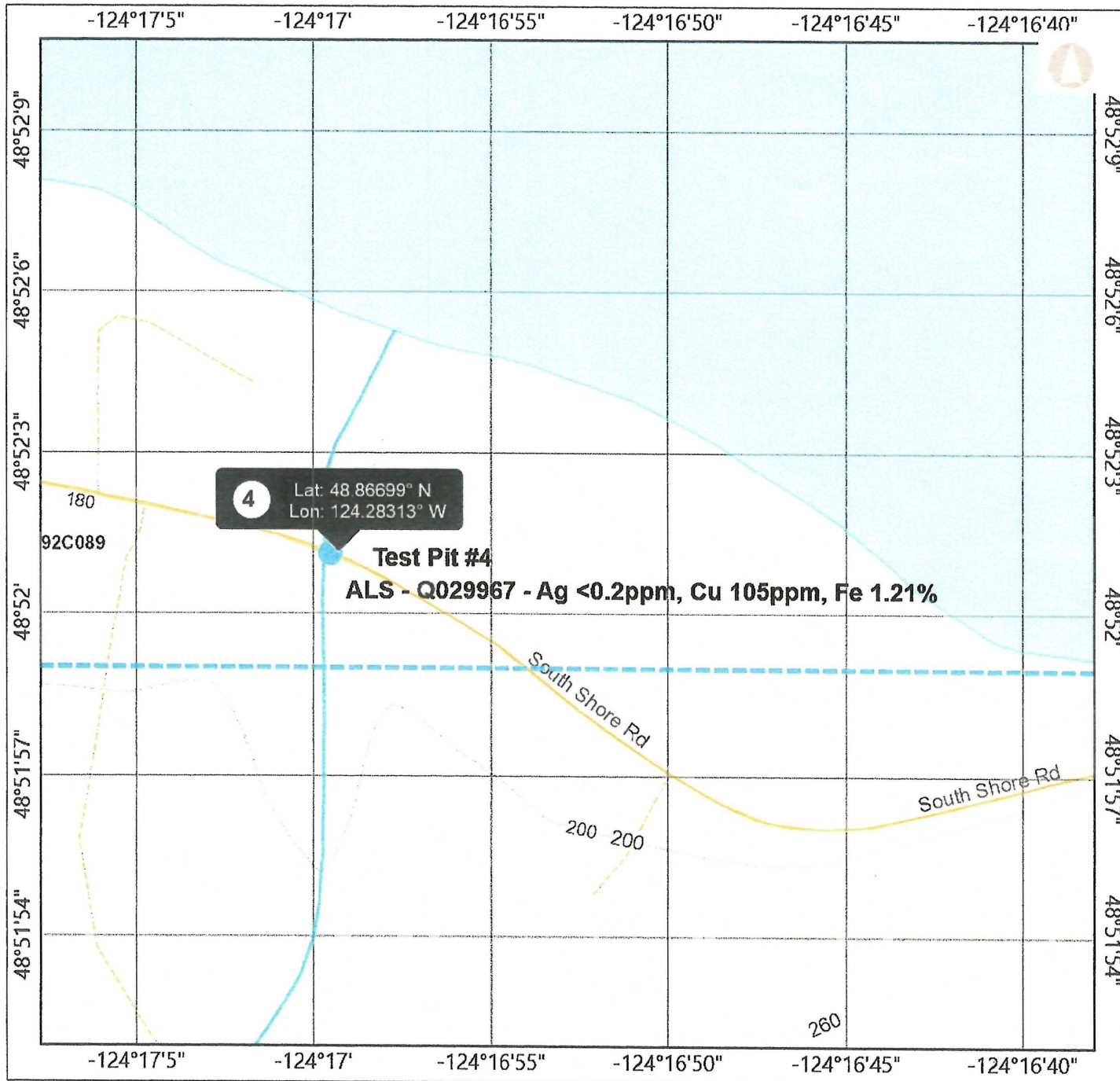

Andy Claim - ALS
 sample site locations
Legend

Elevation - Points (1:20,000',
 FCODE

- ⋮ Spot Height
- ⋮ Mountain Peak

Geographic Names Points -
 FEATURE_TYPE

- ⦿ Abandoned Locality
- ⊕ Airfield
- ✈ Airport
- ⦿ Anchorage
- Canadian Forces Base
- City
- Community
- + Cone

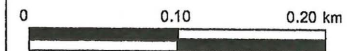

1: 5,000

Copyright/Disclaimer

The material contained in this web site is owned by the Government of British Columbia and protected by copyright law. It may not be reproduced or redistributed without the prior written permission of the Province of British Columbia. To request permission to reproduce all or part of the material on this web site please complete the Copyright Permission Request Form which can be accessed through the Copyright Information Page

CAUTION: Maps obtained using this site are not designed to assist in navigation. These maps may be generalized and may not reflect current conditions. Uncharted hazards may exist. DO NOT USE THESE MAPS FOR NAVIGATIONAL PURPOSES.

Datum: NAD83

Projection: WGS_1984_Web_Mercator_Auxiliary_Sphere

Key Map of British Columbia





**Le Baron Prospecting
Port Renfrew BC**

Work site #4

See Figure reference map # 10

Date(s) – April 19th

Andy Halusiahk

S. Ludvickson

This work site is located 5 meters south of the South Shore Road, (upstream side of the creek), it is located on the east side of the creek bed, the creek was flowing somewhat at the time of exploration yet it was well below the high water flow level that can occur during the rainy months, the steep gradient farther south can attribute to a quickly rising creek bed that can also lessen to a small flow and to a dry creek bed during the summer months too.

A test hole was excavated and returned to near original state over the course of one day of hand work.

The test hole was excavated at the high-water mark outside of the creek flow. Large boulders were encountered and moved out of the way, the alluvial gravels were screened onto a tarp and then further screened through a smaller screen and then finally hand panned into a concentrate.

The smaller test hole was hand dug to a depth of 4' (feet) with a width of 4'(feet) equals approximately 0.6 cubic yards of alluvial material moved. This resulted in 8 five-gallon buckets of screened alluvial gravel placed onto a tarp and then further screened through a finer screen into a five-gallon bucket of fine material which was then hand panned into a concentrate

The resulting concentrate weighed into 1.12kg or (2.46) lbs sample submitted for geochemical analysis.

ALS – Q029967 – Ag <0.2ppm (threshold), Cu 105 ppm (low to low moderate threshold), Fe 1.21% (low threshold)

No Au was discovered in the concentrate, No Au geochemical analyzed for at this location.

The alluvial gravels at this location possibly are of great depth, no significant mineralization was discovered.

The test pit was back filled with the alluvial rock.

Future exploration of this specific area is not warranted at this time.



**Le Baron Prospecting
Port Renfrew BC**

Appendix E

Work site #5

GPS location

48'86848" N x 124'30755" W

ALS – Q029963

Figure maps 5, 6, 11

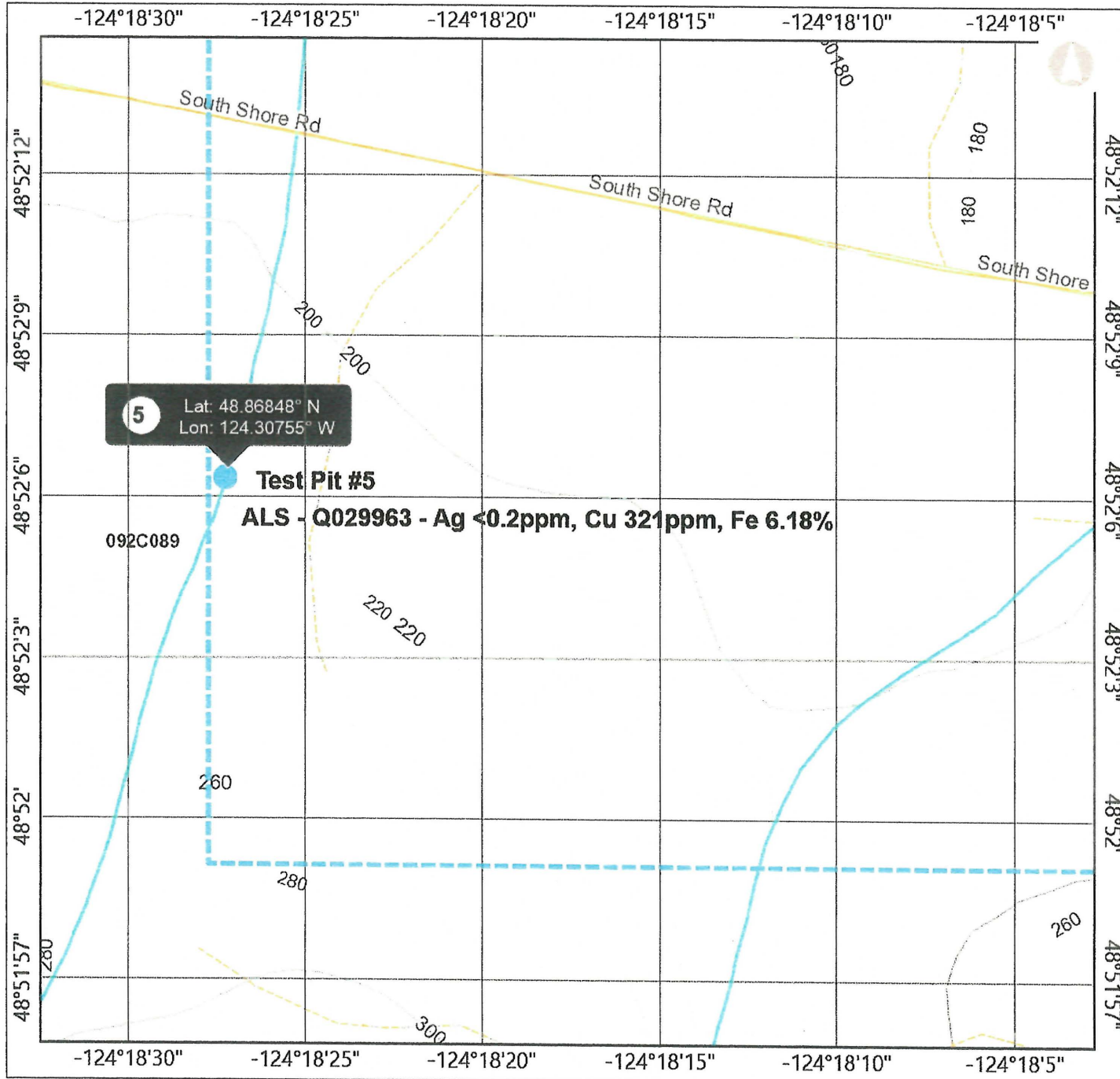

**Andy Claim - ALS
sample site locations
Legend**

Elevation - Points (1:20,000',
FCODE

- ⋮ Spot Height
- ⋮ Mountain Peak

Geographic Names Points -
FEATURE_TYPE

- ◆ Abandoned Locality
- ⊕ Airfield
- ✈ Airport
- ◆ Anchorage
- Canadian Forces Base
- City
- Community
- + Cone

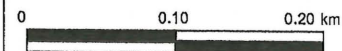

1: 5,000

Copyright/Disclaimer

The material contained in this web site is owned by the Government of British Columbia and protected by copyright law. It may not be reproduced or redistributed without the prior written permission of the Province of British Columbia. To request permission to reproduce all or part of the material on this web site please complete the Copyright Permission Request Form which can be accessed through the Copyright Information Page.

CAUTION: Maps obtained using this site are not designed to assist in navigation. These maps may be generalized and may not reflect current conditions. Uncharted hazards may exist. DO NOT USE THESE MAPS FOR NAVIGATIONAL PURPOSES.

Datum: NAD83
Projection: WGS_1984_Web_Mercator_Auxiliary_Sphere

Key Map of British Columbia





Le Baron Prospecting
Port Renfrew BC

Work site #5

See Figure reference map # 11

Date(s) – April 20th

Andy Halusiahk

S. Ludvickson

This work site is located 350 meters south of the South Shore Road, (upstream side of the creek), it is located on the east side of the creek bed, directly on the tenure western tenure boundary, (marked in field), the creek was flowing somewhat at the time of exploration yet it was well below the high water flow level that can occur during the rainy months, the steep gradient farther south can attribute to a quickly rising creek bed that can also lessen to a small flow and to a dry creek bed during the summer months too.

A test hole was excavated and returned to near original state over the course of one days of hand work.

The test hole was excavated at the high-water mark outside of the creek flow. Large boulders were encountered and moved out of the way, the alluvial gravels were screened onto a tarp and then further screened through a smaller screen and then finally hand panned into a concentrate.

The test hole was hand dug to a depth of 5' (feet) with a width of 5'(feet) equals approximately 0.96 cubic yards of alluvial material moved. This resulted in 5 five-gallon buckets of screened alluvial gravel placed onto a tarp and then further screened through a finer screen into a five-gallon bucket of fine material which was then hand panned into a concentrate

The resulting concentrate weighed into 0.74kg or (1.63) lbs sample submitted for geochemical analysis.

ALS – Q029963 – Ag <0.2ppm (threshold), Cu 321 ppm (low moderate threshold), Fe 6.18% (low moderate threshold)

Fine Au was discovered in the concentrate, with three smaller flakes, No Au geochemical analyzed for at this location.

Note:

Scott Phillips (field observation) – April 21st 2018

The alluvial gravels in this test area are more oxidized, just outside of the tenure, 25 meters south / west, there is a minor bedrock exposure in the creek bed, this area is oxidized. A rock chip / hand grab of the bedrock exposure is described as to contain minor chalcopyrite and pyrite, with blebs of bornite, there is also small eroded and weathered quartz veins in the bedrock exposure.

The alluvial gravels at this location possibly are definitely changing, there is much larger alluvial rock, less structured, depth of the alluvial is unknown at this location, however it is assumed to deep, but there is much more oxidization of the alluvias, no other significant mineralization was discovered.

The test pit was back filled with the alluvial rock.

Future exploration of this specific area is not warranted at this time.



**Le Baron Prospecting
Port Renfrew BC**

Conclusion / recommendations

It can be concluded that no significant areas of mineralization exists within the mineral tenure # 1051065.

Its not to say that with further sampling outside of the creek and high water limits there maybe an ore body, however the author of this report after spending one day (April 21st 2018) traversing and following up on the actual physical work conducted in field by the tenure owner(s) and labor for verification of this assessment report, one can comfortably state that other than the massive amounts of alluvial gravels that is present on the tenure, there is no other significant mineralization and the author can only recommend to the majority tenure owner to continue to maintain the tenure in good standing for the future.

Other than the potential for gravel extraction in a portion of the tenure south of the South Shore Cowichan Road (portion of lot 1, portion of lot 2 and a portion of lot 3). There are some mineralized exposures outside of the southern portion of the tenure, where rock crop exposures are exposed; it may be a source of the down stream sediment mineralization within the tenure.

Without the aid of a gravel extraction drill (rotary disc) to drill sample pits to depth in the southern portion of the tenure it is unknown at this time the abundance of good glacial gravel that is present. For the most part the gravel is clean, with very little glacial clay observed.



Le Baron Prospecting
Port Renfrew BC

Appendix F

ALS Certificates of analysis

VA18265756

VA18265758

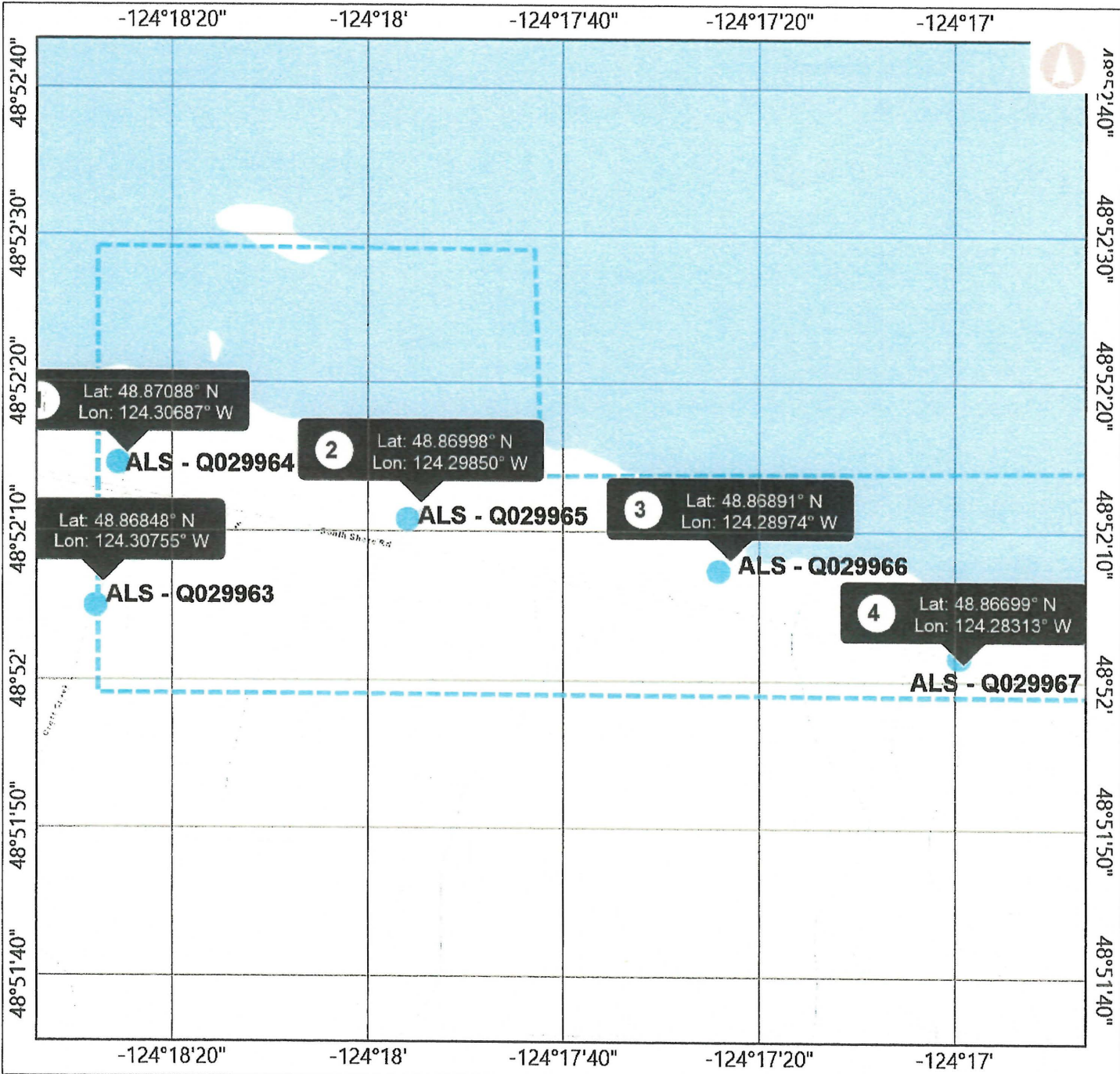

Andy Claim - ALS
sample site locations
Legend

All Ortho Index

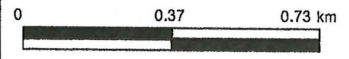

1: 18,056

Copyright/Disclaimer

The material contained in this web site is owned by the Government of British Columbia and protected by copyright law. It may not be reproduced or redistributed without the prior written permission of the Province of British Columbia. To request permission to reproduce all or part of the material on this web site please complete the Copyright Permission Request Form which can be accessed through the Copyright Information Page.
CAUTION: Maps obtained using this site are not designed to assist in navigation. These maps may be generalized and may not reflect current conditions. Uncharted hazards may exist. DO NOT USE THESE MAPS FOR NAVIGATIONAL PURPOSES.

Datum: NAD83
Projection: WGS_1984_Web_Mercator_Auxiliary_Sphere

Key Map of British Columbia





ALS Canada Ltd.
2103 Dollarton Hwy
North Vancouver BC V7H 0A7
Phone: +1 (604) 984 0221 Fax: +1 (604) 984 0218
www.alsglobal.com/geochemistry

To: LE BARON PROSPECTING
3317 HENRY ROAD
CHEMAINUS BC V0R 1K4

Page: 1
Total # Pages: 2 (A - C)
Plus Appendix Pages
Finalized Date: 1-NOV-2018
This copy reported on
2-NOV-2018
Account: LEBPRO

CERTIFICATE VA18265758

Project: Caycuse Mineral Project

This report is for 4 Rock samples submitted to our lab in Vancouver, BC, Canada on 20-OCT-2018.

The following have access to data associated with this certificate:

SCOTT PHILLIPS

SAMPLE PREPARATION

ALS CODE	DESCRIPTION
WEI-21	Received Sample Weight
LOG-21	Sample logging - ClientBarCode
CRU-31	Fine crushing - 70% <2mm
SPL-21	Split sample - riffle splitter
PUL-31	Pulverize split to 85% <75 um
CRU-QC	Crushing QC Test
PUL-QC	Pulverizing QC Test

ANALYTICAL PROCEDURES

ALS CODE	DESCRIPTION	INSTRUMENT
ME-ICP41	35 Element Aqua Regia ICP-AES	ICP-AES

This is the Final Report and supersedes any preliminary report with this certificate number. Results apply to samples as submitted. All pages of this report have been checked and approved for release.

***** See Appendix Page for comments regarding this certificate *****

Signature:

Colin Ramshaw, Vancouver Laboratory Manager



ALS Canada Ltd.
 2103 Dollarton Hwy
 North Vancouver BC V7H 0A7
 Phone: +1 (604) 984 0221 Fax: +1 (604) 984 0218
 www.alsglobal.com/geochemistry

To: LE BARON PROSPECTING
 3317 HENRY ROAD
 CHEMAINUS BC V0R 1K4

Page: 2 - A
 Total # Pages: 2 (A - C)
 Plus Appendix Pages
 Finalized Date: 1-NOV-2018
 Account: LEBPRO

Project: Caycuse Mineral Project

CERTIFICATE OF ANALYSIS VA18265758

Sample Description	Method Analyte Units LOD	WEI-21	ME-ICP41	ME-ICP41	ME-ICP41	ME-ICP41	ME-ICP41	ME-ICP41	ME-ICP41	ME-ICP41	ME-ICP41	ME-ICP41	ME-ICP41	ME-ICP41	ME-ICP41	ME-ICP41
		Recvd Wt. kg	Ag ppm	Al %	As ppm	B ppm	Ba ppm	Be ppm	Bi ppm	Ca %	Cd ppm	Co ppm	Cr ppm	Cu ppm	Fe %	Ga ppm
Q029964		0.84	<0.2	2.49	3	<10	50	<0.5	<2	2.51	<0.5	12	13	50	1.23	10
Q029965		0.62	<0.2	1.77	6	<10	10	<0.5	2	0.34	<0.5	54	1200	206	5.37	10
Q029966		0.68	0.3	6.68	4	<10	90	<0.5	4	6.25	<0.5	24	65	569	1.99	10
Q029967		1.12	<0.2	1.52	<2	<10	70	<0.5	<2	3.52	<0.5	5	23	105	1.21	<10



ALS Canada Ltd.
 2103 Dollarton Hwy
 North Vancouver BC V7H 0A7
 Phone: +1 (604) 984 0221 Fax: +1 (604) 984 0218
 www.alsglobal.com/geochemistry

To: LE BARON PROSPECTING
 3317 HENRY ROAD
 CHEMAINUS BC V0R 1K4

Page: 2 - B
 Total # Pages: 2 (A - C)
 Plus Appendix Pages
 Finalized Date: 1-NOV-2018
 Account: LEBPRO

Project: Caycuse Mineral Project

CERTIFICATE OF ANALYSIS VA18265758

Sample Description	Method Analyte Units LOD	ME-ICP41	ME-ICP41	ME-ICP41	ME-ICP41	ME-ICP41	ME-ICP41	ME-ICP41	ME-ICP41	ME-ICP41	ME-ICP41	ME-ICP41	ME-ICP41	ME-ICP41	ME-ICP41	ME-ICP41
		Hg ppm	K %	La ppm	Mg %	Mn ppm	Mo ppm	Na %	Ni ppm	P ppm	Pb ppm	S %	Sb ppm	Sc ppm	Sr ppm	Th ppm
		1	0.01	10	0.01	5	1	0.01	1	10	2	0.01	2	1	1	20
Q029964		<1	0.07	<10	0.34	73	1	0.21	21	1040	<2	0.42	<2	3	275	<20
Q029965		<1	0.03	<10	3.83	207	1	0.03	371	140	<2	<0.01	<2	3	5	<20
Q029966		<1	0.07	<10	2.97	369	<1	0.16	197	130	<2	0.02	<2	1	384	<20
Q029967		<1	0.19	<10	0.55	365	1	0.06	25	260	<2	0.15	<2	1	252	<20



ALS Canada Ltd.
 2103 Dollarton Hwy
 North Vancouver BC V7H 0A7
 Phone: +1 (604) 984 0221 Fax: +1 (604) 984 0218
 www.alsglobal.com/geochemistry

To: LE BARON PROSPECTING
 3317 HENRY ROAD
 CHEMAINUS BC V0R 1K4

Page: 2 - C
 Total # Pages: 2 (A - C)
 Plus Appendix Pages
 Finalized Date: 1-NOV-2018
 Account: LEBPRO

Project: Caycuse Mineral Project

CERTIFICATE OF ANALYSIS VA18265758

Sample Description	Method Analyte Units LOD	ME-ICP41	ME-ICP41	ME-ICP41	ME-ICP41	ME-ICP41	ME-ICP41
		Ti %	Ti ppm	U ppm	V ppm	W ppm	Zn ppm
		0.01	10	10	1	10	2
Q029964		0.15	<10	<10	37	<10	9
Q029965		0.06	<10	<10	56	<10	37
Q029966		0.02	<10	<10	10	<10	12
Q029967		0.03	<10	<10	17	<10	17



ALS Canada Ltd.
2103 Dollarton Hwy
North Vancouver BC V7H 0A7
Phone: +1 (604) 984 0221 Fax: +1 (604) 984 0218
www.alsglobal.com/geochemistry

To: LE BARON PROSPECTING
3317 HENRY ROAD
CHEMAINUS BC V0R 1K4

Page: Appendix 1
Total # Appendix Pages: 1
Finalized Date: 1-NOV-2018
Account: LEBPRO

Project: Caycuse Mineral Project

CERTIFICATE OF ANALYSIS VA18265758

CERTIFICATE COMMENTS

LABORATORY ADDRESSES

Applies to Method:

Processed at ALS Vancouver located at 2103 Dollarton Hwy, North Vancouver, BC, Canada.
CRU-31 CRU-QC LOG-21
PUL-31 PUL-QC SPL-21

ME-ICP41
WEI-21



ALS Canada Ltd.

2103 Dollarton Hwy
North Vancouver BC V7H 0A7
Phone: +1 (604) 984 0221 Fax: +1 (604) 984 0218
www.alsglobal.com/geochemistry

To: **LE BARON PROSPECTING**
3317 HENRY ROAD
CHEMAINUS BC V0R 1K4

INVOICE NUMBER 4496166

BILLING INFORMATION		
Certificate:	VA18265758	
Sample Type:	Rock	
Account:	LEBPRO	
Date:	1-NOV-2018	
Project:	Caycuse Mineral Project	
P.O. No.:		
Quote:		
Terms:	Due on Receipt	C2
Comments:		

QUANTITY	CODE	ANALYSED FOR - DESCRIPTION	UNIT PRICE	TOTAL
1	BAT-01	Administration Fee	35.80	35.80
4	PREP-31A	Crush, Split, Pulverize Rush Charges X 2.0	14.90	59.60
3.26	PREP-31A	Weight Charge (kg) - Crush, Split, Pulverize Rush Ch	1.60	5.22
4	ME-ICP41	35 Element Aqua Regia ICP-AES Rush Charges X 2.0	24.20	96.80

SUBTOTAL (CAD) \$ 197.42

R100938885 GST \$ 9.87

TOTAL PAYABLE (CAD) \$ 207.29

To: **LE BARON PROSPECTING**
ATTN: SCOTT PHILLIPS
3317 HENRY ROAD
CHEMAINUS BC V0R 1K4

Payment may be made by: Cheque or Bank Transfer

Beneficiary Name: ALS Canada Ltd.
Bank: Royal Bank of Canada
SWIFT: ROYCCAT2
Address: Vancouver, BC, CAN
Account: 003-00010-1001098
Please send payment info to accounting.canusa@alsglobal.com

Please Remit Payments To :
ALS Canada Ltd.
2103 Dollarton Hwy
North Vancouver BC V7H 0A7



ALS Canada Ltd.
2103 Dollarton Hwy
North Vancouver BC V7H 0A7
Phone: +1 (604) 984 0221 Fax: +1 (604) 984 0218
www.alsglobal.com/geochemistry

To: LE BARON PROSPECTING
3317 HENRY ROAD
CHEMAINUS BC V0R 1K4

Page: 1
Total # Pages: 2 (A - C)
Plus Appendix Pages
Finalized Date: 29-OCT-2018
Account: LEBPRO

CERTIFICATE VA18265756

Project: Caycuse Mineral Project

This report is for 1 Soil sample submitted to our lab in Vancouver, BC, Canada on 20-OCT-2018.

The following have access to data associated with this certificate:

SCOTT PHILLIPS

SAMPLE PREPARATION

ALS CODE	DESCRIPTION
WEI-21	Received Sample Weight
LOG-22	Sample login - Rcd w/o BarCode
SCR-41	Screen to -180um and save both

ANALYTICAL PROCEDURES

ALS CODE	DESCRIPTION	INSTRUMENT
ME-ICP41	35 Element Aqua Regia ICP-AES	ICP-AES

This is the Final Report and supersedes any preliminary report with this certificate number. Results apply to samples as submitted. All pages of this report have been checked and approved for release.

***** See Appendix Page for comments regarding this certificate *****

Signature:

Colin Ramshaw, Vancouver Laboratory Manager



ALS Canada Ltd.
 2103 Dollarton Hwy
 North Vancouver BC V7H 0A7
 Phone: +1 (604) 984 0221 Fax: +1 (604) 984 0218
 www.alsglobal.com/geochemistry

To: LE BARON PROSPECTING
 3317 HENRY ROAD
 CHEMAINUS BC V0R 1K4

Page: 2 - A
 Total # Pages: 2 (A - C)
 Plus Appendix Pages
 Finalized Date: 29-OCT-2018
 Account: LEBPRO

Project: Caycuse Mineral Project

CERTIFICATE OF ANALYSIS VA18265756

Sample Description	Method Analyte Units LOD	WEI-21	ME-ICP41	ME-ICP41	ME-ICP41	ME-ICP41	ME-ICP41	ME-ICP41	ME-ICP41	ME-ICP41	ME-ICP41	ME-ICP41	ME-ICP41	ME-ICP41	ME-ICP41	ME-ICP41
		Recvd Wt. kg	Ag ppm	Al %	As ppm	B ppm	Ba ppm	Be ppm	Bi ppm	Ca %	Cd ppm	Co ppm	Cr ppm	Cu ppm	Fe %	Ga ppm
Q029963		0.74	<0.2	5.95	4	<10	10	<0.5	<2	0.36	<0.5	89	368	321	6.18	10



ALS Canada Ltd.
 2103 Dollarton Hwy
 North Vancouver BC V7H 0A7
 Phone: +1 (604) 984 0221 Fax: +1 (604) 984 0218
 www.alsglobal.com/geochemistry

To: LE BARON PROSPECTING
 3317 HENRY ROAD
 CHEMAINUS BC V0R 1K4

Page: 2 - B
 Total # Pages: 2 (A - C)
 Plus Appendix Pages
 Finalized Date: 29-OCT-2018
 Account: LEBPRO

Project: Caycuse Mineral Project

CERTIFICATE OF ANALYSIS VA18265756

Sample Description	Method Analyte Units LOD	ME-ICP41	ME-ICP41	ME-ICP41	ME-ICP41	ME-ICP41	ME-ICP41	ME-ICP41	ME-ICP41	ME-ICP41	ME-ICP41	ME-ICP41	ME-ICP41	ME-ICP41	ME-ICP41	ME-ICP41
		Hg	K	La	Mg	Mn	Mo	Na	Ni	P	Pb	S	Sb	Sc	Sr	Th
		ppm	%	ppm	%	ppm	ppm	%	ppm	ppm	ppm	%	ppm	ppm	ppm	ppm
		1	0.01	10	0.01	5	1	0.01	1	10	2	0.01	2	1	1	20
Q029963		<1	0.03	<10	9.27	735	<1	0.01	569	120	<2	<0.01	<2	2	14	<20



ALS Canada Ltd.
 2103 Dollarton Hwy
 North Vancouver BC V7H 0A7
 Phone: +1 (604) 984 0221 Fax: +1 (604) 984 0218
 www.alsglobal.com/geochemistry

To: LE BARON PROSPECTING
 3317 HENRY ROAD
 CHEMAINUS BC V0R 1K4

Page: 2 - C
 Total # Pages: 2 (A - C)
 Plus Appendix Pages
 Finalized Date: 29-OCT-2018
 Account: LEBPRO

Project: Caycuse Mineral Project

CERTIFICATE OF ANALYSIS VA18265756

Sample Description	Method Analyte Units LOD	ME-ICP41	ME-ICP41	ME-ICP41	ME-ICP41	ME-ICP41	ME-ICP41
		Tl	Tl	U	V	W	Zn
		%	ppm	ppm	ppm	ppm	ppm
Q029963	0.01	0.06	<10	<10	34	<10	103



ALS Canada Ltd.
2103 Dollarton Hwy
North Vancouver BC V7H 0A7
Phone: +1 (604) 984 0221 Fax: +1 (604) 984 0218
www.alsglobal.com/geochemistry

To: LE BARON PROSPECTING
3317 HENRY ROAD
CHEMAINUS BC V0R 1K4

Page: Appendix 1
Total # Appendix Pages: 1
Finalized Date: 29-OCT-2018
Account: LEBPRO

Project: Caycuse Mineral Project

CERTIFICATE OF ANALYSIS VA18265756

CERTIFICATE COMMENTS

LABORATORY ADDRESSES

Applies to Method:

Processed at ALS Vancouver located at 2103 Dollarton Hwy, North Vancouver, BC, Canada.
LOG-22 ME-ICP41 SCR-41

WEI-21



ALS Canada Ltd.

2103 Dollarton Hwy
North Vancouver BC V7H 0A7
Phone: +1 (604) 984 0221 Fax: +1 (604) 984 0218
www.alsglobal.com/geochemistry

To: **LE BARON PROSPECTING**
3317 HENRY ROAD
CHEMAINUS BC V0R 1K4

Page 1 of 1

INVOICE NUMBER 4495831

BILLING INFORMATION

Certificate: **VA18265756**
Sample Type: **Soil**
Account: **LEBPRO**
Date: **29-OCT-2018**
Project: **Caycuse Mineral Project**
P.O. No.:
Quote:
Terms: **Due on Receipt** **C3**
Comments:

QUANTITY	CODE	ANALYSED FOR DESCRIPTION	UNIT PRICE	TOTAL
1	PREP-41	Dry, Sieve (180 um) Soil Rush Charges X 2.0	3.20	3.20
0.74	PREP-41	Weight Charge (kg) - Dry, Sieve (180 um) Soil Rush C	5.30	3.92
1	ME-ICP41	35 Element Aqua Regia ICP-AES Rush Charges X 2.0	24.20	24.20

SUBTOTAL (CAD) \$ 31.32

R100938885 GST \$ 1.57

TOTAL PAYABLE (CAD) \$ 32.89

To: **LE BARON PROSPECTING**
ATTN: SCOTT PHILLIPS
3317 HENRY ROAD
CHEMAINUS BC V0R 1K4

Please Remit Payments To :
ALS Canada Ltd.
2103 Dollarton Hwy
North Vancouver BC V7H 0A7

Payment may be made by: Cheque or Bank Transfer

Beneficiary Name: ALS Canada Ltd.
Bank: Royal Bank of Canada
SWIFT: ROYCCAT2
Address: Vancouver, BC, CAN
Account: 003-00010-1001098
Please send payment info to accounting.canusa@alsglobal.com